

INSTALLATION GUIDE

1-



- 1-
a- Screw the inserts tightly – six pieces

2-

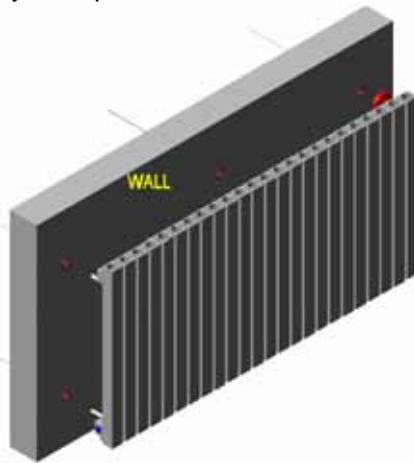

- 2-
a- Fix the radiator in position squarely against wall by inserts making contact with wall.
b- Mark the wall in circle around the contact position of the inserts
c- Drill the wall in the centre of the six circles

3-

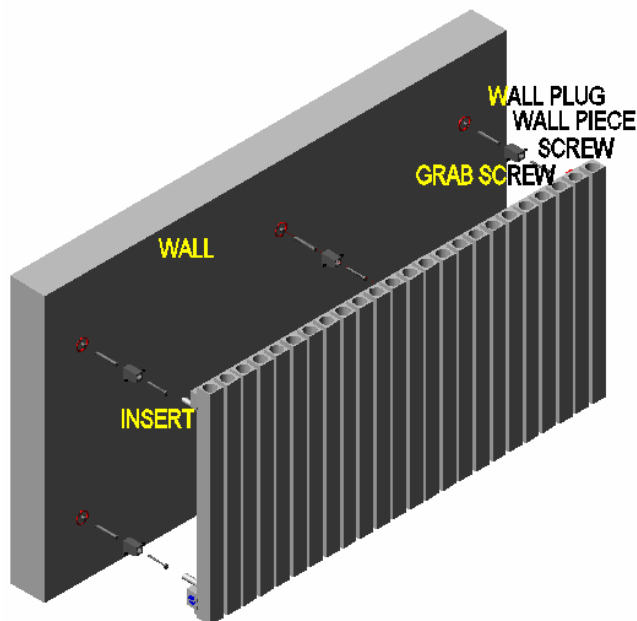

- 3-
a- Fit the wall pieces using correct screws (If the supplied screws are not suitable for the particular wall that you are installing the radiator on)
b- Pop the inserts that are already screwed on the radiators into the wall pieces
c- Secure the radiator by tightening the grab screws on the side of wall pieces

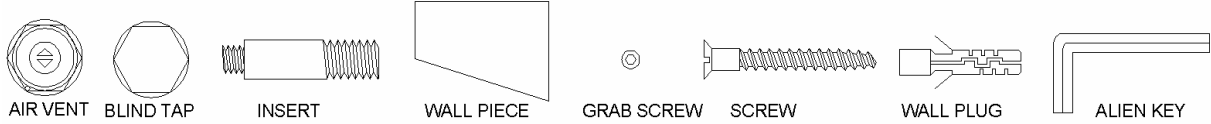

MODEL NAME	LENGTH (mm)	WATER Content (LT)	WEIGHT (Kg)	TAPPING CENTRES (mm)	OUTPUT (BTU)	OUTPUT (Watt)
ELAN E24-6060	1190	14,5	48,50	1150	7775	2280
ELAN E28-6060	1390	16,25	52,30	1350	9071	2660
ELAN E32-6060	1590	18,44	69,00	1550	10366	3040
ELAN E36-6060	1790	20,75	78,00	1750	11662	3420

Test pressure : 13 BAR
 Max. Working pressure : 10 BAR
 Heat output to EN 442

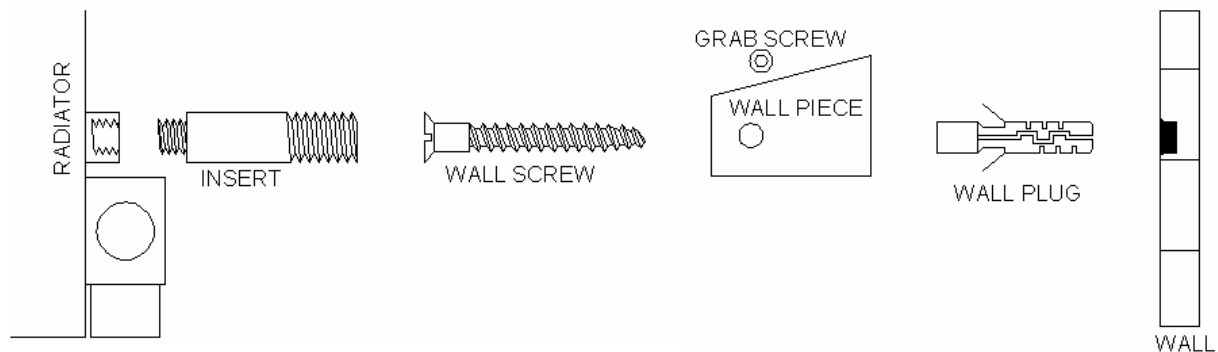
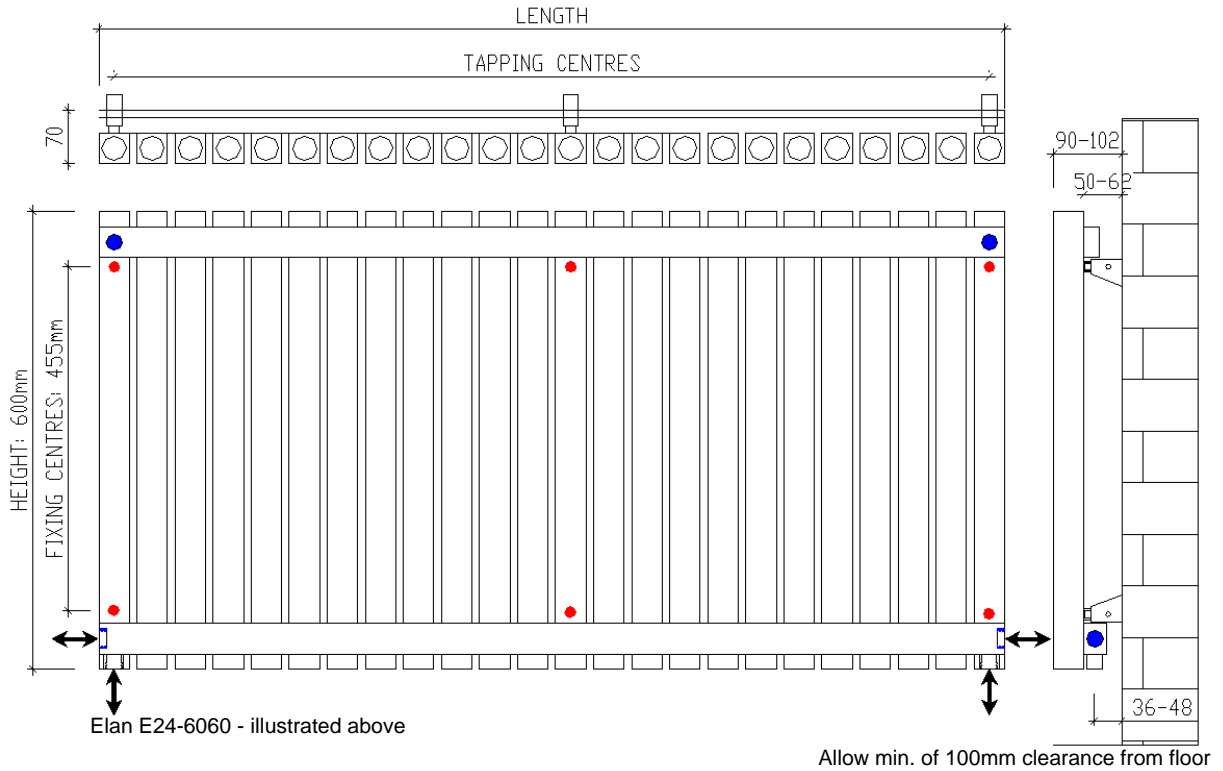

Elan Radiators may only be installed horizontal position as illustrated