

INSTALLATION GUIDE

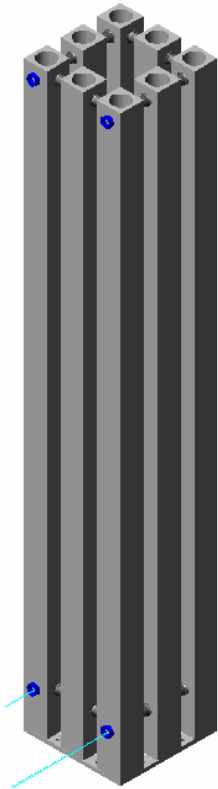

1-
a- Screw the inserts tightly – eight pieces to floor.

2-
a- Hold the radiator in position on the floor.
b- Mark the floor in circle around the contact position of the inserts
c- Drill the floor in the centre of the eight circles

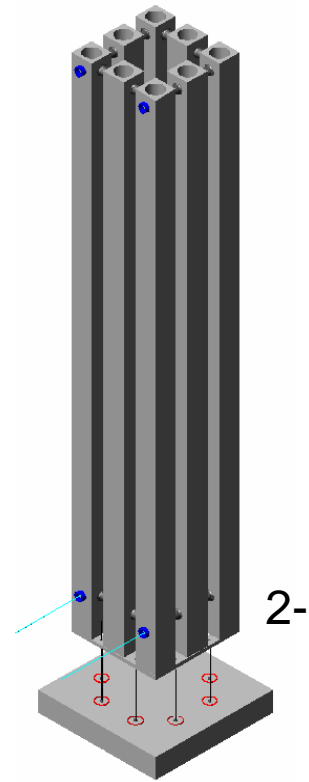

3-
a- Fit the wedge anchor and high tensile set screws into the holes that you already drilled (on the floor and the ceiling)

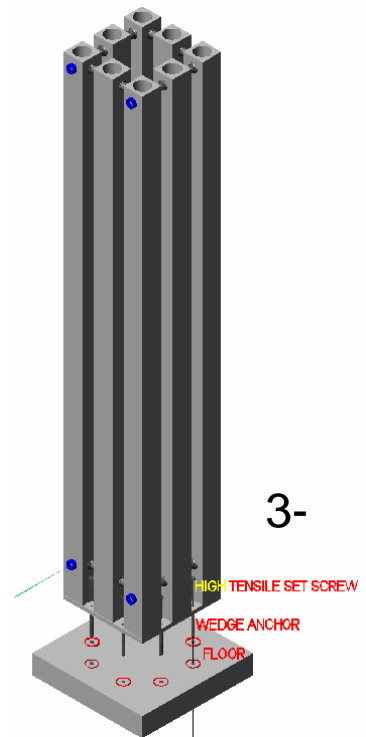

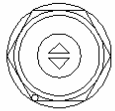

AIR VENT

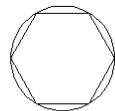

BLIND TAP

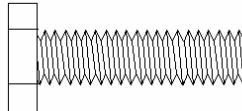

HIGH TENSILE SET SCREW



WEDGE ANCHOR

MODEL NAME	HEIGHT (mm)	WATER Content (LT)	WEIGHT (Kg)	FIXING CENTRES (mm)	OUTPUT (BTU)	OUTPUT (Watt)
Octet 15	1510	37,68	49,83	101	8.913	2610
Octet 18	1810	45,24	59,63	101	10.248	3001
Octet 20	2010	50,28	66,17	101	11.864	3474

Test pressure : 13 BAR
 Max. Working pressure : 10 BAR
 Heat output to EN 442

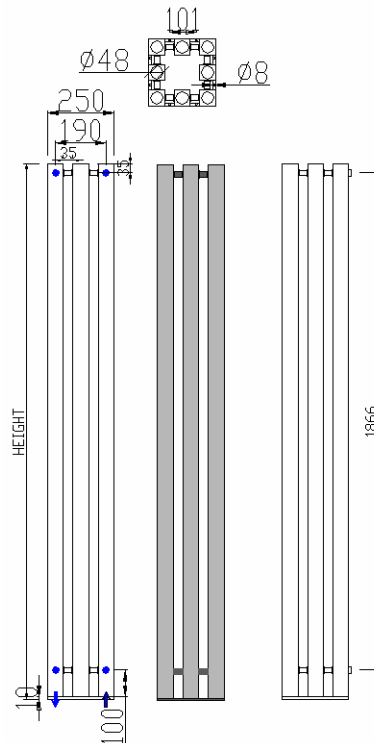

OCTET 20 - illustrated above

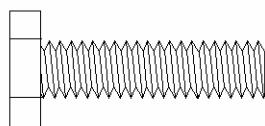

HIGH TENSILE SET SCREW

RADIATOR



WEDGE ANCHOR



FLOOR

OCTET Radiators may only be installed vertical position as illustrated