

UNIVERSAL PANEL & EASY PLUMB KIT

To be read in conjunction with the Shower Tray installation instructions

CONTENTS

1 x 550mm Radius Curved Panel

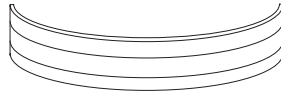

2 x 1200mm Universal Straight Panels

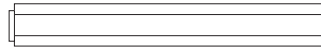

6 x Hexagon Leg Sets

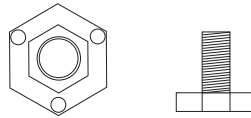

16 x Leg Fixing Screws

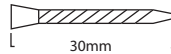

8 x Panel Clips

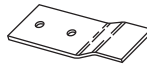

16 x Screws



1 x High Flow Waste Outlet

OR

1 x Duel Waste Outlet

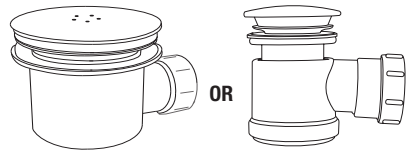

1 x Extendable Flexi waste Pipe



2 x 1200mm Versatile Seal Strips

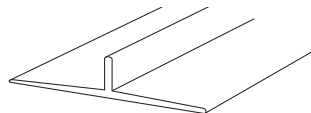

**NB :- For shower trays with one dimension longer than 1200mm and upto 1700mm
a further extension panel set is required.**

UNIVERSAL PANEL & EASY PLUMB KIT

These instructions are for fixing to 'MX' Easy Plumb and ResinLite 45 shower trays, as marked on the installation instructions supplied with the tray.

Use on other brands of shower tray may be possible subject to reference to the shower tray manufacturers instructions.

1. Fit the six hexagon shaped mounting brackets (8 on optional extension pack up to 1700mm) to the shower tray underside with the '30mm' screws supplied (**Fig 1**). Legs must be positioned to give an evenly supported structure, avoiding panel fixing points (section 5) and any existing plumbing.

NOTE: A minimum of one leg (two, one either side of centre on rectangle trays) must be positioned in the approximate centre of the base.

2. Push the hexagon end of the threaded leg tubes into the mounting brackets on the tray and attach the remainder of the mounting brackets (as feet) using the centre threaded section. Adjust the screw in feet height to suit the panels (**Fig 2**).
3. If electing to fit the 'Versatile Seal Strip' (flat top trays only), please follow instructions accordingly.
4. If using a shower tray with a built in tiling upstand, allowance must be made for recessing the tray into adjacent walls to allow tiling down onto the tray surface. With the shower tray in position and adjusted to expected height, mark around top edge and bottom edge of the shower tray onto the adjoining walls and recess the walls to accept the sides of the shower tray allowing 10mm above and below the shower tray for possible adjustment (**Figs 3-4**).

NOTE: When installing or considering recessing any shower tray into adjacent walls, please ensure that your chosen enclosure is compatible with the remaining dimension of the tray.

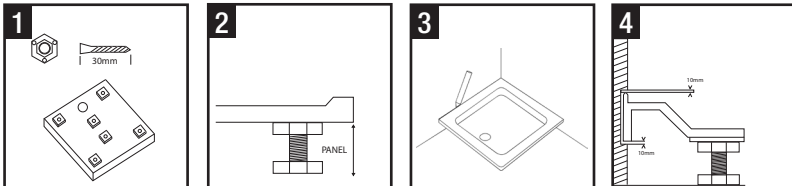

5. Eight panel clips and sixteen screws are supplied in the 'Kit' to secure all panels. These **MUST** be evenly spaced and fixed onto the base of the shower tray for the ResinLite 45 or on the floor (**Fig 7**) in all other cases, using the 12mm screws adjacent the panel sides of the installation. The open end of the clips should fit flush to the sides of the shower tray (**Fig 5 & 8**), adjust the open end of the panel clips using pliers to accept the panels under light tension.

On (**Easy Plumb**) shower trays, mark the outer diameter of the tray on the floor (**Fig 6**) and fix the panel clips 'evenly spaced' to the floor adjacent the panel side of the installation within the marked area. The open end of clips should fit flush to the marked line (**Fig 7**), adjust the open end of the panel clips using pliers to accept the panels under light tension.

6. Place the shower tray in position and level using the adjustable legs (**Fig 2**), ensuring that panel height is maintained. Fit the waste outlet and connect to the waste pipe directly or via the 'flexi waste pipe' supplied.

The shower tray and all connections MUST be checked for water flow, tightness and drainage before final installation and adjust if required. NB If in doubt consult a qualified plumber.

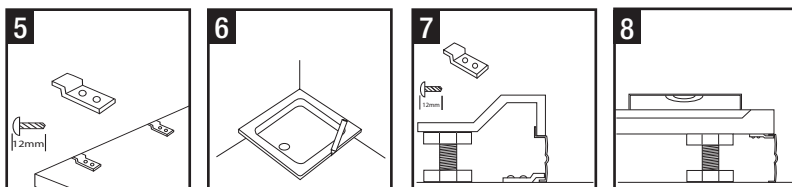

7. Panels should now be cut using a sharp knife or a mitre saw (**taking great care to avoid injury**), for the size and type of shower tray being installed up to 1200mm i.e. dimension **(A)** on **(Fig 9 or 10)**.
8. For shower trays greater than 1200mm upto 1400mm, use optional extension pack and fit as **(Fig 10)**.
9. For shower trays greater than 1400mm, use optional extension pack and cut as **(A)** on **(Fig 11)** to achieve the desired dimension and an evenly spaced join between the two front panels.

NOTE: It is recommended that addition support (i.e. wooden batons or similar) is given to shower trays larger than 1400mm.

Please ensure that all panels are orientated to fit together as either (Fig 9, 10 or 11).

10. For pentangle shower trays, please mitre cut the panels to suit the angle and dimension **(A)** of the particular size of tray being installed **(Fig 12)**. All connecting angled cuts must be taped and glued together using silicone or similar.

NOTE: For best results on an MX pentangle shower tray, use dedicated 'optional' pentangle panel set, up to 900x900mm.

11. All panels in this kit have a protective film covering that **MUST** be removed before fitting the panels to the shower tray by sliding the edge of the panels into the clips.

NOTE: Once the panels are in place, seal all panel contact points with a suitable silicone.

12. After all checks and adjustments, seal along the tiling line with a silicone sealant. Ensure that all mating surface are clean and free from contaminates.

NOTE: If necessary use a proprietary silicone cleaning solvent prior to application.

When fitting a shower enclosure refer to the manufacture's installation instructions.

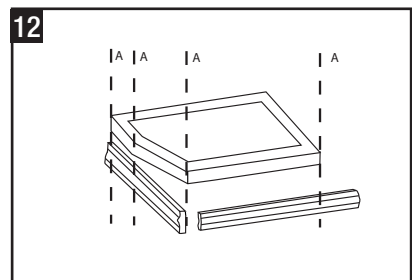
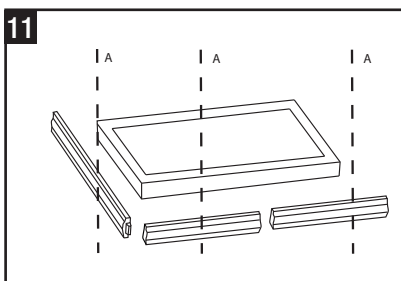
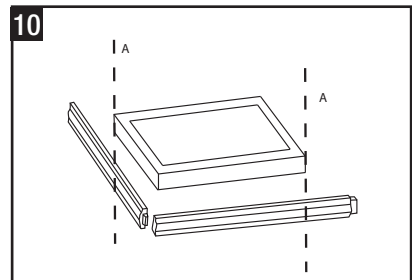
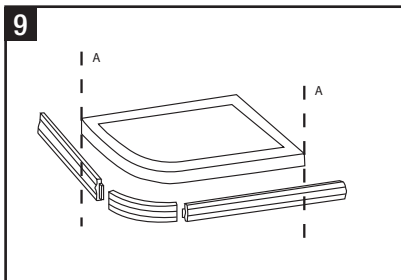

VERSATILE SEAL STRIP INSTALLATION

The Versatile Seal Strip will instantly transform any flat top shower tray to a tiling upstand option.

The Versatile Seal Strip is an extruded self-adhesive UPVC tiling upstand that is fixed by hand, see relevant points on floor and raised shower tray instructions.

This extruded strip comes complete with a mould resistant cushioned seal to ensure a snug fit which combined with its unique angled design helps ensure a watertight seal between the shower tray or bath and the wall. The slim profile of tiling upstand allows easy tile fixing.

Fitting Options

All mating surfaces of the shower tray for the Versatile Seal Strip and Silicone Seals must be clean and free from contaminants, if necessary use a proprietary silicone cleaning solvent prior to application.

NOTE: Avoid spillage on visible areas as some solvents may mark the surface.

To fit the Versatile Seal Strip remove backing strips from fixing tape and apply to the tray or bath as shown in (Fig 1).

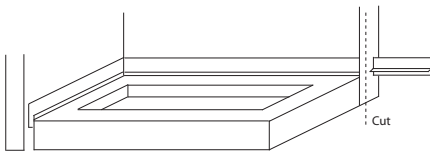

Fig 1.

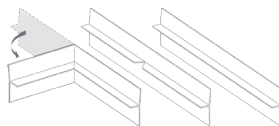

Fig 2.

Fit the Versatile Seal Strip to the tray or bath and simply mitre the lip with two 45° cuts the bend to form corner or butt joint (Fig 2).

Check the Versatile Seal Strip fits the shower tray or bath, then mark the excess length and trim with a sharp knife (Fig 1).

Apply a small bead of silicone on the internal mitred corner before tiling, this will ensure a waterproof seal as shown in (Fig 2).



CERTIFICATE NO. 17298/3

Manufactured by Marleton Cross Limited Trading as The MX Group
A BS EN ISO 9001: 2000 Accredited Company
Alpha Close, Delta Drive, Tewkesbury Industrial Estate, Tewkesbury, Glos. GL20 8JF.

Trade Descriptions Act

Variations in terms of colour finish, materials and all other aspects of appearances may occur on occasions, either through non-availability of materials or due to our policy of continuing technical improvement. Therefore the company reserves the right to change specification or withdraw products without prior notice being given.



ISO 9001:2000

01-09-LH