

AKW[®]
life. style. choice.

Electric Showers



ⓘ care ⓘ therm ⓘ sure



i care

i therm

i sure

iCare	4
› Optional Extras	8
› Technical specification	18
iTherm	10
› Technical specification	19
iSure	14
› Technical specification	20
About AKW	21

Beautifully designed with you in mind

Do you remember the very first time you used an MP3 player... a smartphone... a tablet PC?

Great design changes the way we use things, works well for everyone and creates a product that's simple to use and great to look at.

That's why AKW's new range of electric showers has been beautifully designed with you in mind.

Whether you're using our showers or installing them, you'll find the great features and technical innovations make your life just that little bit easier. Whether it's for a family bathroom or a new development, a small flat or a mansion, a parent or a carer, we have the perfect electric shower for any setting.

Electric showers just got interesting.





Interesting in every way

Contemporary styling combines with advanced technology to create the world's first Bluetooth® Smart enabled electric shower. Offering unrivalled levels of control, safety, ease of use and style, iCare looks good however you look at it.



The care shower that looks so good everyone will want one. iCare's Bluetooth® Smart wireless remote means you can control it from outside the shower area; turn it On/Off, set the flow rate and bring it up to temperature from across the room or even from the comfort of your bed. Stylish push-button controls and Audible/LED Illuminated Indicators provide ultimate control and safety.

Care features

- + Easy push-button controls: Power, Temperature, Flow
- + All controls closely grouped together
- + Raised tactile symbols: +, -, Temp, Flow
- + Audible Temperature and Flow Indicators
- + LED Illuminated Temperature and Flow Indicators
- + Matt anti-glare finish
- + Rounded surfaces and edges for safety
- + BEAB CARE Certified
- + RNIB Tried and Tested
- + 10.5kW option for therapeutic use
- + Care kit: 2m hose, 150kg load-bearing rail, easy-adjust multi-mode shower head
- + Thermostatic Control and Phased/Auto Shutdown
- + Bluetooth® Smart wireless remote control (optional)
- + iShower app for iPhone



Also available in silver

Installer features

- + Super-quick and easy installation
- + 8 electrical / 8 water entry points
- + Dual power blocks for left or right hand wiring
- + Retro-fit footprint covers most manufacturers' models
 - No re-tiling required
 - Existing cable & pipework compatible
- + 3-year warranty
- + 8.5kW / 9.5kW / 10.5kW options
- + Comprehensive technical after-sales support
- + Wired or wireless connectivity to all AKW DigiPump shower waste pumps

Wireless waste pump interface

iCare can connect wirelessly to all AKW DigiPump shower waste pumps. No wires and no mess means super-quick and easy installation in situations where gravity waste isn't suitable. AKW digital pumps work seamlessly with iCare to match the rate of flow and are virtually silent in operation.



Optional Extras

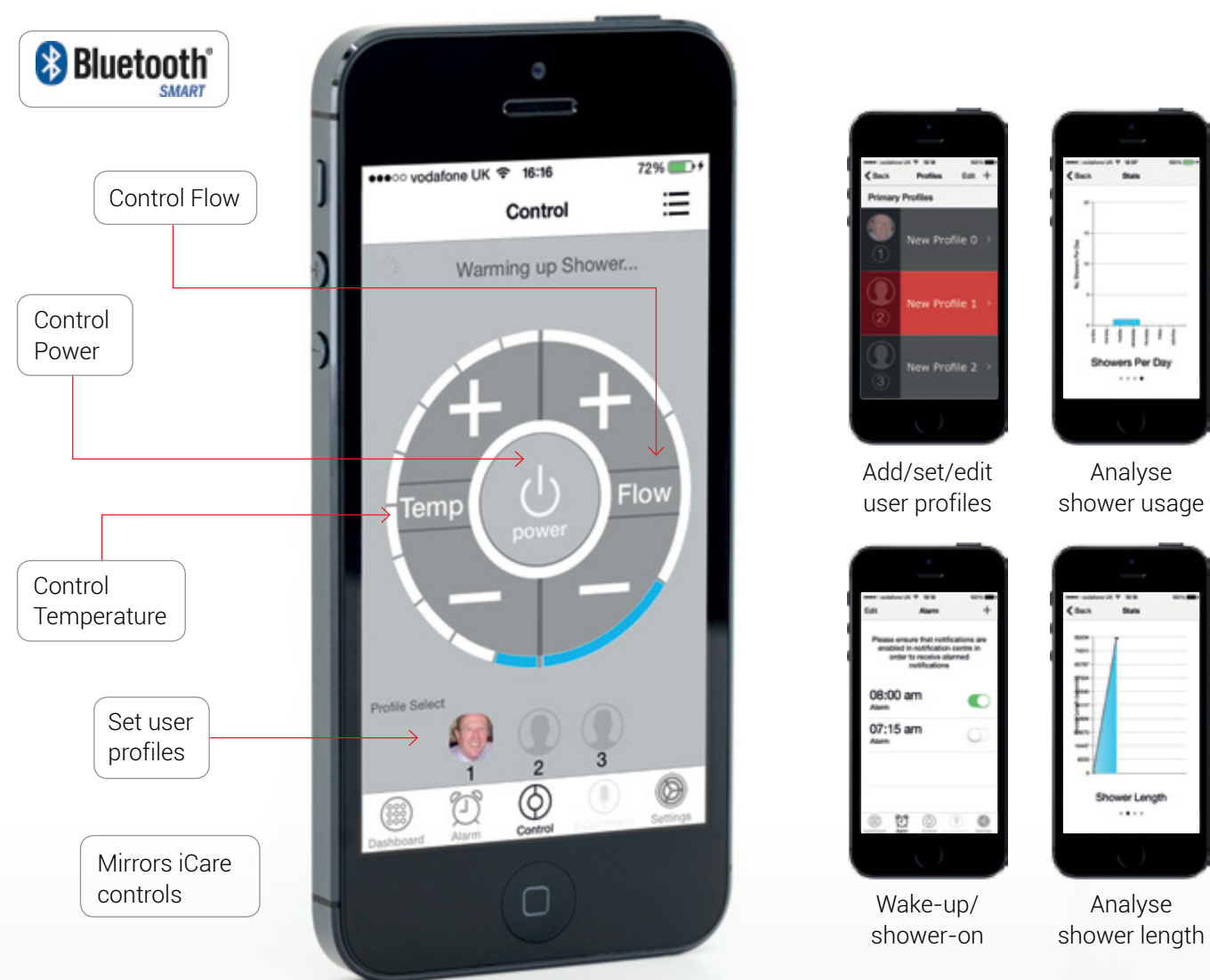

Smart Device App

Use your iPhone to switch on iCare from outside the shower area so you don't get wet, or from your bed so that it's ready for you. iCare can turn on when your alarm goes off and send a 'shower ready' alert to your phone. Monitor shower usage and store preferred settings with multiple user profiles.

- + Full control via app
- + Create individual user profiles
- + Monitor usage: frequency, water, energy
- + Shower-ready alerts
- + Wake-up alarm & shower-on indicator
- + Bluetooth® Smart connection
- + Works up to 10m away from shower unit



Wireless Remote

The Bluetooth® Smart wireless remote control provides flexibility and control, from up to 10 metres away. Tactile raised symbols, push-button control of Power, Temperature and Flow and a fully waterproof high grip casing mean it's easy to hold and use. Wall mount or attach to any flat surface with provided suction cups.

- + Raised symbols
- + Push-button controls
- + Fully waterproof
- + Works up to 10 metres away
- + Control: Power, Temperature, Flow
- + Blue LED activity indicator
- + Wall mount included
- + Glass mount suction cups included



Effortless control

Intuitive design puts you firmly in control. The LED display, Power push-button and independent Temperature and Flow controls ensure the perfect thermostatically stabilised shower every time. Simple, stylish and safe for all the family.



Select the perfect temperature and flow using the highly responsive controls with feedback from the LED Temperature and Flow Indicators. Easy push Power button conveniently maintains the settings for your next shower. Thermostatically stabilised temperature provides ultimate reassurance, along with Phased Shutdown to flush any residual hot water for reduced limescale and a longer life.

Features

- + Contemporary styling and high gloss finish
- + Easy push Power button. Maintains Temp/Flow settings
- + LED Temperature Indicator
- + LED Flow Indicator
- + Independent Temperature and Flow controls
- + Thermostatically Stabilised Temperature
- + Phased/Auto Shutdown
- + Chrome accessories: adjustable riser rail, hose, multi-mode handset, soap dish
- + 8.5kW and 9.5kW options
- + Rounded surfaces and edges for safety

Installer features

- + Super-quick and easy installation
- + 8 electrical / 8 water entry points
- + Dual power blocks for left or right hand wiring
- + Retro-fit footprint covers most manufacturers' models
 - No re-tiling required
 - Existing cable & pipework compatible
- + 3-year warranty
- + 8.5kW / 9.5kW options
- + Comprehensive technical after-sales support



Simply stylish

Clean white lines and a high gloss exterior accentuate the simple elegance many interiors call for. Controlled by individual mechanical Temperature and Flow controls and an easy push Power button which maintains your ideal settings for next time.



The perfect solution for replacement installations and when simple is simply the best. White dials set into a deep gloss surround provide a minimalist look suited to all showering areas. Advanced fitting innovations and a handy fitting template mean it's quick and easy to install over most manufacturers' footprints, which means less re-tiling, cabling and pipework.

Features

- + Contemporary styling and high gloss finish
- + Easy push Power button. Maintains Temp/Flow settings.
- + Independent Temperature and Flow controls
- + Phased Shutdown
- + Accessories: adjustable chrome riser rail, white hose, white single-mode handset
- + 8.5kW and 9.5kW options
- + Rounded surfaces and edges for safety

Installer features

- + Super-quick and easy installation
- + 8 electrical/8 water entry points
- + Dual power blocks for left or right hand wiring
- + Retro-fit footprint covers most manufacturers' models
 - No re-tiling required
 - Existing cable & pipework compatible
- + 3-year warranty
- + 8.5kW/9.5kW options
- + Comprehensive technical after-sales support

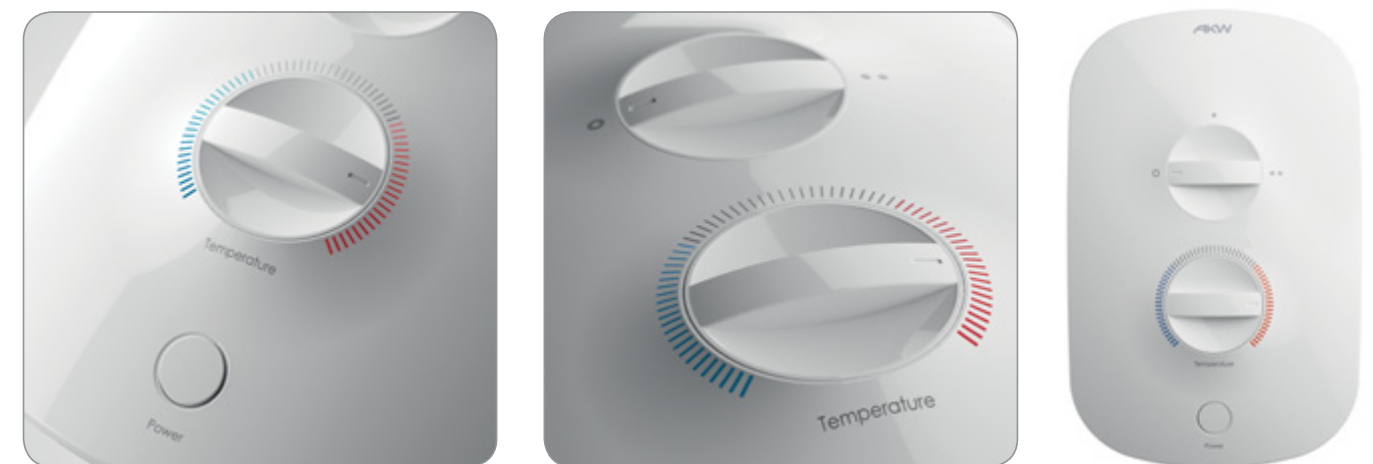

Technical specifications



Plumbing Supply

Supply Source	Mains pressure cold water only
Minimum Dynamic Pressure	50kPa (0.5 Bar)
Maximum Static Pressure	1000 kPa (10 Bar)
Optimal Minimum Dynamic Pressure	100 kPa (1 Bar) (Recommended to ensure high performance)
Maximum Inlet Temperature	28°C
Minimum Inlet Temperature	2°C
Inlet Connection	15 mm pipe
Outlet Connection	1/2" BSP Male thread Fitting

Electricity Supply

Nominal Rating at	240 V 10.5kW, 9.5kW & 8.5kW
Supply Fuse / Circuit Breaker	(10.5kW 45/50A), (9.5kW 40/45A) & (8.5kW 35/40A)
Residual Current Device (RCD)	30 mA (must be fitted)
Supply Cable	Refer to current wiring regulations and BS 7671 to determine minimum cable size. No larger than 10 mm ²
Isolation Switch (e.g. Pull Cord)	45 Amp Double pole

Physical

Height (H)	380 mm
Width (W)	230 mm
Depth (D)	85 mm
Footprint Height (H2)	345 mm
Footprint Width (W2)	210 mm
Water Ingress Rating	IPX4
Water and Cable Entry Points	Top, bottom or back.
Shower Drain Pump Connections	Suitable for AKW M Series (flow sensor or wireless), D4 (Flow Sensor) or AKW A4 (Flow Switch)

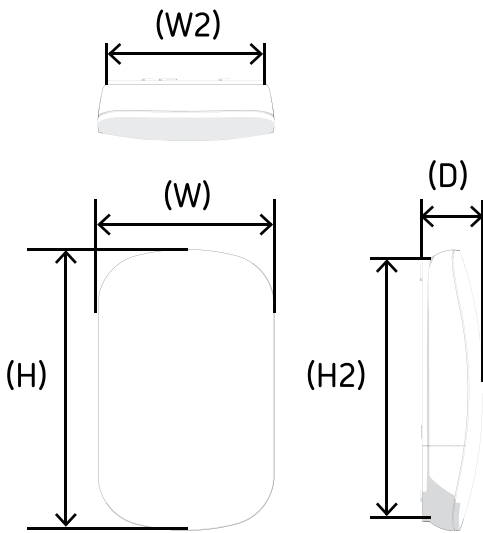

Product codes

29010WH	iCare White 10.5kw with silver/white kit	29012Si	iCare Silver 8.5kw with silver/white kit
29011WH	iCare White 9.5kw with silver/white kit	29013	iCare Shower Remote Control
29012WH	iCare White 8.5kw with silver/white kit	29014	Pump Wireless Module
29010Si	iCare Silver 10.5kw with silver/white kit		
29011Si	iCare Silver 9.5kw with silver/white kit		

Technical specifications



Plumbing Supply

Supply Source	Mains pressure cold water only
Minimum Dynamic Pressure	50kPa (0.5 Bar)
Maximum Static Pressure	1000 kPa (10 Bar)
Optimal Minimum Dynamic Pressure	100 kPa (1 Bar) (Recommended to ensure high performance)
Maximum Inlet Temperature	28°C
Minimum Inlet Temperature	2°C
Inlet Connection	15 mm pipe
Outlet Connection	1/2" BSP Male thread Fitting

Electricity Supply

Nominal Rating at	240 V 9.5kW & 8.5kW
Supply Fuse / Circuit Breaker	(9.5kW 40/45A) & (8.5kW 35/40A)
Residual Current Device (RCD)	30 mA (must be fitted)
Supply Cable	Refer to current wiring regulations and BS 7671 to determine minimum cable size. No larger than 10 mm ²
Isolation Switch (e.g. Pull Cord)	45 Amp Double pole

Physical

Height (H)	380 mm
Width (W)	230 mm
Depth (D)	85 mm
Footprint Height (H2)	345 mm
Footprint Width (W2)	210 mm
Water Ingress Rating	IPX4
Water and Cable Entry Points	Top, bottom or back.
Shower Drain Pump Connections	Suitable for AKW M Series (flow sensor or wireless), D4 (Flow Sensor) or AKW A4 (Flow Switch)

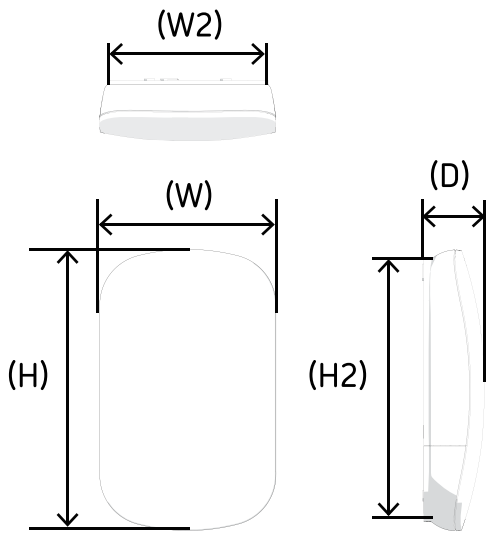

Product codes

29024	iTherm White 8.5kw Thermostatic Shower with Standard Kit
29025	iTherm White 9.5kw Thermostatic Shower with Standard Kit

Technical specifications



Plumbing Supply

Supply Source	Mains pressure cold water only
Minimum Dynamic Pressure	50kPa (0.5 Bar)
Maximum Static Pressure	1000 kPa (10 Bar)
Optimal Minimum Dynamic Pressure	100 kPa (1 Bar) (Recommended to ensure high performance)
Maximum Inlet Temperature	28°C
Minimum Inlet Temperature	2°C
Inlet Connection	15 mm pipe
Outlet Connection	1/2" BSP Male thread Fitting

Electricity Supply

Nominal Rating at	240 V 9.5kW & 8.5kW
Supply Fuse / Circuit Breaker	(9.5kW 40/45A) & (8.5kW 35/40A)
Residual Current Device (RCD)	30 mA (must be fitted)
Supply Cable	Refer to current wiring regulations and BS 7671 to determine minimum cable size. No larger than 10 mm ²
Isolation Switch (e.g. Pull Cord)	45 Amp Double pole

Physical

Height (H)	380 mm
Width (W)	230 mm
Depth (D)	85 mm
Footprint Height (H2)	345 mm
Footprint Width (W2)	210 mm
Water Ingress Rating	IPX4
Water and Cable Entry Points	Top, bottom or back.

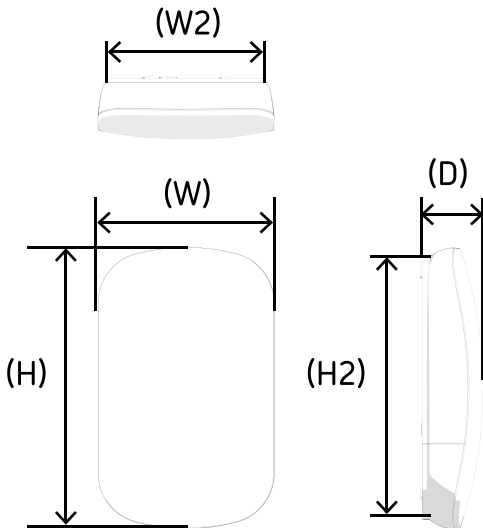

Product codes

29021	iSure White 8.5kw Non-Thermostatic Electric Shower with Standard Kit
29022	iSure White 9.5kw Non-Thermostatic Electric Shower with Standard Kit

About AKW

AKW are passionate about giving our customers what they want. So you get high-quality products that meet practical requirements, offer the widest possible choice and help create stylish living spaces which improve quality of life.

From a small Worcestershire business founded in 1982, AKW has grown to become a market-leader and international operation with:

- + Over 250 trained staff
- + A world-class manufacturing facility on the Isle of Man
- + Our own dedicated nationwide delivery service
- + Two national distribution warehouses
- + A dedicated nationwide sales team

Our highly experienced national sales team and trained surveyors can give you the product knowledge and advice you need. Just give us a call on **01905 823 298** or visit **www.akw-ltd.co.uk/contact-us**

Choice, competitive pricing and first-class customer service make AKW the brand of choice for clients across the UK and abroad.







i care



i therm



i sure

Orders & Quotes

01905 823 299
orders@akw-ltd.co.uk

General Enquiries

01905 823 298
sales@akw-ltd.co.uk

Technical Enquiries

01905 560 219
technicalenquiries@akw-ltd.co.uk

AKW

Pointon Way, Hampton Lovett
 Droitwich Spa, WR9 0LR

www.akw-ltd.co.uk/showers



AKW[®]
 life. style. choice.