

**Product Overview:** The TMV3 thermostatic mixer tap has an extended lever for easy operation using a closed fist or elbow

- Benefits:**
- Ideal for extra safety in domestic bathrooms
  - Can be used for Doc M fully compliant commercial installations
  - Easy to use paddle lever even for users with limited dexterity

- Features:**
- TMV3 approved offering peace of mind and no risk of scalding
  - Integrated mixer valve for improved hygiene
  - Non reflective satin chrome finish for partially sighted users
  - Simple paddle lever
  - Sequential easy operation



**Guarantee & Certification:**



**Product Specification:**

**Maximum Static Pressure:** 10 Bar

**Inlet Temperature Range:** 52°C - 65°C: Hot Supply    0.5°C - 20°C: Cold Supply

**D08 Working Pressure Ranges:** 0.2 - 1.0: Low Pressure

Minimum temperature differential between blended water and hot or cold supply (°C). 10°C Hot Supply  
10°C Cold Supply

\* The lifetime warranty excludes normal wear and tear in general domestic applications and in accordance with AKW installation instructions. It applies only to products being installed for the first time and according to relevant local and national regulations.

**Dimensions:**

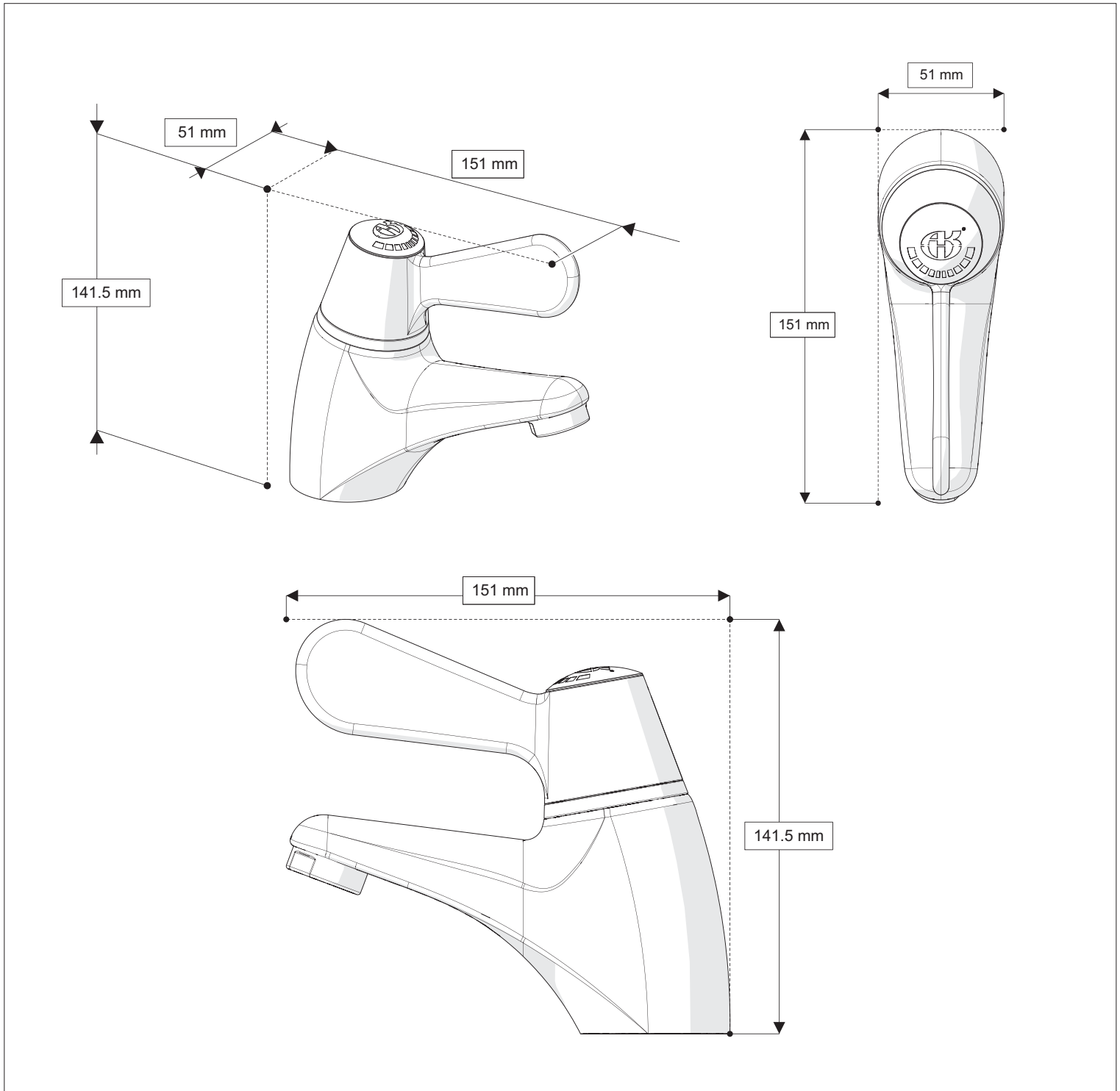

**Product Codes:**

Codes	Description
23116A	TMV3 Thermostatic mixer tap