

# Level Best Screens



Suitable for  
shower trays  
and wet floors



## Installation and user care instructions

Installer- please read all instructions carefully before installation and leave these instructions with the end user for future reference as this document contains important warranty information.

**AKW**  
life.style.choice.

# Important safety notes

**Do not discard this document as it contains important warranty information.**



Read all the instructions carefully and leave the instructions with the end user.



The product is heavy up to (50kg Max). Get someone to help to lift, assemble and install it.

## Before you start work:



Check for hidden cables or pipes before drilling into a wall.

## Caution:



**Always start with the wall profile and align the enclosure into position checking the area is suitable before marking out and fixing.**



Always wear safety glasses when you use power tools and use the appropriate personal protection equipment.



If you have to drill holes into ceramic tiles, stick a piece of masking tape to the tile to stop the drill bit from slipping and damaging the tile. Do not use your drill on hammer action if you are drilling holes into ceramic tiles.



Always disconnect power tools from the electrical supply when you have finished working with them.



Make sure any electrical cables do not cause a trip hazard.



Take care when you handle the profiles. They may have sharp edges.

Follow the manufacturer's safety instructions when you use any silicone sealant or degreasing agent.

## When you unpack the product:

- ✓ Take care when you unpack the product and make sure that you do not inadvertently discard any small parts. If any parts are missing or damaged contact the AKW customer services.

## Before you start work:





- ✓ Check the shower tray or wet-floor is level and is completely sealed to finished or tiled walls.
- ✓ Check that finished walls are sound and free from cracks or loose tiles or grout.

## While you work:

- ✓ Make sure that all surfaces are clean, dry and free from loose debris or dust.
- ✓ Protect the surfaces of the shower tray and cover the waste to prevent the loss of small components and prevent debris from entering the waste trap.
- ✓ Make sure that you follow the manufacturer's instructions to degrease any surfaces that you need to silicone.
- ✓ Use the external packaging to protect the floor and wall when you assemble the product.
- ✓ To check the accuracy of your spirit level place it on a horizontal surface and note the bubble position between the markers. Rotate the spirit level through 180° and note the bubble position again. Ensure the markers are level. Repeat the test vertically.

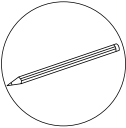
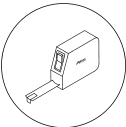
## After installation:

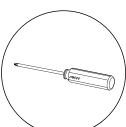
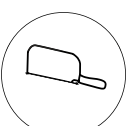
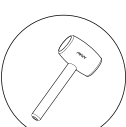
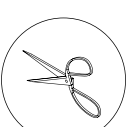
- ✓ Do not wet the enclosure for 24 hours to ensure that the silicone sealant is fully cured.

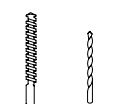
Contents	Pages	Tools required
Important Safety Information	2	
Preparation	Pages	
Steps 1 Wall profile preparation installation	4-6	 
Alignment	Pages	
Steps 2 Post block installation	7	
For Shower Trays	8	
For Wet Rooms	9	
Installation	Pages	
Steps 3 Screen Installation	10	
Step 4 Wall brace and wall bracket installation	11-12	 
Final Installation	Pages	
Step 5		
Securing & fixing	13	
Sealing the enclosure & aftercare	14	 <b>Ø6 Ø2.8</b>

# Wall profile preparation

## Step 1 for shower trays

Check pack contents  
Check tray is completely level  
Cover waste  
Protect tray



Tray installation must be completely 100% level in all directions and sealed to the wall. Wet room preparation must be completed before starting any work and the screen area must be clean and dust free.

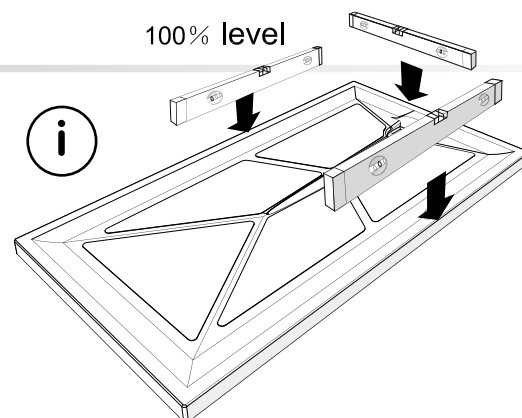

**i** Install the enclosure on the inside edge of the flat portion of the tray. Avoid installing over the edge radius as this will cause leakage.

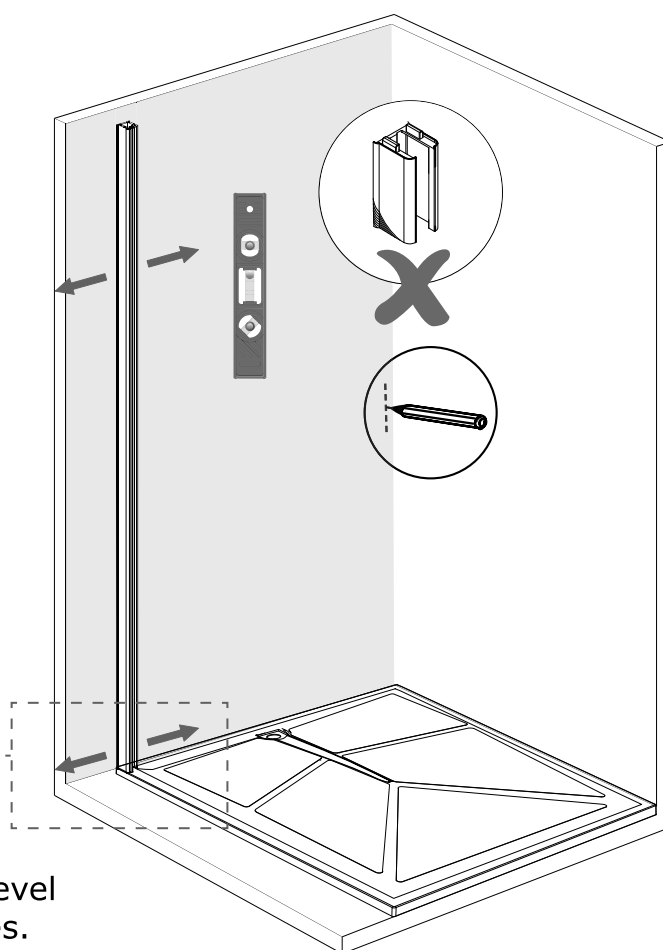
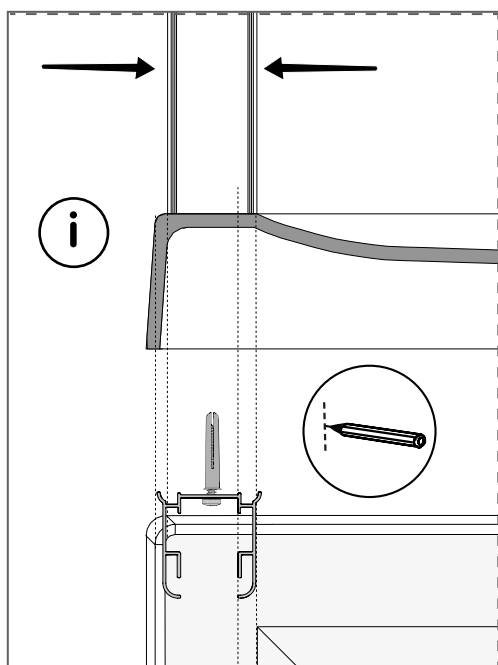

**i** Ensure the wall profile is completely level and mark the centre of the fixing holes.

**TIP**

Install the post block footplate onto the tray or floor before installing the screen into the wall compensator.



# Wall profile preparation

## Step 1 for slip resistant flooring

Ensure the wall profile is completely level and mark the centre of the fixing holes.

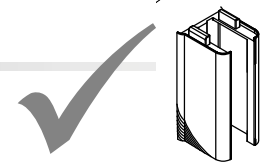

100mm corner block

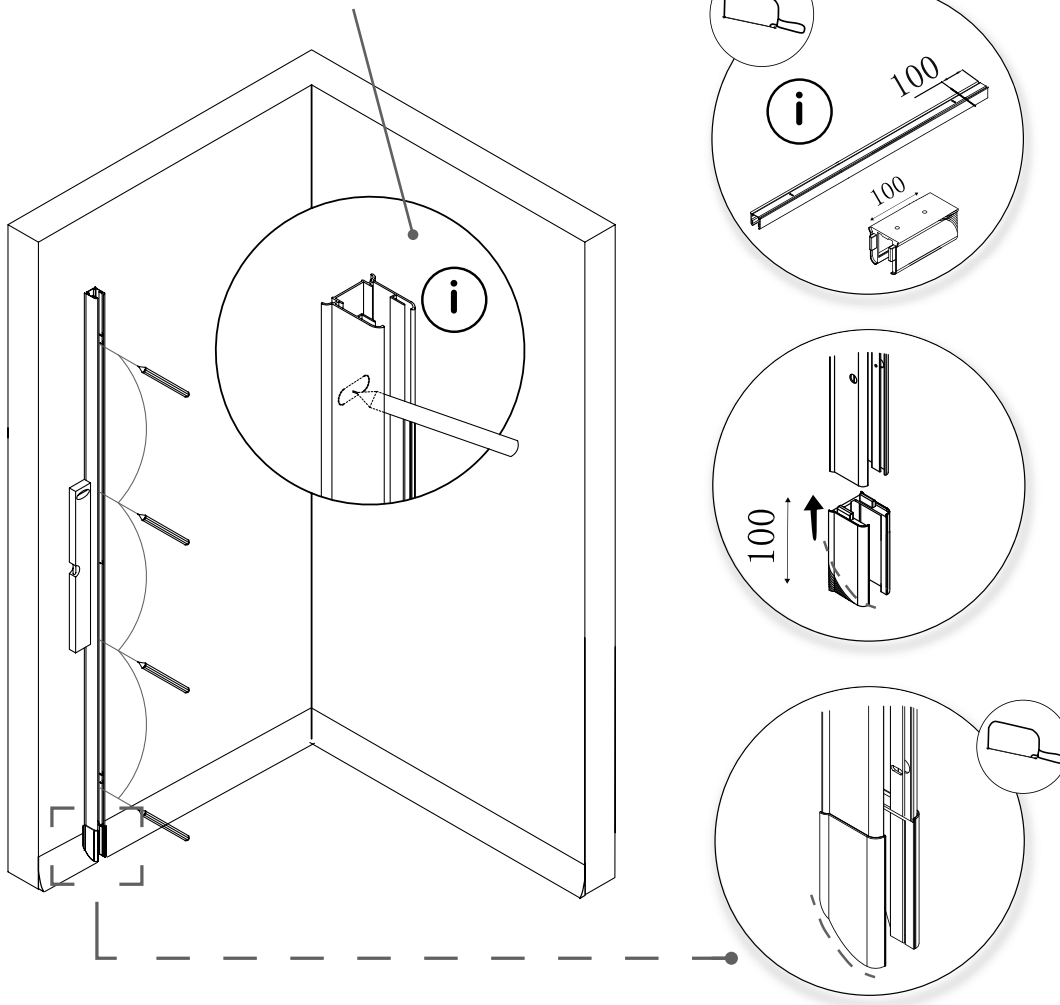

For wet rooms using slip resistant safety flooring or similar, use the corner block with the wall profile. Wet room preparation must be completed before starting any work and the screen area must be clean and dust free.

Measure and cut the wall profile 100mm, the same length as the corner block to match the total height of the screen. Trim to the shape of the safety flooring before fixing to the wall profile. Ensure the wall surface is level and clean from any building material. Ensure the wall profiles are completely level before fixing. For wall tiles use a tile drill bit. Ensure suitable fixings are used for this type of installation and the wall structure can support the weight of the screen that will be used.

# Wall profile installation

## Installing the wall profile

Ensure the wall surface is finished, level and capable of supporting the screen. For wall tiles use a tile drill bit. Ensure suitable fixings are used for this type of installation and can support the weight of the screen that will be used.

For tray installations do not use the wet floor compensator block.

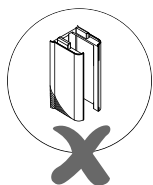

Drill the wall through the centre of the slots with a 6mm tile or wall masonry drill bit and insert the wall plugs.

**TIP**

Use masking tape to drill on tiled surfaces.

**TIP**

Do not silicone between the wall profile and the wall as further adjustment may be required. Only seal the entire enclosure after installation. See page 15

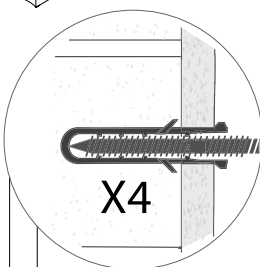
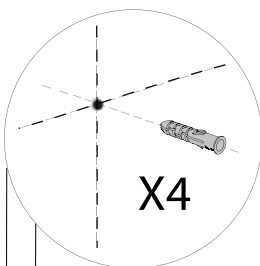

4x35mm

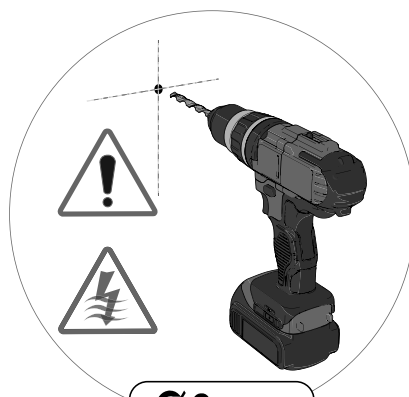

Ø6mm



**WARNING -**

Ensure there are no buried pipes or cables before drilling.

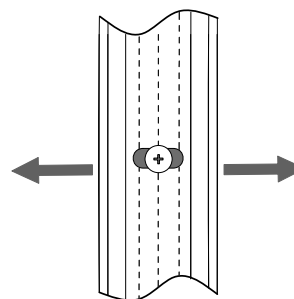
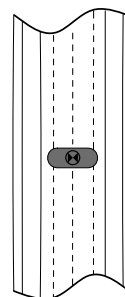

Ensure profile is vertical by using the profile slots for finer adjustment.



Ensure the fixing holes are to the inside of the enclosure.

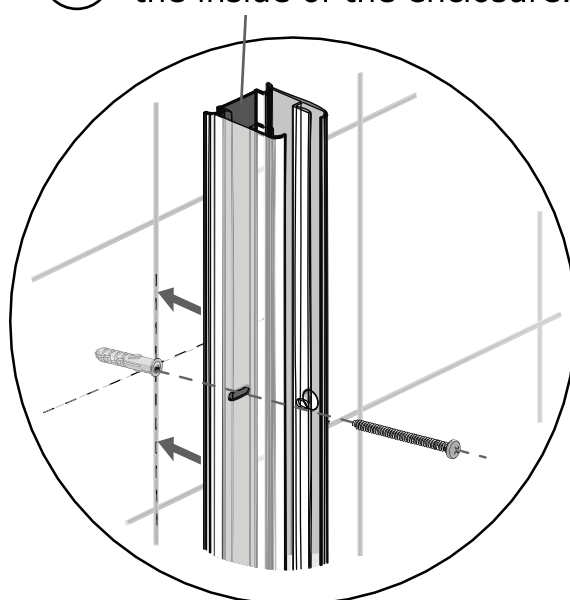

## Step 2

Level Best screens use a support post block footplate and wall support tie bar rod. The post block footplate must be installed before the panel can be fitted to the wall profile. Align the panel into the wall compensator. Position the post block footplate ensuring the screen is level and at 90 degrees from the wall before marking the floor type or on the inside edge of the tray with a pencil around the bottom of the post block footplate.

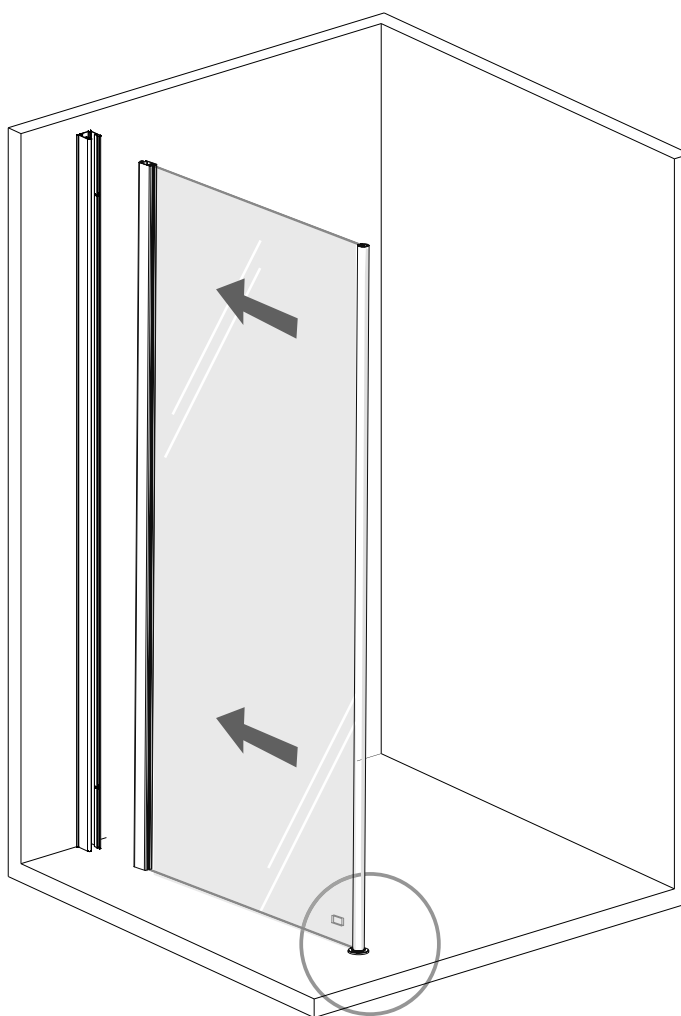

Note: there are different post block footplates for both tray installation and wet floor or tiled installations.

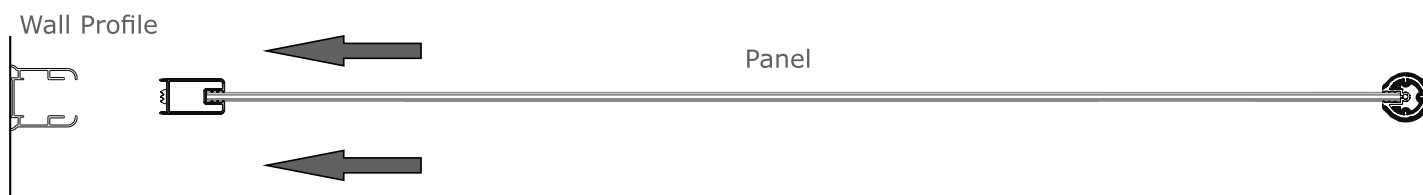

## Installing the bottom post block footplate onto a shower tray

Remove the screen from the wall compensator to install the post block footplate onto the tray before securing the screen onto the wall. Ensure the glass screen is positioned towards the inside of the tray and ensure the wall mounting column foot is in place. Attach the bottom water seal to the glass screen and ensure the lip is on the inside of the shower enclosure before cutting to length.

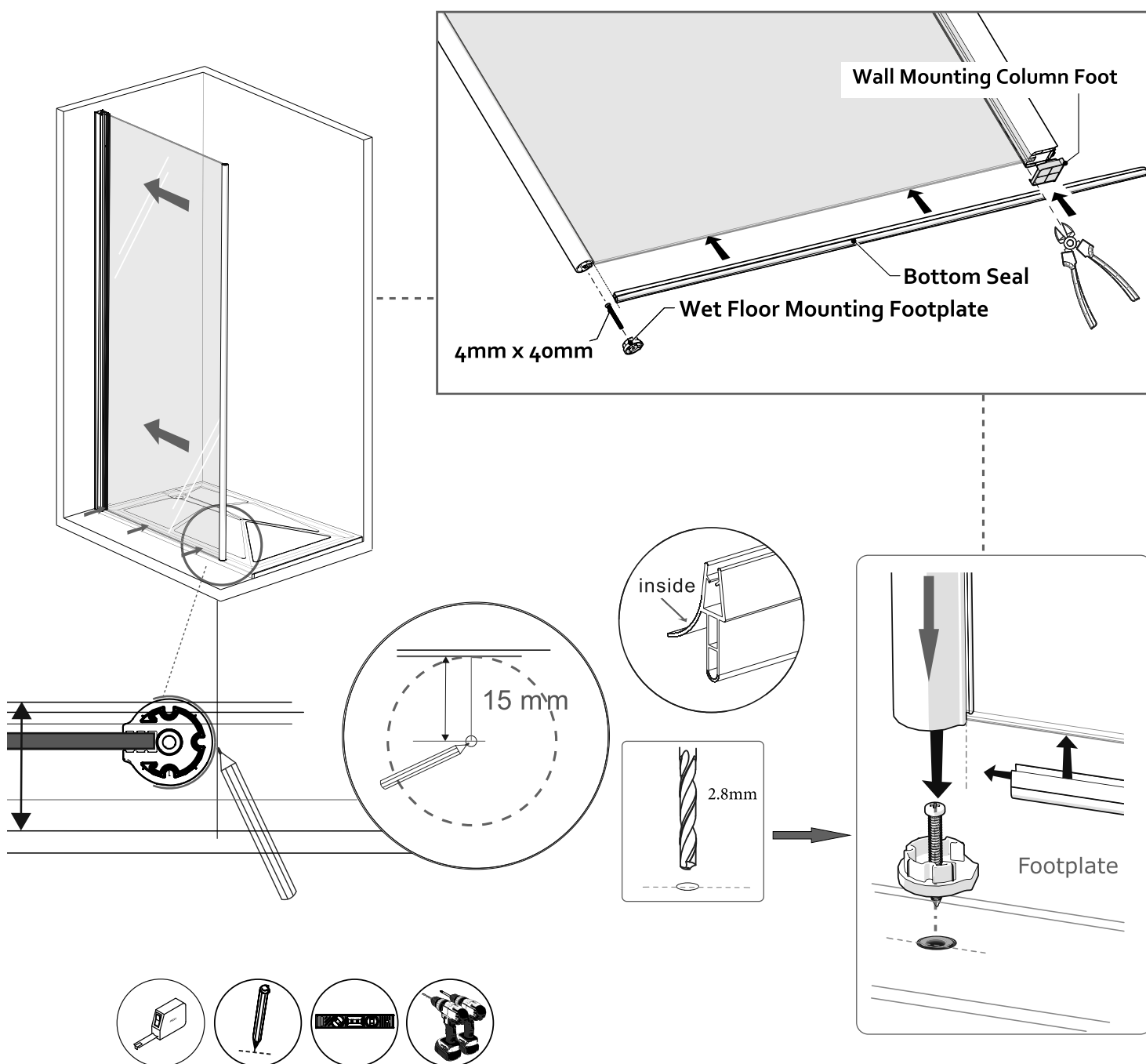

Note: for tray installation ensure the screen is towards the inside edge of the shower tray.

## Installing the bottom post block footplate onto wetroom/tiled flooring

Remove the screen from the wall compensator to install the footplate and rubber gasket seal before securing onto the wall. Ensure the wall mounting column foot is in place. Attach the bottom water seal to the glass screen and ensure the lip is on the inside of the shower enclosure before cutting to length.

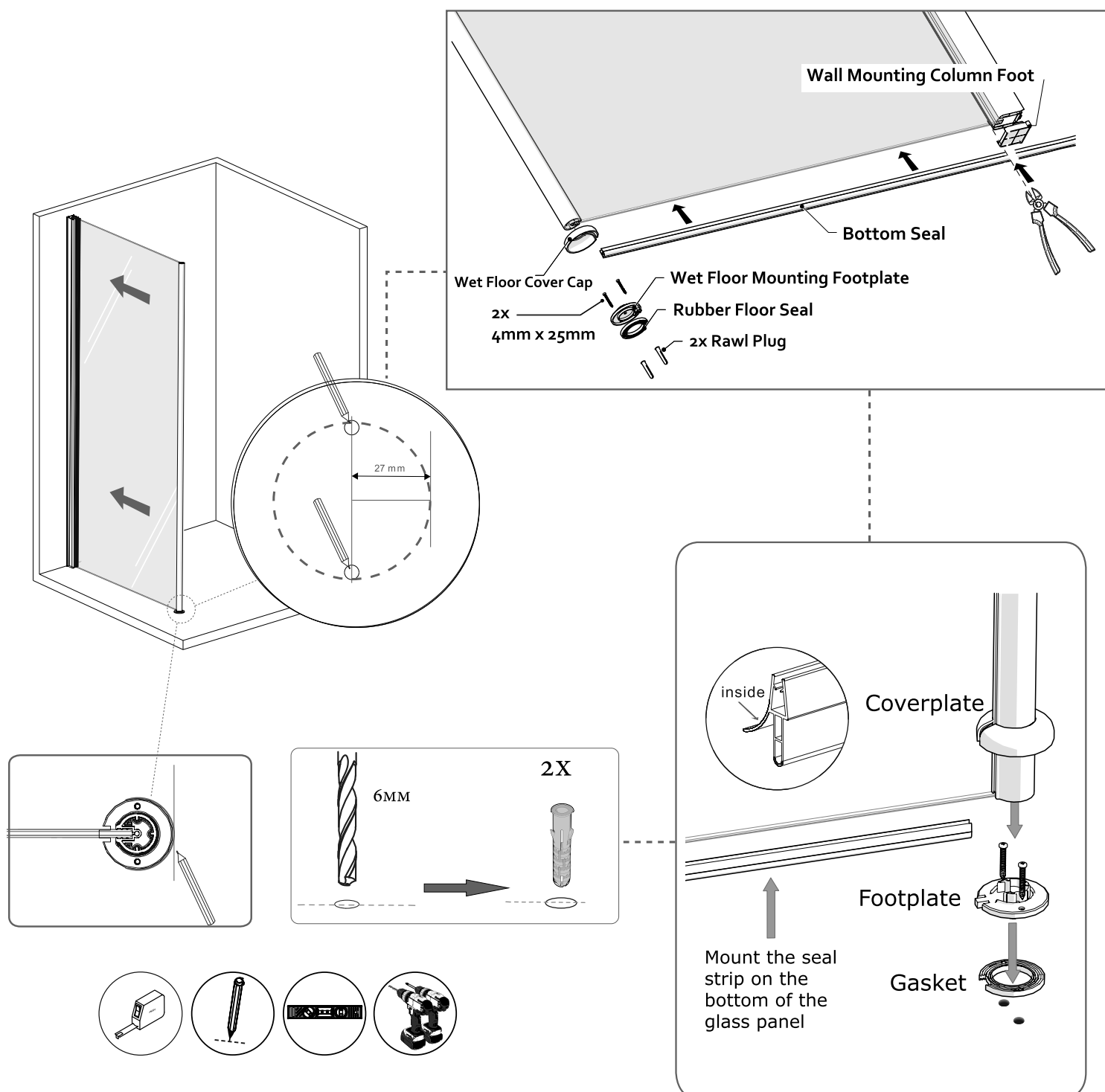

## Step 3 Install the level best screen into the wall profile

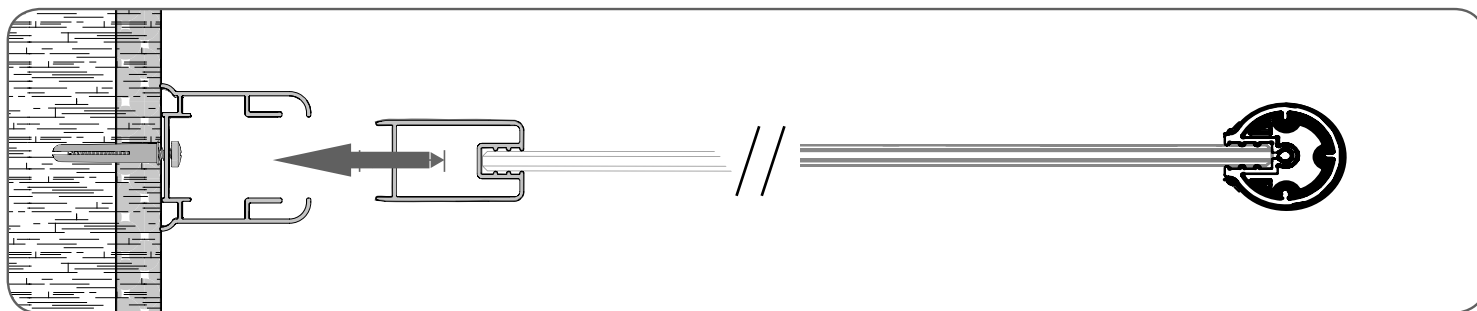

(1) When the panel is aligned into wall profile compensator and on the footplate post block, drill through the 2 slot holes at its longest position and hold the panel with the 4mmx10mm (top & Bottom).

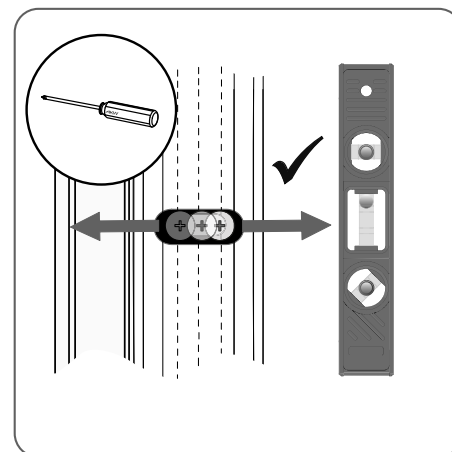
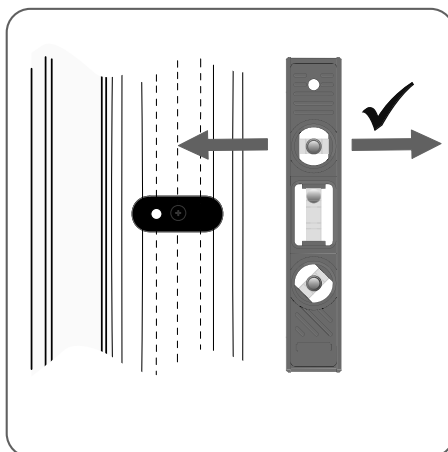
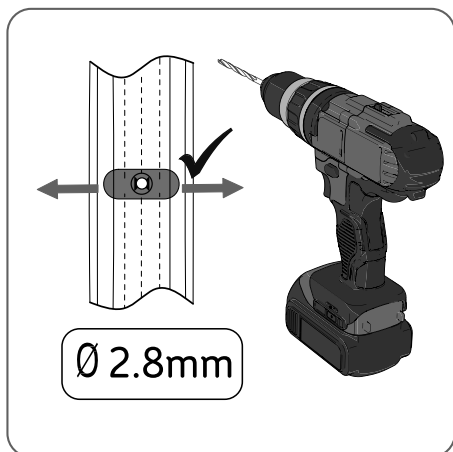

(2) Ensure the screen panel is level and in its final position before tightening the screws.

## Step 4 Wall brace rod and pivot socket installation

Mark out the position of pivot socket on the wall, make sure it is level and at 90 degrees to the screen face. Attach the tie bar socket to the top of the screen. Insert the wall brace rod into the tie bar socket using the 4x45mm screw and secure to the top of the screen.

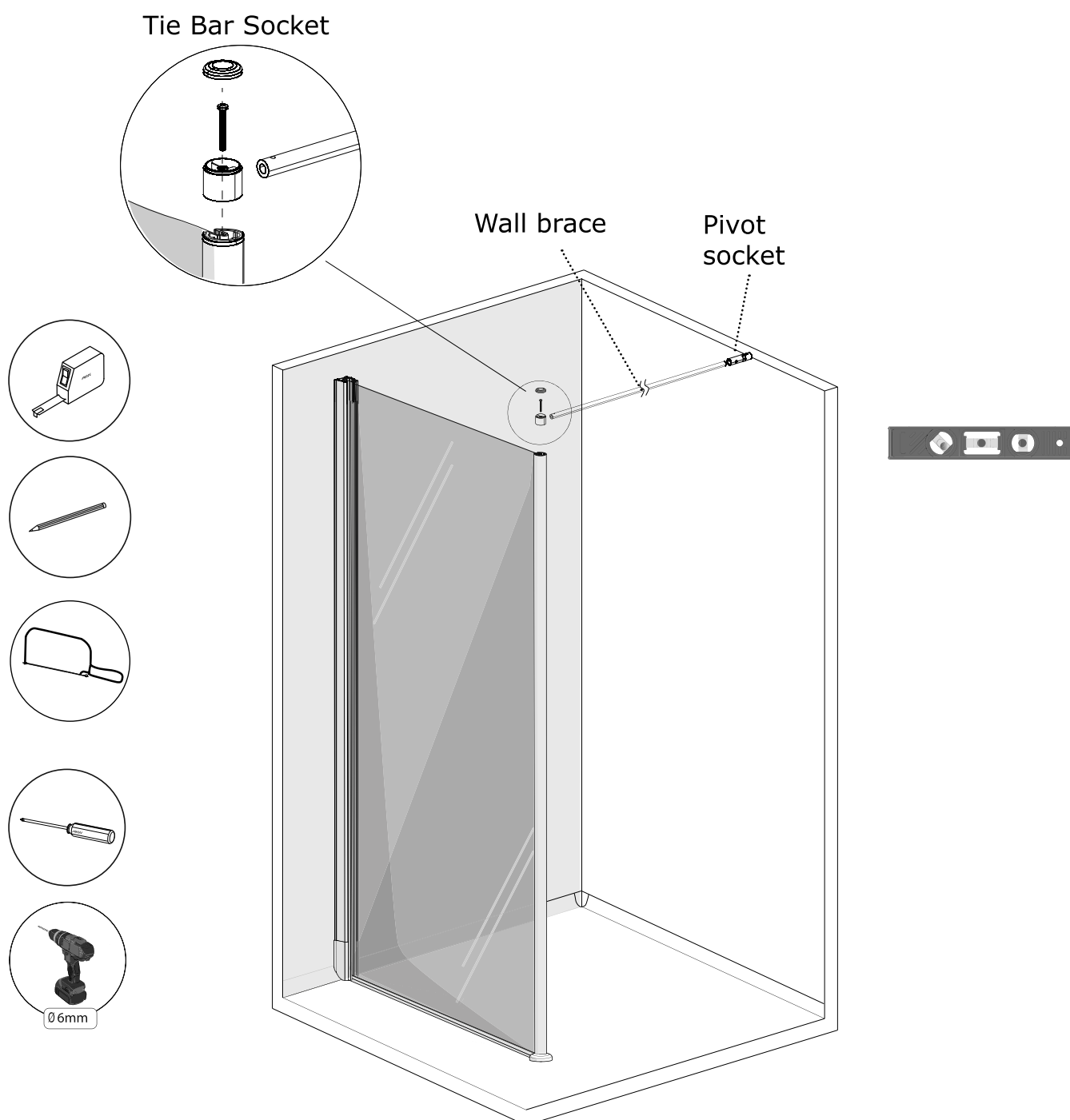

## Wall brace rod and pivot socket installation

1. Measure the distance between pivot socket and the tie bar socket and cut tie bar to length.
2. Insert the wall brace rod into the pivot socket.
3. Drill and fix the pivot socket bracket to the wall using a wall plug and 4mmx45mm screw.

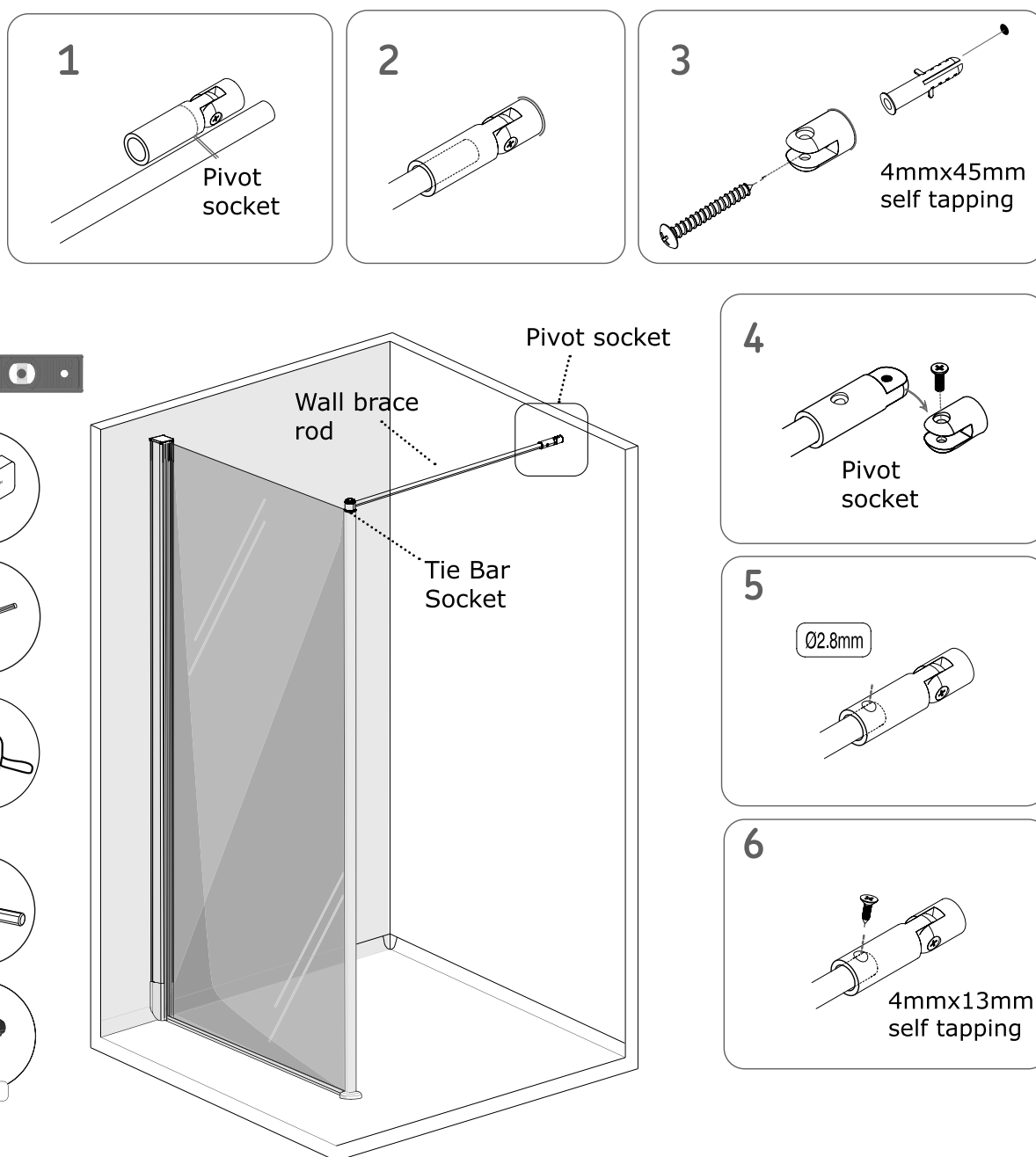

4. Re-assemble the pivot socket and screw together.
5. Drill a hole through the socket into the wall brace rod for the locking screw.
6. Secure the wall brace rod into the socket with the self tapping 4mmx13mm screw.



## Step 5 Final Installation

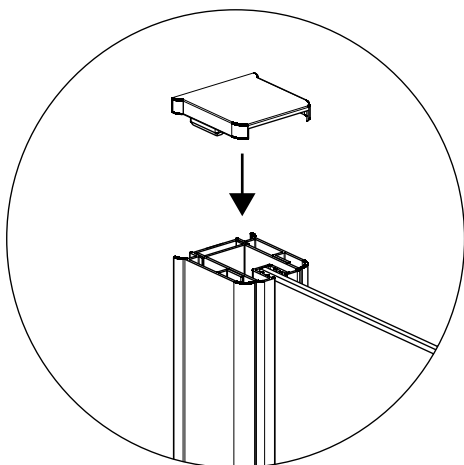

**i** Clip on profile and panel cover caps

**i** Screw cap covers

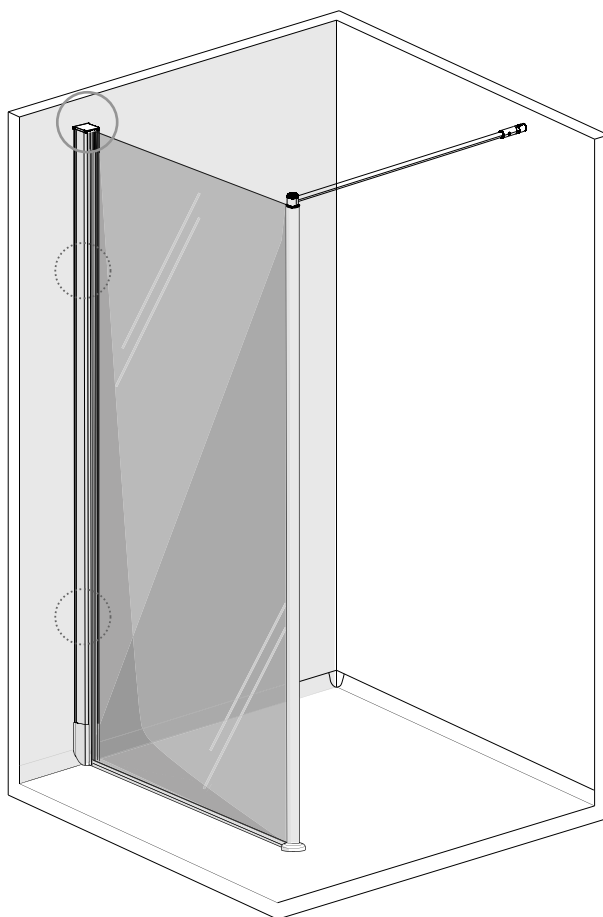
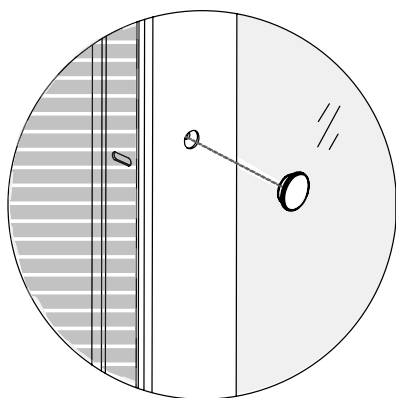

Finally check the levels and operation.

## Seal Shower Enclosure

Use a quality silicone sealant and applicator gun to the finished enclosure.

### Sealing internally

Seal all vertical joints between profile and wall. Do not seal horizontally.

### Sealing externally

Seal horizontally along the wall profile and vertically 50mm up the wall.

Allow 24hrs to dry after sealing.  
Do not use the shower enclosure until it is sealed as instructed.

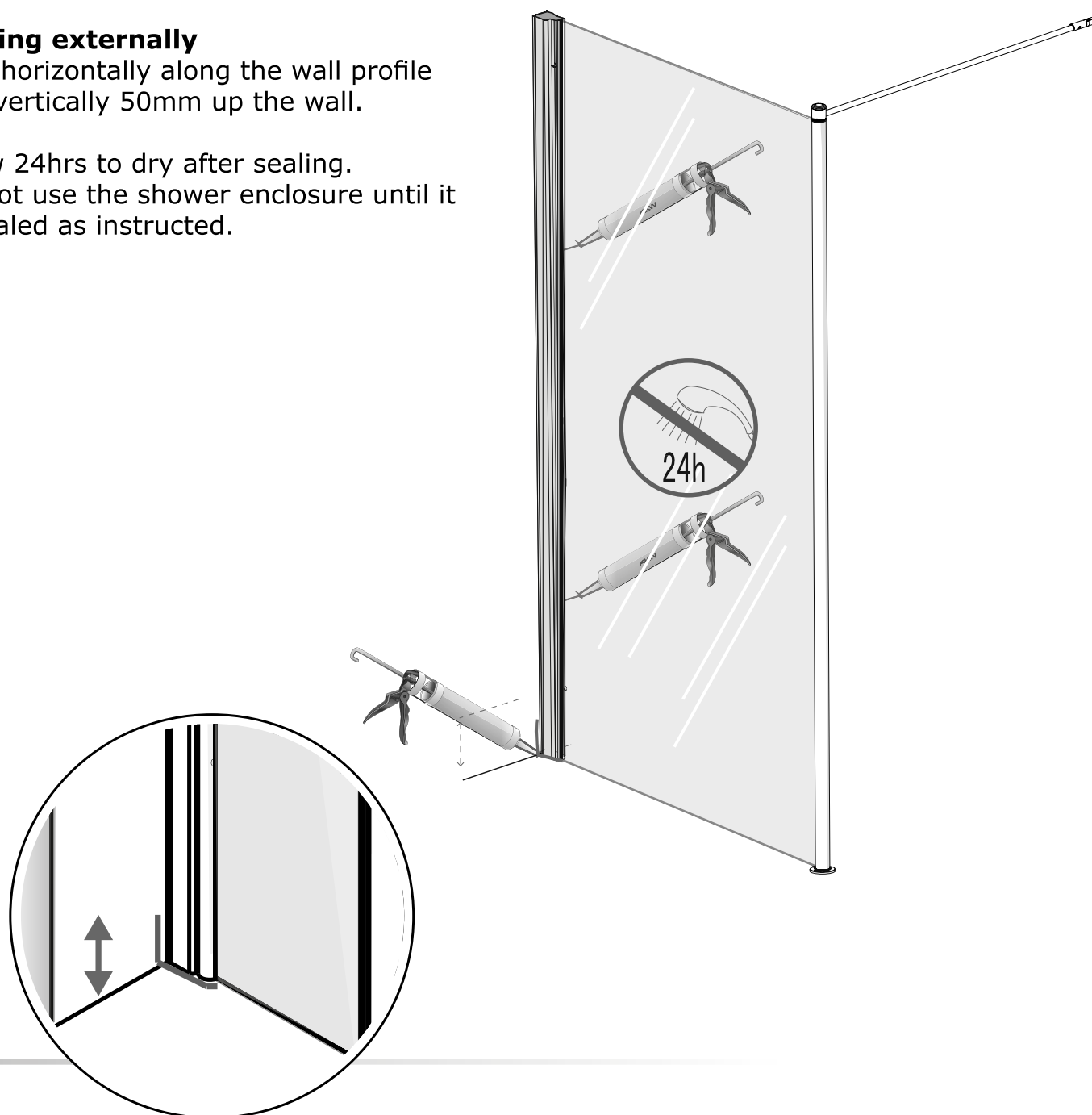

## Aftercare

Level Best Glass Screens should be cleaned regularly using normal domestic bathroom cleaning materials. It is important to clean areas such as seals and keep moving parts clear from build up of grime and water deposits to maintain good working order.

Do not use abrasive products, cloths, strong or concentrated acidic or alkaline cleaning materials as these may discolour or otherwise damage the product. Always read manufactures cleaning guidelines before using any cleaning products.

The use of strong or concentrated acidic, alkaline, chlorine or other cleaning materials will invalidate any warranty as this may discolor or otherwise damage the products.

We recommend cleaning regime and either increase or decrease it as required.

- Regularly rinse off soap and water deposits and dry the surface using a squeegee or a soft cloth if required.
- Clean glass panels weekly (depending on usage and hardness of water).
- Alternatively, clean the panel with a non-abrasive daily cleaner and rinse with copious amounts of water and wipe dry with a soft non-abrasive cloth.

**Do not** use abrasive products, cloths, strong or concentrated acidic, alkaline, chlorine or other abrasive cleaning materials as these may discolour or otherwise damage the product and will invalidate any warranty.

## Warranty information



Glass Screens are covered by a life time guarantee.

\* The guarantee applies only to manufacturing or material defects and does not apply to:

- Normal wear and tear, inappropriate use or accidental damage.
- Damage or defects that result from incorrect installation, improper use, accidental damage or lack of maintenance including the build up of grime, dirt or lime-scale and water-borne debris.
- Damage resulting from inappropriate cleaning or water ingress.
- Damage or defects that result from repairs, modifications undertaken by unauthorised persons who are not installers or service engineers.

AKW products should be installed by an experienced and competent installer or trades persons using appropriate fixings suitable for the condition of the surfaces on which the product is to be attached.

The selection of any specific fixings must be made by the installer based upon the requirements for each individual installation.

If you do not install AKW product in accordance with the supplied instructions or if you carry out any unauthorised modifications to this product then you will affect product safety and invalidate this guarantee.

For further information latest AKW product news please visit our website or scan this QR code with your device.



Technical Help line

+44 (0) 1905 560219

Orderline

+44 (0) 1905 823299

General Enquiries

+44 (0) 1905 823298

Fax

+44 (0) 1905 823297

Website

[www.akw-ltd.co.uk](http://www.akw-ltd.co.uk)

Quotes & orders email

[orders@akw-ltd.co.uk](mailto:orders@akw-ltd.co.uk)

Enquiries email

[sales@akw-ltd.co.uk](mailto:sales@akw-ltd.co.uk)

[technicalenquiries@akw-ltd.co.uk](mailto:technicalenquiries@akw-ltd.co.uk)

Postal address

AKW, Pointon Way,  
Hampton Lovett,  
Droitwich Spa,  
WR9 0LR

### What to do if something goes wrong?

In the unlikely event that you should encounter a problem with this product, please contact your local installer and if this does not resolve the issue then contact AKW technical team who will provide further advice and if necessary arrange for a maintenance engineers to visit and report any issues.

As part of our quality and training programme calls may be monitored or recorded. None of the foregoing affects your statutory rights.

These instructions are provided to advise the minimum standards of installation and recommends what is the best practice for the installation. Due to the very wide variability of possible installation conditions AKW cannot provide all circumstances for the installation. AKW cannot accept any liability in connection with this information or its use. This information is provided on the condition that the person receiving it shall make their own tests to determine the suitability for their particular purpose. Failure to install this AKW product in accordance with supplied instructions or the making of unauthorised modifications will invalidate any warranty and may affect product safety. None of the foregoing affects your statutory rights.