

iSure Electric Shower

INSTRUCTIONS

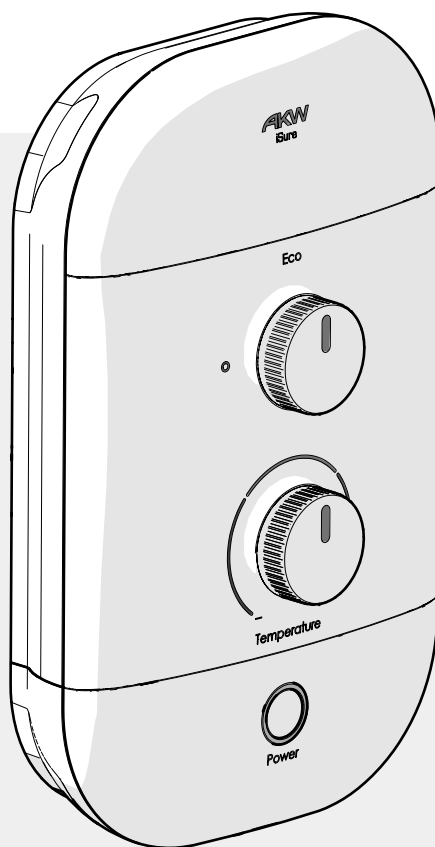

Stock code
8.5 kW - **30309**
9.5 kW - **30310**

Please read all instructions before installation and leave this document with the end user for future reference as it contains important warranty information

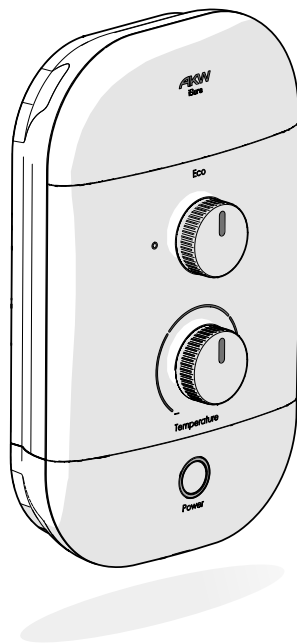
**Eco Setting**

Reduced power setting

Power Button

Push button on off retains user preferred power and temperature settings

Flexible Installation

6 cable entry points

8 water entry points

Dual power blocks for left or right wiring

Fitting plate retro-fit footprint - Optional Extra

User	4-7
Safety Information	4
Operating Instructions	5
Troubleshooting	6
Filter Cleaning.....	7
 Installer	 8-15
Main Components	8
Specifications	9
Installation Requirements	10
Disassembly	11
Fitting to wall - With Fitting Plate (Optional Extra)	12
Fitting to wall - Without Fitting Plate	13
Reassembly - Bottom Cover	14
Reassembly - Front Cover	15
 Plumbing	 16-17
 Electrical	 18-19

Failure to install this AKW product in accordance with supplied instructions or the making of unauthorised modifications will invalidate any warranty and may affect product safety.

AKW does not accept any liability in connection with this information or its use. This information is provided on the condition that the installer determines its suitability for each case. None of the foregoing affects your statutory rights.

This appliance can be used by any persons with reduced physical, sensory or mental capabilities or lack of experience and knowledge of showering, if they have been given supervision or instruction concerning the use of the appliance in a safe way and understand the hazards involved. Children must not play with the appliance. Cleaning and user maintenance shall not be made by children without supervision.

Do not operate shower if you suspect the water in the heater tank is frozen or the appliance has been exposed to freezing conditions.

Do not operate the shower if the spray handset or hose is damaged or blocked.

Cleaning Recommendations

Always isolate power supply before cleaning.
Clean and descale the shower head regularly.

The shower unit and surrounding areas should be cleaned periodically to remove any accumulation of dirt or other waste materials, using domestic bathroom and kitchen cleaning materials with a soft cloth.

Do not use abrasive pads or cloths. Do not use strong or concentrated acidic, alkaline or other cleaning materials as these may damage or discolour the product.

After cleaning always wash down with water then wipe thoroughly with a damp soft cloth to remove any cleaning material residue.

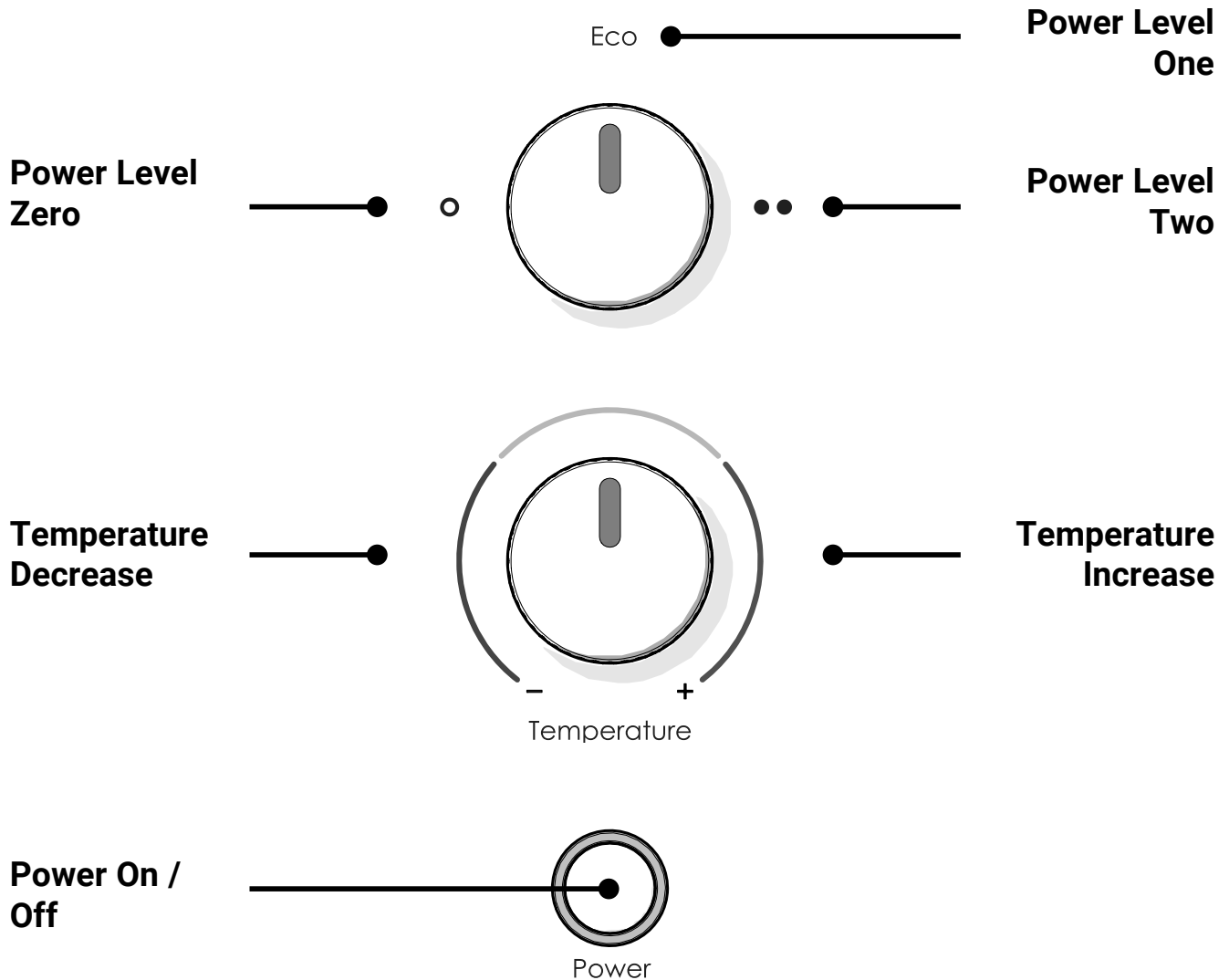

Starting the Shower

Switch on the mains power at the isolating switch.

To toggle the On/Off state press and release the Power button.

The Temperature and Power Level are indicated on their respective controls.

Temperature Setting

Note: Increasing Temperature setting reduces flow rate.

Changes in the water temperature may take a few seconds to reach the handset.

Read and understand the user guide before commencing troubleshooting.

Fault	Possible Cause	Remedy
No Water Flow	Water isolating valve in off position	Turn on isolating valve
	Filter blocked	Isolate water supply, remove filter and clean
	Isolating switch not on	Turn on isolating switch
Water temperature too hot	Insufficient water flowing through the shower	Clean the handset. Increase the flow by adjusting the temperature control knob to cooler setting
Shower runs too hot and cold during use	Water pressure is below minimum requirement. This may be caused by other appliances on the same pipework drawing water	Check running pressure (minimum of 0.7 bar) Wait until pressure increases
Shower temperature cycles between hot and cold	Shower temperature is set too high causing the thermal cut out to turn off heating elements to reduce the water temperature	Turn shower temperature control anticlockwise to reduce the water temperature
Water from pressure relief outlet - PRD activated	Non-product issue: Obstruction in hose or handset	Contact AKW Technical Enquiries (See back page)

This should be done only if you suspect reduced flow rate or water hardness build up.

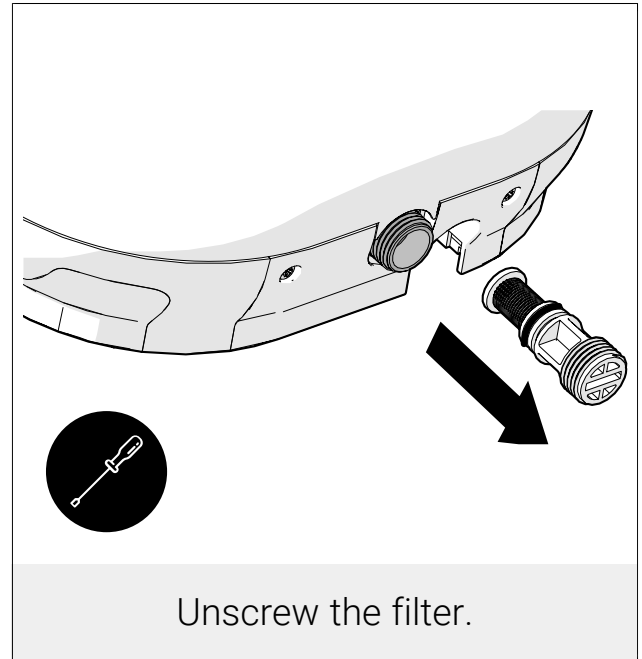
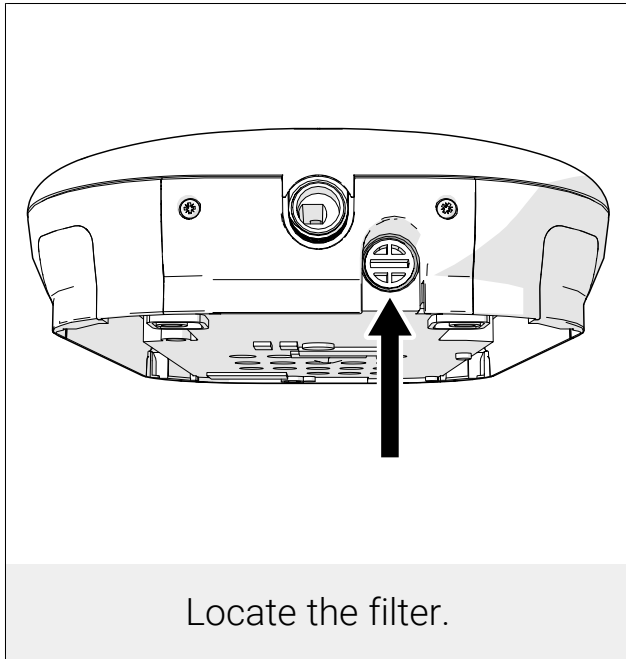

Ensure that the electrical supply is switched off at the mains.

Ensure that the water supply is turned off.

Using a flat head screwdriver, unscrew the filter.

Rinse the filter in water and once this is clean then return to the inlet housing.

Main Components

MAIN COMPONENTS

3x M4 Screws with Spring Washer

Stock Code: 21-005-326

Fitting Plate (Optional Extra)

Back Case

Front Cover

2x Front Cover Screws

3x Wall Screws

3x Wall Plugs

Fixings

Back Case - Components and Features

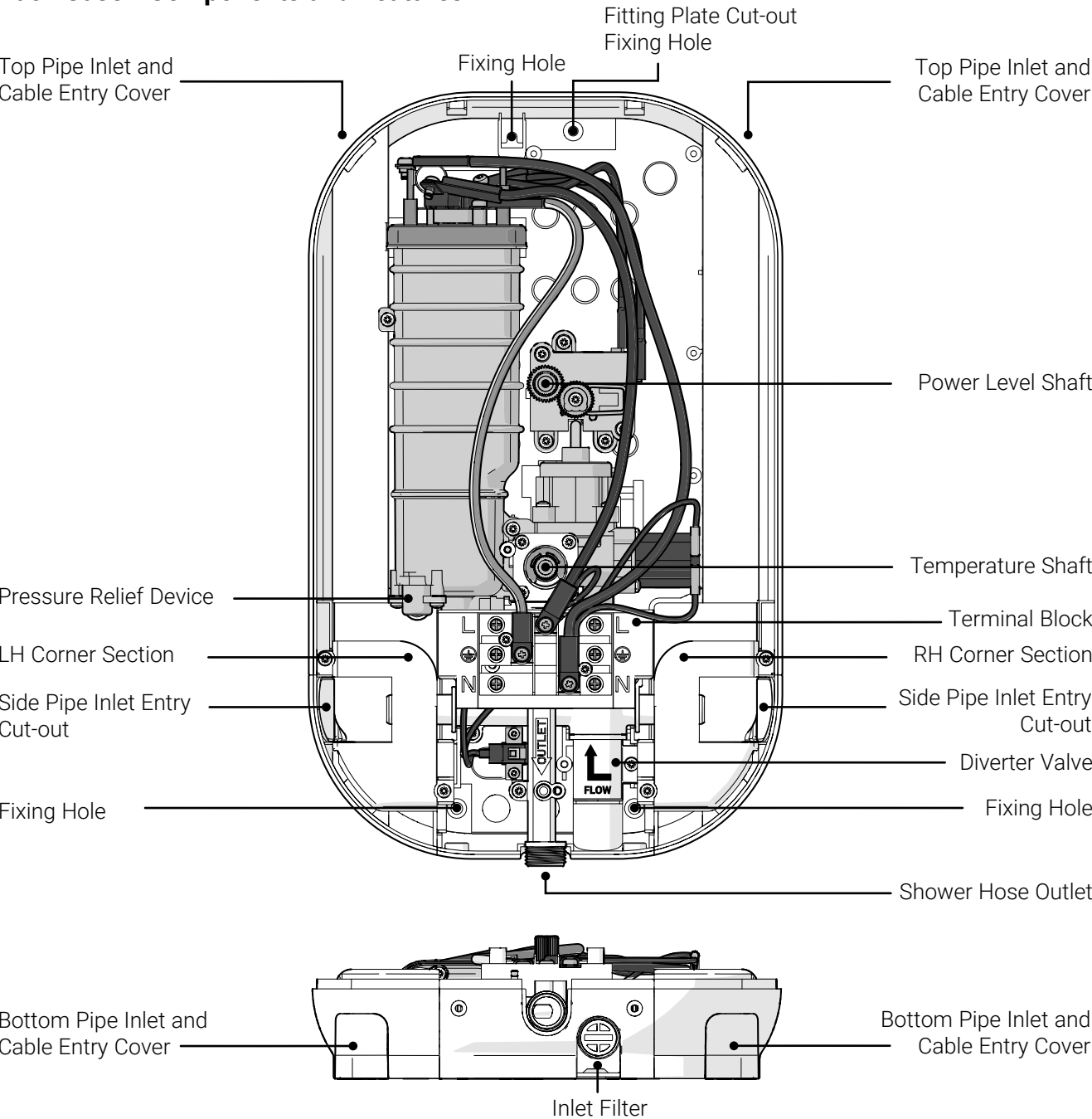

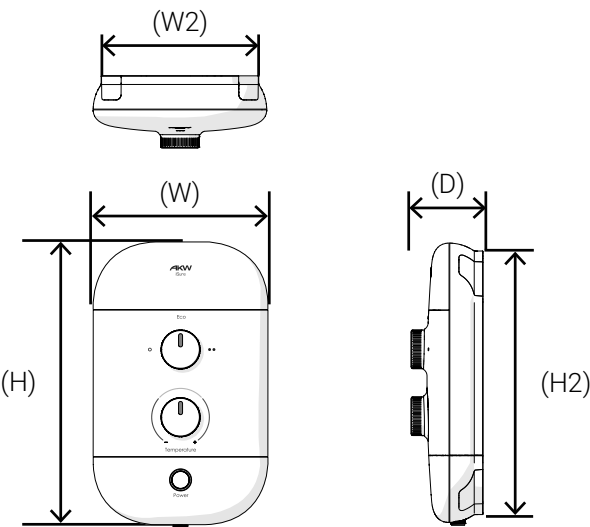

PLUMBING SUPPLY	Supply Source	Mains pressure cold water only
	Minimum Dynamic Pressure	70 kPa (0.7 Bar)
	Recommended Minimum Dynamic Pressure	100 kPa (1 Bar)
	Maximum Static Pressure	1000 kPa (10 Bar)
	Maximum Inlet Temperature	28°C
	Minimum Inlet Temperature	3°C
	Inlet Connection	15 mm pipe
	Outlet Connection	1/2" BSP Male Thread Fitting
ELECTRICITY SUPPLY	Nominal Rating at 240 V	9.5 kW & 8.5 kW
	Supply Fuse / Circuit Breaker	(9.5 kW 40/45 A) & (8.5 kW 35/40 A)
	Residual Current Device (RCD)	30 mA (must be fitted)
	Supply Cable	Refer to current wiring regulations and BS 7671 to determine minimum cable size. No larger than 10 mm ²
	Isolation Switch (e.g. Pull Cord)	50 Amp Double Pole with 3 mm contact separation.
PHYSICAL	Height	(H) 388 mm
	Width	(W) 240 mm
	Depth	(D) 100 mm
	Footprint Height	(H2) 365 mm
	Footprint Width	(W2) 218 mm
	Water Ingress Rating	IPX4
	Cable Entry Points	6 - Top, bottom or rear.
	Water Entry Points	8 - Top, bottom, rear or side.

ACCREDITATIONS & CERTIFICATIONS



Installation Requirements

The shower must be connected only to the mains cold water supply.

DO

- Mount on a finished flat, waterproof surface.
- Position the shower unit vertically.
- Ensure that the shower unit is positioned over a bath, shower tray, or wet floor.
- Direct the shower head away from the shower unit. During normal use the shower head must not spray directly on to the shower unit.

DO NOT

- Use a shower handset with an integrated on/off button or switch.
- Block, restrict or connect the water outlet pipe to any parts other than those AKW specifically state for use with this electric shower, as it acts as a vent.
- Position the shower where it will be subjected to freezing conditions.
- Tile up to the shower unit.
- Seal the shower to the wall with silicone or other sealant.
- Use fittings which cannot be removed.

Before you start work:

Check that there are no pipes or electrical cables inside the wall before drilling. Check for cracks or loose tiles or grout. Make sure that all surfaces are clean, dry and free from loose debris or dust.

This product is not suitable for mounting into steam rooms or steam cubicles.

Note - If it is intended to operate the shower in areas of hard water (above 200 ppm temporary hardness), a scale inhibitor may have to be fitted.



Ensure that the electrical supply is switched off at the mains.
Ensure that the water supply is turned off.

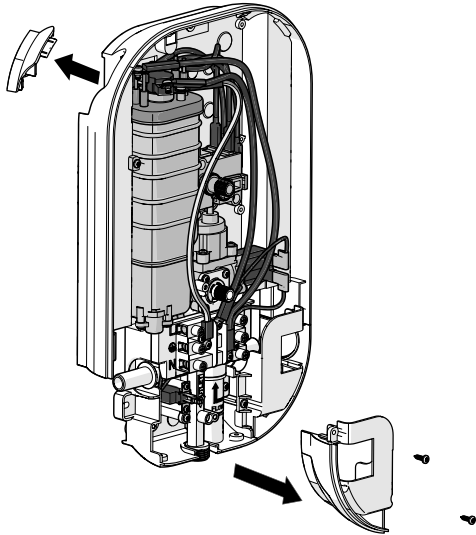

Remove desired entry covers
and corner section.

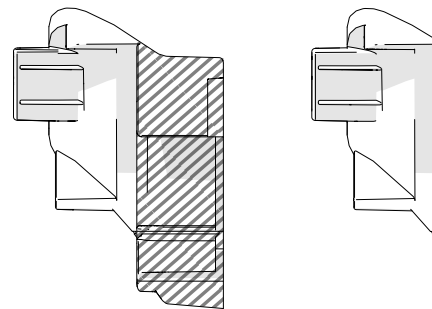
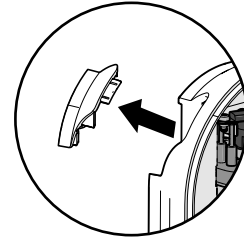

If using 25 x 16 cable trunking, cut out the
area shown.

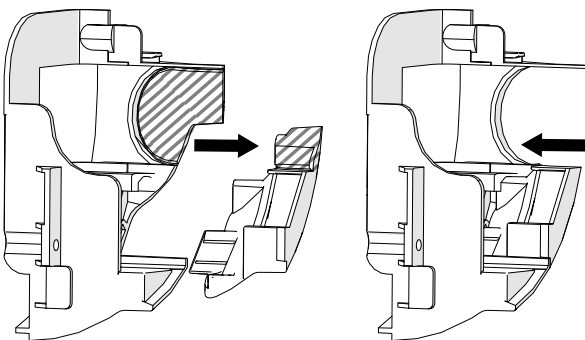
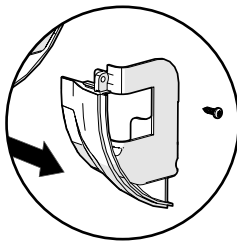

If using side pipe entry, cut out the area on
the two parts shown.

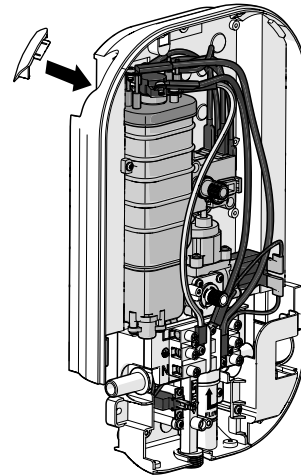

Reinsert the cover shown before mounting
to the wall. Leave the corner section to one
side until pipe installation is complete.

Fitting to Wall - With Fitting Plate (Optional Extra)



The Fitting Plate is an option if you cannot drill into certain areas due to existing pipes or cables in/on the wall. You can also use this if you want to use existing screw positions from an existing shower. This is not supplied with the shower but is available as an optional extra. This can be ordered by referencing stock code: 21-005-326.

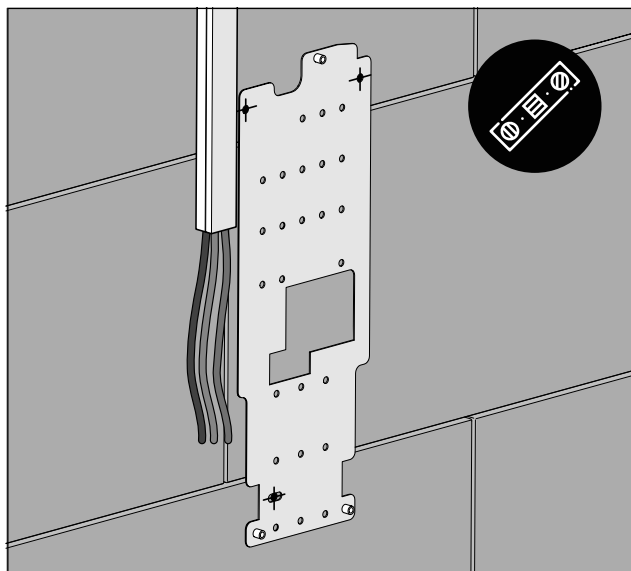

Ensure the plate is level and mark a minimum of 3 out of the 28 available fixing points on the wall. Note: the 3 marked holes match AKW electric showers within the stock code range 29010 to 29092.

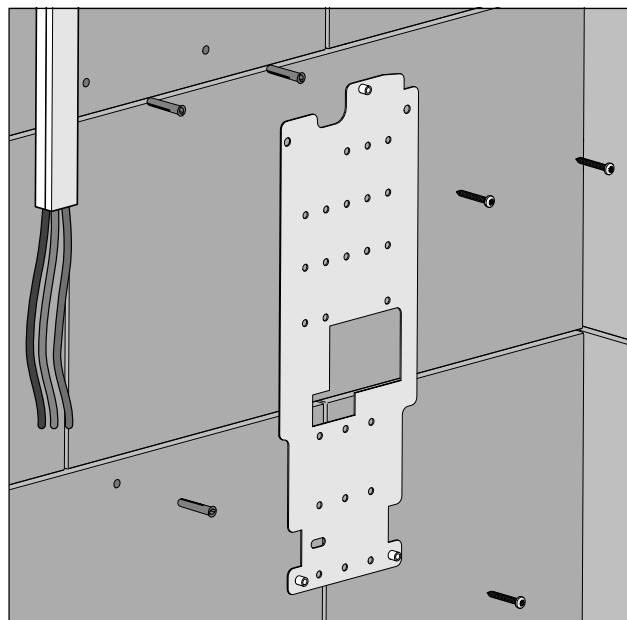

Before drilling, check for any buried cables or pipework. Drill, insert wall plugs and screw to wall.

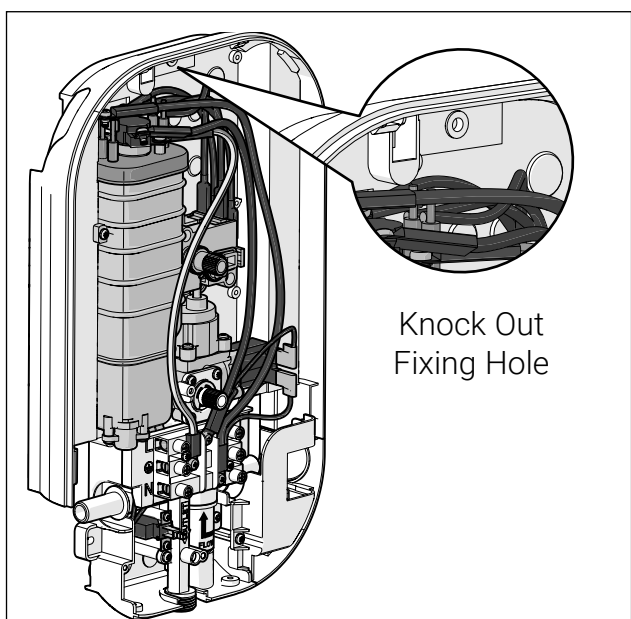

Knock Out
Fixing Hole

Knock out the fixing hole at the top of the back case with a screwdriver.

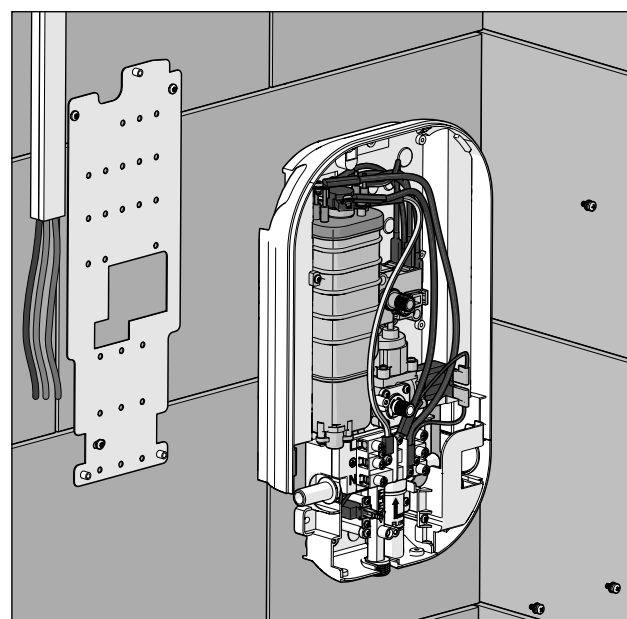

Screw back case to plate using the provided 3x M4 machine screws with spring washer.

Fitting to Wall - Without Fitting Plate

13



It is essential to remove any debris and/or brick dust that could otherwise damage the unit. Do not drill any alternative holes in the case – as this may compromise safety and will invalidate the warranty. Check for hidden cables and water pipes.

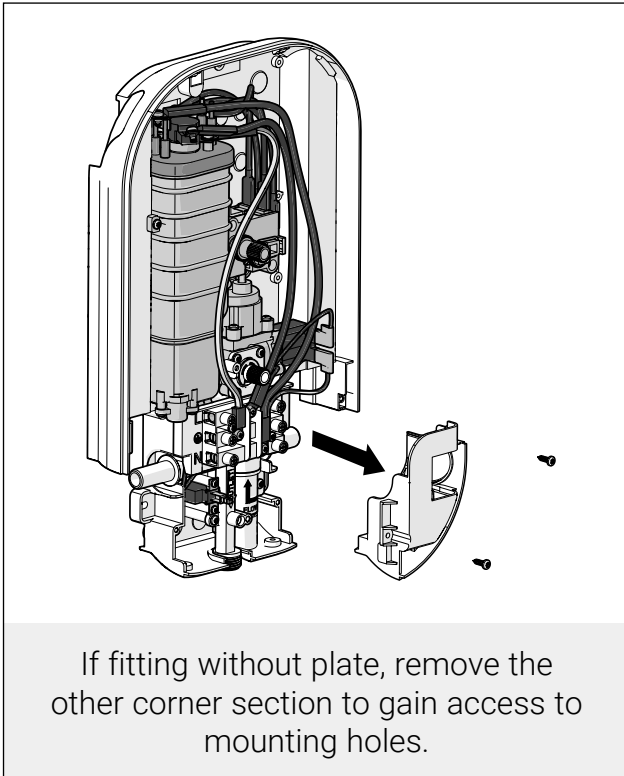

If fitting without plate, remove the other corner section to gain access to mounting holes.

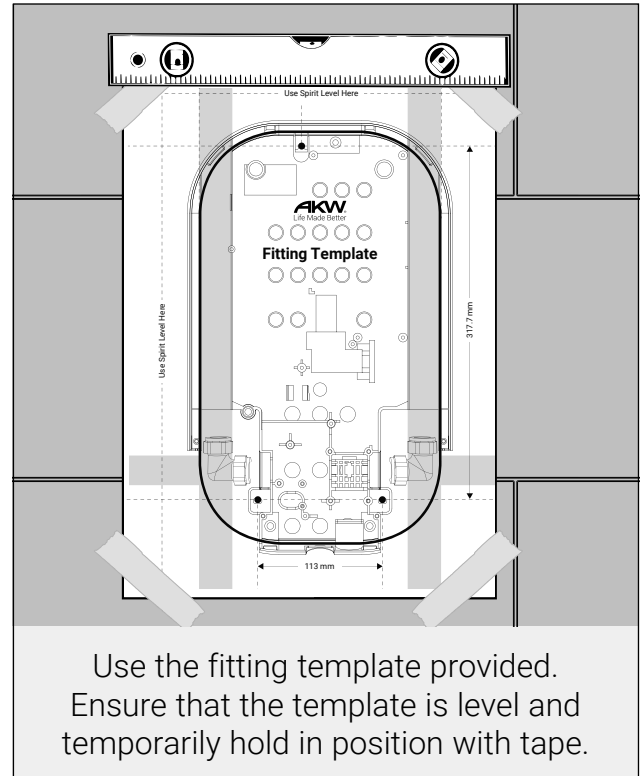

Use the fitting template provided. Ensure that the template is level and temporarily hold in position with tape.

Tip: use masking tape on tiled walls to prevent slipping and tile splintering. Always use a tile drill bit when drilling tiles.

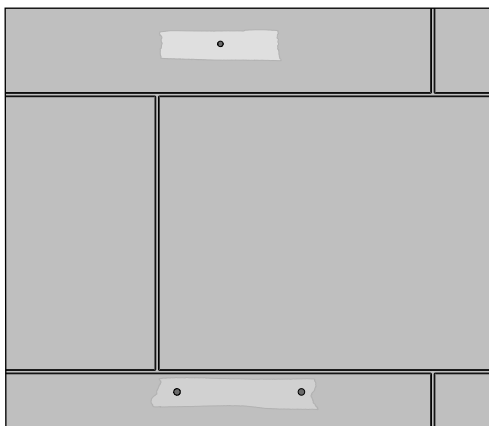

Before drilling, check for any buried cables or pipework. Remove the fitting template from the wall and drill the marked fixing points.

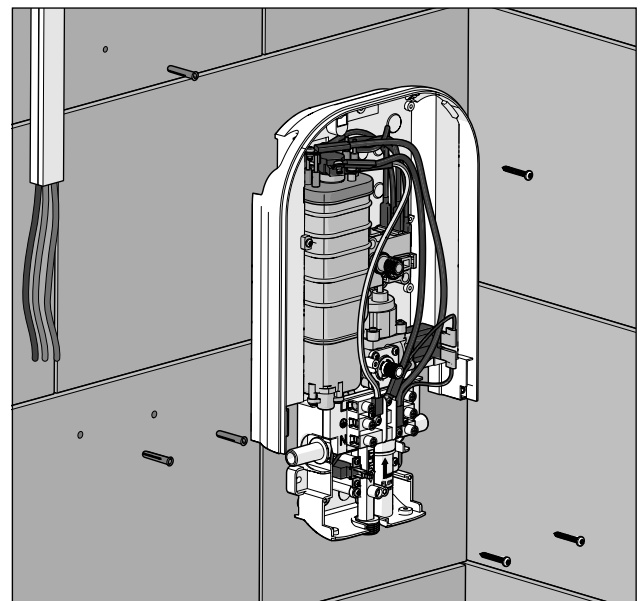

Insert wall plugs and screw the top screw to the wall first and then bottom screws should be fitted only during final installation.

Reassembly - Bottom Cover

Once the cable and pipe connections have been made, reassemble the corner section.

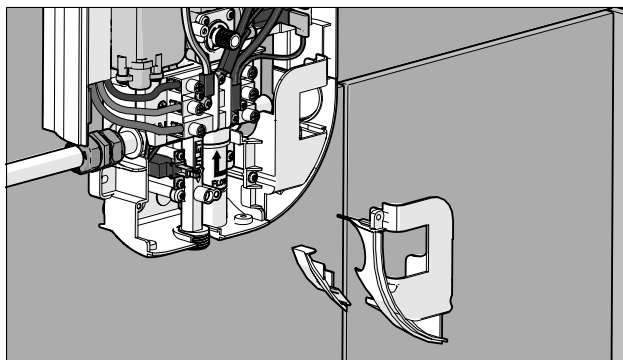

If using side entry, slide the entry covers in.

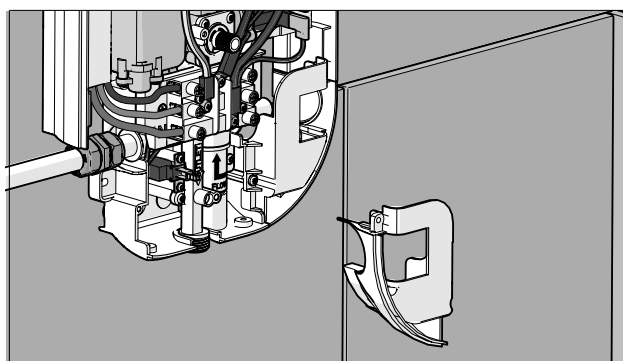

Slide the corner section in to the unit.

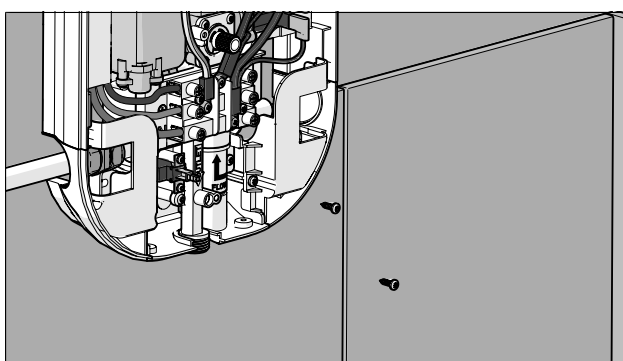

Fasten the screws holding the corner section.

Reassembly - Front Cover

15

REASSEMBLY - FRONT COVER

Refit the front cover taking care not to trap wires.

Use only the supplied screws to secure the front cover. Failure to do so may cause internal damage to the appliance.

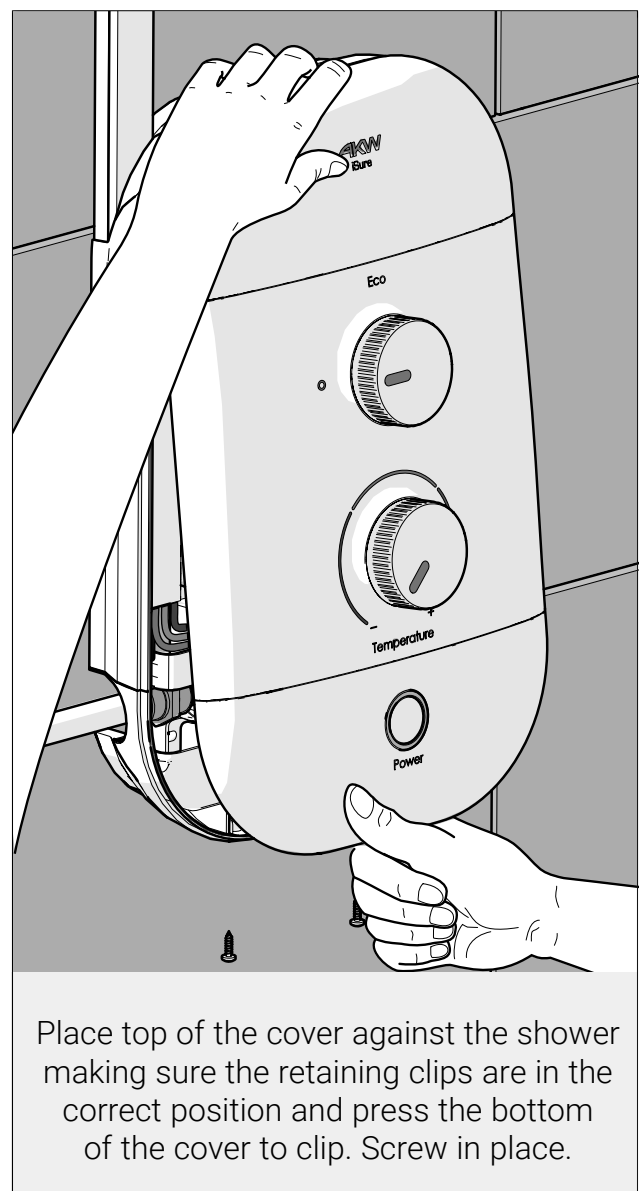
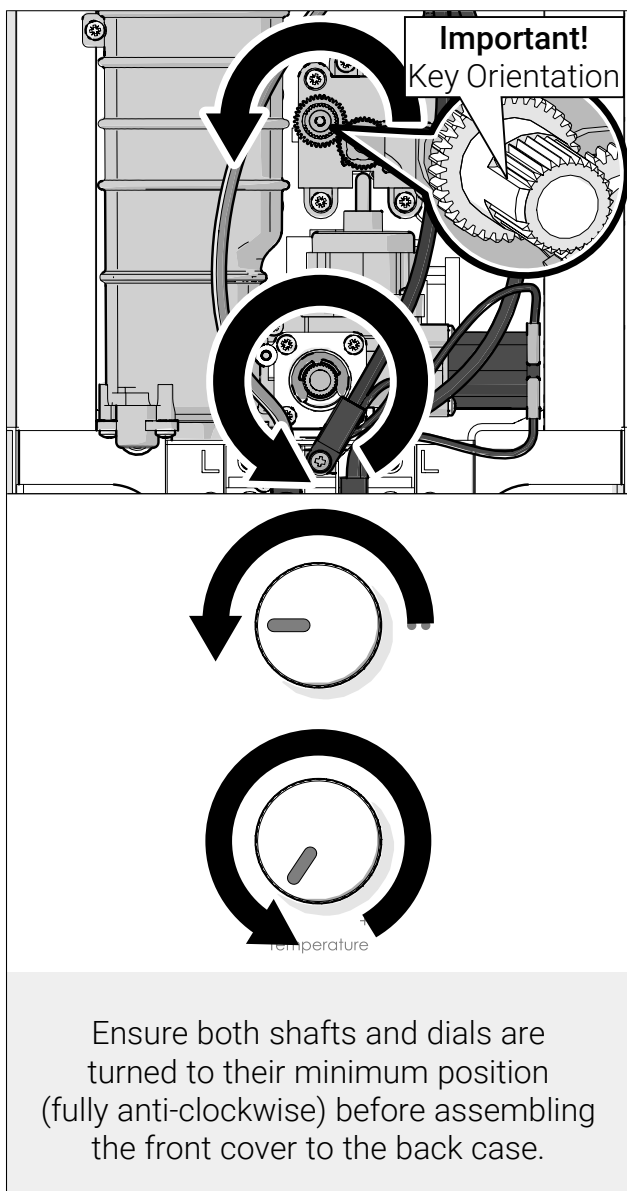

COLD WATER FEED ONLY - Never fit the appliance to the hot water supply.

There are 8 water inlet points for easy installation.

Plumbing work should be completed before any electrical connections are made.

Before assembly, flush the water supply pipes thoroughly to remove debris in the pipework (allow the water to run with the main stopcock open for about 3 mins), to prevent debris and dirt particles from blocking the filter which might affect the function of the shower.

DO NOT fit any form of outlet flow control to the water heater.

Note: An isolating stop valve must be installed on the cold water feed before connecting to the shower. The isolation valve (not supplied) should be fitted as close as is practicable to the water supply inlet of the shower heater whilst being accessible for maintenance and servicing purposes.

Determining Water Inlet Direction

Remove retaining screw and rotate diverter valve to left or right as desired. Reinsert screw to secure before connecting water supply.



Note: If valve is tight when rotating, use a flat head screwdriver under tab to free it.

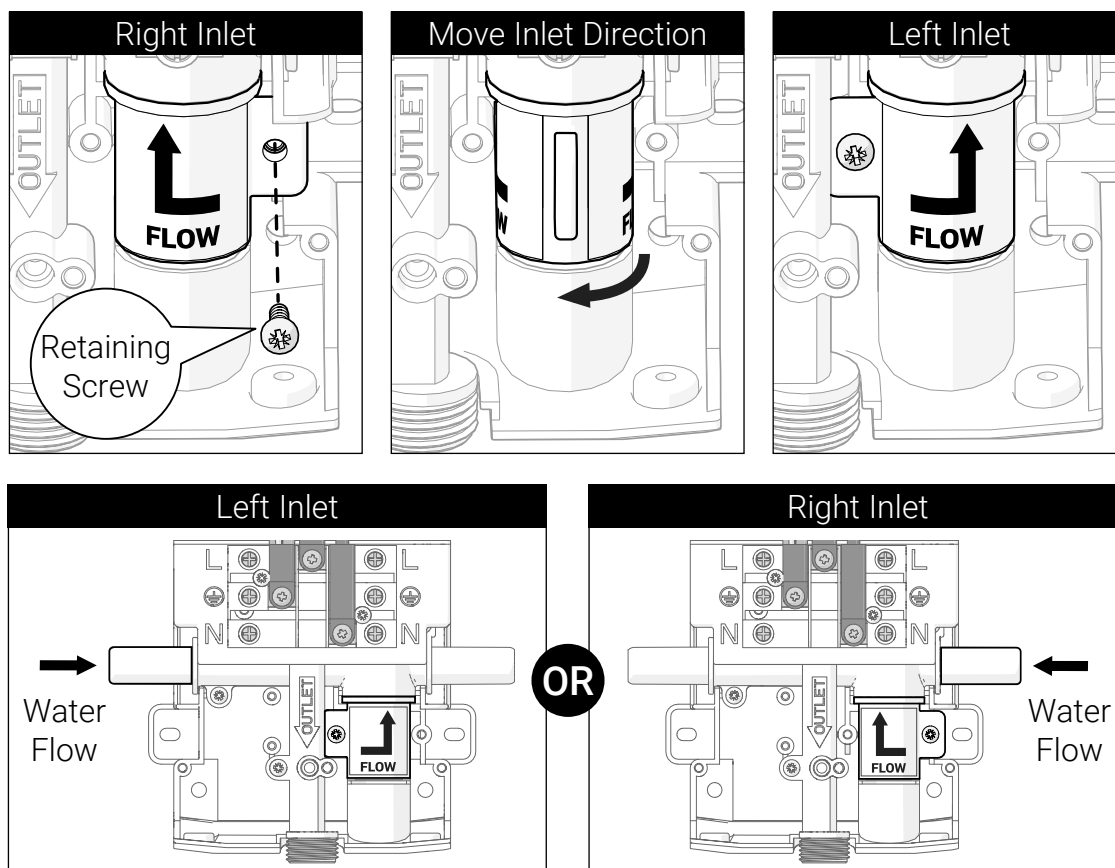

Determine pipework position and select the inlet option most suited to your situation. Always prime pipework and flush clear of debris.

Top Entry

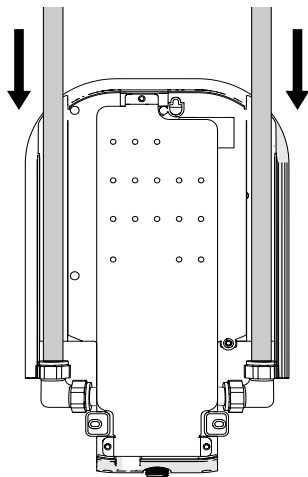

Left or right top inlet.

Bottom Entry

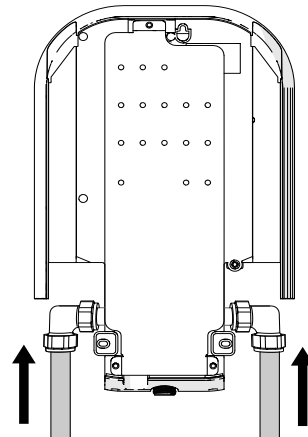

Left or right bottom inlet.

Rear Entry

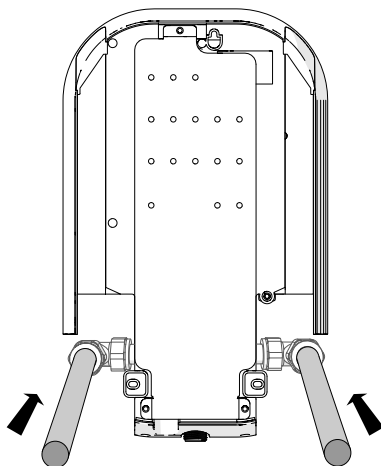

Left or right rear inlet.

Side Entry

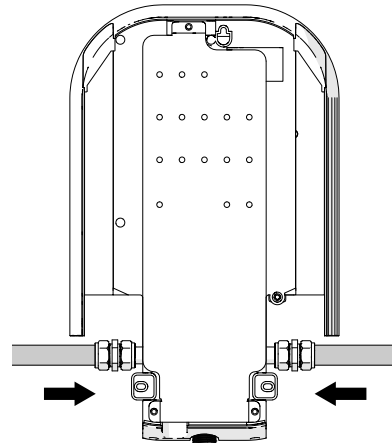

Left or right side inlet.



Caution - Danger of Death 230 V AC
Lethal Voltage present on the AC supply.

WARNING - THIS APPLIANCE MUST BE EARTHED

ALL COMPONENTS MUST BE RATED AND INSTALLED IN ACCORDANCE WITH WIRING REGULATIONS.

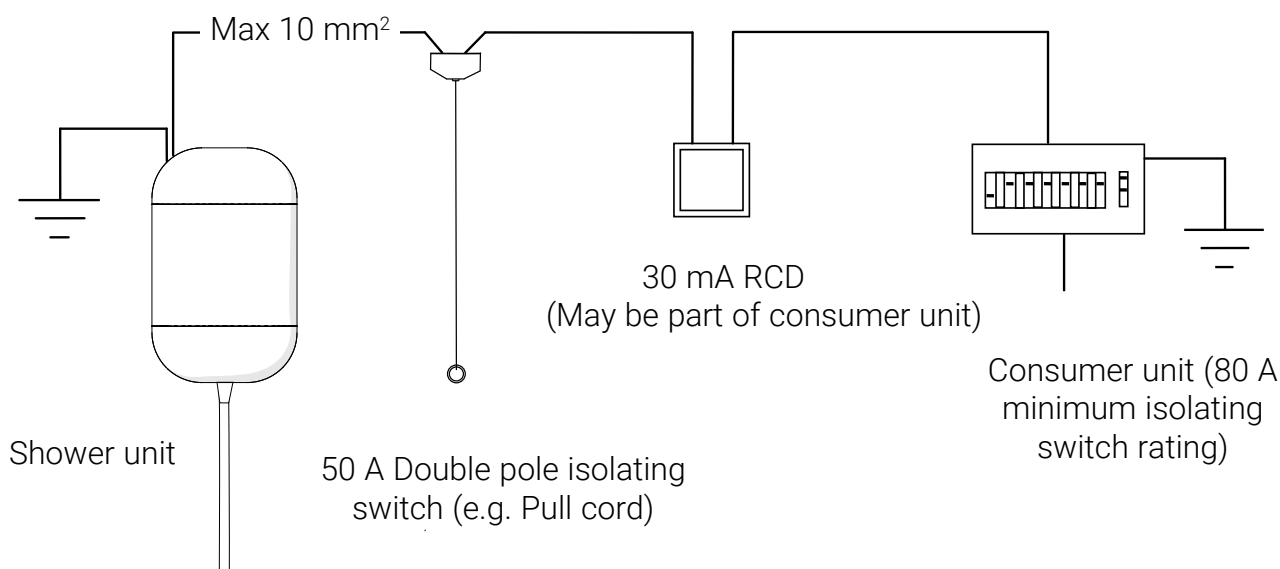

For adequate circuit protection DO NOT use a rewireable fuse. Instead use a suitably rated miniature circuit breaker or cartridge fuse.

A 30 mA residual current device (RCD) must be installed.

A 50 amp double pole isolating switch with a minimum contact gap of 3 mm in both poles must be incorporated in the circuit.

The isolating switch must have a mechanical indicator showing when the switch is in the OFF position, and the wiring must be directly connected to the switch.

The isolating switch must be accessible and clearly identifiable, although out of reach of a person using a fixed bath or shower. The cord of a cord-operated switch should be placed so that it is not possible to touch the switch body whilst standing in a bath or shower cubicle.

Where shower cubicles are located outside of a bathroom, all socket outlets in the room must be protected by a 30 mA RCD. Consult the wiring regulations.

It is recommended to use the shortest cable route possible from the consumer unit to the shower.

Determine cable position and select the inlet option most suited to your situation.

Note: Depending on cable size and entry point used, it may be necessary to strip back the outer cable sheath sufficiently to allow cables to be directed to the terminal connection block within the unit.

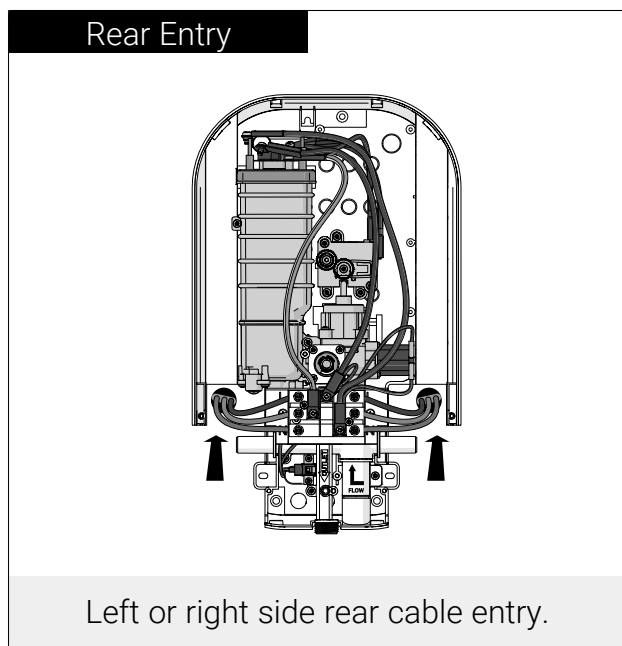
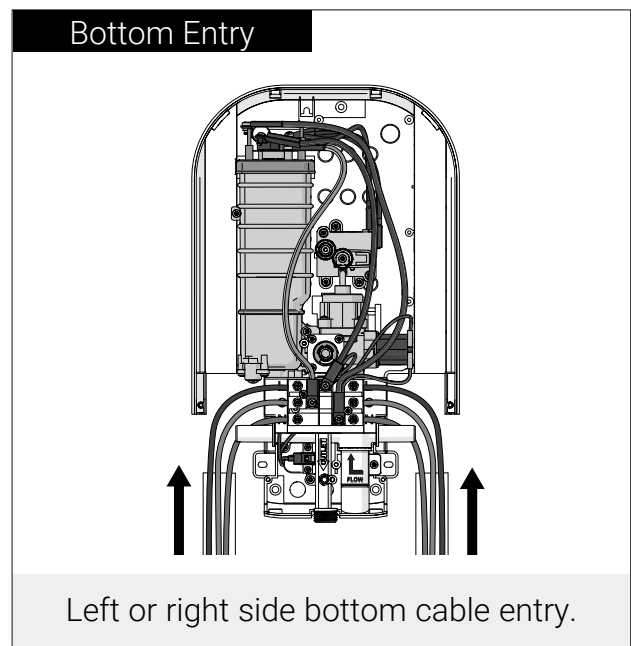
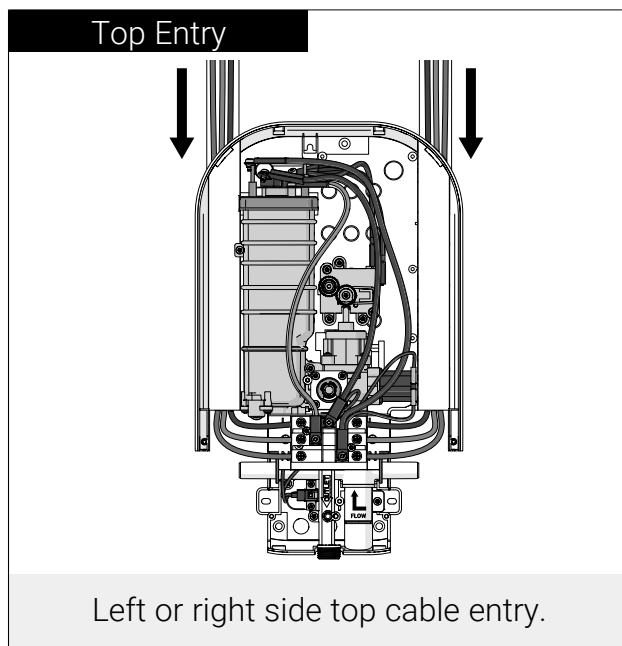

IMPORTANT - Connect to only the left OR right terminal blocks. Never make a simultaneous connection to both left and right terminal blocks.

Contact us

AKW
Life Made Better

Orders & Quotes

01905 823 299

orders@akw-ltd.co.uk

General Enquiries

01905 823 298

sales@akw-ltd.co.uk

Technical Enquiries

01905 560 219

tech@akw-ltd.co.uk

Kitchen Enquiries

01905 823 262

kitchens@akw-ltd.co.uk

Fax

01905 823 297

AKW

Pointon Way, Hampton Lovett
Droitwich Spa, WR9 0LR

www.akw-ltd.co.uk

orders.akw-ltd.co.uk

Follow us on Social:



Warranty

Warranty applies only to manufacturing or material defects, conditional on the one-time correct installation of the product. It does not apply to:

- Inappropriate use or accidental damage.
- Damage or defects that result from incorrect installation.
- Lack of maintenance including the build up of grime or damage resulting from inappropriate cleaning.
- Damage or defects that result from repairs or modifications undertaken by unauthorised persons.
- General wear and tear through usage and does not apply to surface finishes.

Warranty period starts from the date of installation.

To activate your warranty, you must register your product within 30 days of installation. See the T&Cs on our website for further information.

Select 1 of 2 ways to activate your warranty



1. Scan using your Smart Device

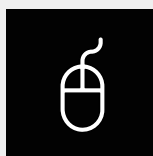

2. Visit Online

akw-ltd.co.uk/warranty-information

What to do if something goes wrong?

In the event that you encounter a problem with this product, follow the trouble shooting guide if applicable, then contact your local installer. If the issue is still unresolved, contact AKW Technical Enquiries who will provide further advice and arrange for a maintenance engineer to visit if necessary. None of the foregoing affects your statutory rights.