

CURTAIN RAILS ARE SUPPLIED OVERSIZE AND WILL NEED CUTTING TO SIZE.
PLEASE FIT CORRECT AMOUNT OF HOOKS AND GLIDERS TO RAIL BEFORE INSTALLATION

Step 7 - Re-fit the Gasket Seal

Re-glaze the panel using the two sizes 2 x 2 rubber gaskets supplied. Larger size for the wet side of the screen.

Push the gasket back into panel evenly on both sides making sure the gasket finishes with outer edge of compensators.

See Fig. 15.

GASKET SHOULD NOT BE STRETCHED.

Use some soapy solution to apply the seal.

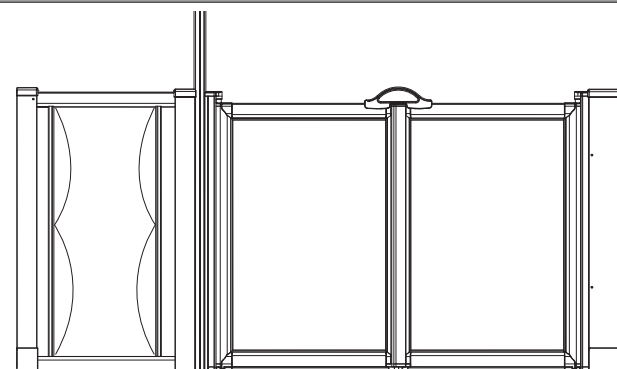

Fig. 15

Step 8 - Attach Curtain Rail

Curtain rails are to be positioned on the inside of screens. When rail is level, mark off curtain rail bracket hole positions, then drill into wall with a No.10 masonry drill bit. Fit red plugs and then fit with a No.8 x 1 1/2 and cover caps.

See Fig. 16 and 17

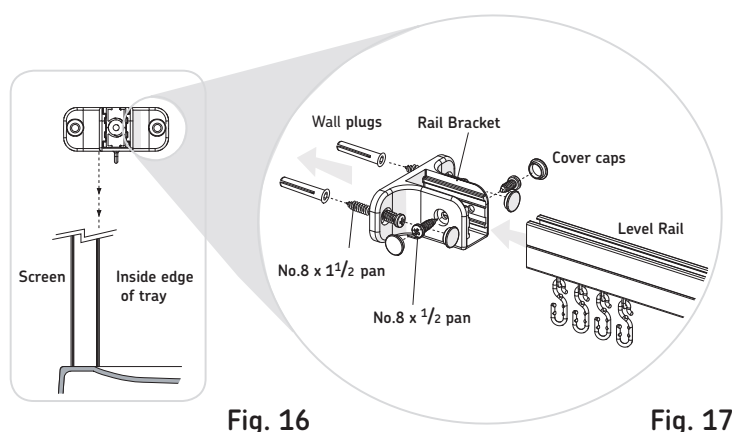

Fig. 16

Step 9 - Attach the Post and Final Checks

When rail and post are level using bracket supplied, drill into post and rail using a 3.5mm drill bit and fasten with No. 8 x 1/2 pan and finish off with cover caps. **See Fig. 18** Ensure all screws are fully tightened and ensure all panel stile caps and cover caps are fitted. Silicone seal all joints between framework and tray and framework and wall on both sides. Complete final checks.

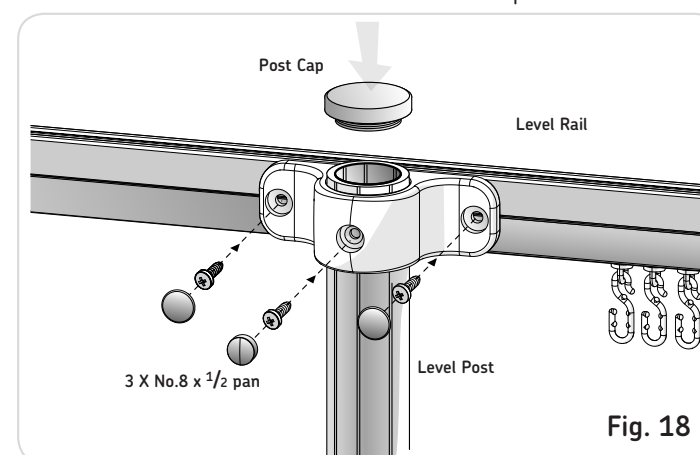

Fig. 18

Aftercare Instructions

AKW showering and daily living products have been developed on the basis that they are cleaned regularly using normal domestic bathroom cleaning materials. **Do not use** abrasive products, cloths, strong or concentrated acidic or alkaline cleaning materials as these may discolour or otherwise damage the product. The use of strong or concentrated acidic, alkaline, chlorine or other cleaning materials will invalidate any warranty as this may discolor or otherwise damage the products. **DO NOT** place matches, cigarettes or naked flames on or near this product.

It is important to clean areas such as seals and keep moving parts clear from build up of grime and water deposits to maintain good working order. Dry with a towel to prevent new water spots from forming. Whenever possible always rinse down the screen, shower, shower rail and curtain after use to remove soap and any other deposits. After cleaning, the user should always rinse with water and wipe thoroughly with a soft damp cloth to remove any cleaning material residues before drying off.

***Guarantee for life Conditions - Not covered by any warranty**

Damage or defects that result from incorrect installation, improper use, accidental damage or lack of maintenance including the buildup of grime, dirt or limescale and waterborne debris. Damage resulting from inappropriate cleaning or water ingress. Damage or defects that result from repairs, modifications undertaken by unauthorised persons who are not AKW authorised service staff or agents.

The guarantee applies only to manufacturing or material defects and does not apply to normal wear and tear, inappropriate use or accidental damage.

Orderline
01905 823299

General Enquiries
01905 823298

Fax
01905 823297

Website
www.akw-ltd.co.uk

Quotes & orders email
orders@akw-ltd.co.uk

Technical Help line
01905 560219
technicalenquiries@akw-ltd.co.uk
Enquiries email
sales@akw-ltd.co.uk

Post
AKW, Pointon Way,
Hampton Lovett,
Droitwich Spa,
WR9 0LR



AKW Limited,
Pointon Way, Hampton Lovett
Droitwich Spa, WR9 0LR
13
DoP 07-002-590
PH
EN 14428:2004+A1:2008

What to do if something goes wrong?

In the unlikely event that you should encounter a problem with this product, please contact your local installer and if this does not resolve the issue then contact AKW technical team who will provide further advice and if necessary arrange for our service engineer to visit or discuss our comprehensive after-sales service. As part of our quality and training program calls may be monitored or recorded. None of the foregoing affects your statutory rights.

Failure to install this AKW product in accordance with supplied instructions or the making of unauthorised modifications will invalidate any warranty and will affect product safety.

AKW
life. style. choice.

Guaranteed
for
Life

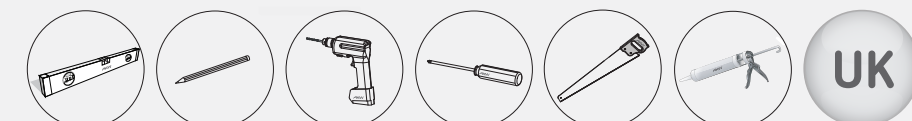

UK

Option TT/TTW, Z/ZW Shower Screens Installation And User Care Instructions



Read ALL instructions carefully BEFORE installation and leave with the end user for future reference

Choose which sliding screen cubical is to be installed and read all the steps clearly before installation.

*These screens can be fitted to Multi-Spec trays or trays fitted with a pipe work duct.

+ In addition to fitting the trays as indicated in the catalogue these screens can be fitted to trays with integral or optional pipe work ducts. When fitted to a pipe work duct the extra wide compensators will be required.

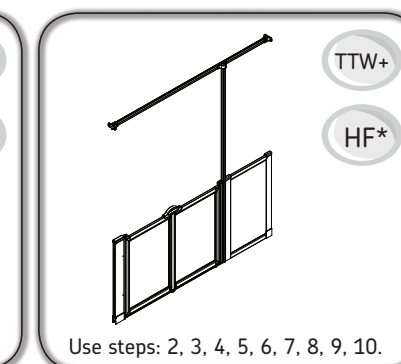
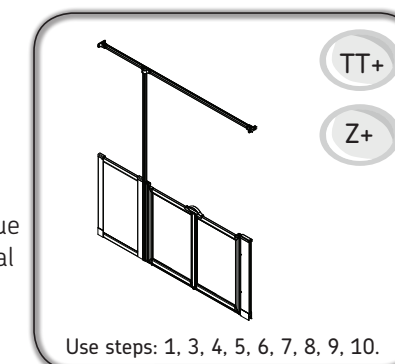

Step 1 - Compensator Installation

Take out adjusting screws from inside of compensator. Place compensator against wall making sure edge of compensator lines up over the inside edge of tray.

For surface mounted trays use the card template to align the outside edge of the compensator to the outside edge of the tray. Fig 1.1

For flush mounted trays use the notch as a guide to align the compensator with the outside edge of the tray. Fig 1.2

Mark off hole position when level. Drill into wall with a No.10 masonry drill bit. Fit wall plugs and fix compensator with No. 8 x 1 1/2 pan. Fig 1.3

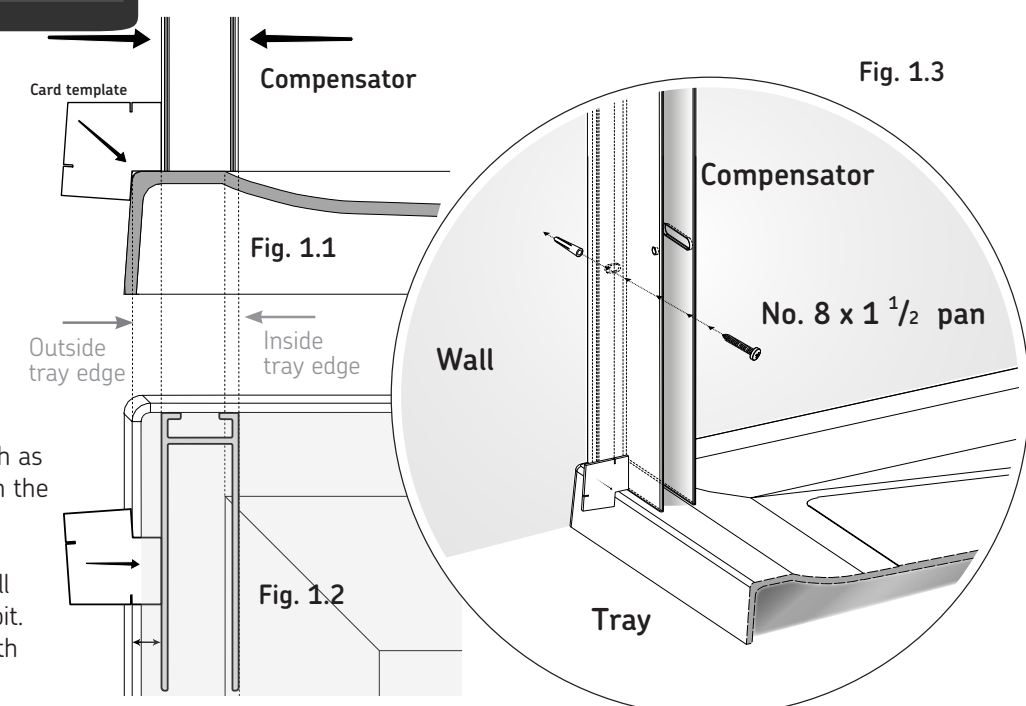

Step 2 - Corner Block Installation

FOR WET FLOOR INSTALLATION ONLY.

Corner block is removable, please ensure that the compensator locking holes are on the inside of the showering area.

Corner blocks must be trimmed to suit alto floor using a heavy pair of scissors or snips then sanded down to give a smooth finish.

See Fig. 2.

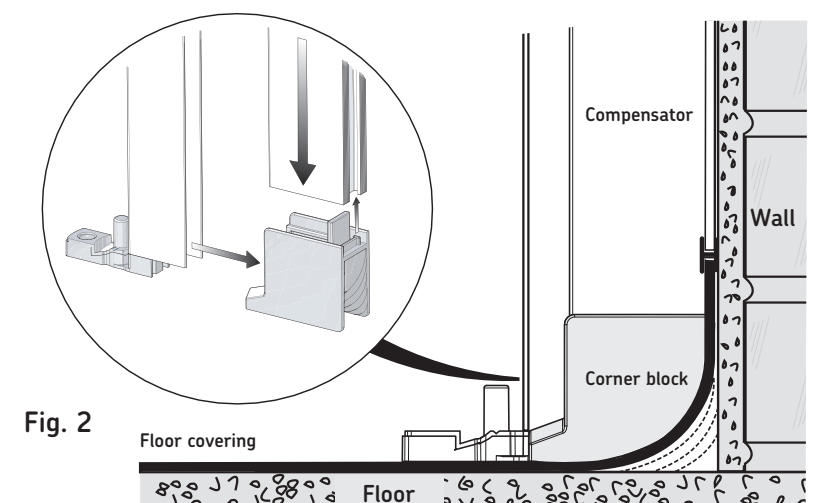

Step 3 - Compensator and Door Installation

Slide doors into outer compensator, reattach the adjusting plate and clamping plate loosely with No. 6 x 3/4 pan head screw.

See Fig. 3

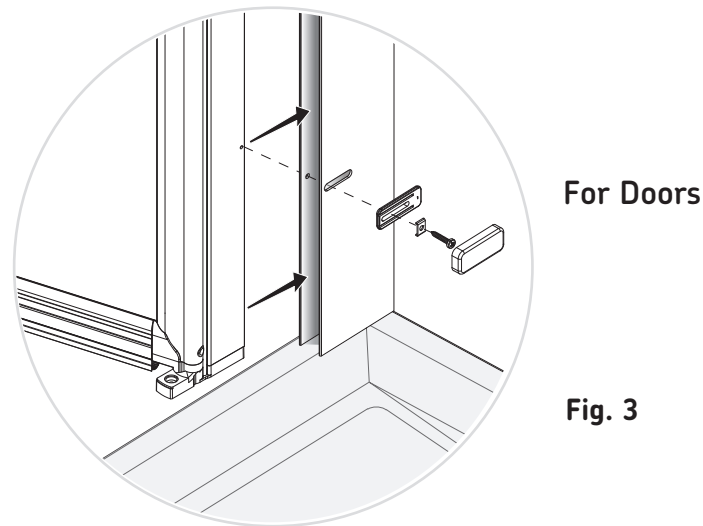

Fig. 3

Step 4 - Post Installation

For fitting an option Z, fit the bottom cap with clear silicone. See Fig. 4

For fitting an option TT, fit the bottom pivot to underside of post hinge adaptor with No. 6 x 1 pan, before screwing the panel compensator onto the post. See Fig. 5

Drill 3.5mm diameter hole into the post then fasten the panel compensator with No. 8 x 3/4 pan head screw.

See Fig. 6

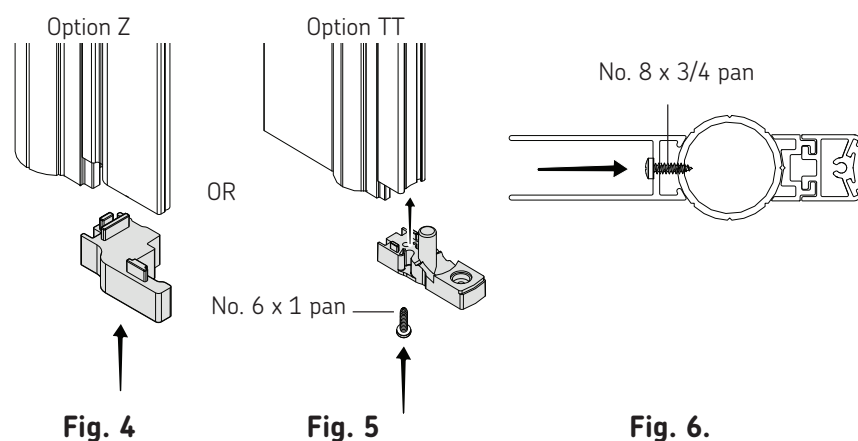

Fig. 4

Fig. 5

Fig. 6

Step 5 - Cap Installation

For fitting an option Z, fit the top cap with clear silicone. See Fig. 7

For fitting an option TT, fit onto the bottom pivot, then fit the spring into door and fit top pivot with No. 6 x 1 pan.

Then fit screw cover cap. See Fig. 8

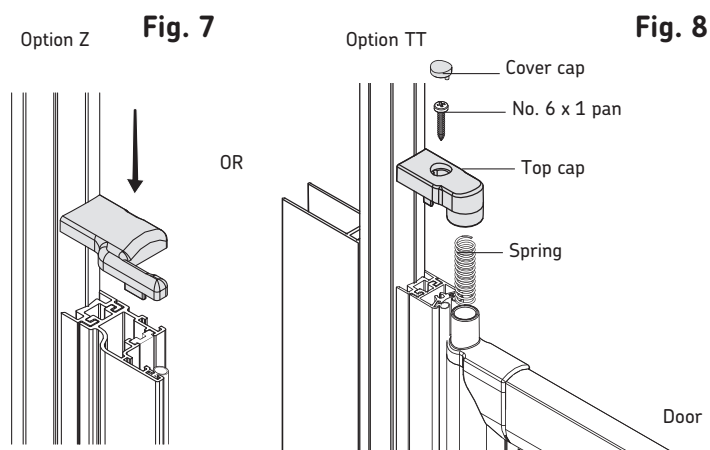

Fig. 7

Fig. 8

Step 6 - Post and Panel Installation

Fitting of the other door/panel post are identical.

Align doors/panels with posts onto tray and mark off hole positions.

See Figs. 9 and 10

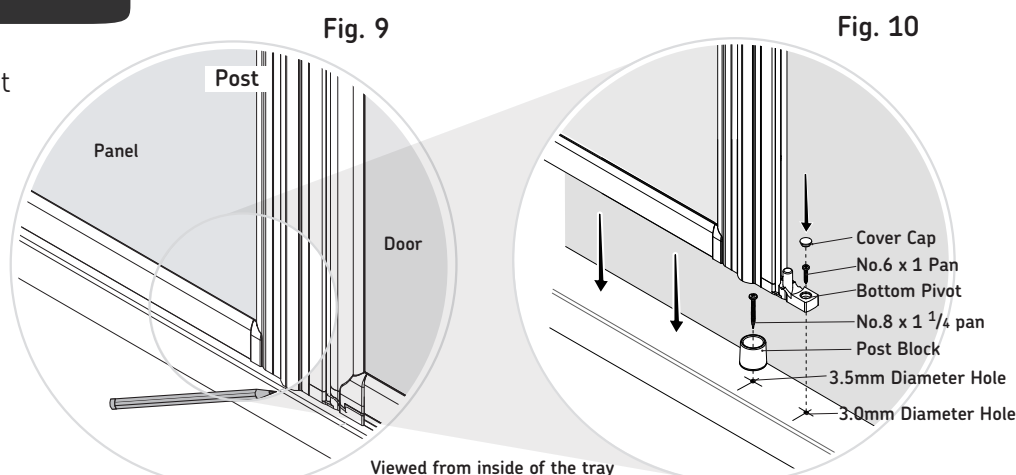

Fig. 9

Fig. 10

Step 7 - Disassemble

Disassemble the panel by removing the outer compensators.

The compensators must be drilled and screwed to the post and wall respectively (refer to diagram for the correct screw size) with locking screw holes at the top and facing inside the shower base.

See Fig. 11

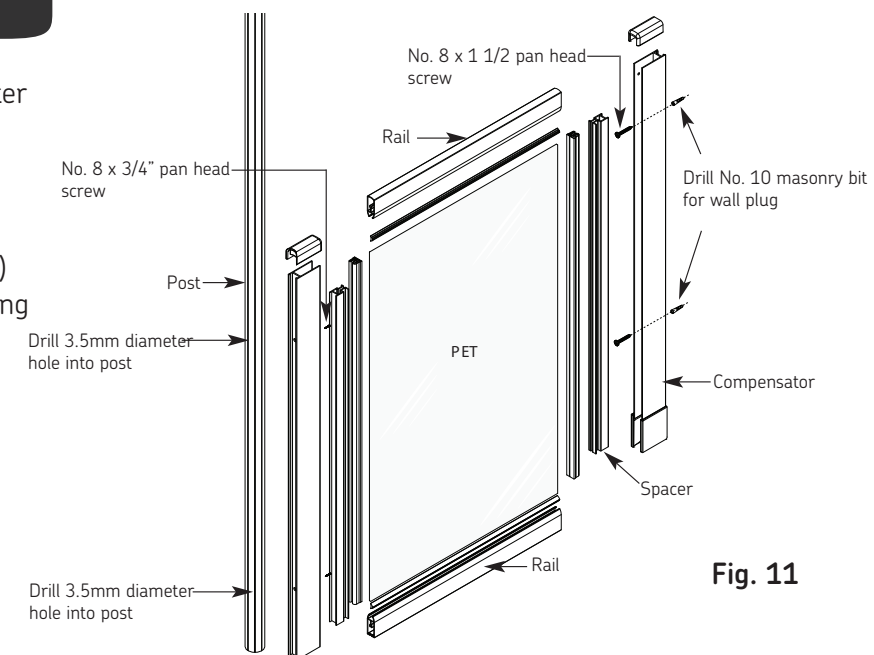

Fig. 11

Step 8 - Cutting PET

Measure between the back of the compensators at the top and bottom points to allow for walls being out of plumb, then deduct 15mm before cutting PET, top and bottom rails and wedge gaskets with a fine tooth blade this allows for easy installation.

See Fig. 12.

CAUTION when cutting PET or aluminium

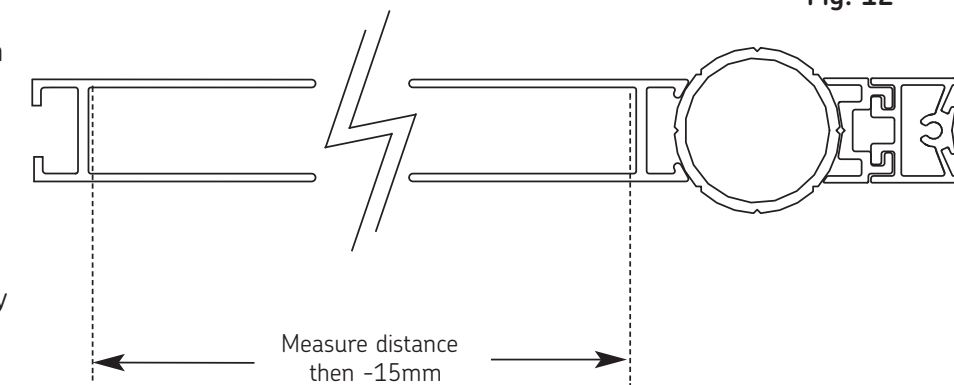

Fig. 12

Cutting of PET/aluminium/rubber maybe done separately. Deburr any sharp edges.

Assembly of these items is as follows: Fit the top and bottom rail then fit the wedge gasket back into the rails on the wet side of the screen.

Step 9 - Reassemble

Once cut and re-assembled, reattach spacers down both sides of the panel and slide down between legs of compensators.

The top rail should be level with the top of the compensators.

With both locking holes facing into the showering area, drill through hole with a 3.5mm bit, using uni-screw cap and No. 8 x 1/2 pan head screw and fully tighten.

See Fig. 13 and 14.

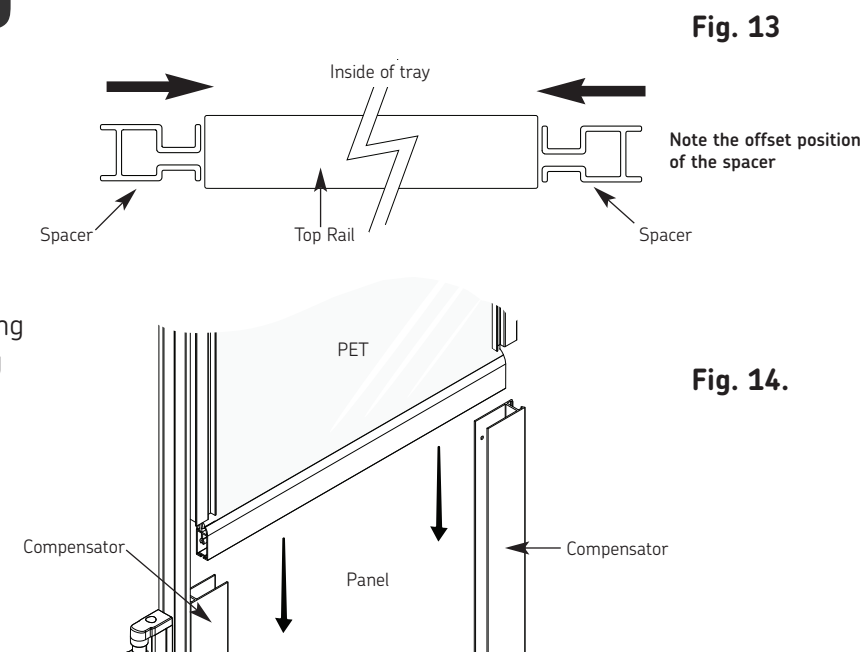

Fig. 13

Fig. 14.