

Low Profile Shower Tray

INSTALLATION AND USER CARE INSTRUCTIONS

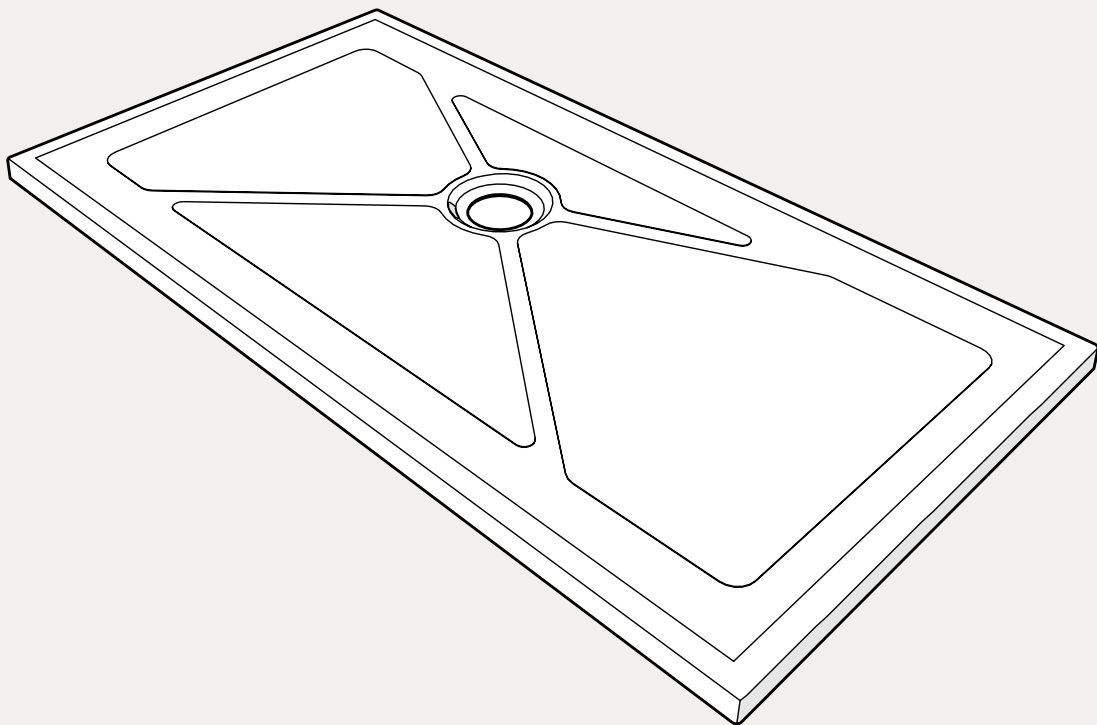

Please read all instructions before installation and leave this document with the end user for future reference as it contains important warranty information

Notes to Installers

IMPORTANT: Before completing the installation, water test the flow from tray into waste for correct installation and drainage efficiency.

It is important to ensure that the floor is level in all directions before putting the tray into place. If water puddles away from the waste, this is a clear indication that the levels are not correct - the water is acting as a 'spirit level'.

The sides on the tray A and B may well show level on testing, but if point C is low, then water will puddle in the area of point C and the only remedy is to level the floor and refit the tray. The tray has 'lands' on all four sides.

Use a spirit level front to back and side to side - all 'lands' must be level (ABC) - the fall is moulded into the tray.

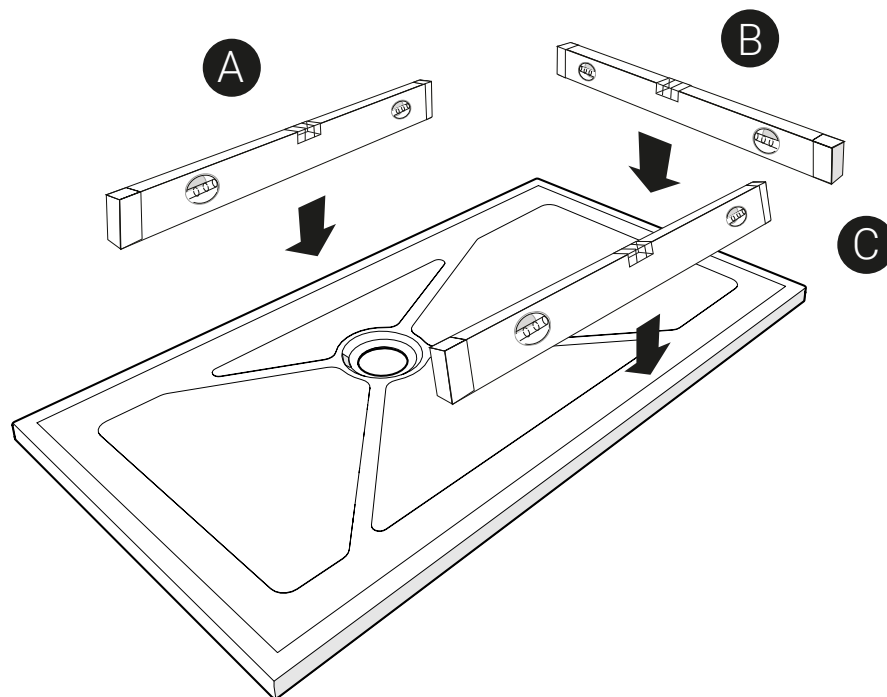

1. Cutting Tray to length (1800x700 & 1800x820 only)

The Low profile trays have offset wastes in two directions so that by rotating the tray, the waste outlet should never come into contact with the joists.

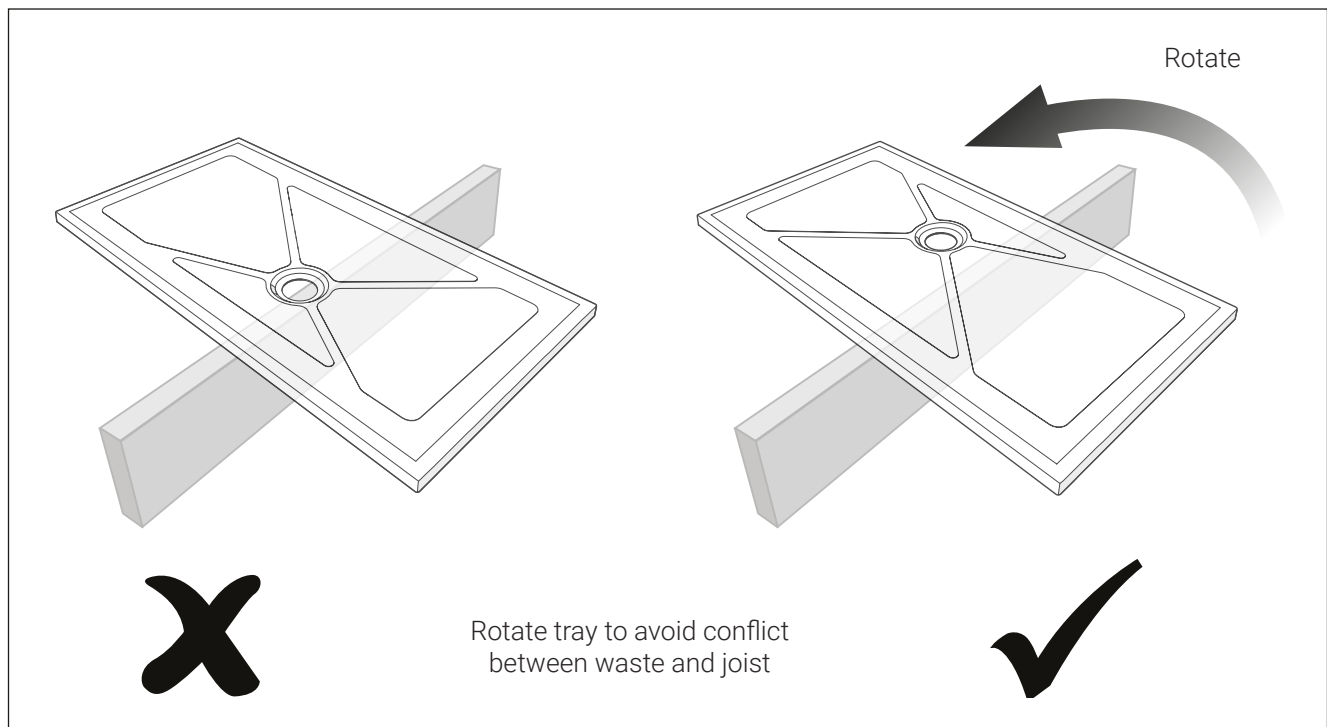

The 1800x700 & 1800x820 Low Profile trays can be cut to suit the dimension between walls down to 1500mm. Two aluminium strips (Angle A and B) are included to give support. The waste must be positioned first to avoid joists prior to any cutting. Do this first by measuring from the shower head end to the waste position. If this avoids joists, then cut end of tray opposite to shower head end. If the waste comes into contact with the joist, then rotate the tray 180° and cut end of tray opposite the shower head end. Use a fine toothed blade in either jig or handsaw (cut from below with jigsaw or from above with handsaw). Allow for thickness of trim angle 'B' (2mm or $\frac{1}{8}$ ") when cutting tray to size (See Fig. 1). After trimming tray and angles A & B to size, silicone underside of tray in position of angle 'B' placement. Fit angle 'B' to underside of tray with stainless steel screws.

Place tray onto a prepared level floor and between walls, ensuring that angle 'B' is tight against end wall. Place angle 'A' onto tray and against angle 'B' then drill 4.5mm ($\frac{3}{16}$ ") diameter holes on 'v' groove location through both angles (drill countersunk holes in angle 'A') (See Fig. 1). Remove angle 'A' then drill through previously drilled holes in angle 'B' with a No.10 / 5mm masonry drill into wall and fit plastic wall plugs. Silicone seal undersides of angle 'A' then fix to wall with No. 8x38mm ($1\frac{1}{2}$ ") countersunk head stainless steel screws. Further silicone seal between angle 'A' and tray if required. Trimmed tray edge is now ready for tiling (See Fig. 1).

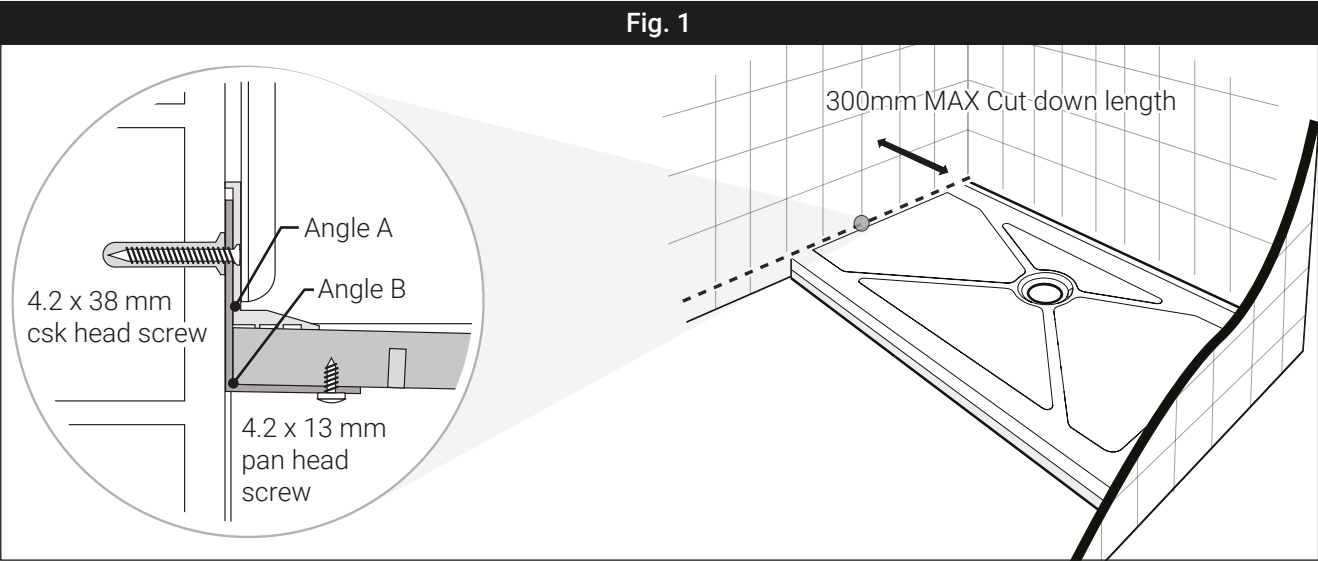

2.1. Tiling Upstands

N.B. Tiling upstands are supplied cut-to-size only. Installers to drill holes for tray fixings. Tiling upstand (fixing flange to tray) may have to be cut out to accommodate waste pipe exit in tray before fixing to tray.

Place tiling upstand against tray wall edges, ensure that upstand has angled ribbed face against tray wall, is flush with top of tray edge and is correctly positioned at corner before marking off fixing holes.

Drill 3.5mm (1/8") diameter holes in tray, apply silicone sealant to tiling upstand before fixing to the tray with No. 8 x 20mm (3/4") pan head self tapping screws.

Fit other tiling upstand in the same way, ensuring that it butts up to and is level with previously installed upstand at the corner. Cavities caused by radius on tray edge and corner must be silicone sealed. (See Figs. 2.1, 2.2 and 2.3)

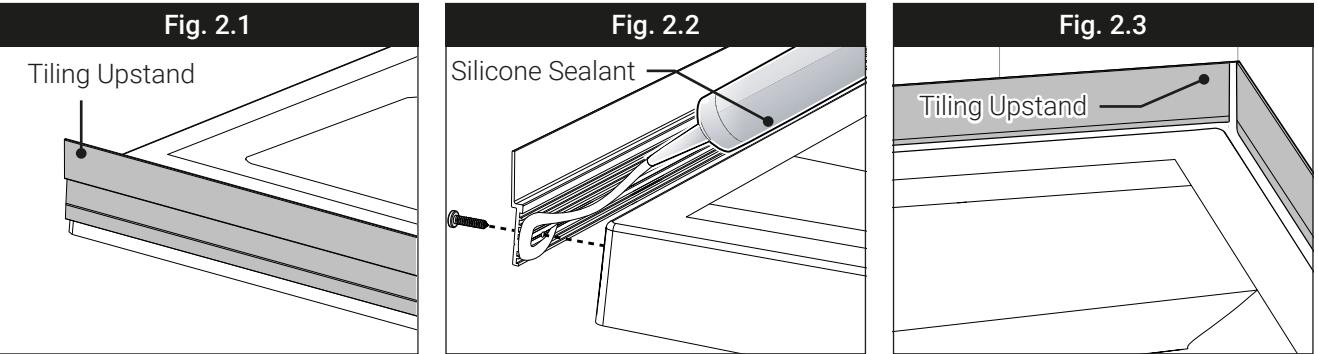

2.2. Installing Tray to Wooden Floor

Place tray onto floor with tiling upstands tight against plaster finish on back walls. Mark around tray front edges onto floor then cut along marked line and remove floor boarding. Install 75 x 50mm (3" x 2") wood noggins to joists around floor recess edges as shown. Note. These noggins must be installed level for tray to sit level when placed into floor recess. This will ensure that fall in tray will efficiently drain to waste.

Although the tray does not require any additional strengthening through the central area on the underside. Additional noggins **MUST** be placed so that the edges of the tray are fully supported.

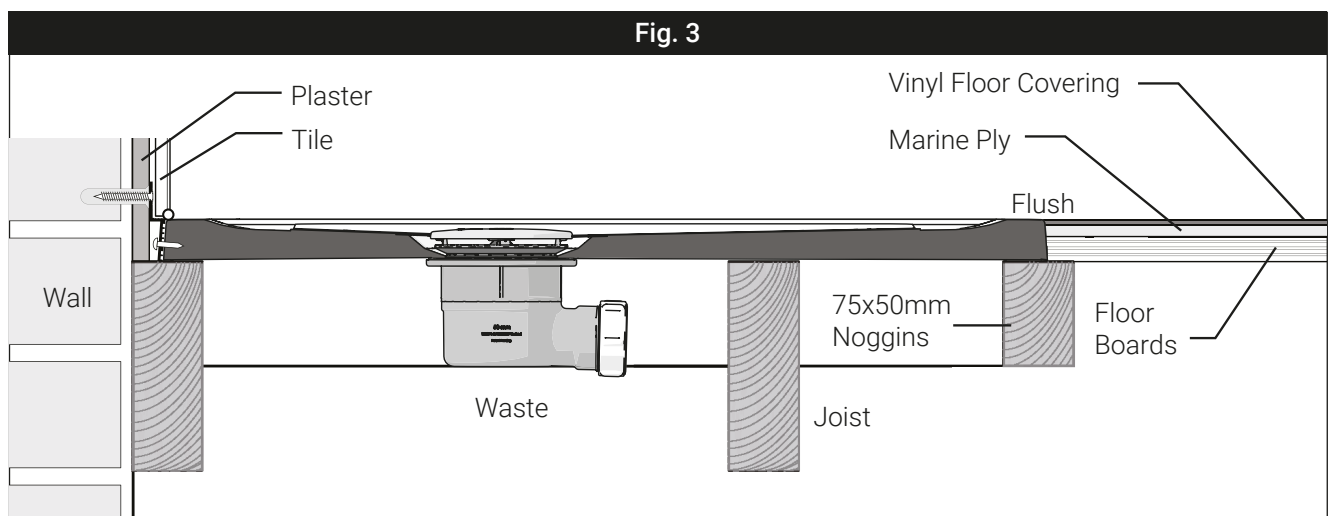

Install the waste into the tray and connect the exit pipes to the waste. Place tray into floor recess ensuring that the tray edges are tight up to edges of previously cut floorboard. Drill for suitable plugs in wall for tiling upstand fixings then fix with CSK head stainless steel screws (not supplied). Re-check tray is level and test for water drainage efficiency of tray. Apply mastic to tiling upstand while tiling bottom row of tiles. Vinyl floor covering should finish flush to and be level with the tray as shown. If the waste pipes have to pass through the wooden floor joists, these should be drilled and not notched. (See Fig. 3)

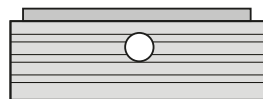

Correct

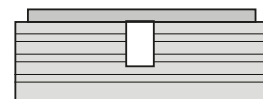

Incorrect

After Care

Provided that the shower tray has been correctly installed, difficulties should not be encountered. If any maintenance is required, it must be carried out by a competent installer.

It is advised that this product is cleaned regularly as part of a routine maintenance regime.

Always rinse the shower tray down using warm water after every wash to remove any insoluble products. If you use hair dye, immediately rinse the shower tray with soap and water.

For routine cleaning, use hot soapy water or a mild detergent and a soft cloth to wash and rinse the showering area. Never use abrasive cloths or any aggressive cleaning materials to clean the showering area. Do not use industrial cleaners that have abrasive or harsh chemical properties as this could affect the surface finish.

The surface of this shower tray should never directly come into contact with strong industrial acids or alkalis, organic solvents, caustic soda, lacquers or nail polishes, bleaches or any dry powder cleaning agents. Do not use paint strippers or stain removers to remove any stubborn staining. If more thorough cleaning is needed using domestic cleaning products always test on a small area first.

Contact Us



Orders & Quotes

01905 823 299
orders@akw-ltd.co.uk

General Enquiries

01905 823 298
sales@akw-ltd.co.uk

Technical Enquiries

01905 560 219
tech@akw-ltd.co.uk

Kitchen Enquiries

01905 823 262
kitchens@akw-ltd.co.uk

Fax

01905 823 297

AKW

Pointon Way, Hampton Lovett
Droitwich Spa, WR9 0LR

www.akw-ltd.co.uk
orders.akw-ltd.co.uk

Follow us on Social:



Guarantee

The life time guarantee applies only to manufacturing or material defects, conditional on the one-time correct installation of the product.

Does not apply to:

- Inappropriate use or accidental damage.
- Damage or defects that result from incorrect installation.
- Lack of maintenance including the build up of grime or damage resulting from inappropriate cleaning.
- Damage or defects that result from repairs or modifications undertaken by unauthorised persons.
- This guarantee excludes general wear and tear through usage and does not apply to surface finishes.

What to do if something goes wrong?

In the event that you should encounter a problem with this product, please contact your local installer and if this does not resolve the issue, then contact AKW technical team who will provide further advice and, if necessary, arrange for a maintenance engineer to visit and report any issues. See the T&Cs on our website or our catalogue for further information. None of the foregoing affects your statutory rights.