



ALWAYS read the installation instructions before installing this product.



ALWAYS read the installation and end user care instructions.



ALWAYS match the correct waste to the shower tray.

ALWAYS have the pumped waste installed by a trained and experienced skilled craftsman.



NEVER use the pumped waste without the unit fully assembled.



ALWAYS Keep fingers clear of the gaps between the cover, and the locking ring during installation.



DO NOT place matches or cigarettes on or near this product.
The following materials are used in this product:
Acrylonitrile Butadiene Styrene (ABS),
Ethylene Propylene Thermoplastic Rubber (EPTPR)
Stainless Steel



ALWAYS Attach Grid Removal Tool to a cord to prevent loss!



22mm PGTF Pumped Waste with Adjustable Height Stainless Steel cover

Installation and user care instructions John Guest Speedfit* Adaptor

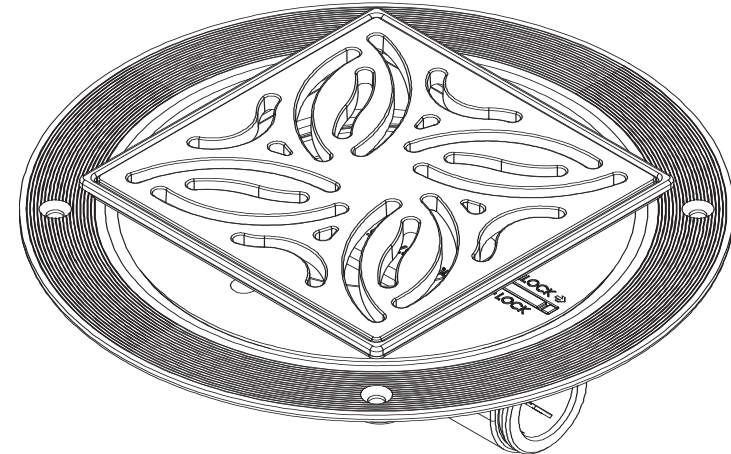

This product carries a lifetime warranty against manufacturing and material defects conditional on the one-time correct installation of the product. Warranty excludes debris & blockages and improper installation. Your statutory rights are not affected.

Level Best does not make any warranty, expressed or implied, or accept any liability in connection with this information or its use. This information is furnished upon the condition that the person receiving it shall make his/her own tests to determine the suitability thereof for his/her particular purpose.

For further details on this and other Level Best products please contact your distributor - see details on outer packaging

*John Guest and Speedfit are registered trade marks of John Guest International Limited

*Polypipe is a registered trademark of Polypipe plc, a subsidiary of IMI plc

Colour: White RAL9016

Internal Building use only

Registered Design/ EU000566849-0001

Patent Pending

Installer: Please ensure that this information is left with the end user of this product.

Installation Instructions

Fitting the waste into the former and connection to drain pump

Remove the central waste grid (A) and unscrew the grid frame threaded adjustment ring (B), put these to one side.

As a "dry run" first place the tray into the desired location and determine the position and depth of clearance required to position the drain.

Apply sealant to underside of outer rim and install into centre hole of Tuff Form Former. Use 4 x No 6 or No 8 x 3/4" CSK HD screws (not supplied).

Clean sharp edges from and then insert a square ended ø22mm polypipe® pipe fully into the bore (approximately 25mm); route this clear away from below the shower wet floor former to the pump location;

Fit the JG locking clip into the waste fitting;

Fitting the sealed Flooring

Temporarily blank off waste centre hole to stop debris entering;

Apply wet floor tanking sealant to floor to overlap edge of waste 25mm, let this dry before continuing;

Depending upon the thickness of the floor tiles to be used, change the threaded adjustment ring (B) (small = 6-16mm (1/4"-5/8" in) / large = 16-25mm (5/8"-1 in)). This part is a push fit but may require some leverage to remove.

Insert centre waste grid fitting carefully and screw down (1) until height is level with intended finished floor.

Move sliding locking clip towards centre of waste

to lock height adjustment; (2)

Rotate centre grid to line up with tile edges (this is sometimes a tight / stiff action); (3)

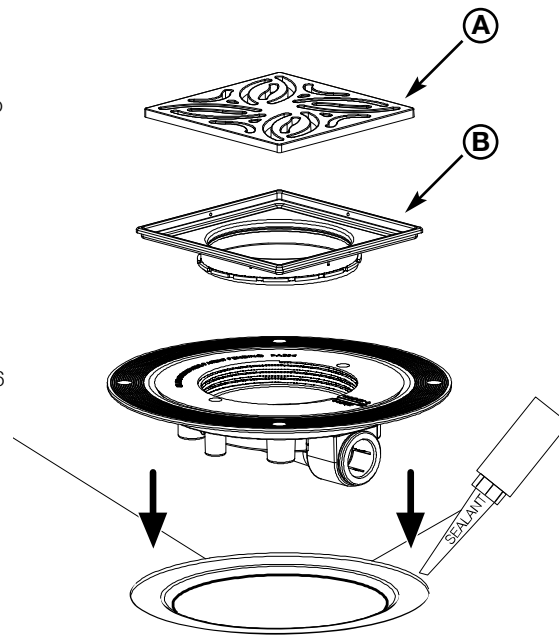

1. SET HEIGHT BY ROTATING THREADED RING
2. LOCK IN POSITION WITH SLIDER
3. ALIGN WITH TOP OF TILE BY ROTATING STAINLESS STEEL COVER PLATE

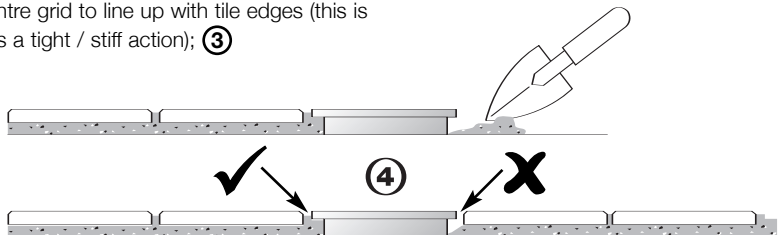
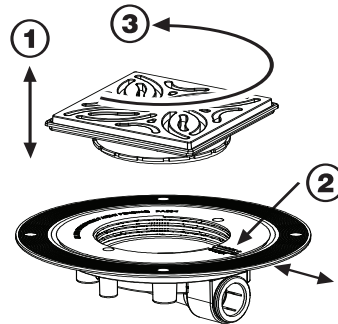

REMOVE THE CENTRE STEEL GRID AND STORE TO ONE SIDE TO ENSURE IT IS NOT DAMAGED DURING TILING

IMPORTANT: Tiling cement must be carefully packed around and below the centre grid support to ensure a long and trouble free life to the product and water-proof seal to the flooring is maintained. (4)

Finishing the waste installation

Clean up inside the waste grid area of tile grout and cement – do NOT place this in the waste!

REMOVE TEMPORARY WASTE BLANKING

MATERIALS, clean any grout and cement or other rubbish from the waste so it will not damage the pump.

Re-fit the stainless steel grid. It should sit level with the edge of the frame and the finished floor surface.

User Care Instructions

This waste is designed for low maintenance and reliable operation. The Pumped waste should be checked as part of a planned maintenance programme, and any parts showing evidence of damage or misuse must be replaced.

Keeping your pump waste clean

This product should be cleaned periodically to remove any accumulation of hair or other waste material, using normal domestic bathroom cleaning materials.

To clean, remove the steel grid using the tool provided.

If necessary the waste can now be rodded to clear any blockage or waste material.

Reinstall following the above instructions.

Disinfecting

Where disinfecting is necessary, standard established procedures for disinfecting equipment should be used taking due care and attention to the warnings below concerning possible effects of aggressive chemicals on plastics.

After cleaning always flush down with water then wipe thoroughly with a damp cloth to remove any cleaning material residues before drying off.

Do not use strong or concentrated acidic, alkaline or other cleaning materials as these may discolour or otherwise damage the product.

Level Best do not approve or recommend autoclave cleaning of any of the components due to the damage this can cause to the special engineering plastics used in the construction of this product.

Such action may discolour the metal grid

Packaging

This waste is supplied in a polypropylene (PP) bag to keep the plastic product unsoiled until installation; it may also be packed in a cardboard box.

Both are suitable for recycling operations and should be disposed of in accordance with local recycling regulations.