

Installing the vinyl floor covering into the edge of a Mullen shower tray

After following the instructions inside according to your type of floor, clean any sawdust or screed out of the channel to leave it clean, smooth and dry.

Lay the floor covering up to the shower tray and then use the inside edge at the bottom of the channel around the edges of the shower tray as a guide for your cutting knife. The channel is made from solid GRP and has been designed to be used as a cutting guide.

The vinyl floor covering can be cut unevenly and even short by up to 10mm (3/8") up the sloping side of the channel - and still be clamped properly. However the more even the cut the better the clamping effectiveness.

Excess length in the bottom of the channel will stop the clamp working correctly. Trim back any excess floor covering so that it is level with the bottom of the channel.

Apply lines of mastic to the inner vertical side and sloping face of the floor covering and to both ends of both clamping bars. Fit both clamping bars and the corner block, gradually and evenly tightening the screws to eliminate any distortion of the floor covering. Remove any excess sealant immediately.

Finally fit the screw caps, pressing them down firmly, flush with the surface of the clamping bar.

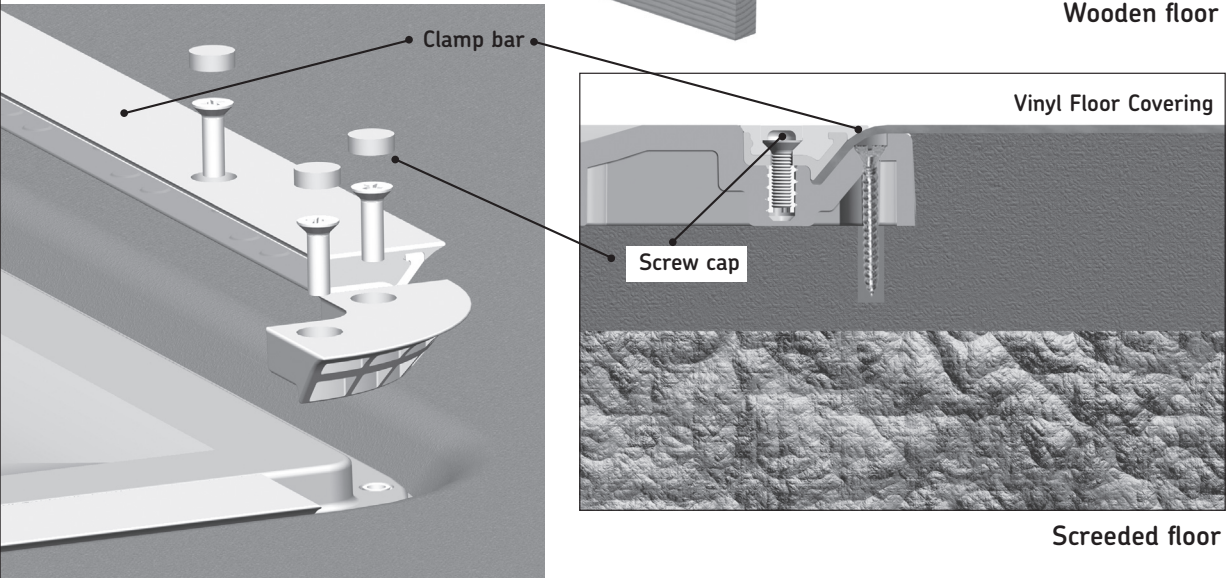
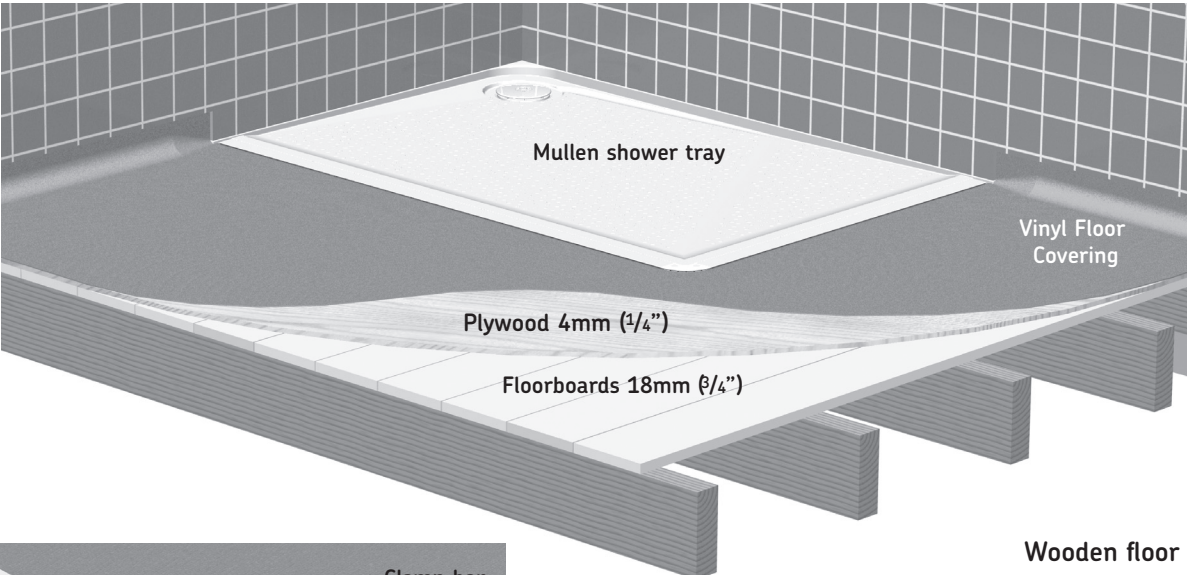

The measurements throughout these installation and user care instructions have been converted from metric to its equivalent in imperial, therefore all dimensions are approximate and subject to manufacturing tolerances. AKW MediCare does not make any warranty, expressed or implied, or accept any liability in connection with this information or its use. This information is furnished upon the condition that the person receiving it shall make his/her own tests to determine the suitability thereof for his/her particular purpose.



READ ALL INSTRUCTIONS CAREFULLY BEFORE INSTALLATION AND LEAVE WITH THE END USER FOR FUTURE REFERENCE

Mullen Shower Tray Installation Instructions

Patent GB2394175 and other GB and World-Wide Patents Pending

Mullen Dimensions

Each Mullen shower tray has a channel to accept the floor covering around two sides. This extends outside the shower screen area by 50mm (2") on one side and 50mm (2") on the other side.

The opposite ends incorporate built-in tiling upstands which are 19mm (3/4") total width, also outside the shower screen area. This part of the shower tray will be located within the finished plaster tile wall surface.

To calculate the size of the aperture in the floor required based on the nominal shower screen area, simply add this 69mm (2 5/8") value to the nominal length and width figures:

| Showering Area | Overall (including clamping bar) |
|----------------------------------|----------------------------------|
| 1000 x 1000 39 1/4" x 39 1/4" | 1069 x 1069 42" x 42" |
| 1200 x 700 47 1/4" x 27 1/2" | 1269 x 769 49 7/8" x 30 1/8" |
| 1200 x 820 47 1/4" x 32 1/4" | 1269 x 889 49 7/8" x 34 7/8" |
| 1300 x 700 51 1/4" x 27 1/2" | 1369 x 769 53 7/8" x 30 1/8" |
| 1300 x 820 51 1/4" x 32 1/4" | 1369 x 889 53 7/8" x 34 7/8" |
| 1420 x 700 55 7/8" x 27 1/2" | 1489 x 769 58 1/2" x 30 1/8" |

The Mullen shower tray is 27mm (1/8") below the finished floor surface which is level with the screen flat mounting area on the top of the shower tray.

The outside edge of the channel is 3mm (1/8") below this level to allow for the thickness of the floor covering.

| Tray sizes in this range | | | | | |
|--------------------------|--------------|--------------|--------------|--------------|--------------|
| 1000 x 1000mm | 1200 x 700mm | 1200 x 820mm | 1300 x 700mm | 1300 x 820mm | 1420 x 700mm |

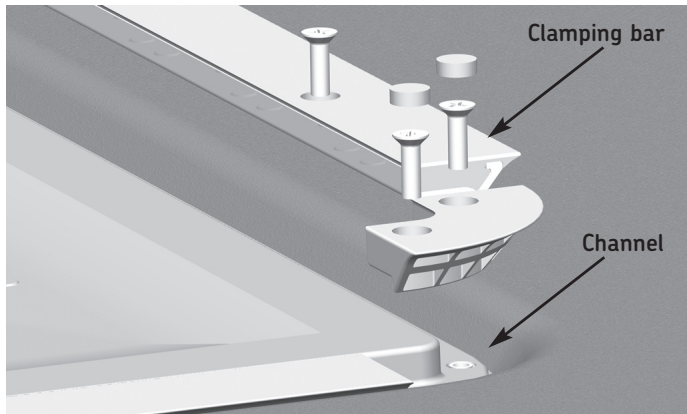

The shower tray is screw fixed down around the front perimeter, screw heads are hidden by vinyl floor covering.

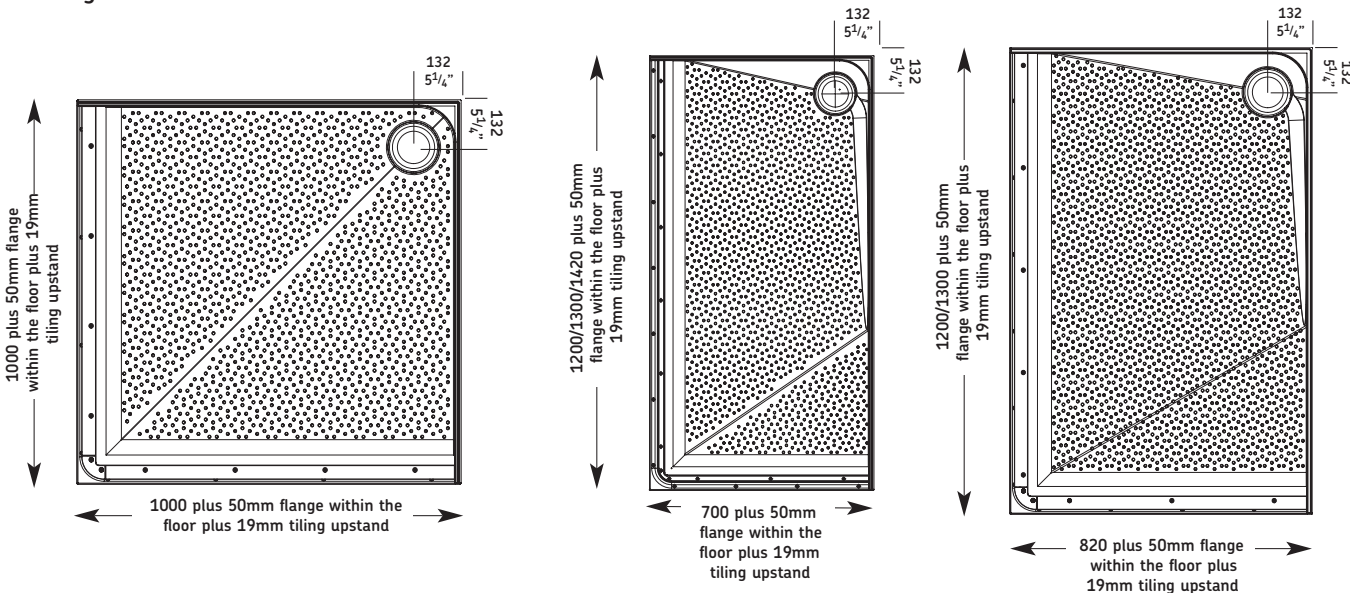
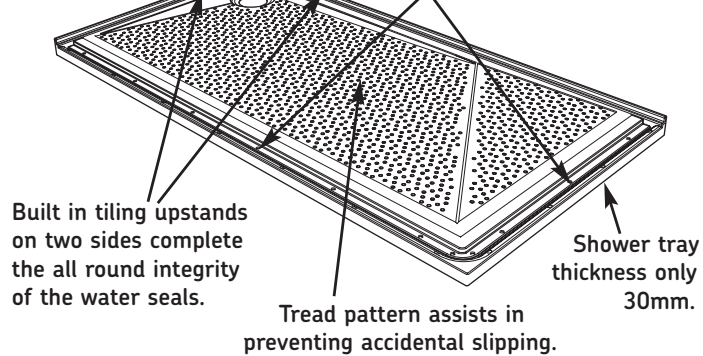

Installation in wooden floors

Your Mullen shower tray is supplied with the two clamping bars already positioned in place to where they would be when the installation is complete. Carefully unscrew the clamping bars and the corner block from the shower tray and put them safely to one side. Loosely hand fit the M6 stainless steel screws fully into the inserts.

Included in the packaging is a plastic bag containing 10 x screw caps. Put this safely with the clamping bars until required.

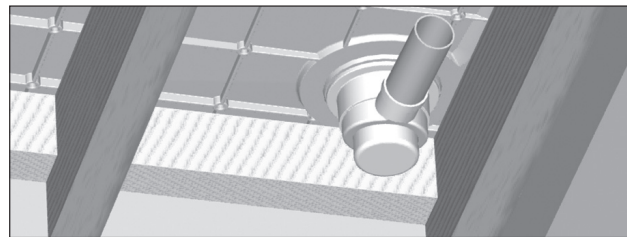

Ensure all 4 edges of the Mullen shower tray are supported on joists or noggins. Support the rest of the shower tray with joists or noggins on 400mm (15³/₄") centres

Step 1

Position the shower tray over the desired location for the shower and mark around the edge.

Cut out the flooring area within the marked area taking care not to cut through supporting joists or any electrical wiring which may be below.

19mm (3/4") of the shower tray tiling built-in upstand will be located inside the wall on two sides

Step 2

Fit Noggins 75mm x 50mm (3"x 2") to all the edges of the cut-out area to provide support for both the new shower tray and the existing floor. Also fit them within 100mm of the waste outlet position.

Joist top surfaces do not require profiling for this flat-bottomed shower tray.

Step 3

Align the shower tray - to avoid or minimise joist overlap, the Mullen waste location is offset.

Step 4

Ensure the edge of the Mullen shower tray (**outside of the channel**) is level with the surrounding floor surface.

If the surrounding floor is lower than the Mullen edge:

Use ply or hardboard to bring surrounding floor levels up to the Mullen.

Surrounding Floor higher than the Mullen edge:

Use ply or hardboard strips on all exposed joists and noggins to bring the tray level to 30mm (1³/₁₆") below the surrounding floor levels.

Fit the waste to the Mullen shower tray and ensure all connections and pipework are watertight before proceeding to fix the shower tray down. Use the screw holes outside the channel – they are the holes closest to the edge of the shower tray.

Step 5

Fix Down – when the shower tray is fully supported and level with the surrounding floor, apply mastic in conjunction with woodscrews on the tray edge to fix the shower tray down onto the joists and noggins.

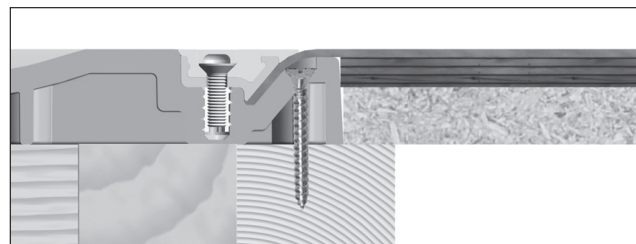

Use a minimum of 2 screws per side – it is not necessary to use all the screws holes provided.

Do not overtighten screws.

With the front edge and end secured to the floor place a level along the tiling upstand side and back edges to check they are level.

It may be necessary to drill and fit a screw through the tiling upstand.

Step 6

Carefully clean out the channels running around the edges of the shower tray to remove any sawdust or other rubbish to leave them clean, smooth and dry. Remove the screws protecting the screw inserts.

See page 4 - fit waterproof non-slip floor covering to the shower tray according to manufacturer's guidelines. The waste cover can now be secured in place.

Installation in screeded floors

Step 1

Dig out floor screed to suit shower tray area.

Step 2

When installing into concrete floors it would be usual to fit the shower tray with our specially designed shallow waste water pickup with an Digi-pump. For this arrangement approximately 45mm (1³/₄") of depth is needed under the waste position to allow installation. It may be required to remove some concrete to achieve this result. 15mm (5/8") Polypipe or equivalent should be used.

If fitting shower tray to a ground floor it is possible to use a 50mm (2") trapped waste. To fit this waste concrete needs to be removed to allow waste pipe to reach an outside gully.

Step 3

The shower tray edge outside the channel must finish flush and level with the top of the screed. The shower tray needs to be supported on all four edges and at least 50% of the ribbed underside. Sand and cement may be used to create a sub-screed 30mm (1³/₁₆") lower than the finished floor height. Check the tiling upstand edge is flat and level before this mix sets. Apply weight to the centre of the edge / shower tray if required. Loosely hand fit the M6 stainless steel screws fully into the inserts around the edge of the shower tray – if you splash screed onto the channel you'll still keep the screw holes clear. Sand & cement mix may then be applied liberally to the sub screed to hold the shower tray firmly in position after fitting. If necessary you can also screw the tray down around the edge of the shower tray in at least 4 positions, (one on each side - do not overtighten screws).

Step 4

Carefully clean out the channels running around the edges of the shower tray to remove any screed or other waste material to leave them clean, smooth and dry.

Remove the screws protecting the screw inserts.

Follow the steps on page 4 showing how to install the floor covering.

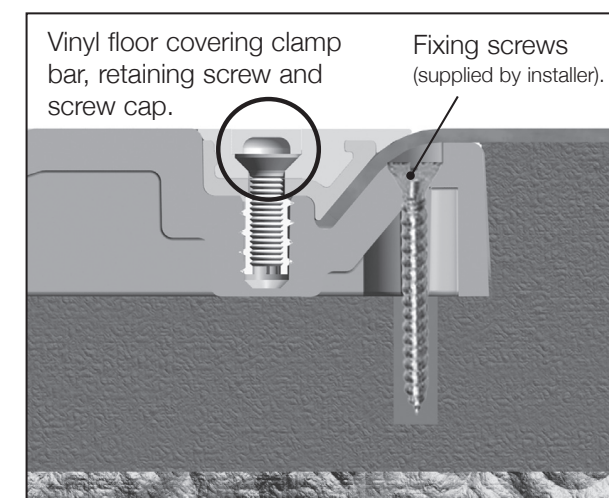
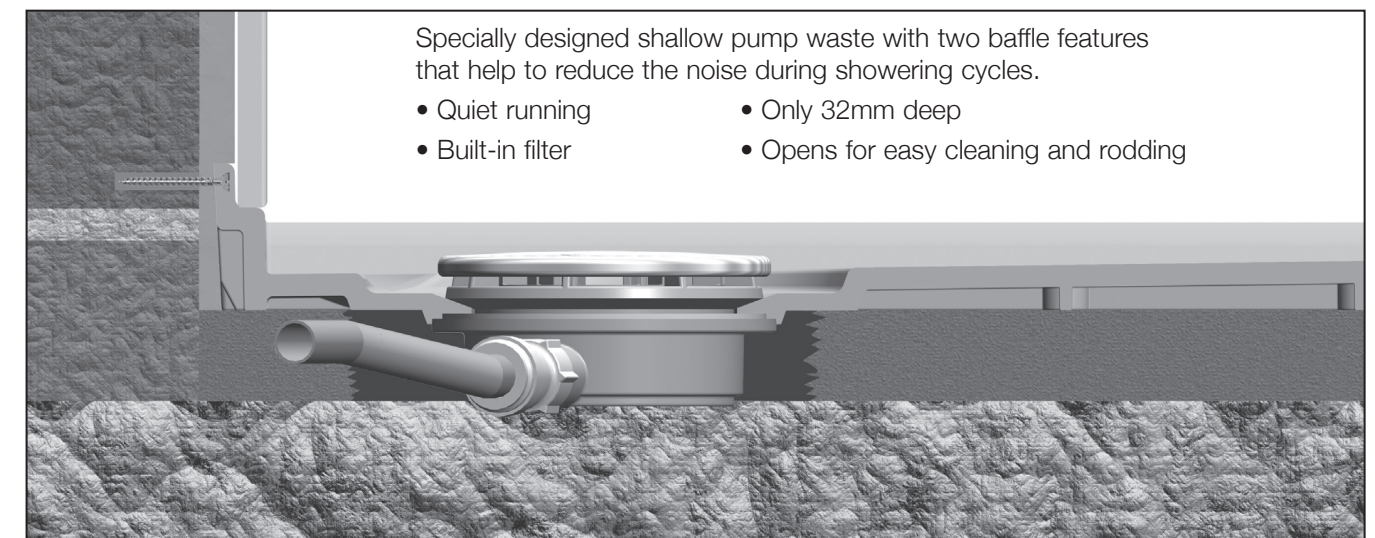

Completely level access

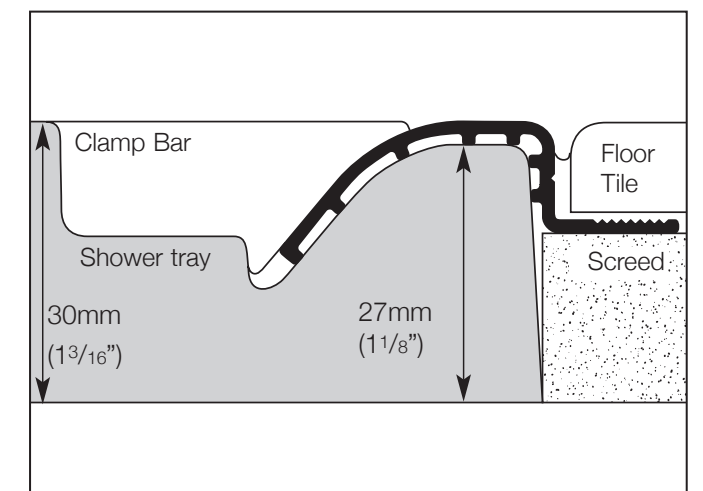

Floor Tiling Kit / Detail