

# Navlin Corner Wash Basin

**AKW**  
Life Made Better

## INSTALLATION INSTRUCTIONS

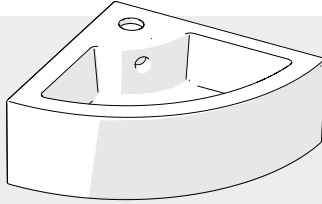

Stock code  
**23548**

**Installation must be carried out in accordance with these instructions, and must be conducted by a qualified and competent installer.**

### Important

This product must be installed in compliance with Water Regulations. Access must be made available to the water supplies and fixings for future maintenance and servicing. Make sure all fixing holes are used and do not over-tighten the fixings. Before fixing any unit to the walls, ensure that the construction of that wall type is capable of the maximum weight of the loaded unit and the appropriate fixings and fixtures are used for that wall type.

### Before you start

Please remove any protective covering and examine carefully. Check that all items are present before discarding of all packaging. Please notify the retailer immediately of any damage or faults. The manufacturer cannot be held responsible for any installation costs that may arise from damaged or faulty products being installed and not in accordance with these instructions.

Keep small parts and packaging away from children and dispose all packaging in accordance with the local recycling authorities.

### Safety

- Handle ceramics with extreme care.
- This product is heavy and may require two people to carry.
- Have the correct tools available.
- When drilling walls or floors, check first for hidden pipes and cables.
- Use safety eye wear when drilling.



# Dimensions & Instructions

## Dimensions

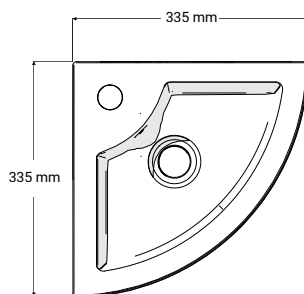
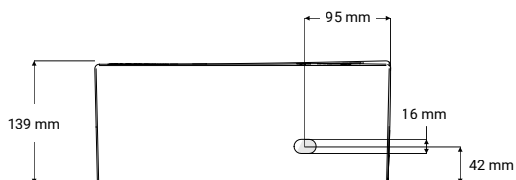

## Instructions

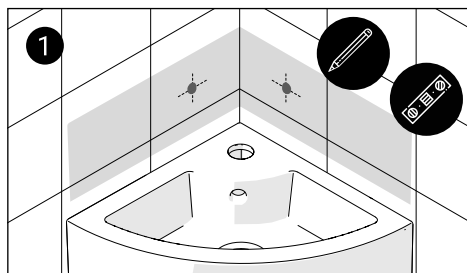

1 Ensure that the washbasin is level and mark the desired fixing location using the holes in the washbasin as a guide.

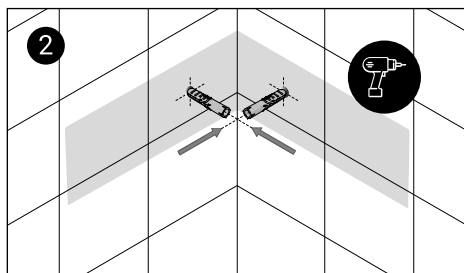

2 Drill holes and insert the wall plugs.

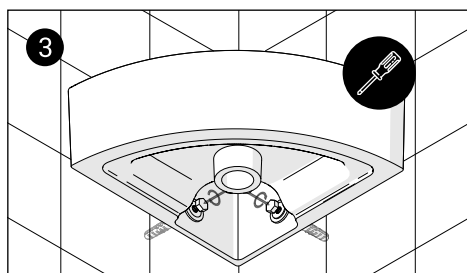

3 Offer the basin up to the wall. Ensure washbasin is level before tightening the wall fixings. Apply sealant around the washbasin and wall.

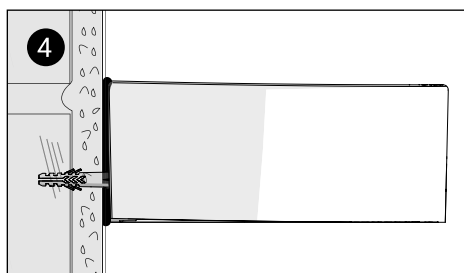

4 Secure the washbasin to the wall and do not over-tighten fixings. Remove any excess sealant. Fit the tap and waste pipe in accordance with the manufacturer's instructions.

## Cleaning

To optimise the performance and durability of the washbasins, we recommend the following basic regular maintenance programme:

- Rinse off soap and water deposits and dry the surface using a squeegee or a soft cloth.
- Remove hard water stains with a non-abrasive daily cleaner and rinse thoroughly with warm soapy water and wipe dry with a soft non-abrasive cloth.
- Do not use any abrasive products, cloths, strong or concentrated acidic, alkaline, chlorine such as bleach, ammonia, caustic soda, white spirit and sterilising solutions. Leaving neat bleach or other abrasive cleaning materials in the washbasin can cause damage and may discolour or otherwise damage the product and will invalidate the warranty.
- Do not drop hard materials into or against the ceramic.

**Note:** The durability of material surfaces may be affected by the frequency of use, water hardness and the type of cleaning compounds and methods used. Such matters are outside the control of the manufacturer and are not covered by any warranty.

These instructions are provided to advise the minimum standards of installation and recommends what the best practice for the installation is. Due to the very wide variability of possible installation conditions, AKW cannot provide all circumstances for the installation. AKW cannot accept any liability in connection with this information or its use. This information is provided on the condition that the person receiving it shall make his/her own tests to determine the suitability for the particular purpose.

# Contact Us

**AKW**  
Life Made Better

## Orders & Quotes

01905 823 299  
orders@akw-ltd.co.uk

## General Enquiries

01905 823 298  
sales@akw-ltd.co.uk

## Technical Enquiries

01905 560 219  
tech@akw-ltd.co.uk

## Kitchen Enquiries

01905 823 262  
kitchens@akw-ltd.co.uk

## Fax

01905 823 297

## AKW

Pointon Way, Hampton Lovett  
Droitwich Spa, WR9 0LR

[www.akw-ltd.co.uk](http://www.akw-ltd.co.uk)  
[orders.akw-ltd.co.uk](http://orders.akw-ltd.co.uk)

## Follow us on Social:



## Warranty

Warranty applies only to manufacturing or material defects, conditional on the one-time correct installation of the product. It does not apply to:

- Inappropriate use or accidental damage.
- Damage or defects that result from incorrect installation.
- Lack of maintenance including the build up of grime or damage resulting from inappropriate cleaning.
- Damage or defects that result from repairs or modifications undertaken by unauthorised persons.
- General wear and tear through usage and does not apply to surface finishes.

Warranty period starts from the date of installation. See the T&Cs on our website for further information.

### Select 1 of 2 ways to activate your warranty



#### 1. Scan using your Smart Device



#### 2. Visit Online

[akw-ltd.co.uk/warranty-information](http://akw-ltd.co.uk/warranty-information)

### What to do if something goes wrong?

In the event that you encounter a problem with this product, follow the trouble shooting guide if applicable, then contact your local installer. If the issue is still unresolved, contact AKW Technical Enquiries who will provide further advice and arrange for a maintenance engineer to visit if necessary. None of the foregoing affects your statutory rights.