

# 2 DOOR QUADRANT

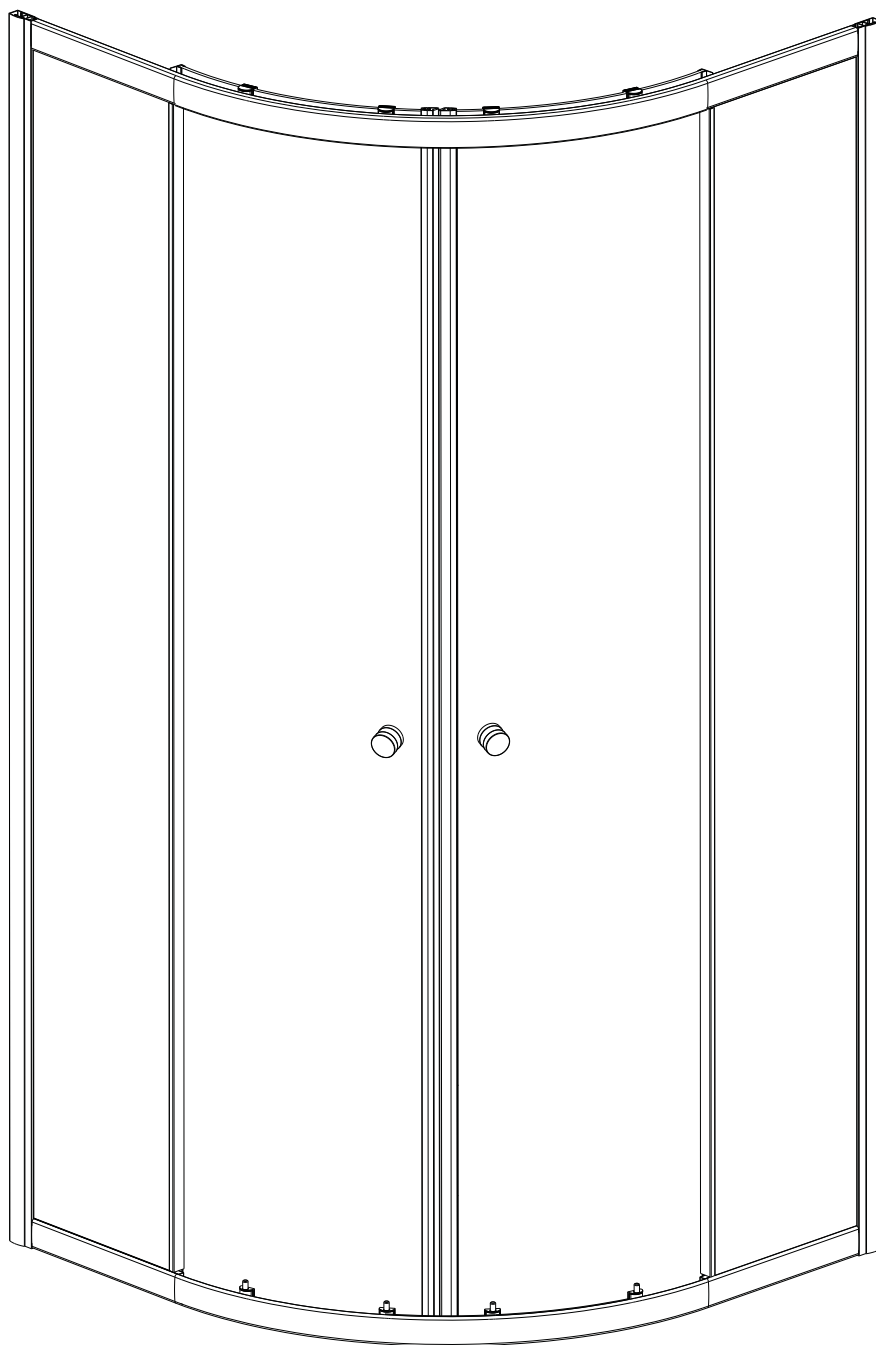

## INSTALLATION GUIDE

Size	Product code	Adjustment	Opening space
800	A1202A0	770-790	400
900	A1202B0	870-890	540
800x1000	A1202D0	770-790/970-990	470
800x1200	A0202H1	770-790/1170-1190	470
900x1200	A0202I1	870-890/1170-1190	540

## ATTENTION

If you install the product in a way that differs from this manual this will void all guarantees. Before installation check that the product meets all your requirements and is not damaged. By proceeding with installation, You accept the condition of the product. The wall plugs supplied with the installation kit are for use in solid walls. Hollow or 'stud partition' walls will require alternative fixings. Please consult your local hardware supplier for the correct type.

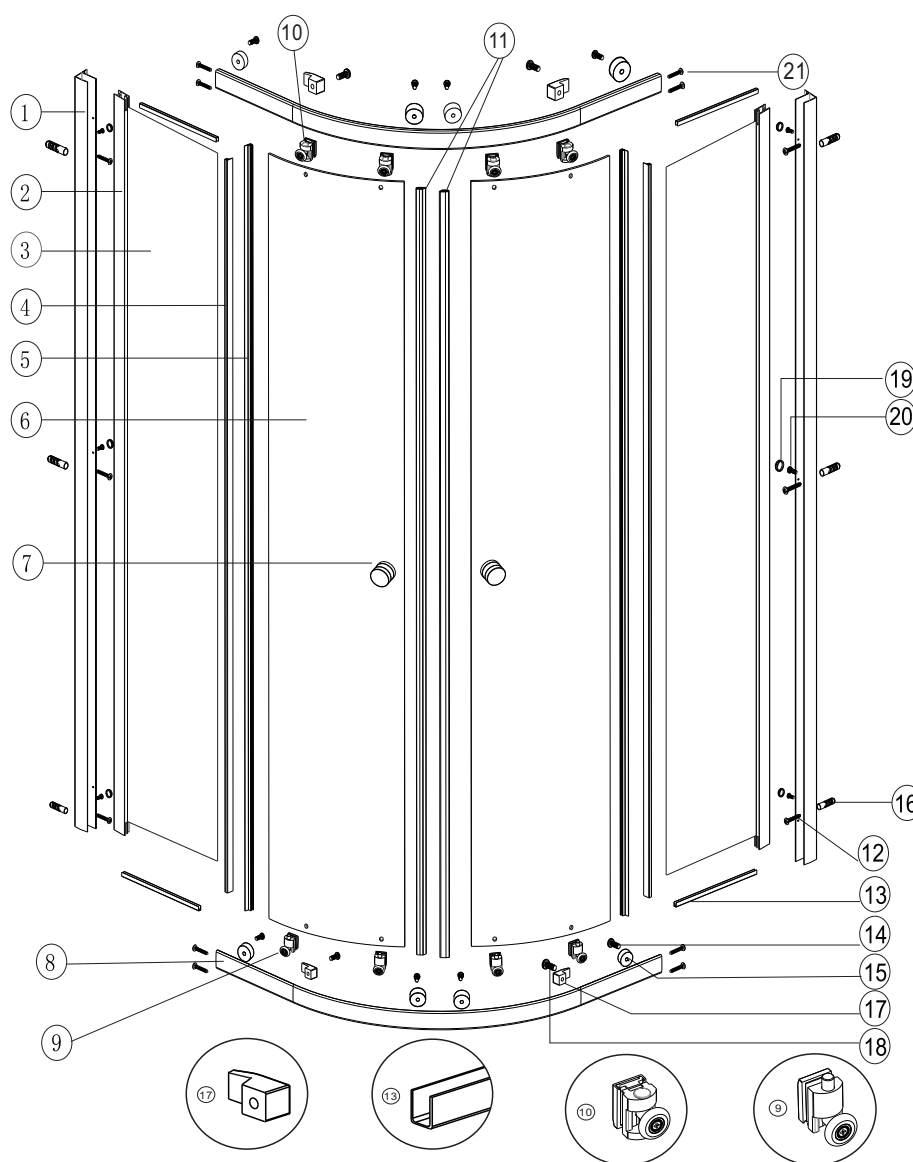

No.	Qty	Part No.
1	2	A02S0020
2	2	A12S0004
3	2	A
4	2	A12S0012
5	2	A12S0016
6	2	B
7	2	A12S0023

No.	Qty	Part No.
8	2	C
9	4	D6026
10	4	D6027
11	1	A12S0007
12	6	2SY51
13	4	A12S0055
14	8	2SY59

No.	Qty	Part No.
15	8	C073
16	6	2SP12
17	4	A12S0020
18	4	N124
19	12	C070
20	6	2SY50
21	8	N081

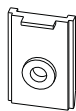
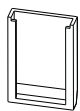
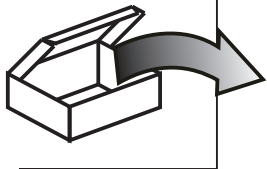

D6027  
x4

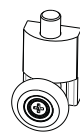

D6026  
x4

4x30mm

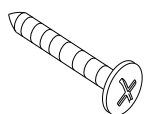

2SY51  
x6

4x16mm



2SY50  
x6



2SP12  
x6



C070  
x12

Ø3mm

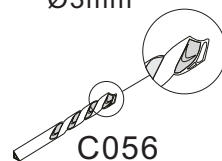

C056  
x1

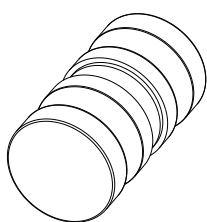

A12S0023  
x2

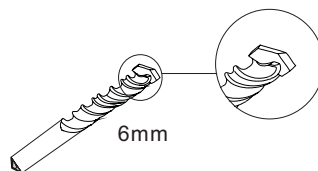
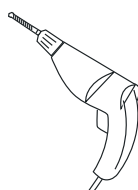
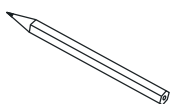

6mm

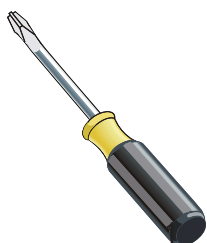

PH2

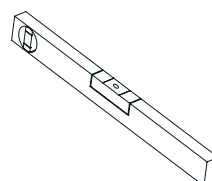
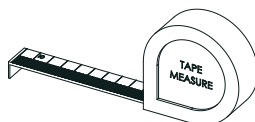

Please ensure your tray is 100% level in all directions before fitting your enclosure.

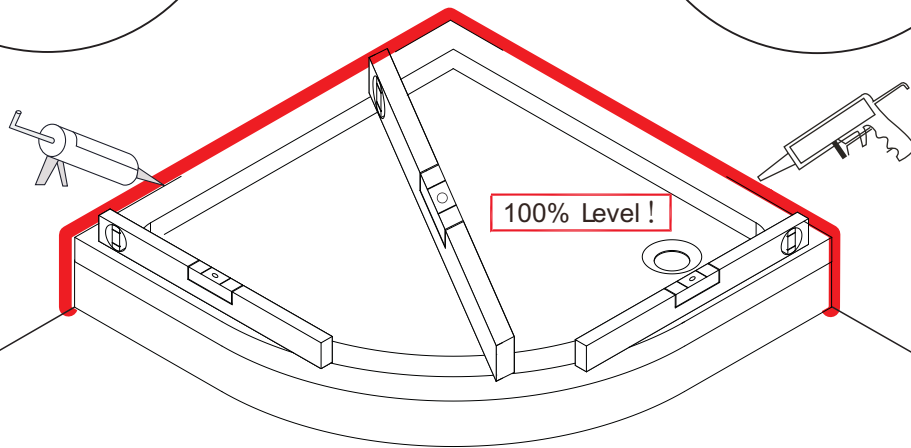

1

Determine your step in from the edge of the tray. Measure your x and y dimension. Your measurements must fall within the below table of adjustments .  
Level your wall profiles and mark the points of fixing.

CODE	X	Y
A1202A0	770-790	770-790
A1202B0	870-890	870-890
A1202D0	770-790	970-990
A1202H1	770-790	1170-1190
A1202I1	870-890	1170-1190

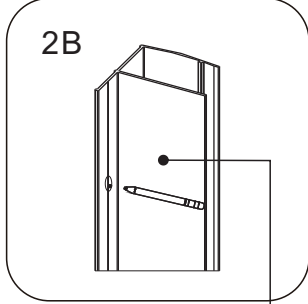
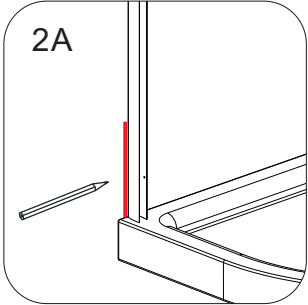
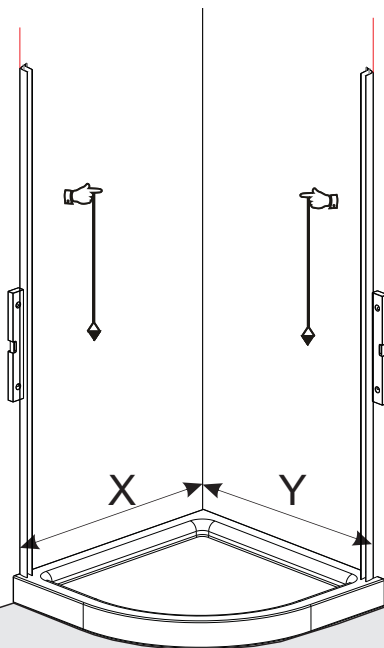

A02S0020

2

Remove the wall profiles and use a 6mm masonry drill bit to drill the holes for your fixings and place the wall plug into the holes.

3

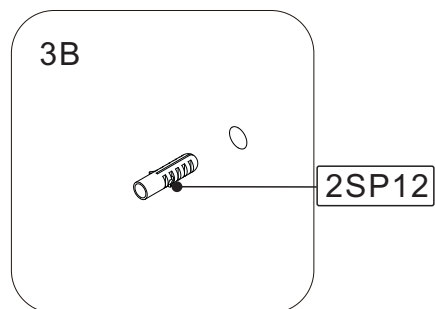
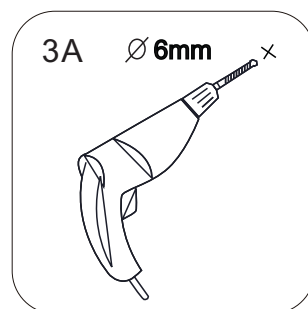
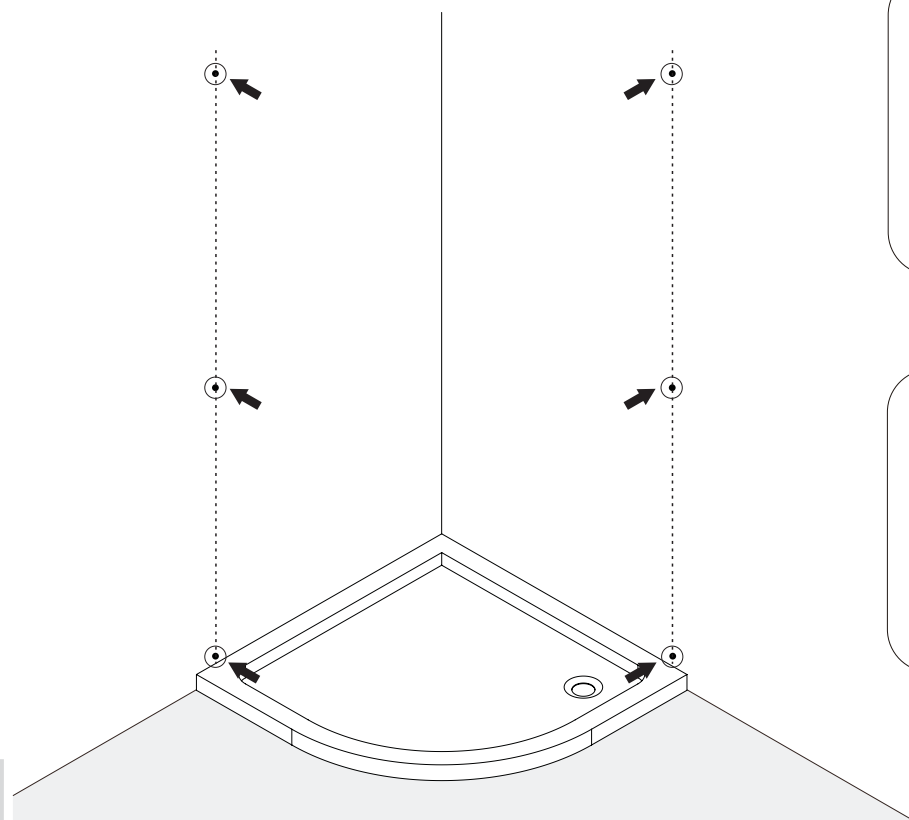

Fit your fixed panels seals to the top and bottom of each fixed panel.

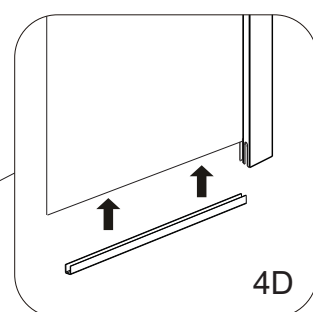
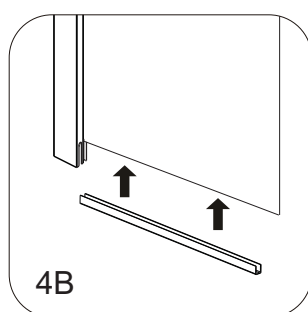
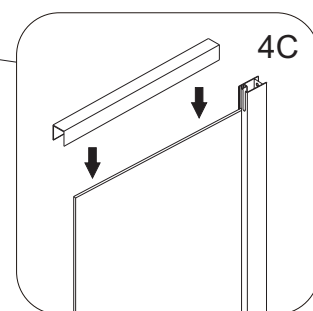
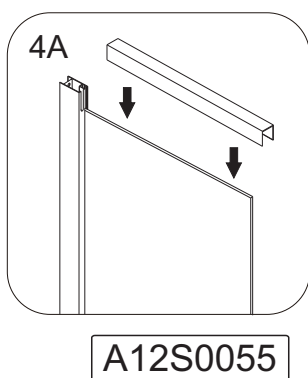

4

Loosen A12S0020 before you fit your top and bottom profile to the upright profile.

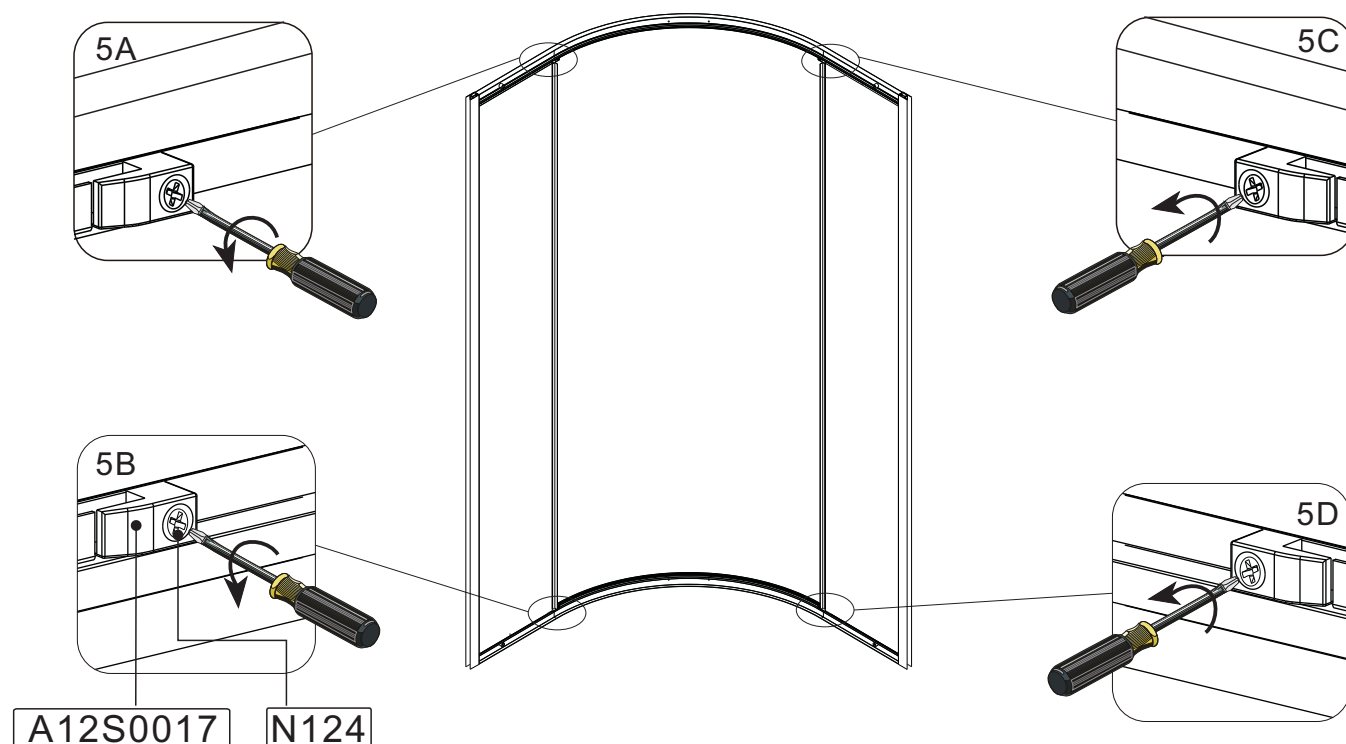

5

Slot the top and bottom profile fixing screws into the slots in the upright profile.

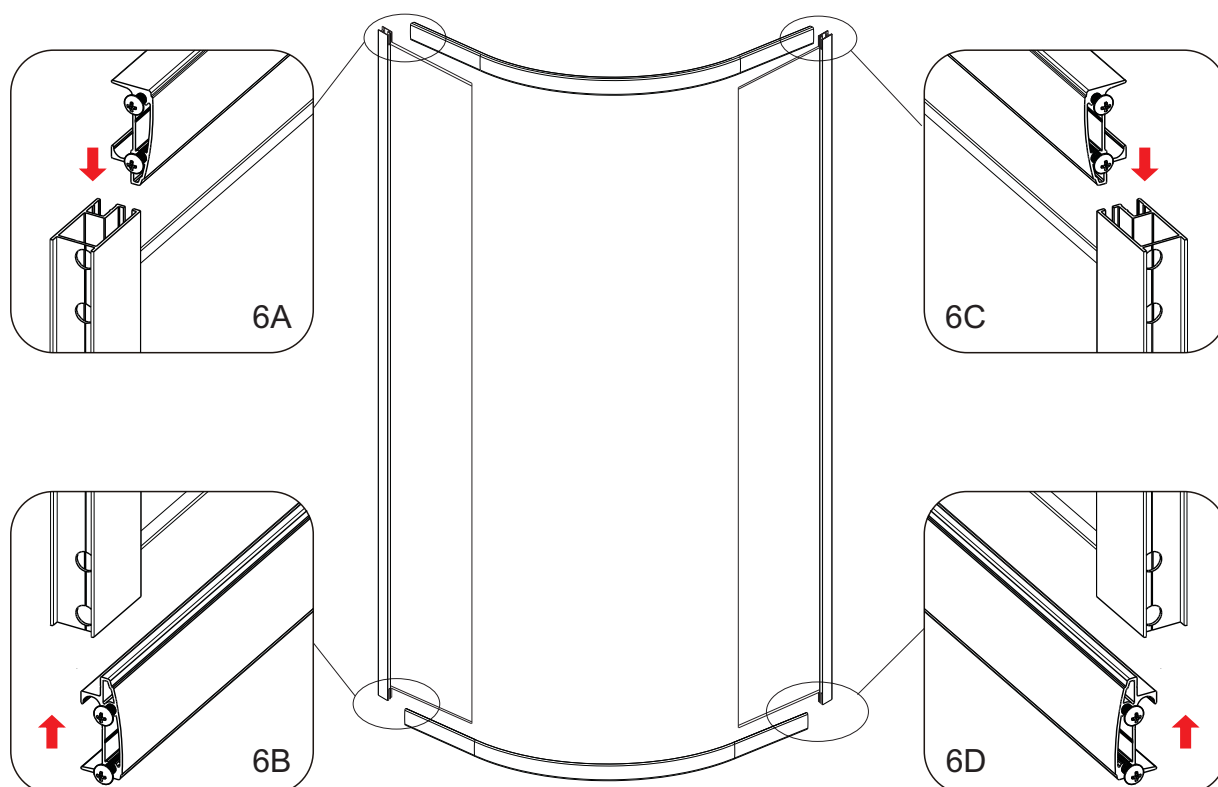

6

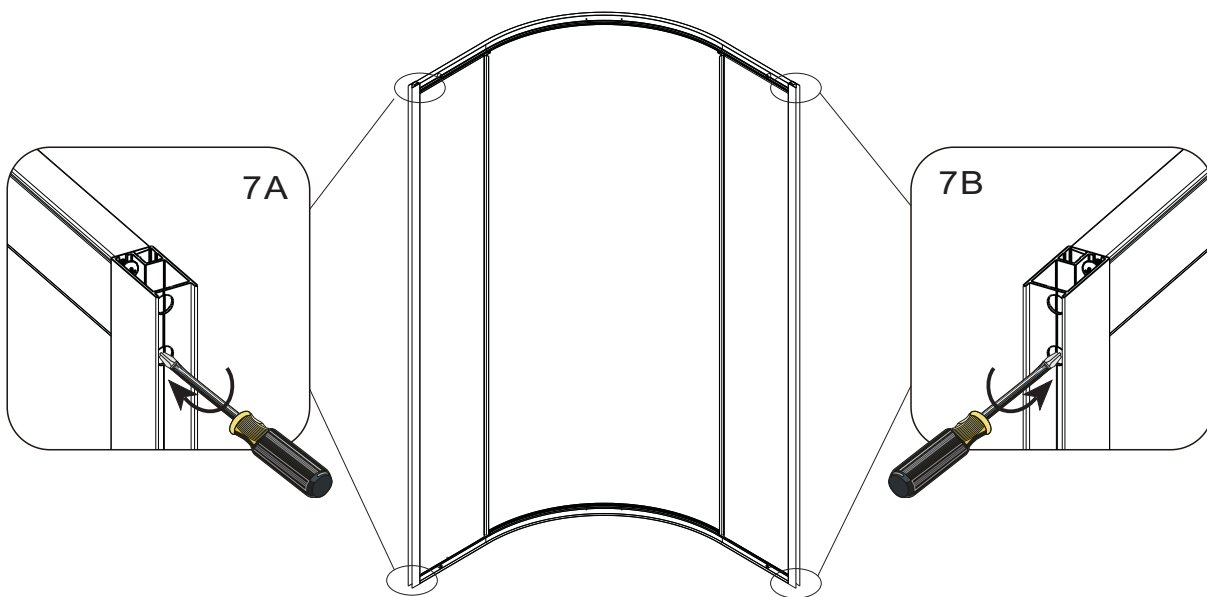

Note: Do not over tighten the screws

7

Tighten A12S0020 onto the fixed panel to secure the glass.

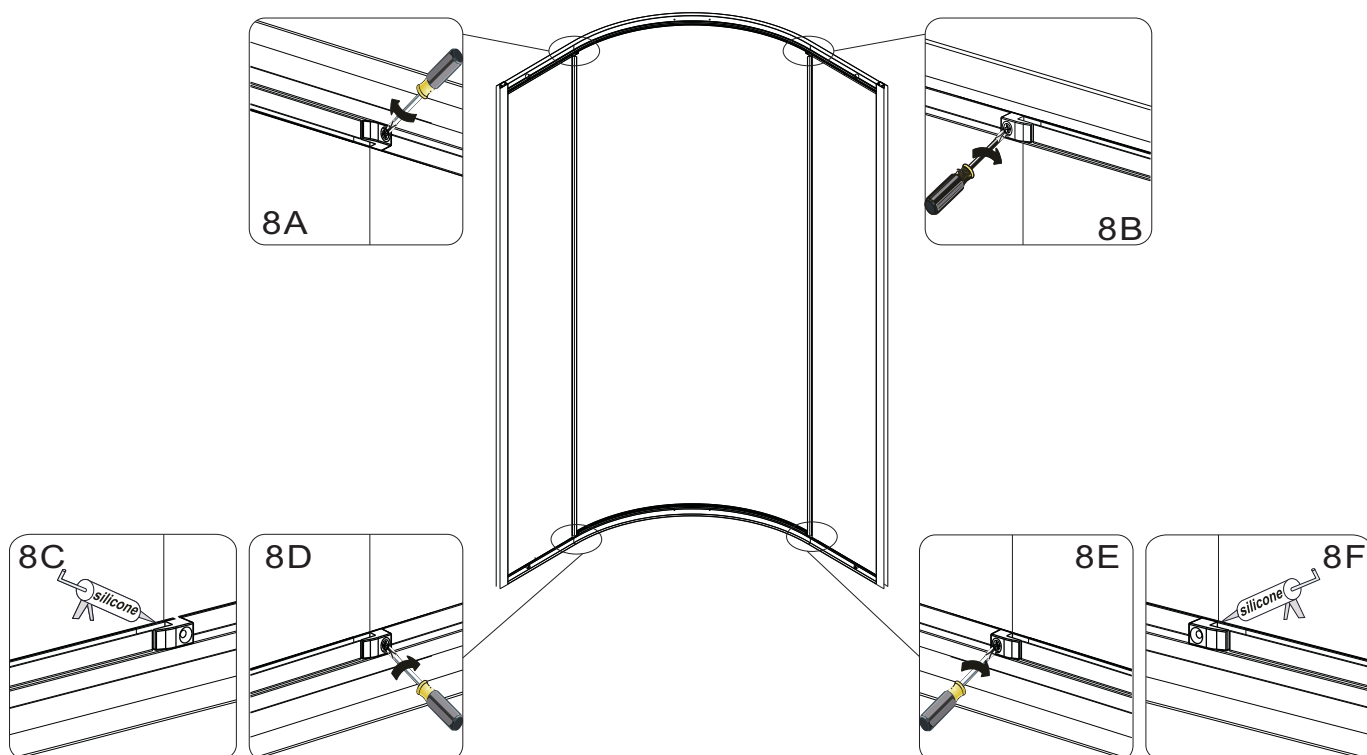

8

6

Fix the wall profile to the wall. Push your fixed panel assembly including your top and bottom profile into your wall profile. Do not yet fix your upright profiles to the wall profiles.

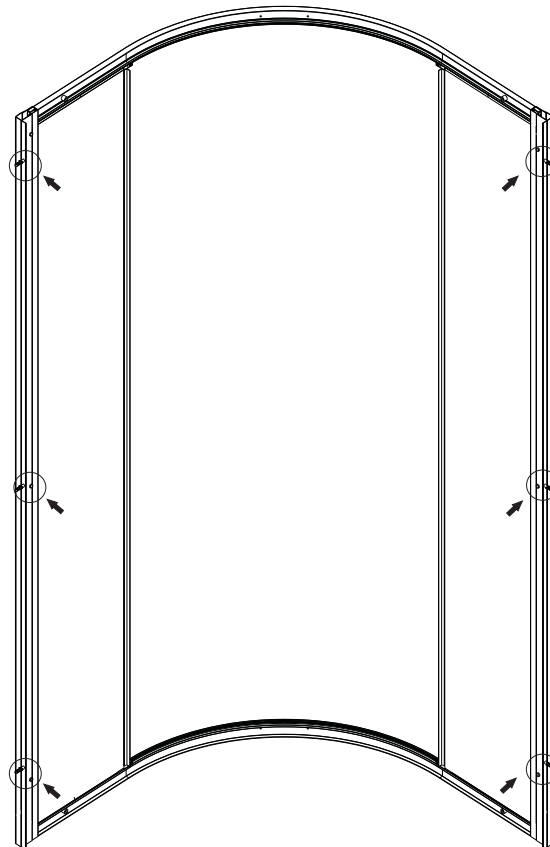
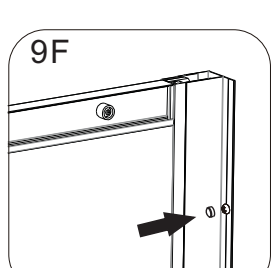
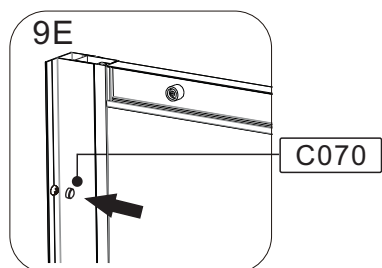
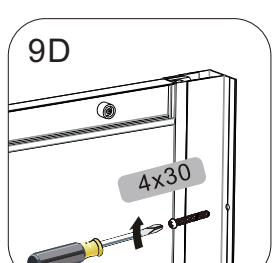
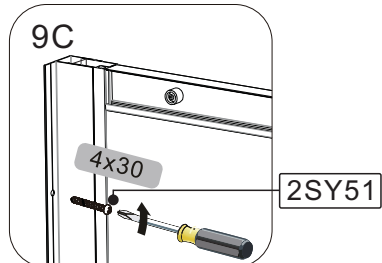
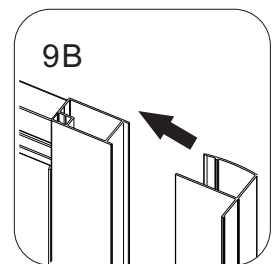
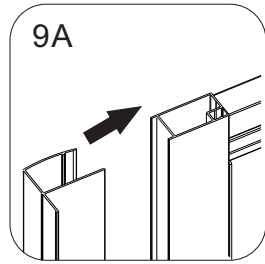

9

After your wall profiles have been fixed you can square your enclosure on the tray and fix the wall profiles to the upright profiles as shown below.

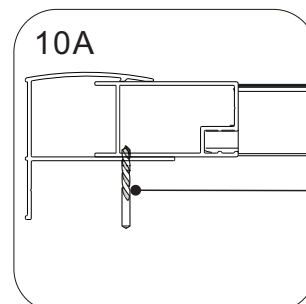
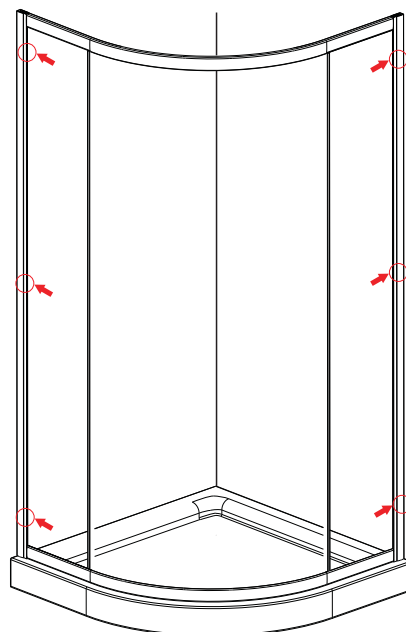

C056  
(Ø3mm)

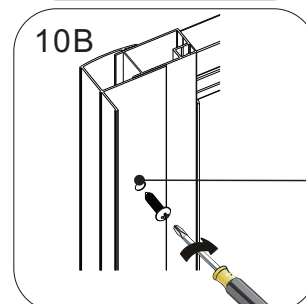

2SY50

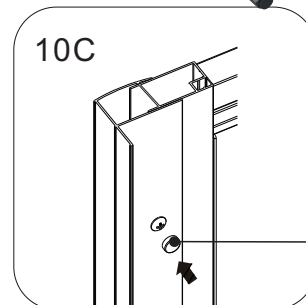

C070

10

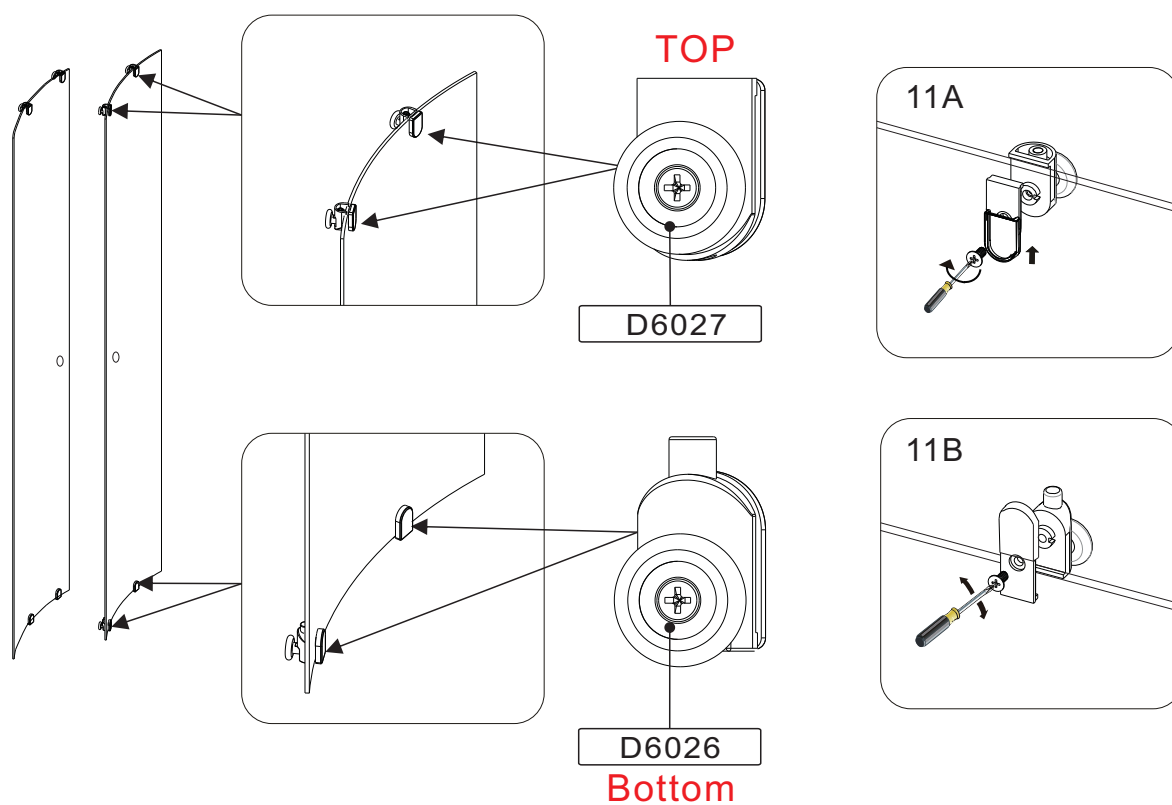

11

To fit your door panel firstly hange the top roller to support the weight of the glass panel. You can then leave your door panel hang making it easier to release your easy clean roller into the bottom track.

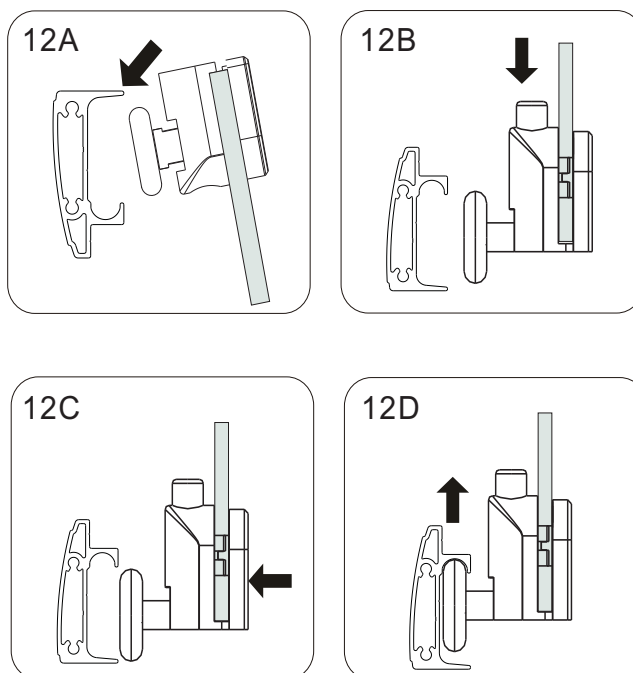
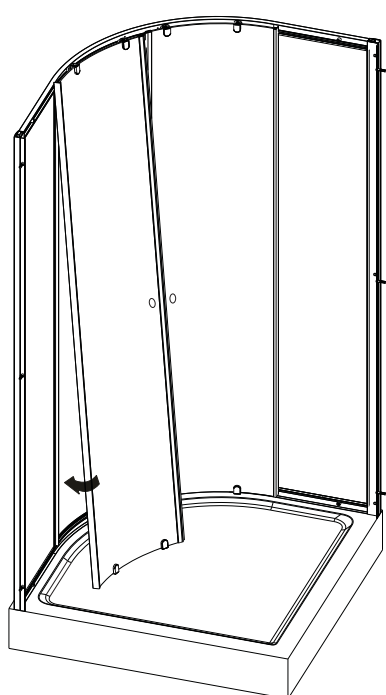

12

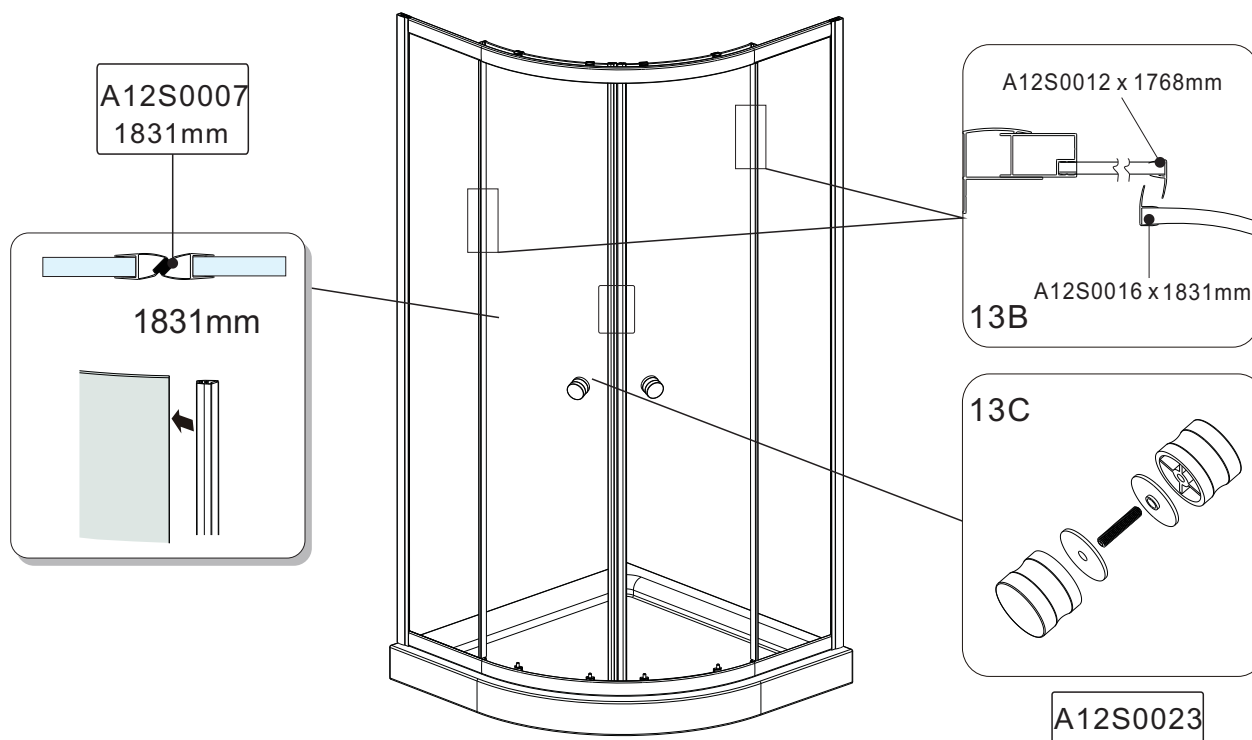

13

You can adjust the gaps between the two door panels by turning the adjustment screw in the top roller.

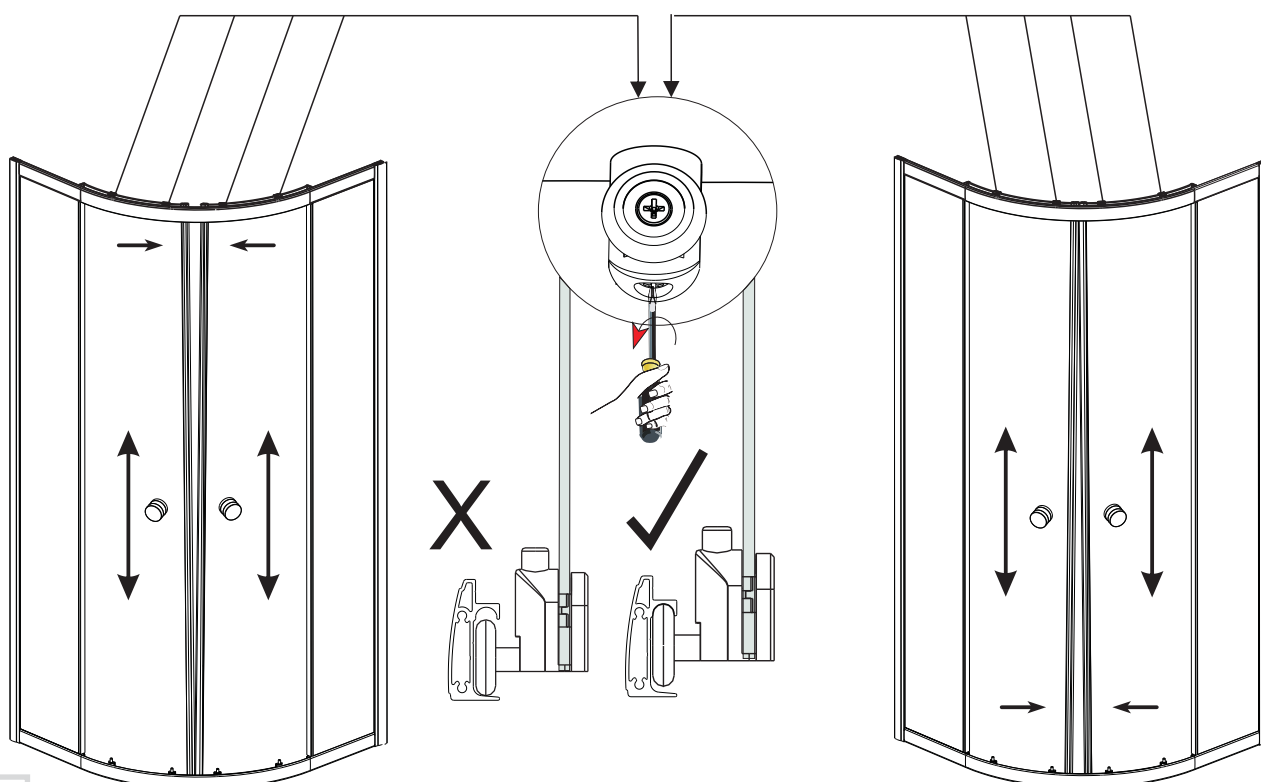

14

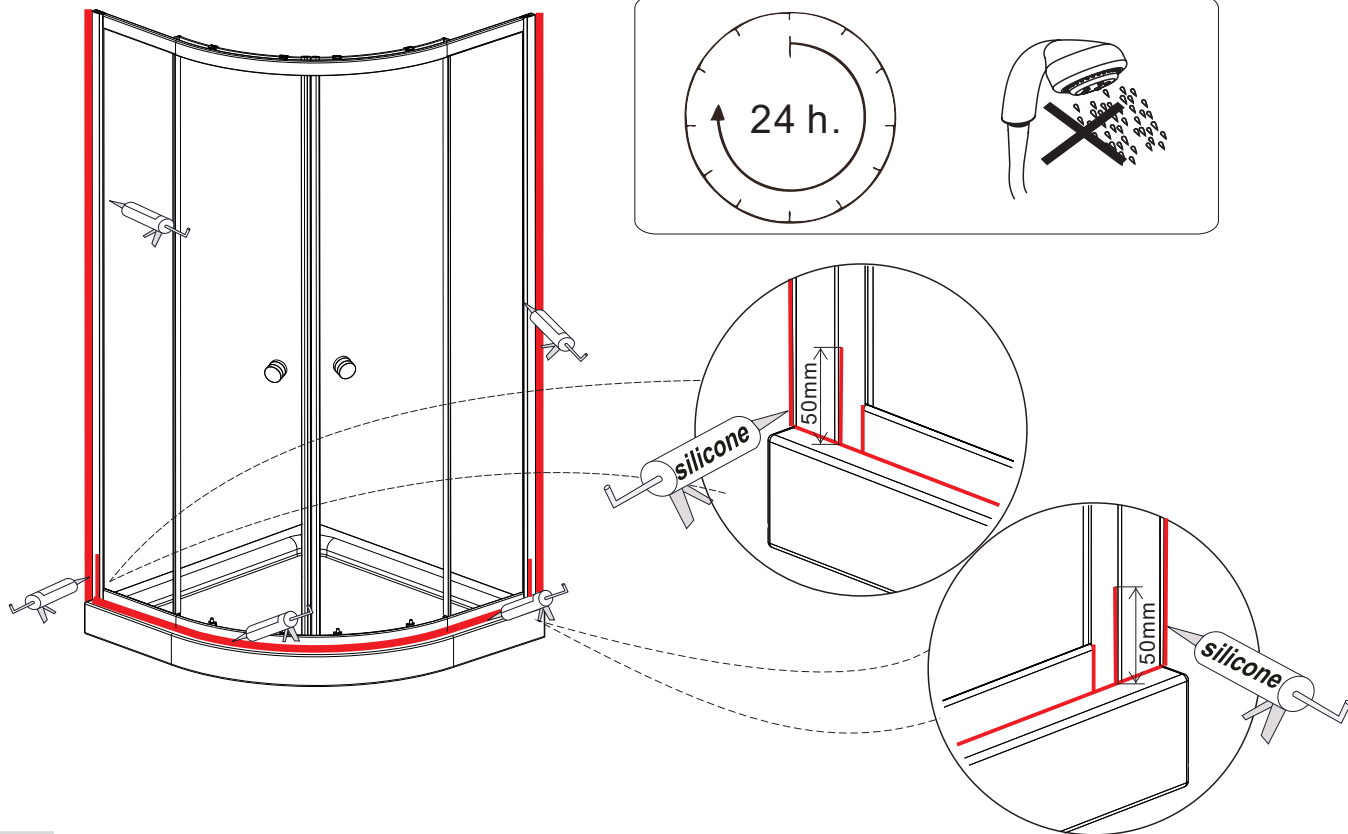

13

<b>CE</b>	
Pioneer Bathrooms Ltd	
15	
<b>EN 14428</b>	
Shower enclosures with aluminium profiles and safety glass	
Cleanability	: Pass
Impact resistance/shatter properties	: Pass
Durability	: Pass