

Gummers
Timed Flow Control

Product Code	Finish/Model Type
MEFC2000ECP	Chrome - Exposed
MEFC2000CCP	Chrome - Concealed

Weblink
<http://www.specifybristan.com/MEFC2000>

- 60 second time delay allows adequate showering time whilst managing water use
- Flow regulator included for water economy
- Option of BREEAM compliance when installed with supplied flow regulator
- High flow rate at pressures as low as 0.1 bar



MEFC2000CCP



Education
Sports & Leisure

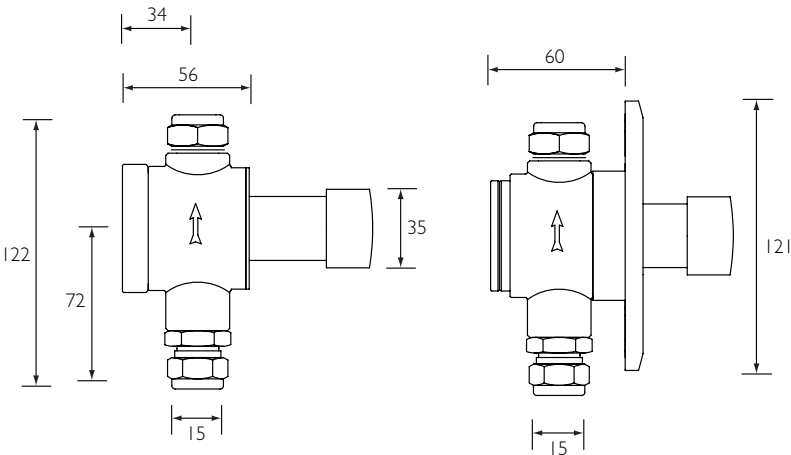

Recommended items: visit www.specifybristan.com

- Thermostatic mixing valves
- Showerheads and arms
- Slide bar shower kits

All measurements in mm (unless stated otherwise)
Inlet connection 15mm
Outlet connection 15mm

Performance with open outlet <i>*with flow regulator fitted</i>								
Pressure Drop	0.1	0.2	0.5	1	2	3	4	5
Flow Rate	9	13	*7	*7	*7	*7	*7	*7

Product Code

MEFC2000ECP
MEFC2000CCP

Pressures

- Minimum pressure drop: 0.1 bar
- Maximum dynamic pressure: 4 bar
- Maximum static pressure: 10 bar