

## RENAISSANC Tap Range

Renaissance Mono Basin Mixer With Pop Up Waste Chrome



## Features:

- Supplied with pop-up waste
- Chrome plated to BS EN 248
- Ceramic disc
- Metal fixing nut

## Product Certifications:

WRAS Certificate Number: 1307035  
WRAS Expiry Date: 31/07/2018



For more products, visit our website:



### Specification

Style:	Traditional
Product Type:	Bathroom Taps
Finish/Colour:	Chrome
Main Construction Material:	Brass
Mount Type:	Deck Mounted
Handle Type:	Lever
Connection Inlet:	M12 x 15mm Screw-in Copper Connection Pipes
Number of Tap Holes Required:	1
Valve/Cartridge Type:	1/4 turn 1/2" Ceramic Disc
Plumbing System Suitability	All
Working Pressure Range:	Min. 0.2 bar, Max. 5.0 bar
Maximum Hot Water Temperature: °c	65
Maximum Dynamic Pressure: (bar)	5
Maximum Static Pressure: (bar)	10
Flow Type:	Single
Flow Rate: (l/min @ 3 bar)	54.4
Connection Outlet:	M24 Antisplash
Isolation Included:	No

Dimensions (measurements in mm)

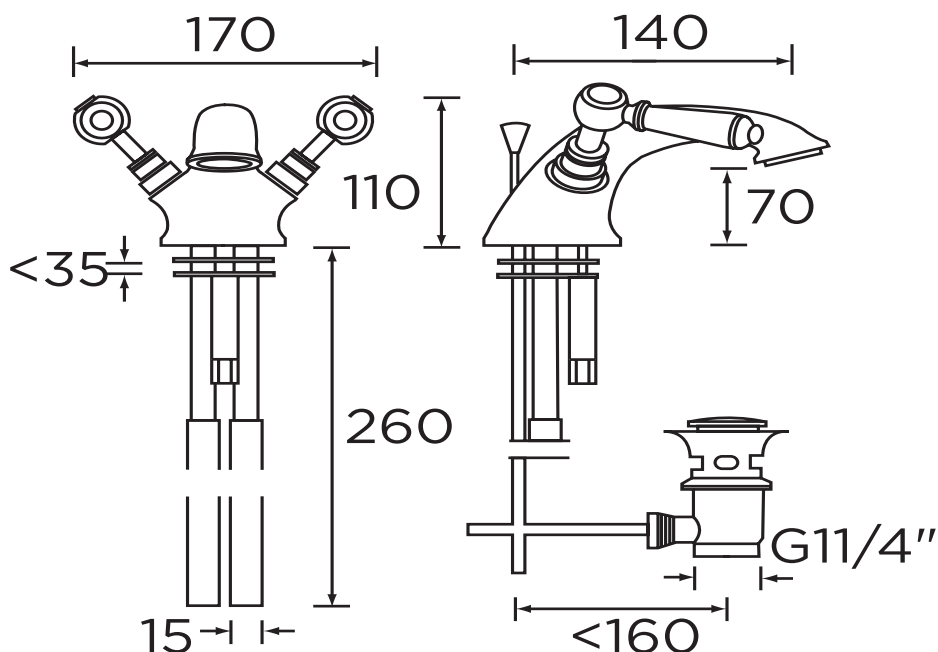

## Flow Rates (l/min)

System Pressure (bar)	0.2	0.5	1	2	3	5
RS BAS C	12.4	21.4	31	44.2	54.4	70.3

# TECHNICAL DATA SHEET



**BRISTAN**  
TAPS & SHOWERS

D5

Bristan, Birch Coppice Business Park, Dordon, Tamworth, B78 1SG. Telephone: 0844 701 6274. Facsimile: 0844 701 6275. Web Site: [www.bristan.com](http://www.bristan.com) Email: [enquire@bristan.com](mailto:enquire@bristan.com). The information contained on this page was correct at date of issue. Fitting Dimensions are provided as a guide only. Some variation may occur due to manufacturing tolerances. Bristan pursues a policy of continuing improvement in design and performance of its products and so reserves the right to change specifications without prior notice.

