

CHOICES TAP RANGE

Choices Bath Taps Chrome Plated

Product Specification

Product Code:

Finish:

Product Type:

Construction:

Cartridge Type:

Supply:

Inlet Connections:

Working Pressures:

CHC ¾ C

Chrome

Contemporary

Body is of brass construction and is designed to conform to BS EN 200

1/4 turn ¾" Ceramic Disc Valves

Suitable for all plumbing systems

¾" BSP

Min 0.2bar, Max 5.0bar



*shown with CHC SNUB C handles

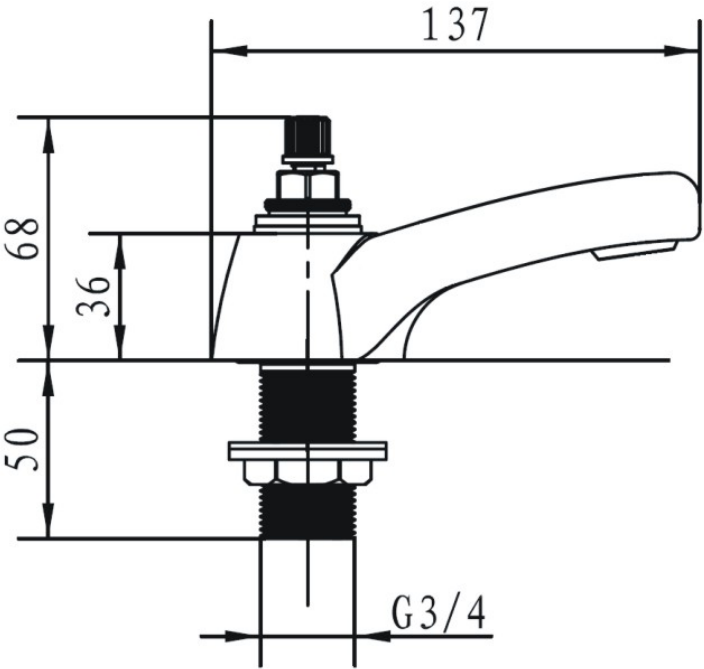

Additional Information

- Handles available separately.
- Chrome plated to BS EN 248.
- Supplied with metal backnuts

Technical Advice:

Guarantee:

For further information please call 0844 7016273

or email customer@bristan.com

5 years covering manufacturing faults.

Flow Rates (litres per minute)

System Pressure	0.2bar	0.5bar	1.0bar	2.0bar	3.0bar	5.0bar
CHC ¾ C	16.4	28.0	38.9	55.0	67.3	86.9