



Features:

- Metal Backnuts
- Ceramic Disc
- Product supplied without heads
- Chrome plated to BS EN 248

Specification

Style:	Contemporary
Product Type:	Bathroom Taps
Main Construction Material:	Brass
Mount Type:	Deck
Handle Type:	N/A
Connection Inlet:	3/4" BSP
Connection Outlet:	N/A
Number of Tap Holes:	2
Valve/Cartridge Type:	1/4 turn 3/4" Ceramic Disc Valves
Plumbing System Requirements:	All
Working Pressure Range:	Min. 0.3, Max. 5.0 Bar
Maximum Hot Water Temperature: °C	60
Maximum Dynamic Pressure: (bar)	5
Maximum Static Pressure: (bar)	10
Flow Type:	Single
Flow Rate: (l/min @ 3 bar)	15.2
Isolation Included:	No

Product Certifications:



WRAS Certificate No: 1505951
WRAS Expiry Date: 31/05/2020



Dimensions (measurements in mm)

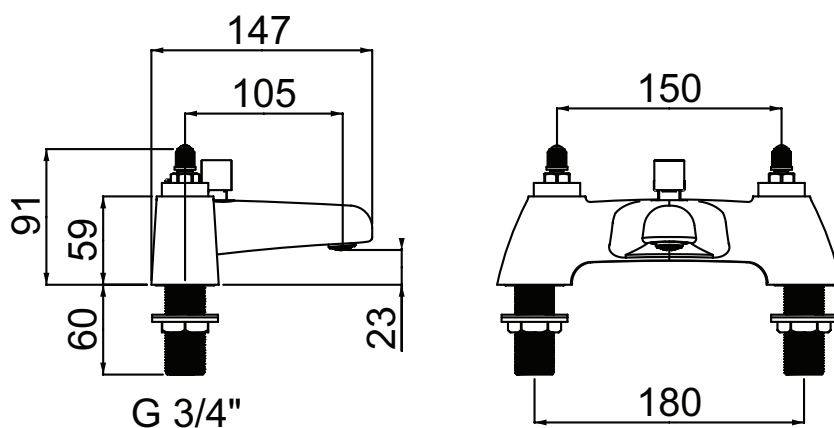

For more products, visit our website:
<http://www.bristan.com>

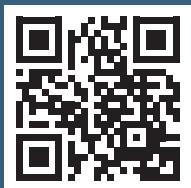

Flow Rates (l/min)

System Pressure (bar)	0.3	0.5	1	2	3	5
Bath Filler	19.5	25.7	27.2	38.4	47.1	60.8
Handset	4.3	5.9	8.8	14.4	15.2	19.6

TECHNICAL DATA SHEET



BRISTAN

TAPS & SHOWERS D3