

TECHNICAL DATASHEET

RUBY

RUBY MONOBLOC SINK MIXER

Product Specification

Product Code:	RU SNK C
Finish:	Chrome
Product Type:	Contemporary
Construction:	Body is of brass construction and is designed to conform to BS EN 817
Valve Type:	40mm ceramic disc cartridge
Supply:	Suitable for all plumbing systems, ideally balanced
Inlet Connections:	M12 x 15mm screw-in copper connecting pipes
Water Pressure:	Min. 0.2 bar, Max. 8.0 bar

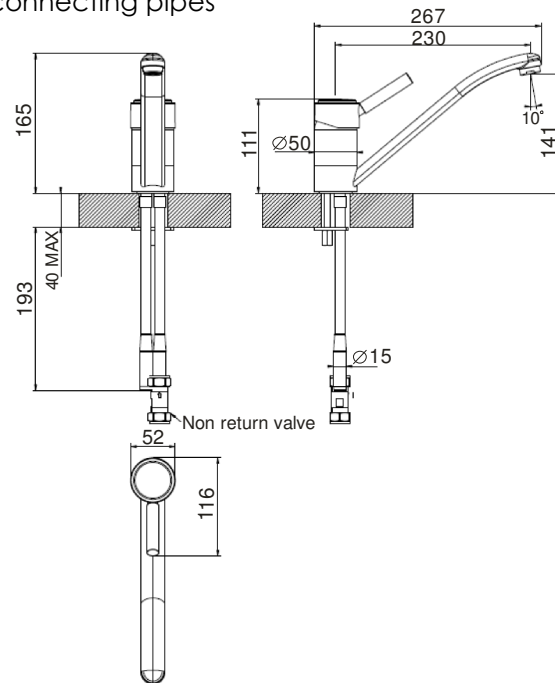
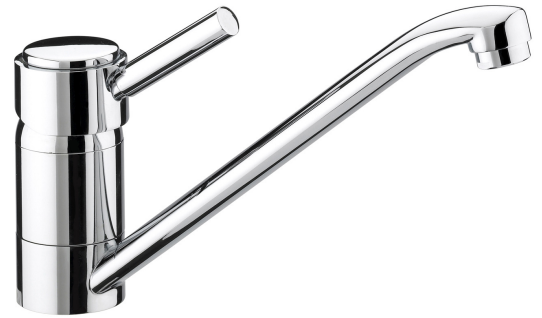

Additional Information

- Chrome plated to BS EN 248.

Technical Advice: For further information please call 0844 7016273 or email customer care@bristan.com.
Guarantee: 5 years covering manufacturing faults.

Compliance/Approvals

WRAS: Certificate No. 0812334

Flow Rates (litres per minute)

System Pressure	0.2bar	0.5bar	1bar	2bar	3bar	5bar
RU SNK C (mixed)	3.9	7.5	11.2	16.2	19.9	25.4

AFTERCARE INSTRUCTIONS

Your fitting has a high quality finish and should be treated with care to preserve the visible surfaces.

All surface finishes will wear if not cleaned correctly, the only safe way to clean your mixer is to wipe with a soft damp cloth. Stains can be removed using washing up liquid. All bath cleaning powders and liquids will damage the surface of your fitting, even the non-scratch cleaners. **NOTE: Never use abrasive detergents or disinfectants or those containing alcohol, hydrochloric acid or phosphoric acid.**

Bristan recommend E-Cloth for cleaning all of our bathroom & kitchen products. Using just water, E-cloth gives a smear free, deep clean by breaking up and holding dirt, which normal cloths leave behind. Order through your Bristan stockist. (ORDER CODE: ECLOTH)



GUARANTEE

All products are manufactured to the highest standards and a 5 year guarantee covers any defect in manufacture.

All products must have access for servicing or replacement during the life of the product.

In the interests of continuous product development we reserve the right to alter specification as necessary

PRODUCT CODE: RU SNK C

PRODUCT IDENTIFICATION CODE LASER ETCHED ON PRODUCT
Installer please fill in code here _____.(Where applicable)

TELEPHONE HELPLINE: 0844 701 6273

Bristan Group Limited
Birch Coppice Business Park
Dordon
Tamworth
Staffordshire
B78 1SG
UK
A Masco Company
Website: www.bristan.com
Telephone: 0844 701 6274
Facsimile: 0844 701 6275
Email: enquire@bristan.com

BRISTAN

Ruby Single Lever Sink Mixer

Fitting Instructions & Content List

Before starting any installation project please consider:

Prior to drilling into walls, check there are no hidden electrical wires, cables or water supply pipes with the aid of an electronic detector. If you use power tools do not forget:

- Wear eye protection
- Unplug equipment after use



Please keep these instructions for future reference and request of replacement part

WATER PRESSURE

This mixer is suitable for use at a minimum supply pressure of 0.2 bar. However for optimum use both the hot and cold supplies should be reasonably balanced.

If the fitting is installed at low pressure (tank fed), then the minimum distance from the outlet of the nozzle to the underside of the cold tank should be approximately 2 metres to ensure adequate performance.

Operating Pressures: Min 0.2 bar, Max 7.0 bar.

This mixer should be installed in compliance with Water Regulations. For further details contact your Local Water Authority.

CONTENTS

- | | |
|---------------------|------|
| 1. Mixer Body | (x1) |
| 2. Sealing Washer | (x1) |
| 3. Threaded Rod | (x1) |
| 4. Rubber 'C' Plate | (x1) |
| 5. Metal 'C' Plate | (x1) |
| 6. Nut | (x1) |
| 7. Flexi Tail Pipes | (x2) |
| 8. Check Valves | (x2) |
| a. Cartridge | (x1) |
| b. Casing | (x1) |
| c. Locknut | (x1) |
| d. Shroud | (x1) |
| e. Handle | (x1) |
| f. Grub Screw | (x1) |
| g. Handle Cap | (x1) |

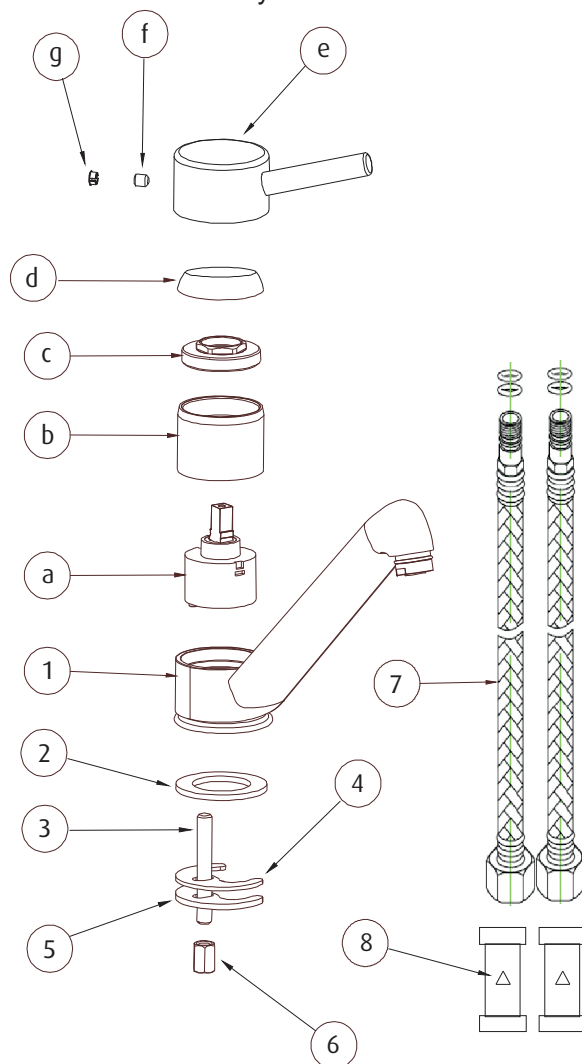

INSTALLATION

1. Identify all components and check for completeness, particularly before commencing installation.
2. Fit the mixer body (1) to the sink using the 'C' plate fixing kit. The sealing rubber washer (2) goes between the fitting and the sink, and the 'C' shaped and metal washers on the underside of the sink. The nut (6) is then tightened to the sink using the threaded rod (3).
3. Fit the flexi pipes (7) to the fitting **(BY HAND ONLY)** and **(DO NOT OVERTIGHTEN)**, then connect check valves (8) supplied to hot side (arrow on valve points upwards), then connect the hot and the cold supplies.
4. Fully open the mixer in the mid position for a few minutes letting the water flow to check all joints and connections for leaks.
5. See over the page for aftercare instructions.

MAINTENANCE

If the fitting begins to drip:

1. Turn off the water supply.
2. Remove cap (g) and grub screw (f), then remove handle (e) by pulling from the cartridge (a). Unscrew shroud (d), lock nut (c), and casing (b).
3. Remove cartridge by pulling out of mixer body. Once removed, carefully clean seating and all exposed parts.
4. Replace all of the above then turn on the water supply.
5. If problem persists contact our helpline quoting the product code.