

# TECHNICAL DATA SHEET

# BRISTAN

## CASCADE Basin Mixer

### Product Specification

|                    |   |
|--------------------|---|
| Product Code:      | CAS BAS C   |
| Finish:            | Chrome plated   |
| Product Type:      | Contemporary  |
| Construction:      | Bodies are of all brass construction and designed to conform to BS EN 200 |
| Valve Type:        | ½" CD valve ¼ turn  |
| Supply:            | Suitable for all plumbing systems   |
| Inlet :            | M10 15mm Compression Flexible Tails                                       |
| Working Pressures: | Min 0.2 Bar Max 5.0 Bar   |



### Additional Information

- Chrome plated to BS EN 248.
- Supplied with metal handles.

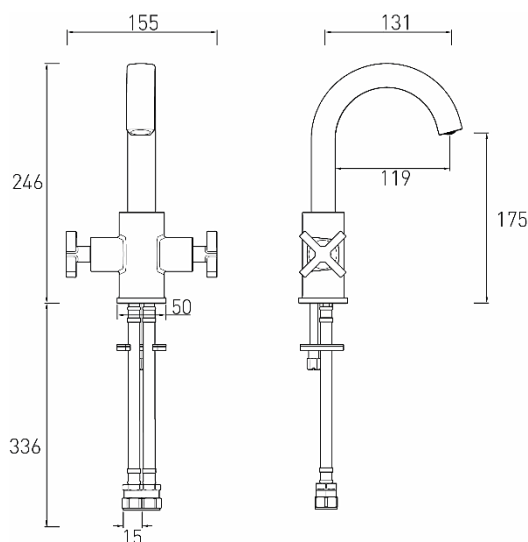

**Technical Advice:** For further information please call 0844 7016273 or email [customer care@bristan.com](mailto:customer care@bristan.com).

**Guarantee:** 5 years covering manufacturing faults.

### Flow Rates (litres per minute)

| System Pressure   | 0.2 bar | 0.3 bar | 0.5 bar | 1.0 bar | 2.0 bar | 3.0bar | 4.0bar | 5.0bar |
|-------------------|---------|---------|---------|---------|---------|--------|--------|--------|
| CAS BAS C (hot)   | 4.0     | 5.4     | 7.2     | 10.5    | 15.1    | 18.5   | 21.8   | 24.3   |
| CAS BAS C (cold)  | 4.0     | 5.4     | 7.3     | 10.6    | 15.3    | 18.7   | 22.1   | 24.5   |
| CAS BAS C (mixed) | 7.5     | 9.7     | 13.3    | 19.5    | 27.9    | 34.8   | 40.0   | 44.8   |