

# KG SNK EF G TO

## KINGSBURY Tap Range

Kingsbury Easyfit Sink Mixer Gold Tap Only



### Features:

- Metal fixing nut for added durability
- Product supplied without Easyfit base

### Product Certifications:



For more products, visit our website:  
<http://www.bristan.com>

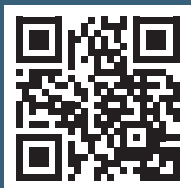

### Specification

Product Type:	Kitchen Taps
Main Construction Material:	Brass
Mount Type:	Deck Mounted
Handle Type:	Crosshead
Connection Inlet:	1/2" BSP Flexible Tails
Connection Outlet:	
Number of Tap Holes:	1
Valve/Cartridge Type:	1/2" Compression Valves
Plumbing System Requirements:	All, Preferably Balanced
Working Pressure Range:	Min 0.2 Bar, Max 5.0 Bar
Maximum Hot Water Temperature: °C	65
Maximum Static Pressure: (bar)	10
Flow Type:	Dual Flow
Isolation Included:	Yes

### Dimensions (measurements in mm)

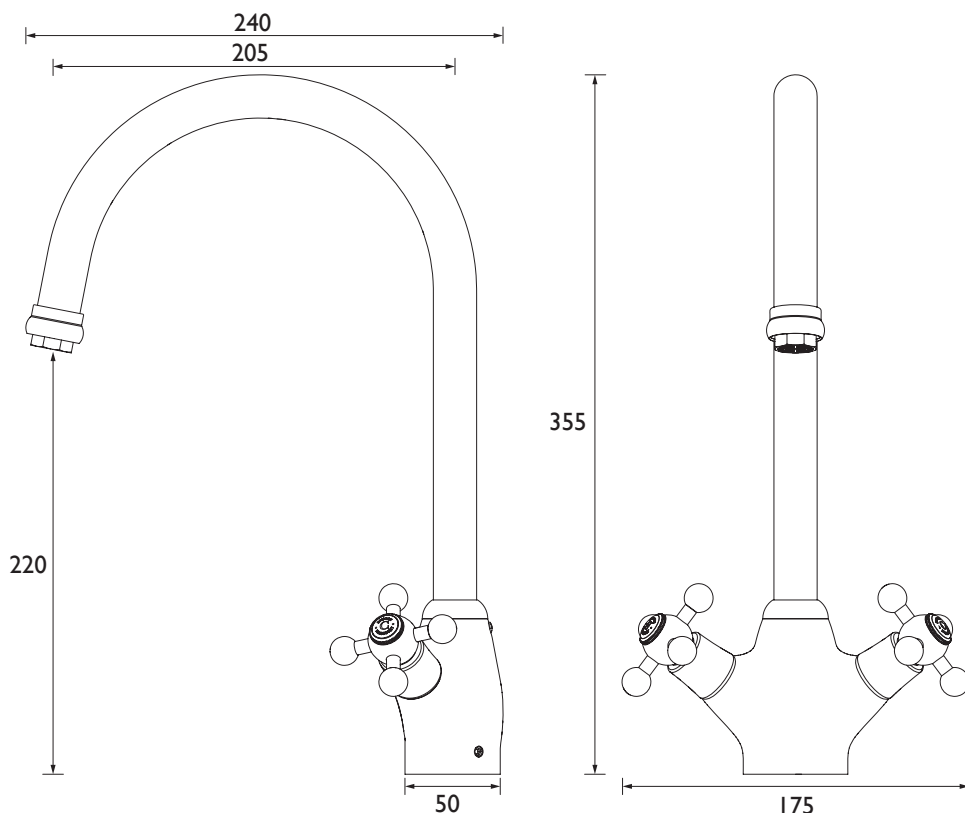

### Flow Rates (l/min)

System Pressure (bar)	0.2	0.5	1	2	3	5
KG SNK EF G TO	10.7	16.9	23.8	33.7	41.3	53.3

TECHNICAL  
DATA  
SHEET



**BRISTAN**  
TAPS & SHOWERS D1