

VAL2 DSM C CD

VALUE Tap Range Lever Deck Sink Mixer Chrome With Ceramic Disc Valves



Features:

- Long life and easy to use 1/4 turn ceramic disc valves
- Supplied with 3" (76mm) metal lever handles
- Metal back nuts for added durability

Product Certifications:



WRAS Cert. Number: 2105904
WRAS Expiry Date: 31/05/2026



For more products, visit our website:
<http://www.bristan.com>



Specification

Product Type:	Kitchen Taps
Main Construction Material:	Brass
Mount Type:	Deck
Handle Type:	Lever
Connection Inlet:	1/2" BSP
Connection Outlet:	Flow Straightener
Number of Tap Holes:	2
Valve/Cartridge Type:	1/2" Ceramic Disc Valve - 1/4 turn
Plumbing System Requirements:	Suitable for all plumbing systems
Minimum Dynamic Pressure:	0.2 bar
Maximum Dynamic Pressure:	5 bar
Maximum Hot Water Temperature: °C	65
Maximum Static Pressure: (bar)	10
Flow Type:	Single
Isolation Included:	No
Check Valve Supplied:	No

Dimensions (measurements in mm)

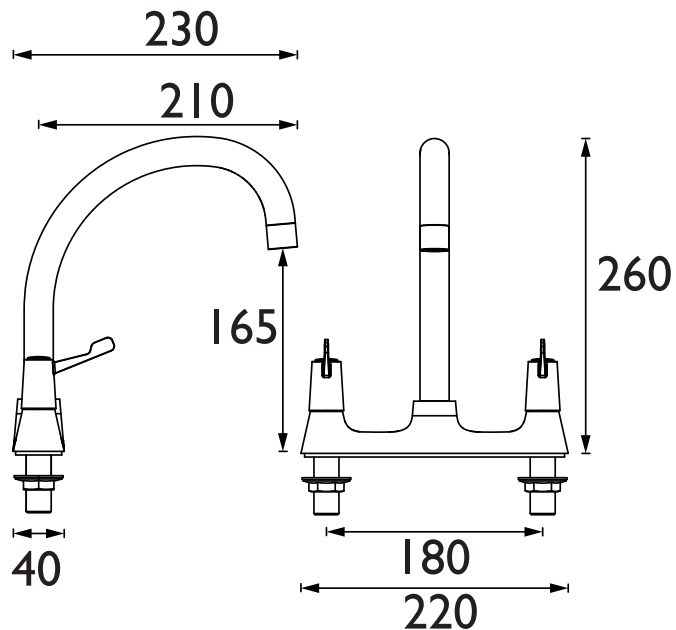

Flow Rates (l/min)

System Pressure (bar)	0.2	0.5	1	2	3	5
Hot	7.7	13.4	19.3	27.4	33.6	43.3
Cold	7.8	13.6	19.6	28.0	34.4	44.4
Mixed	13.5	22.9	32.9	47.1	57.3	73.2

TECHNICAL DATA SHEET



BRISTAN