

SAFFRON SHWR PK

SAFFRON Shower Range

Saffron Concealed Dual Control
Shower Pack Chrome



Features:

- All in one box - pack includes shower valve with integral two outlet diverter, slimline 200mm round fixed head with shower arm, and shower kit with an adjustable riser rail plus a multi function handset and wall outlet.
- Rub clean handset and fixed head - limescale and debris build-up is quickly and easily removed by rubbing a finger or a cloth over the nozzles.
- A hard-wearing, flawless, scratch resistant chrome finish that lasts for years. Salt spray tested to ensure added durability.
- Easy installation with an adjustable faceplate that fits total wall depths from 60mm to 75mm for a perfect flush finish
- Dual control - Flow and temperature are operated separately giving accurate control of both.
- Cartridge can be accessed from the front for easy servicing.
- 15mm inlet connections.
- 5-year parts and 1 year labour guarantee for peace of mind.
- Also available in black and brushed brass.
- Co-ordinating range of Bathroom taps available.

Product Certifications:



Specification

| | |
|--|--|
| Finish/Colour: | Chrome |
| Main Construction Material: | Brass; ABS |
| No of Controls: | 2 |
| Shower Type: | Dual Control |
| Shower Head Type: | Fixed Head and Adjustable Riser Kit |
| Valve/Cartridge Type: | Thermostatic Cartridge & 40mm Single Lever Cartridge |
| Maximum Hot Water Supply Temperature °C: | 65 |
| Plumbing System Suitability: | Suitable for all plumbing systems |
| Minimum Dynamic Pressure (bar): | 0.2 |
| Maximum Dynamic Pressure (bar): | 5 |
| Maximum Static Pressure (bar): | 10 |
| Connection Inlet: | 15mm Compression |
| Connection Outlet: | G 1/2" |
| Isolation Valve Included: | No |
| Check Valve Included: | Yes |

Dimensions (measurements in mm)

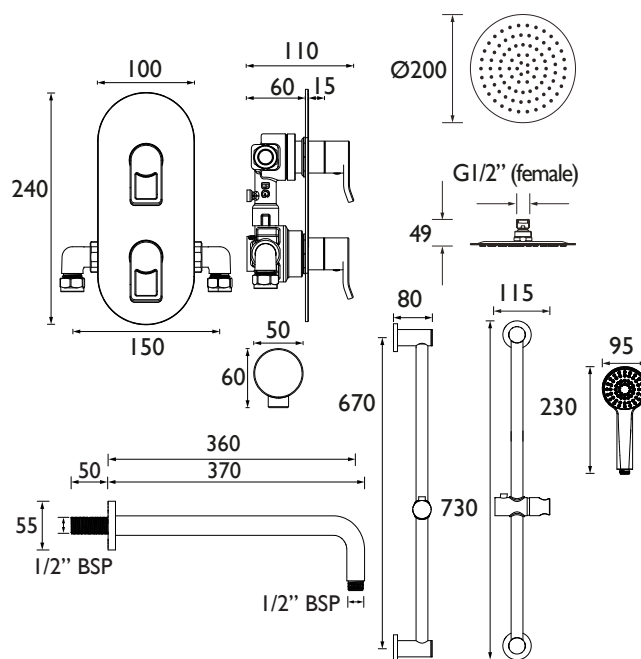

Flow Rates (l/min)

| System Pressure (bar) | 0.2 | 0.5 | 1 | 2 | 3 | 5 |
|--|-----|-----|------|------|------|------|
| Through Handset (mixed) | 2.7 | 5 | 7.3 | 7.8 | 8.9 | 9.8 |
| Through Fixed Head (mixed) | 3.6 | 5.9 | 6.5 | 8.1 | 8.5 | 9.6 |
| Through Handset (without flow regulators) | 3.1 | 5.8 | 8.7 | 12.9 | 16 | 21 |
| Through Fixed Head (without flow regulators) | 5.9 | 9.3 | 13.5 | 19.5 | 23.3 | 24.8 |

TECHNICAL
DATA
SHEET



BRISTAN

D2