

AFTERCARE INSTRUCTIONS

Your fitting has a high quality finish and should be treated with care to preserve the visible surfaces.

All surface finishes will wear if not cleaned correctly, the only safe way to clean your mixer is to wipe with a soft damp cloth. Stains can be removed using washing up liquid. All bath cleaning powders and liquids will damage the surface of your fitting, even the non-scratch cleaners. **NOTE: Never use abrasive detergents or disinfectants or those containing alcohol, hydrochloric acid or phosphoric acid.**

Bristan recommend E-Cloth for cleaning all of our bathroom & kitchen products. Using just water, E-cloth gives a smear free, deep clean by breaking up and holding dirt, which normal cloths leave behind. Order through your Bristan stockist. (ORDER CODE: E-CLOTH)



GUARANTEE

All products are manufactured to the highest standards and a 5 year guarantee covers any defect in manufacture.

NOTE: The 5-year guarantee on the cartridge is invalidated if damaged by any waterborne debris.

All products must have access for servicing or replacement during the life of the product.

In the interests of continuous product development we reserve the right to alter specification as necessary

TELEPHONE HELPLINE: 0844 701 6273

Bristan Group Limited
Birch Coppice Business Park
Dordon
Tamworth
Staffordshire
B78 1SG
UK
A Masco Company
Website: www.bristan.com
Telephone: 0844 701 6274
Facsimile: 0844 701 6275
Email: enquire@bristan.com

BRISTAN

Prism Side Bodies (PM SB C)

Fitting Instructions & Contents List

Please keep these instructions for future reference and request of replacement part

These side bodies are intended to be used as a manual control in conjunction with other products, such as, a bath spout or a combined bath fill and overflow from Bristan range in order to create a system to suit your requirements.

WATER PRESSURE

These fittings are suitable for use at all supply pressures. Depending on outlet choice and whether the fittings are installed at low pressure i.e tank fed, then the minimum Height from the outlet to the underside of the cold tank should be at least 2 metres to ensure adequate shower performance.

Operating Pressures: Min 0.2 bar, Max 7.0 bar.

This fitting should be installed in compliance with the Water Regulations. Where the supplies are unbalanced, i.e. hot water from cylinder tank/cold from the mains, approved check valves must be fitted in the supply pipes. For further details contact your Local Water Authority.

CONTENTS

- | | |
|-------------------|------|
| 1. Side Bodies | (x2) |
| 2. Backnuts | (x2) |
| 3. Metal Washers | (x2) |
| 4. Rubber Washers | (x2) |
| 5. Cartridges | (x2) |
| 6. Washers | (x2) |
| 7. Shrouds | (x2) |
| 8. Handles | (x2) |
| 9. Grub Screws | (x2) |
| 10. Cap | (x2) |

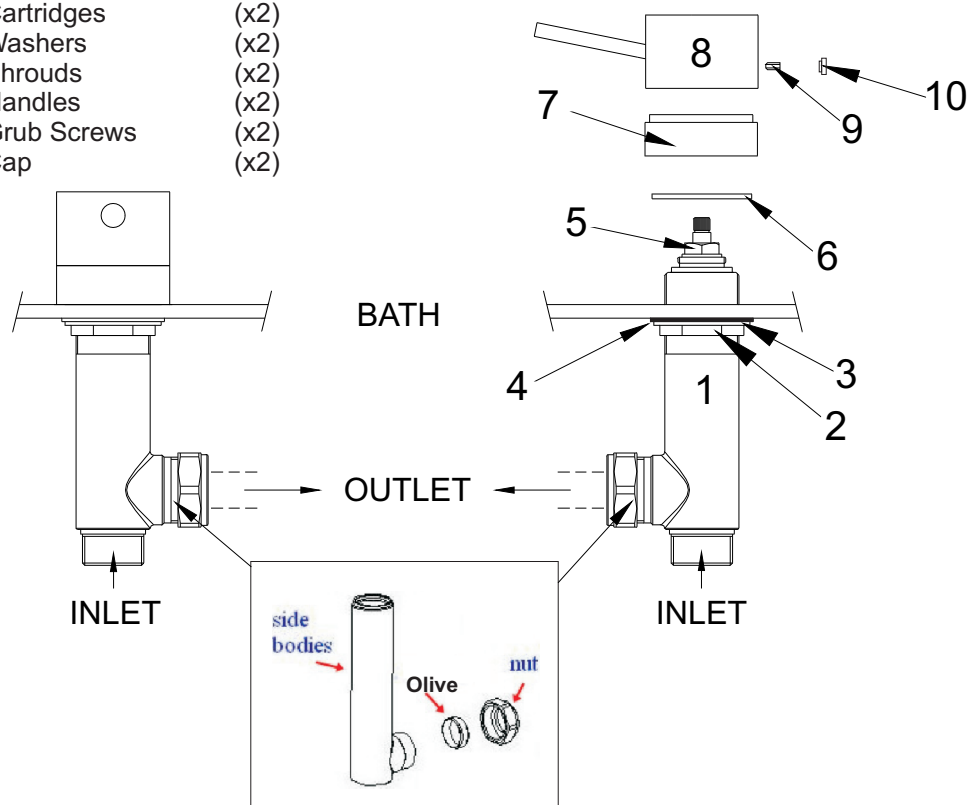

INSTALLATION

1. Identify all components and check for completeness, particularly before arranging installation.
2. Fit the sides bodies (1) to the bath using shrouds (with washers) (2) above the nuts (3) and washers (4) below the bath.
3. Fit the handles (5) and side bodies making sure the valves are closed with the levers pointing forwards. Secure by tightening the grub screw (6) within the Handle concealed by the lever (7).
4. Connect the side bodies to the outlet using suitable length of 22mm pipe (not supplied), the 22mm compression fittings and the connections supplied with the chosen outlet fitting.
5. Connect the hot and cold water supplies to the side bodies inlets.
6. Fully open both valves, letting them run for a few minutes to flush the system.
7. Check all joints and connections for leaks.
8. See over the page for aftercare instructions.

MAINTENANCE

If the fitting begins to drip:

1. Turn off the water supply
2. Unscrew lever (7), loosen grub screw (6) with hexagon key and pull off handle (5).
3. Remove valve (8).
4. Carefully clean seating, rubber washer and ceramic disc valve.
5. Replace the valve, collar, shroud and handle then turn on the water supply.
6. Contact our helpline if problem persists.

PLEASE NOTE:

In the unlikely event you find a part missing, please contact our Customer Service helpline on **0844 701 6273** for immediate dispatch of part