

Technical Datasheet

Product Code: SY-G03K



Product Description: Synergy Tec Studio G Black Bath Filler

Specification

Product Guarantee:	Lifetime
Barcode:	0729557188018
Material:	Brass
Handle Type:	Lever
Tap Pressure:	Low - High Pressure
Min Operating Pressure:	0.2 Bar
Waste Included:	No
Number Of Tap Holes:	1
Projection (mm):	118
Colour:	Black



Key Features

- Clean, straight lines, uncluttered spaces. Embrace modernistic style from the 20th century
- Manufactured from strong quality brass
- Coated in a luxury sleek black finish
- Ceramic disc technology for a smooth precise water flow
- Matching brassware is also available in the Studio G range

Technical Drawing

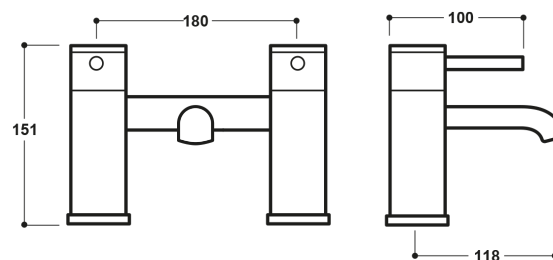

Dimensions: All measurements are in millimetres and are subject to normal manufacturing variations.

Due to a continuing development programme to improve design and performance, we reserve all rights to vary specifications without prior notice. Please note, all accessories are for photographic purposes only.