

Technical Datasheet

Product Code: SY-VAL02



Product Description: Synergy Valencia 500mm 1 Tap Hole Basin

Specification

Product Guarantee:	Lifetime
Barcode:	SY-VAL02
Projection (mm):	385
Material:	Vitreous China
Style:	Modern
Shape:	Rectangular
Number Of Tap Holes:	1



Key Features

- Clean structural lines make this piece the perfect match for both modern & traditional spaces
- Vitreous china's smooth, elegant, naturally stain resistant quality helps stand the test of time
- Features 1 tap hole suitable for mono basin mixer use
- Overflow hole included to prevent any bathroom accidents
- Ideal design suited for full & semi pedestal mounting
- Matching sanitaryware is also available in the Valencia Range
- Alternatively available in 600mm

Technical Drawing

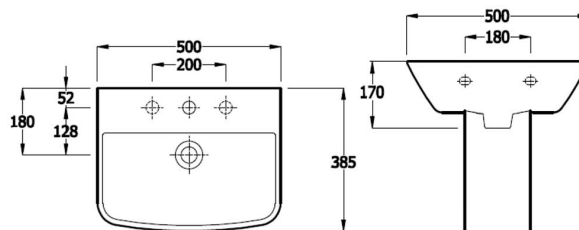

Dimensions: All measurements are in millimetres and are subject to normal manufacturing variations.

Due to a continuing development programme to improve design and performance, we reserve all rights to vary specifications without prior notice. Please note, all accessories are for photographic purposes only.