

Milan Range

Milan mono sink mixer

Product Code: MILAN 104

Finish: Chrome

Features

| | |
|-----------------------|-----------------------------------|
| Construction: | Brass |
| Valve/Cartridge type: | Standard |
| Supply: | Suitable for all plumbing systems |
| Working Pressures: | 0.1 - 5.0 bar |
| Inlet connections: | 15mm Copper |
| Flexi or Copper: | Copper Tails |

- Swivel Spout
- Dual Flow



*Please refer to website for full warranty details.

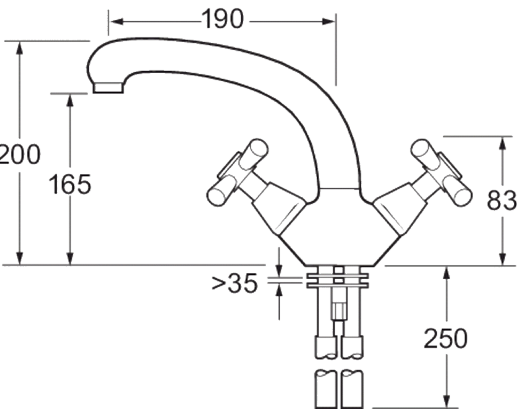

Flow (Bar - l/min, open outlet)

| Spout | | | | | | | |
|----------|----------|----------|----------|----------|----------|----------|----------|
| Flow 0.1 | Flow 0.3 | Flow 0.5 | Flow 1.0 | Flow 2.0 | Flow 3.0 | Flow 4.0 | Flow 5.0 |
| 5.5 | 8.4 | 11.4 | 14 | 17 | 20 | | |

