

Lever

Lever Action Sequential Basin Mixer

Product Code: SOL004

Finish: Chrome



Features

- Construction:** Brass
- Valve/Cartridge type:** Single Sequential Headwork
- Supply:** Suitable For High Pressure Systems
- Working Pressures:** 0.5 - 5.0 bar
- Inlet connections:** ½" BSP
- Flexi or Copper:** Flexi Tails - M10 - 400mm

- Long lever handle suitable for closed fist operation
- Single lever sequential mixer, turn lever to increase both temperature and flow
- Cold Start – Default start position of cold means no unnecessary engagement of the hot water system
- Flow regulated to 3lpm, saving water and energy
- Recommended for use with TBV008 blending valve
- Supplied With Flexi Tails And Copper Tails



*Please refer to website for full warranty details.

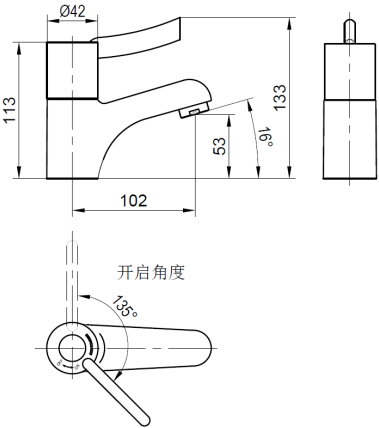

Flow (Bar - l/min, open outlet)

Spout							
Flow 0.1	Flow 0.3	Flow 0.5	Flow 1.0	Flow 2.0	Flow 3.0	Flow 4.0	Flow 5.0
1	1.6	2.1	2.7	2.9	2.9	3	3.1



2410709



250204001

