

# Technical Data Sheet

1700 x 700mm Steel Bath with Grip Holes - Anti-Slip  
ESB010

**essential**  
BATHROOMS

## ESB001

SIZE	1700 x 700mm
TAPHOLES	2TH



Horizontal distance between the axis of the drain and the axis of the overflow	a	<b>280</b>
Angle of the contact cone / Angle of the contact cone	alfa	<b>100°</b>
Slope of the pool measured at the level and on the support surface D4	beta	<b>12°</b>
External length	b	<b>1700</b>
External length	c	<b>700</b>
Overflow hole diameter	D1	<b>51</b>
Drain hole diameter	D2	<b>54</b>
Contact diameter of the control template	D3	<b>70</b>
Diameter of the flat support surface for the gasket	D4	<b>81</b>
Diameter of the free volume around the overflow	D5	<b>91</b>
Diameter of the flat surface intended to receive the sealing gasket in the internal part of the tub	D6	<b>66</b>
Height between the contact diameter of the control template and the surface of the tub	e	<b>2</b>
Internal length (bottom)	g	<b>1060</b>
Vertical distance between the axis of the overflow and the underside of the drain	H	<b>330</b>
Height between the floor and the underside	h1	<b>130/210</b>
Height of the clamping of the drains	h2	<b>6</b>
Height of the free volume around the overflow intended for the installation of the latter	h4	<b>90</b>
Internal width (top)	i	<b>550</b>
Internal width (bottom)	l	<b>380</b>
Height from the edge	m	<b>30</b>
Depth	p/p1	<b>390/367</b>
Height with feet	pT	<b>540/620</b>
Distance between the top edge and the center of the overflow hole	j	<b>65</b>
Distance between the edge of the bath and the center of the overflow hole	k	<b>290</b>
Edge width	r1/ r2/ r3	<b>100/50/70</b>
Thickness of the material at the drain hole	s	<b>5</b>

• View from above

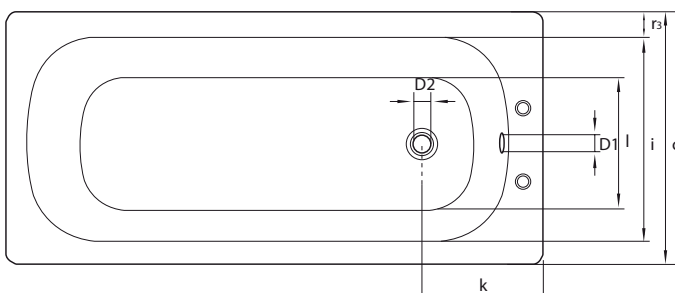

• Front view along side

