

## D-Code Wall-mounted toilet Compact # 25150900002

| < 370 mm > |

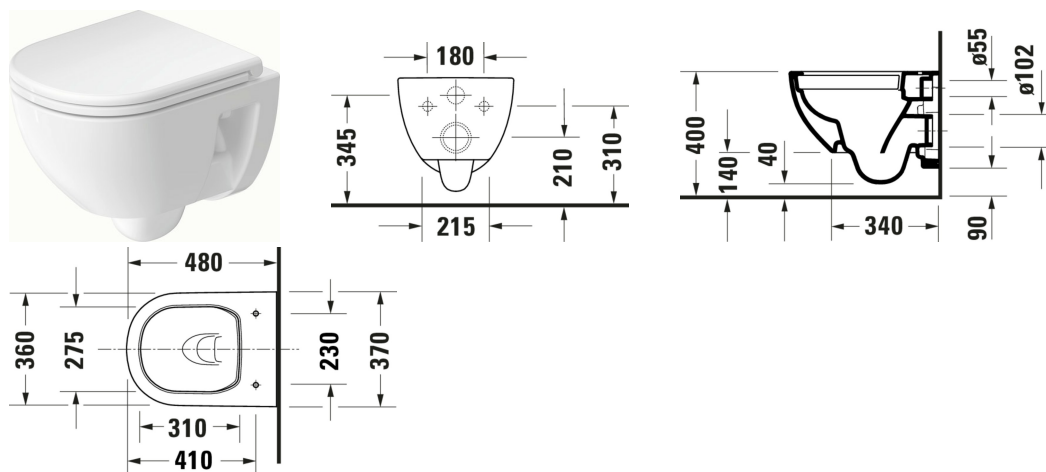

Wall-mounted toilet Compact	Dimension	Weight	Order number
Flush water quantity: 4,5 l, Washdown model, Flushing rim: Rimless, Flush principle: washdown model, Outlet drain horizontal, Unified Water Label (UWL) Class: 1			
<b>Colors</b>			
00 White Alpin			
<b>Variant</b>			
White High Gloss, Flush water quantity: 4,5/3 l	370x360 mm	21.500 kg	25150900002
<b>Accessory for ceramics</b>			
Fixation Suitable for Wall-mounted bidet, Wall-mounted toilet	Ø 12 mm	0.69 kg	006500
<b>Accessory</b>			
Noise reduction set	420 x 390 mm	0.2 kg	005090
<b>Suitable products</b>			
Toilet seat Soft-closing: Yes, Removable Seat, Hinge material: Stainless steel, Hinge colour: Stainless steel, 374 x 433 mm	374 x 433 mm		002819
Toilet seat , 374 x 433 mm	374 x 433 mm		002811

All drawings contain the necessary measurements which are subject to standard tolerances. They are stated in mm and are non-binding. Exact measurements, in particular for customised installation scenarios, can only be taken from the finished piece.