

## Geberit Duofix frame for bidet, 98 cm, universal

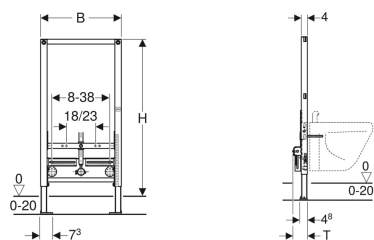

Example image



### Application purposes

- For drywall construction
- For installation in part-height prewall installations
- For installation in part-height Geberit Duofix system walls
- For wall-hung bidets with deck-mounted tap
- For floor constructions 0–20 cm

### Characteristics

- Statically self-supporting frame, protected against corrosion with powder coating
- Frame with  $\varnothing 9$  mm drilling holes for fastening in wood frame construction
- Galvanized feet
- Feet adjustable 0–20 cm

### Scope of delivery

- 2 angle stop valves 1/2"
- 2 elbow tap connectors Rp 1/2" / R 1/2", compatible with MF
- 2 sealing washers
- 2 sound insulation bases
- 2 insulating sleeves
- 2 protection plugs
- 2 threaded rods M12
- Fastening material

- Fastening distance for wall-hung bidet 18 or 23 cm
- Height-adjustable bidet fastening
- Non-slip leg supports
- Rotatable foot plates
- Foot plate depth suitable for installation in U-profiles UW 50 and UW75 and Geberit Duofix system rails
- Fastening for connection bend, height-adjustable and sound-absorbing
- Tap attachments adjustable in width and height
- Self-adhesive sealing washer, fleece-laminated
- Protection plug for one-time pressure test with cold water up to a maximum of 15 bar / 1500 kPa

### Technical data

Product material | Steel

Art. no.	B	H	T
111.544.00.1	50 cm	98 cm	10 cm



- Any boarding must be fixed tight up against the face of the Duofix frame and screwed directly to the frame