

Sales Code: SAR302L

Description: 1000 W/H 2 Drawer Unit & Basin Lh

Packaging Details

Barcode: 5056211875055

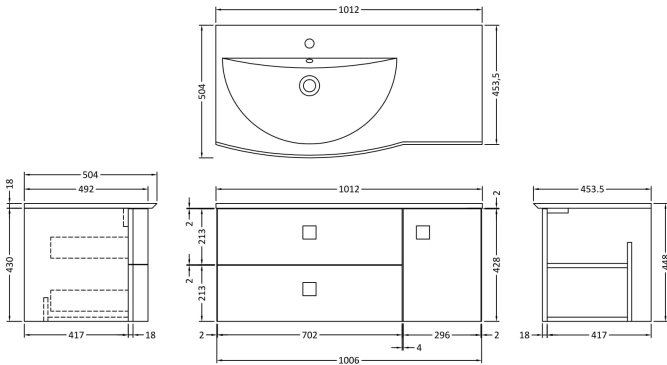

Sales Code: SAR394

Description: 700 W/H 2 Drawer Unit

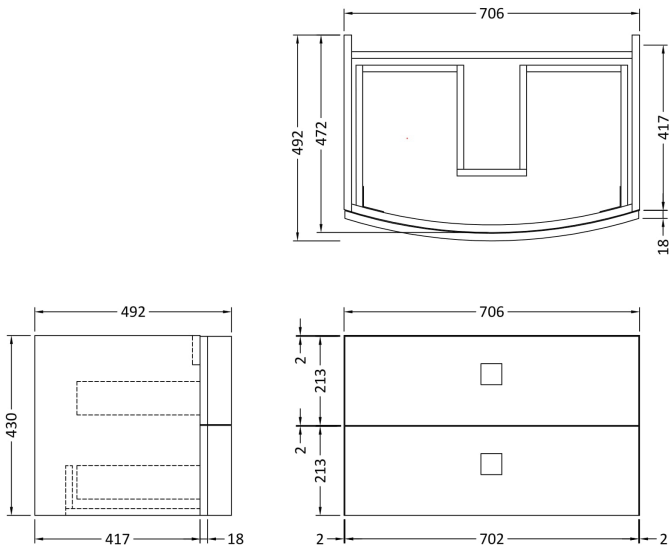

Product Dimensions

Height (mm):	430
Width (mm):	710
Depth (mm):	480
Nett Weight (kg):	22

Packaging Dimensions

Height (mm):	500
Width (mm):	700
Depth (mm):	470
Gross Weight (kg):	22

Packaging Data

Box Colour:	Brown Cardboard Box
Box Qty:	1
Label Size:	100 x 50
Label Colour:	White Label
Label Qty:	2

Outer Box Dimensions (If Applicable)

Height (mm):	
Width (mm):	
Depth (mm):	
Gross Weight (kg):	
Barcode:	5056211873860

Product Details

Country of Origin:	Ukraine
Fitting Instruction:	No
Certification:	FSC: Yes CE: N/A
Colour:	Mineral Blue
Construction Method:	Cam & Wood Dowel
Construction Type:	Rigid
Cabinet Finish:	MFC Smooth Matt
Fascia Finish:	MFC Smooth Matt
Cabinet Thickness (mm):	18
Fascia Thickness (mm):	18
Drawer Included:	Yes
Drawer Type:	80mm High Metal Softclose
No of Shelves:	0
Hinge Type:	Not Applicable
Hinge Included:	Not Applicable
Adjustable Legs:	No
Fixings Included:	Yes
Handle Style:	Modern
Handle Included:	Yes
Waste Shroud:	Yes
Handle Type:	Square

Sales Code: SAR360

Description: 300 W/H Side Cabinet

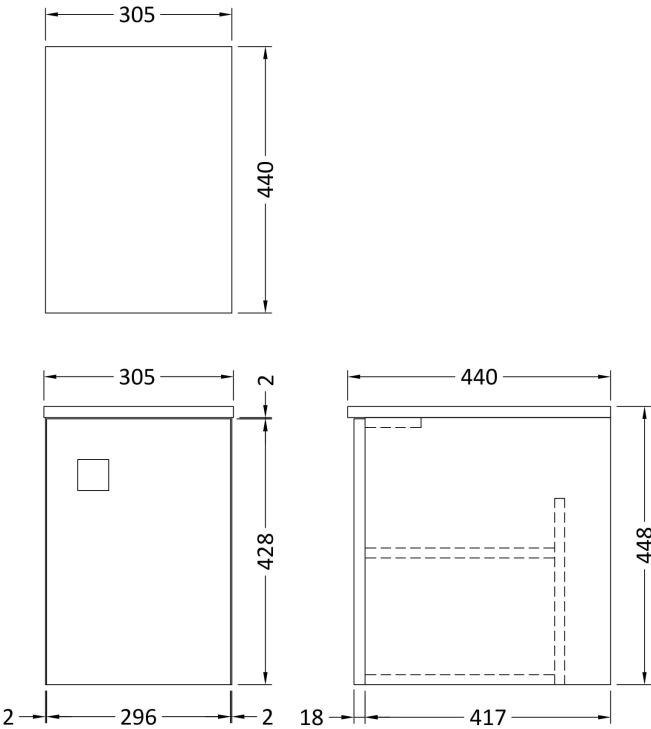

Product Dimensions		
Height (mm):		
Width (mm):		
Depth (mm):		
Nett Weight (kg):	14	
Packaging Dimensions		
Height (mm):	450	
Width (mm):	320	
Depth (mm):	425	
Gross Weight (kg):	14	
Packaging Data		
Box Colour:	Brown Cardboard Box	
Box Qty:	1	
Label Size:	100 x 50	
Label Colour:	White Label	
Label Qty:	2	
Outer Box Dimensions (If Applicable)		
Height (mm):		
Width (mm):		
Depth (mm):		
Gross Weight (kg):		
Barcode:	5056211873891	
Product Details		
Country of Origin:	Ukraine	
Fitting Instruction:	Yes	
Certification:	FSC: Yes	CE: N/A
Colour:	Mineral Blue	
Construction Method:	Cam & Wood Dowel	
Construction Type:	Rigid	
Cabinet Finish:	MFC Smooth Matt	
Fascia Finish:	MFC Smooth Matt	
Cabinet Thickness (mm):	18	
Fascia Thickness (mm):	18	
Drawer Included:	No	
Drawer Type:	Not Applicable	
No of Shelves:		
Hinge Type:	95 Degree Clip-On Soft Close	
Hinge Included:	Yes	
Adjustable Legs:	No	
Fixings Included:	Yes	
Handle Style:	Modern	
Handle Included:	Yes	
Waste Shroud:	No	
Handle Type:	Square	

Sales Code: FMB0093L

Description: 1012 X 504 Vanity Basin Lh

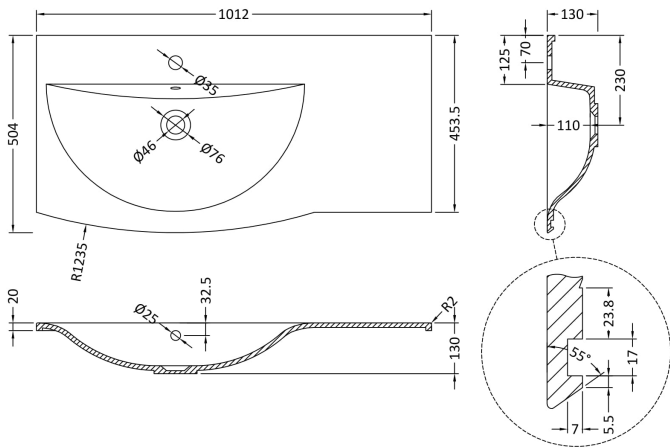

Product Dimensions

Height (mm):	130
Width (mm):	1012
Depth (mm):	504
Nett Weight (kg):	13.5

Packaging Dimensions

Height (mm):	110
Width (mm):	1012
Depth (mm):	504
Gross Weight (kg):	13.5

Packaging Data

Box Colour:	Brown Cardboard Box - Printed
Box Qty:	1
Label Size:	100 x 50
Label Colour:	White Label
Label Qty:	2

Outer Box Dimensions (If Applicable)

Height (mm):	
Width (mm):	
Depth (mm):	
Gross Weight (kg):	
Barcode:	5055275832479

Product Details

Country of Origin:	Poland
Fitting Instruction:	No
Certification:	CE: N/A WRAS: N/A WRAS No: N/A
Product Material:	Polymarble
Fixing Supplied:	No

Pans/Bidets:	Trap Style: Not Applicable	Includes Seat: Not Applicable
---------------------	----------------------------	-------------------------------

Seats:	Seat Type: Not Applicable	Material: Not Applicable
	Function: Not Applicable	Hinge Type: Not Applicable
	Hinge Material: Not Applicable	

Cisterns:	Operating Type: Not Applicable	Fittings: Not Applicable
	Lever Type: Not Applicable	

Basins:	Tap Hole: One Taphole	Chain Stay Hole: No
	Template: Not Required	Waste Type Req: Slotted
	Overflow Inc: Yes	Overflow Cover: Yes
	Inner Bowl Depth (mm): 105mm	