

Sales Code:
KRI8023

Barcode: 5056462673967

Brand: Hudson
Reed

Description: Hudson Reed Tec Crosshead Brushed Brass Triple Thermostatic Shower Valve With Diverter

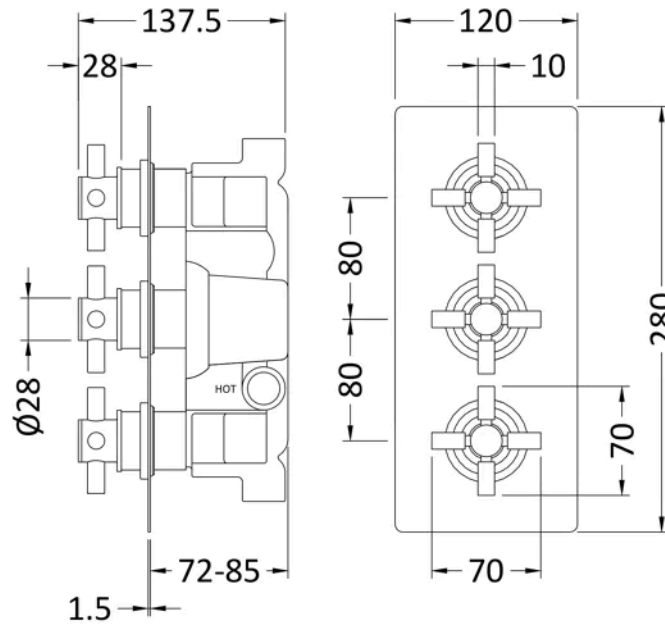
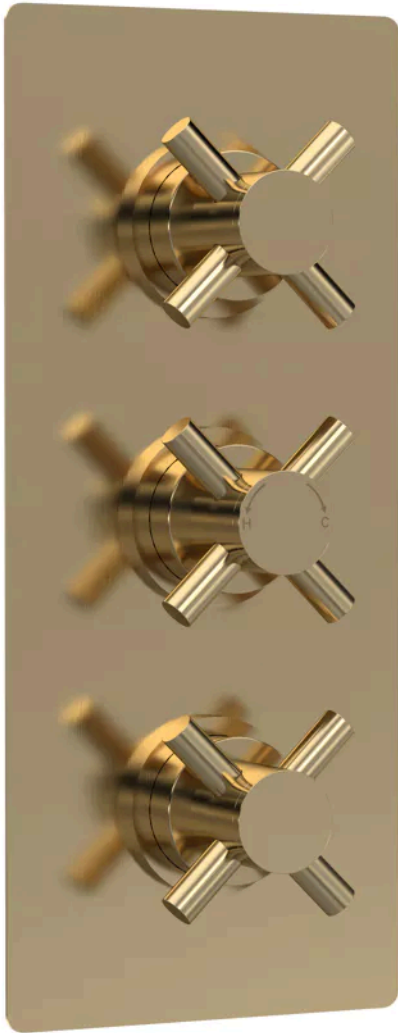

Product Dimensions

Product	280 x 120 x 136mm (H x W x D)
Packaged	110 x 255 x 350mm (H x W x D)
Outer Box	430 x 530 x 345mm (H x W x D)
Nett Weight	3.93 kg
Packaged Weight	3.93 kg

Packaging Details

Label Size (mm)	50 x 100
Label Colour	White
Label Qty	2.0000

Product Details

Country of Origin	United Kingdom
Product Material	Brass Abs
Control Type	Manual
WRAS Approved	Yes
Valve/Cartridge Type	1/4 Turn
Colour/Finish	Brushed Brass
Mount Type	Recessed/Wall
Style	Contemporary
Handle Type	Crosshead
TMV2 Approved	Yes
TMV3 Approved	No
Pipe Size	15 mm & 22 mm
Handset Included	No
Head Included	No
Min Operating Pressure	0.5 Bar
Minimum Operation Pressure	1 Bar
No. Outlets	3.0000
Outlet Elbow Supplied	No
Tmv2 Approval Number	2603035
Valve / Cartridge Type	1/4 Turn
Wras Approval No	250602040