

Sales Code: TSVT003

Description: Topaz Triple Concealed Shower Valve

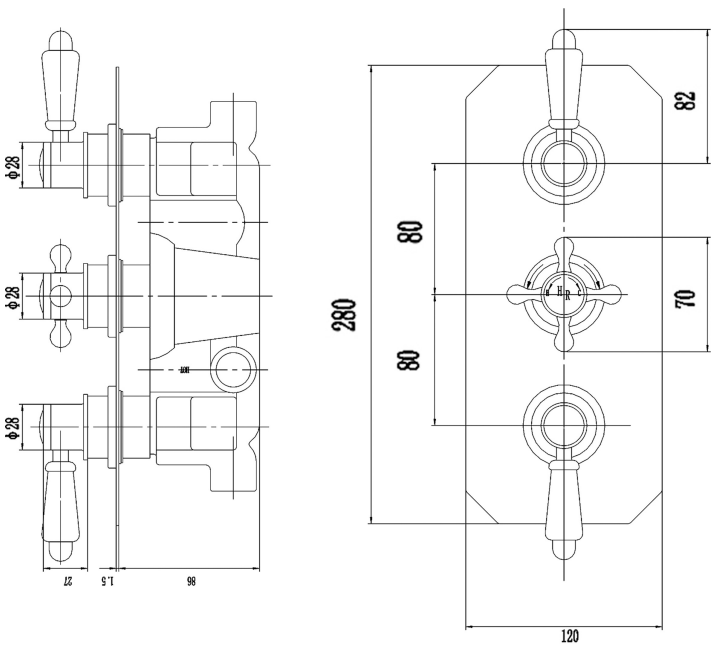

Product Dimensions

|                   |     |
|-------------------|-----|
| Length (mm):      |     |
| Width (mm):       | 120 |
| Height (mm):      | 320 |
| Depth (mm):       | 135 |
| Nett Weight (kg): | 3   |

Packaging Dimensions

|                    |     |
|--------------------|-----|
| Length (mm):       | 320 |
| Width (mm):        | 250 |
| Height (mm):       | 110 |
| Gross Weight (kg): | 3.4 |

Packaging Data

|               |                     |
|---------------|---------------------|
| Box Colour:   | White Cardboard Box |
| Box Qty:      | 0                   |
| Label Size:   | 0 x 0               |
| Label Colour: | White Label         |
| Label Qty:    | 0                   |

Outer Box Dimensions (If Applicable)

|                    |               |
|--------------------|---------------|
| Length (mm):       |               |
| Width (mm):        | 530           |
| Height (mm):       | 370           |
| Depth (mm):        | 345           |
| Gross Weight (kg): |               |
| Barcode:           | 5055275831595 |

Product Details

|  |                       |
|--|-----------------------|
| Country of Origin:   | United Kingdom        |
| Fitting Instruction:   | Yes                   |
| Product Material:  | Brass/ABS             |
| Mount Type:  | Wall                  |
| Outlet Elbow Supplied:   | No                    |
| Easy Clean:  | Not Applicable        |
| Head Included:   | No                    |
| Handset Included:  | No                    |
| Body Jets Included:  | Not Applicable        |
| No of Body Jets:   | Not Applicable        |
| Operating Pressure (bar):  | 0.1                   |
| Valve/Cartridge Type:  | 1/4 Turn Ceramic Disc |
| Flow Rates (L/min): 0.1 bar: 5.5   0.5 bar: 13   1 bar: 20   2 bar: 29   3 bar: 44 |                       |
| TMV2 Approved: No  | Approval No: N/A      |
| TMV3 Approved: No  | Approval No: N/A      |
| WRAS Approved: Yes   | Approval No: 1703023  |
| Head Function:   | Not Applicable        |
| Handset Function:  | Not Applicable        |
| Body Jet Info:   | Not Applicable        |
| Pipe Size:   | 22 mm (3/4" Bsp)      |
| Pipe Centres:  | N/A                   |
| Colour/Finish:   | Chrome                |
| Hose Included:   | Not Applicable        |
| No. of Outlets:  | 2                     |