

# ProSsys<sup>®</sup>

BETTER ON EVERY LEVEL



Ideal Standard

PART OF THE IDEAL STANDARD GROUP

ProSys® Installation Systems

# Pictograms

The symbols shown here are used throughout this brochure to indicate the following features and benefits

- 

Tool-free servicing
- 

400kg load tested
- 

Dry-wall, wall-hung WC
- 

Dry-wall back-to-wall WC
- 

Dry-wall washbasin
- 

Solid wall, wall-hung WC
- 

Solid wall back-to-wall WC
- 

Solid wall, wall-hung washbasin
- 

Water-saving
- 

Mechanical actuation
- 

Pneumatic actuation
- 

No-touch sensor actuation
- 

Infrared actuation
- 

Single flush
- 

Dual flush
- 

Vandal-resistant
- 

10 years warranty
- 

5 years warranty
- 

25 years spare parts availability

5	Bathrooms that work on every level
6	What you see and what you can't
8	Everything you need in one place
11	Making life better for our customers
13	Designed for performance
14	Designed for quality and reliability
17	Designed for easy installation and maintenance
18	Efficient technology: SmartValve
20	ProSys® in-wall installation types
22	ProSys® benefits at a glance
24	ProSys® WC solutions
28	ProSys® accessories
30	ProSys® non-WC solutions
34	Flush Plates
44	Minimum wall thicknesses
46	Technical information
66	Solutions for any project

‘Whatever your bathroom vision,  
it’s the details that make  
the difference.’



Wall-hung bowl Aquablade®: Strada II  
 Basin: Strada II 60cm  
 Fitting: Edge  
 WC frame: ProSys® 120  
 Basin frame: ProSys® deck taps



Basin: Strada II 100cm Fitting: Edge Mirror: Mirror & Light 100cm

## Bathrooms that work on every level

There's more to a great bathroom design than meets the eye. What goes on behind the wall is as important as what is on or in front of the wall. Ideal Standard's range of compatible installation systems, flush plates, ceramics and fittings ensure that every layer works together. So you can configure our products not just to create a beautiful design, but one that is easy to install, hygienic, and sustainable too – a bathroom that works on every level.

## What you see

Our range of flush plates offers a choice of shapes, colours, functions and materials to suit any design need, whatever your bathroom vision. They come with a choice of actuation methods and perfectly match the look and functionality of our toilet and urinal ranges.



## And what you can't



Top: Wall-hung bowl AquaBlade®: Concept Air  
Frame: ProSys® WC frame 120 M  
Middle: Basin: Strada II 100cm Fitting: Edge  
Frame: ProSys® basin frame deck taps  
Bottom: Urinal: Sphero™ Maxi  
Frame: ProSys® urinal back inlet frame

Our range of high-quality installation systems provide complete peace of mind behind the wall. Advanced features like our EasyFix™ wall brackets, the incorporated brakes and adjustable outlet bend make our frames extremely easy to install. They have also been thoroughly tested to ensure safety, quiet operation, and reliability that lasts. Tool free-servicing means they are simple to maintain too.



Wall-hung bowl: Aquablade®; Strada II  
 Flush plate: Symfo® NT1 in black glass  
 Vessel: Ipalyss® 55cm  
 Furniture: Adapto console 120cm in light wood  
 Vessel mixer: Edge

## Everything you need in one place

Ideal Standard has always been well-known for our expertise in ceramics and fittings. With the addition of our flush plate ranges and installation systems, we can provide you with everything you need for all your bathroom projects. Whatever you are trying to achieve, we can help you complete your vision.

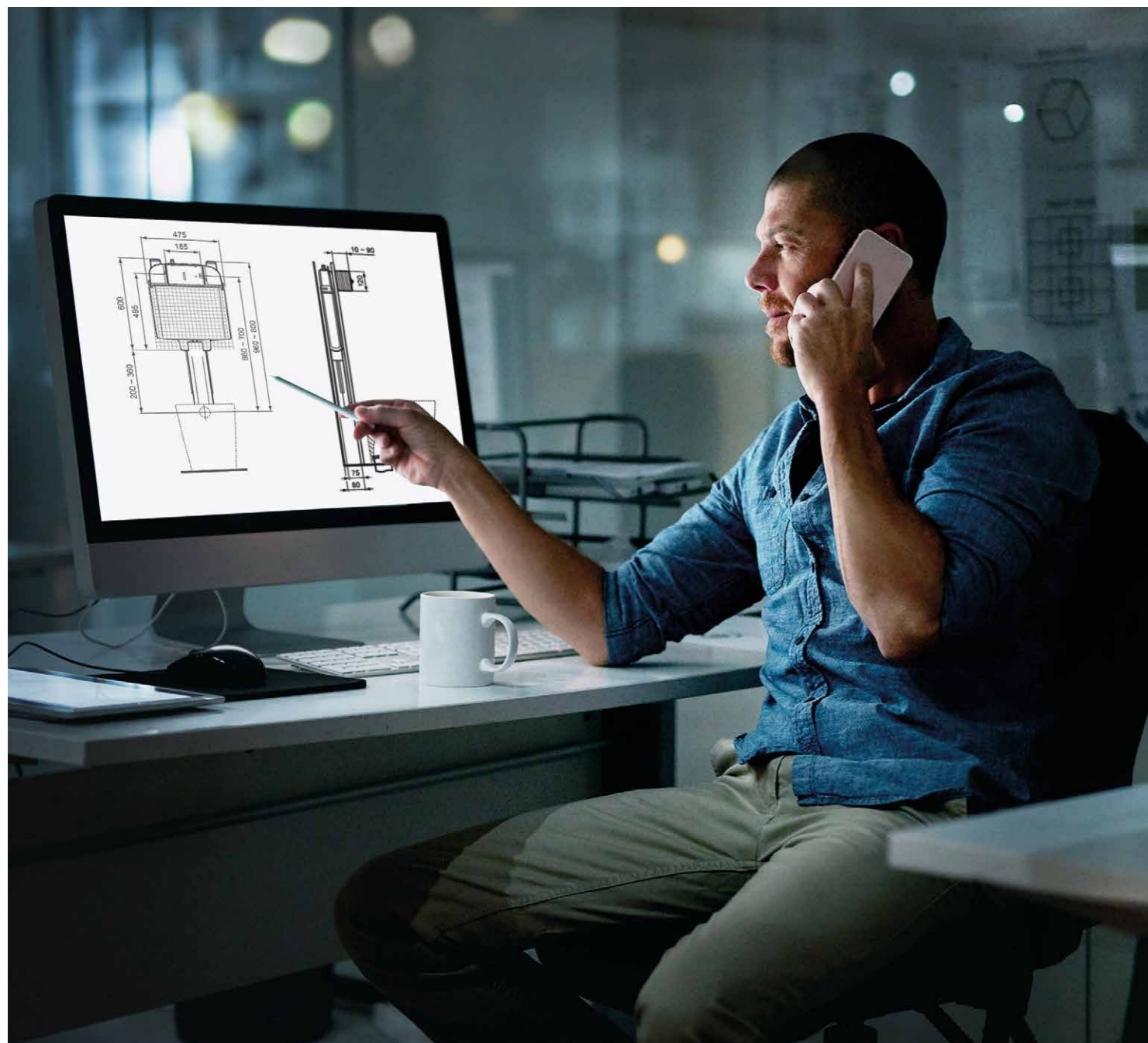

### A history of expertise

We have sold over 5 million cisterns in 10 different countries in the last 50 years, which is testament to the high-quality of our products that deliver peace of mind to our customers. It's this expertise, especially in the manufacture of associated technical components, such as flush mechanisms, that we bring to our installation solutions.

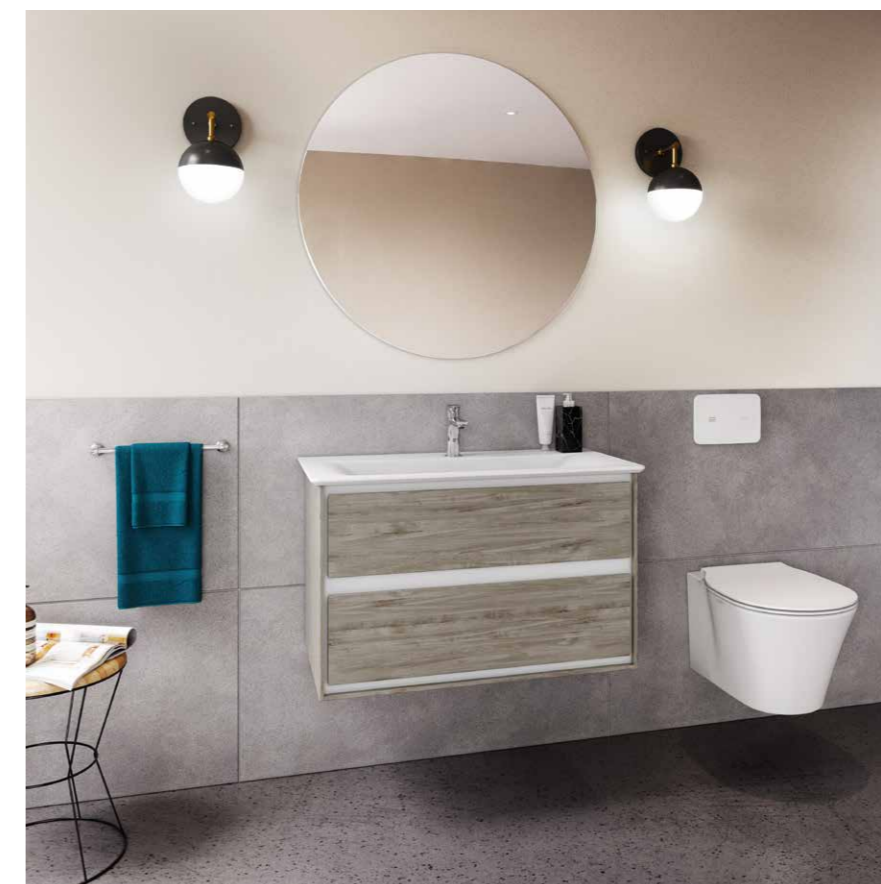

Flush plate: Altes® NT1 in white  
Wall-hung bowl AquaBlade®: Concept Air  
Fitting: Concept Air  
Vanity: Concept Air 80cm  
Furniture: Concept Air basin unit 80cm

## Making life better for our customers

For over 100 years, our mission has been to make life better for our customers. We do this by bringing emotional meaning to functional perfection: always innovating to anticipate the demands and aspirations of modern living.

From our roots pioneering products like the single lever tap, to delivering solutions for pressing global challenges, we create not just for today, but for tomorrow.

## Designed for performance

Great design is life-enhancing. That's why it's at the heart of everything we do. We collaborate with award-winning designers to create elegant, contemporary and stylish bathrooms.

But it's not just about aesthetics – we continually evaluate our materials and processes so that you can be confident in the quality of our sanitaryware, fittings, showers and furniture. And we place enormous emphasis on performance to make sure our products live up to their promises.

Whether it's a cleaner, quieter flush, or saving water or energy, we constantly challenge ourselves to give our customers the best experience possible.

Wall-hung bowl: Concept Air  
Flush plate: Septa Pro P3



Wall-hung bowl: Studio Echo  
Flush plate: Oleas® M1



Flush plate: Altes® NT1 in black ceramic  
Wall-hung bowl AquaBlade®; Concept Air

**'Great design is life-enhancing.  
That's why it's at the heart  
of everything we do.'**



## Designed for quality and reliability

All of our products are thoroughly laboratory-tested during development, and undergo stress, endurance, noise and hydraulic testing. We follow strict processes of certification, including NF and WRAS, so that our customers are aware that our quality meets the highest standards.

### Fire safety

All material components used by Ideal Standard to produce our cisterns are rated fire resistance class EI 120 conforming to EN 13502-2:2016.

### Noise control

All our cisterns are classified to noise level 1, meeting the requirements of EN14124.

### European Construction Products Regulation

According to the Construction Products Regulation CPR305/2013, all cisterns sold by Ideal Standard are CE marked and produced and tested according to the harmonised product standard EN 14055.

### NF certification

Our products are tested for NF certification. This is a quality and safety benchmark widely recognised in Europe.

### WRAS

Our products are tested according to WRAS requirements for the design, installation, operation and maintenance of plumbing systems, water fittings and appliances that use water, to prevent misuse, waste and contamination of drinking water. In addition all ProSys® products adhere to all current UK regulations.

### Load tests

Our WC frames are capable of holding 400kg, our urinal frames can hold 100kg, and our basin frames hold 150kg, so we can offer the right products for all projects without the need to specify specialist products.

Ideal Standard warranties are as extensive as our testing, with moving parts and tanks guaranteed for 5 years, frames for 10 years, and a reassurance that spare parts will be available for a minimum of 25 years after purchase.



**'Moving parts and tanks guaranteed for 5 years, frames for 10 years, and spare parts made available for 25 years after purchase.'**

## Designed for easy installation & maintenance

At Ideal Standard, we believe that ease of installation and maintenance are just as important as reliability. That's why our 120 depth frames feature EasyFix™ brackets which allow for quick fixing to the wall and precise levelling with 3 easy steps to a secure installation.

They also come with brakes on the feet so that there is no need for a second person to hold the frame when adjusting the height – making installation a one-man job.

This simple height adjustment means our in-wall systems can easily cater for different types of floor or particular customer needs. Our in-wall systems also provide solutions for solid and dry-wall applications, as well as different bathroom fixtures.

Our cisterns can be operated with electronic, mechanical or pneumatic flush plates to suit users' requirements.

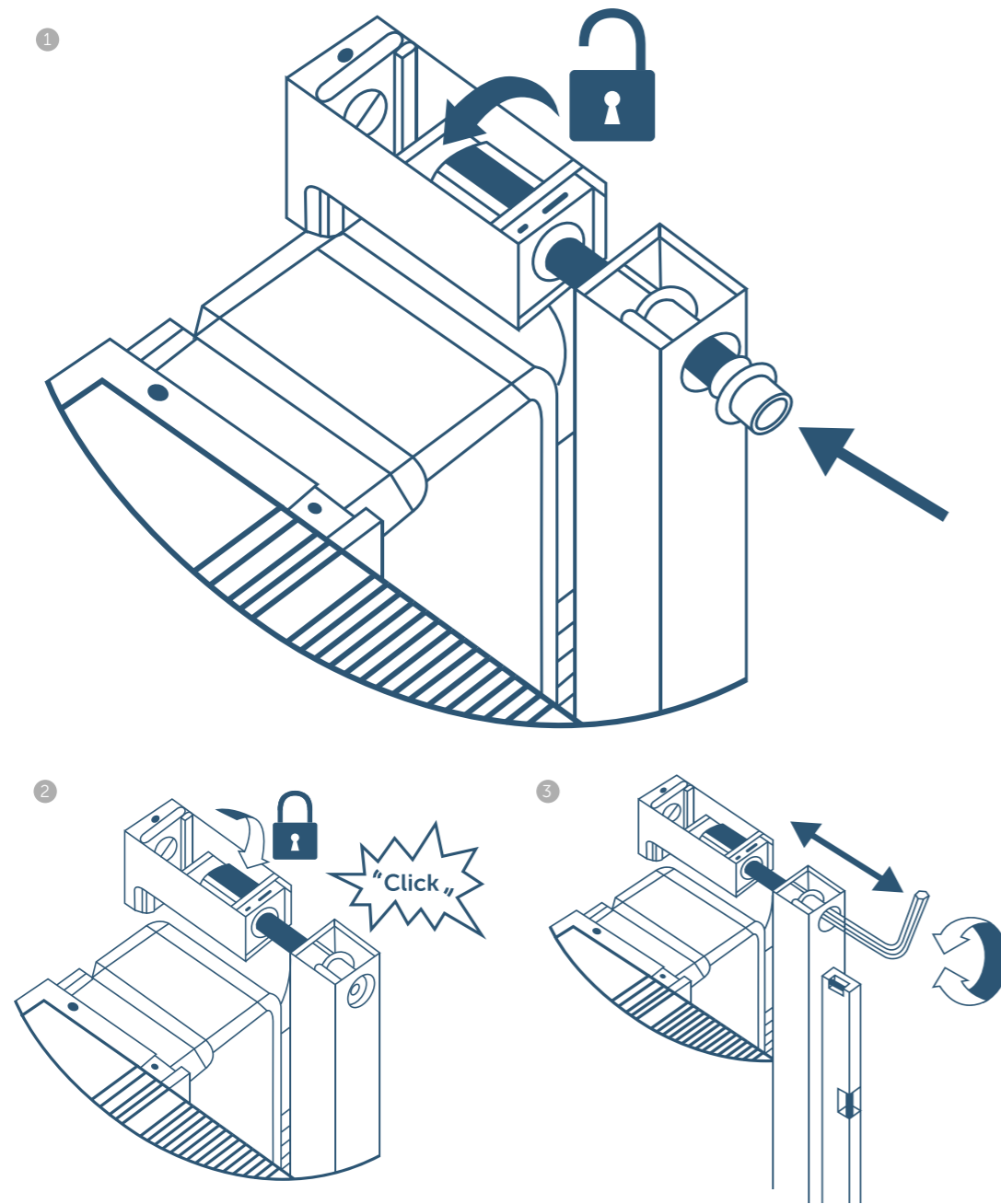

1. Insert the threaded bar into the allocated hole in the frame, and set the wall bracket dial to 'unlocked' and thread onto the bar.
2. Push the bar into the frame until it clicks and is locked in place, and set the bracket to the correct depth and rotate it to give the most suitable access for fixing to the

wall. The dial on the bracket can then be set to 'locked'.

3. The bracket can then be fixed to the wall using the fixation pack provided, and a hex key can be used for fine adjustment to ensure the frame is perfectly level.

ProSys® EasyFix™ wall brackets  
(feature currently available on 120 frames only)

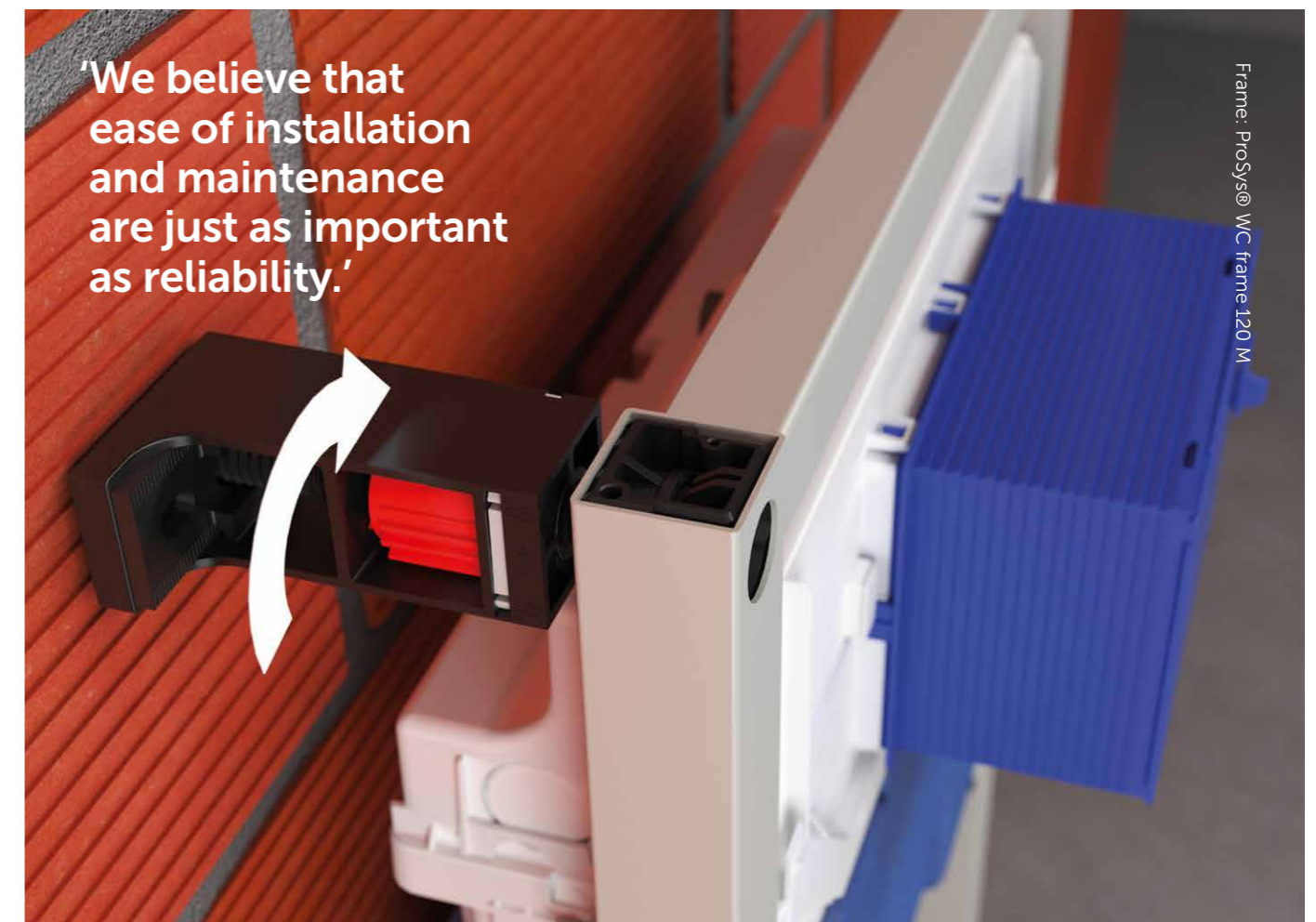

Frame: ProSys® WC frame 120 M

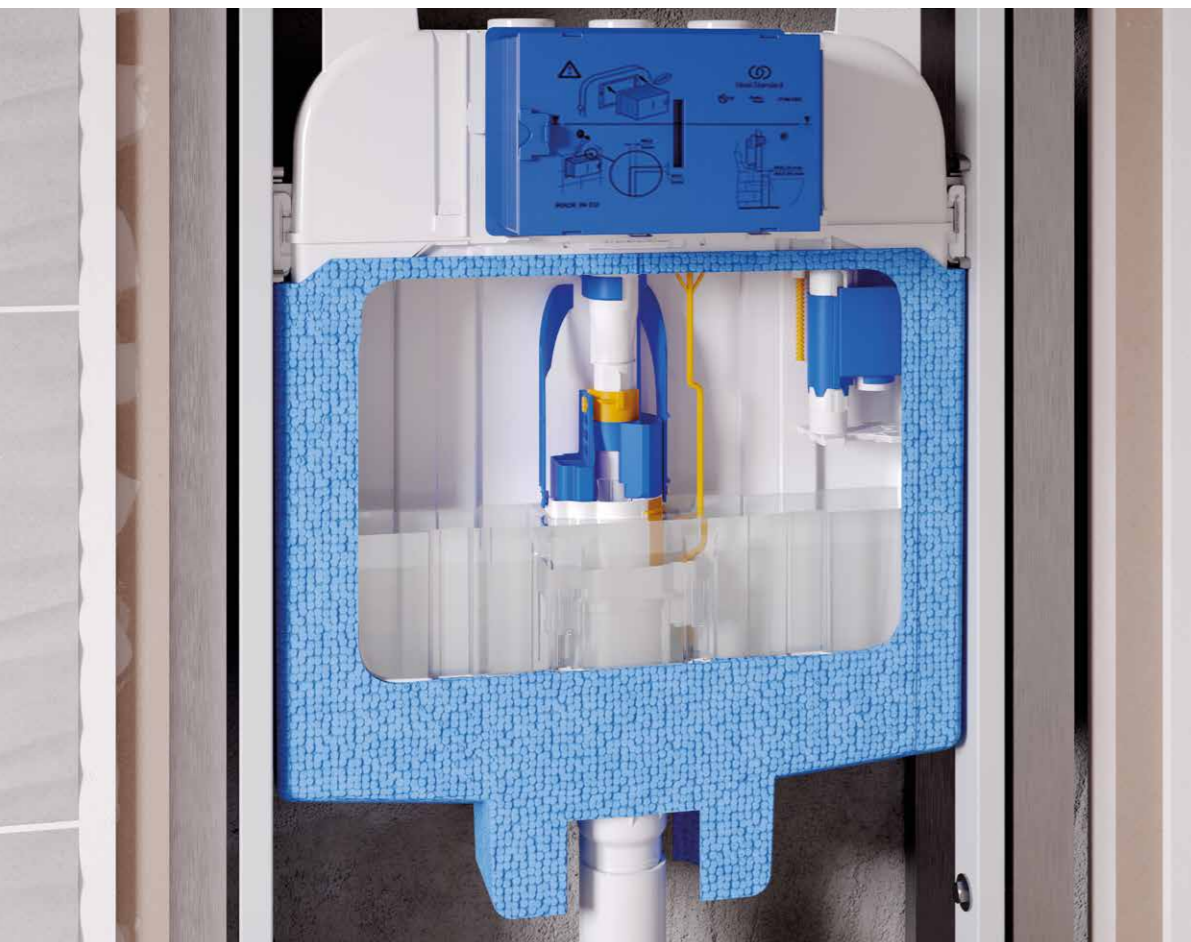

Frame: ProSys® WC Frame 120 M

## SmartValve saves water



Standard on all ProSys® cisterns, this innovative inlet valve only allows refilling of the cistern after the flush is complete, avoiding any wastage of water during flushing. This patented feature has been proven to save up to 63 litres a week, which corresponds to a 12% reduction\* in users' water bills. Not only does it promote water conservation. It is a quick-filling valve and is compatible with any water pressure.

\*When comparing average use in a single-family dwelling of 4 people.

**'Save up to 63 litres a week, which corresponds to a 12% cost reduction.'**



Wall-hung bowl: AquaBlade® Blend  
Flush plate: Symfo® NT1 in black glass

Concealed cisterns

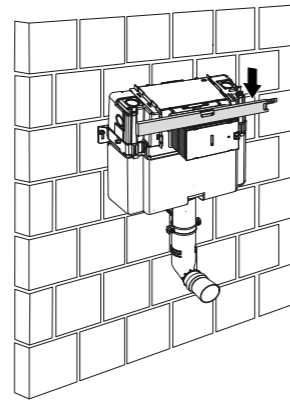

Frames

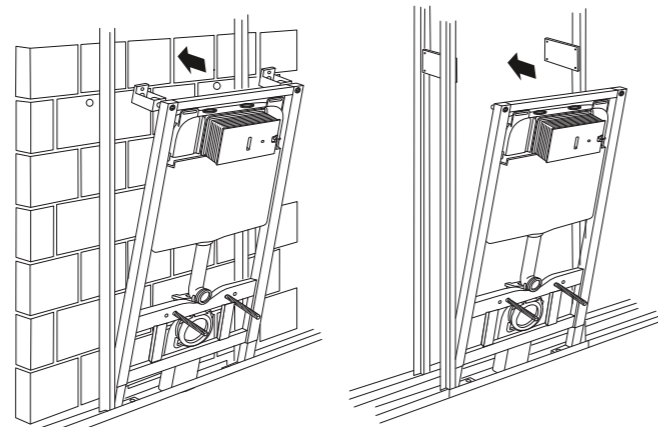

Freestanding frames

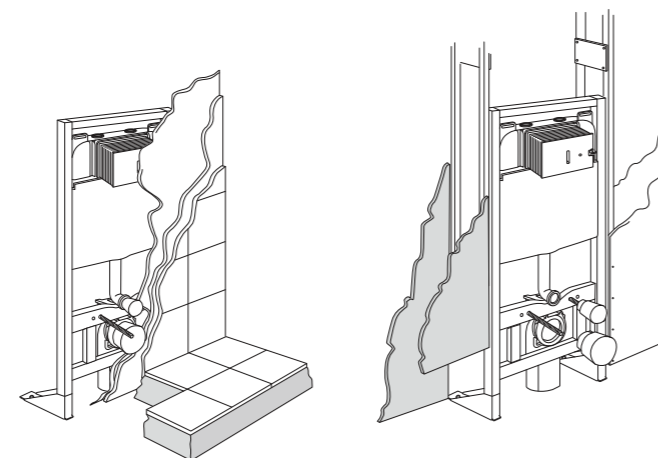

# In-wall installation types

## Concealed cisterns

This wall installation system should be selected when installing the cistern in a solid wall that will be brick lined or a cavity dry wall with a floor-standing toilet.

## Frames

This installation system can be used in dry-wall applications as well as solid wall applications. The main advantage of the system is the ease and speed of safely installing a cistern with a wall-hung toilet.

## Freestanding frames

Our freestanding frames are used in dry-wall applications with a wall-hung toilet. The main advantage of the system is the ease and speed of safely installing a concealed cistern with a wall-hung toilet without the need of any type of structural or load-bearing brick wall.



Wall-hung bowl: Tesi  
Flush plate: Oleas® M2/ P2 in brushed chrome

# ProSys® – benefits at a glance

**Tool-free servicing**  
It's quick and easy to access the cistern

**Corrosion resistant frame**  
For complete peace of mind behind the wall

**Load tested up to 400kg for WC frames**  
Washbasin frames support up to 150kg, urinal frames up to 100kg

**Adjustable outlet bend**  
Enables an easy and flexible depth adjustment to conveniently fit all waste pipe arrangements

**Simple height adjustment from 0-200mm**  
Brakes on feet make height adjustment a simple, one-man job\*

**Fast and easy installation\*\***  
EasyFix™ brackets allow for fast fixing to the wall and precise levelling of the frame in 3 easy steps

**Water-saving SmartValve**  
All ProSys® cisterns are fitted with a special delayed-fill inlet valve which can save up to 9 litres of water per day. Water only begins to fill the cistern after the flush valve is closed

**Fully adaptable service box**  
Depth is adjustable from 20 to 90mm, which allows the service box to cover all wall thicknesses. The box is made from polypropylene, which is soft and easy to cut

**Adjust dual flush volume**  
Changed manually on the outlet valve, with no need to change the inlet valve

Frame: ProSys® WC frame 120 M

\*Available for ProSys® 120 and ProSys® 150

Frame: ProSys® WC frame 120 M

\*\*Feature currently available on 120 frames only

# ProSys® WC solutions

## ProSys® 120

### Easy to install and maintain

- Tool free maintenance with access through the service tunnel assessed by removing the flush plate or inspection plate where a flush plate is positioned remotely
- Easier installation thanks to our EasyFix™ wall brackets
- Incorporated in-cistern stop valve allows for the water supply to be turned off prior to replacing the inlet valve or outlet valve seals

#### SmartValve

- Exclusive Class 2 water-saving inlet valve delays refill until flush valve is closed
- Class 2 NF certified

#### Outlet valve

- Dual flush, pre-set for 6/4 litres
- Single operation to adjust flush volumes to 4.5/3 litres

#### Compatible kits

- Electronic conversion kit – sensor – R015867
- Electronic conversion kit – infrared – R009967

## Flush plate compatibility

#### Mechanical

- Oleas M1, M2, M3, M4
- Septa Pro M1, M2

#### Pneumatic

- Oleas P1, P2, P3
- Solea P2
- Septa Pro P1, P2, P3, P4
- Septa XS P1, P2

#### Electronic with ProSys® Conversion Kit 120NTS

- Symfo NT1
- Altes NT1

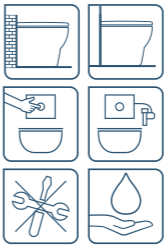

#### ProSys® WC cistern 120 M/P

**R031767 - Mechanical and R031867 - Pneumatic**

- Flush cistern to be installed inside a solid or cavity/stud wall
- Compatible with all floor-standing WC bowls (separate floor brackets also allow for installation with wall-hung WC bowls)
- Mechanical and Pneumatic actuation variants available



#### ProSys® (1150mm height) WC frame 120 M/P

**R015367 - Mechanical and R031367 - Pneumatic**

- For built-in installation into room height plasterboard constructed walls
- For wall hung WC bowls with connection dimensions in accordance with EN 33 2011
- For wall hung WC bowls up to 66cm projection
- Height adjustable legs for floor construction 0 - 200mm
- Front actuation only
- Mechanical and Pneumatic actuation variants available



#### ProSys® (1150mm height) WC frame 120 P 3 height adjustable pneumatic actuation

**R031567 - Pneumatic**

- For built-in installation into room height plasterboard constructed walls
- For wall hung WC bowls with connection dimensions in accordance with EN 33 2011
- Adjustable installation height of WC bowl during first fix installation phase (40 – 50cm)
- Suitable for use with Contour 21+ WC 75cm projection pans S0441HY / S0442HY (available from July 2021)
- Height adjustable legs for floor construction 0 - 200mm
- Front actuation only
- Pneumatic actuation



#### ProSys® WC frame Freestanding 120 M

**R031467 - Mechanical**

- For built-in installation into room height plasterboard constructed walls
- For freestanding installation on concrete floors
- For wall hung WC bowls with connection dimensions in accordance with EN 33 2011
- For wall hung WC bowls up to 70cm projection
- Height adjustable legs for floor construction 0 - 200mm
- Front actuation only
- Mechanical actuation

# ProSys® WC solutions

## ProSys® 150

### The perfect solution for low-height applications

- Tool free maintenance with access through the service tunnel assessed by removing the flush plate or inspection plate where a flush plate is positioned remotely
- Incorporated in-cistern stop valve allows for the water supply to be turned off prior to replacing the inlet valve or outlet valve seals
- Features multiple water connections and gives a choice of top or front actuation

#### Outlet valve

- Dual flush, pre-set for 6/4 litres
- EPDM seal

#### SmartValve

- Exclusive water-saving inlet valve with delayed refill system
- Class 2 NF Certified

#### Compatible kits

- Conversion kit for top actuation for mechanical models add R017667

### Flush plate compatibility

#### Mechanical

- Oleas - M1, M2, M3, M4
- Septa Pro - M1, M2

#### Pneumatic

- Oleas - P1, P2, P3
- Solea - P2
- Septa Pro - P1, P2, P3, P4
- Septa Pro XS

Proslys top actuation kit (R01767) required for Oleas or Septa flushplates with the Mechanical frame and cistern



#### ProSys® WC cistern 150 M/P

R014267 - Mechanical, R031667 - Pneumatic

- Flush cistern to be installed inside a solid or cavity/stud wall
- Compatible with all floor-standing WC bowls
- Mechanical or Pneumatic actuation options
- Front or top actuation



#### ProSys® (820mm height) WC frame 150 M/P

R014067 - Mechanical, R031267 - Pneumatic

- For built-in installation into part height plasterboard constructed walls
- For wall hung WC bowls with connection dimensions in accordance with EN 33 2011
- For wall hung WC bowls up to 66cm projection
- Height adjustable legs for floor construction 0 - 200mm
- Front and top actuation
- Mechanical and Pneumatic actuation variants available

## WC Half frames

If you already have a concealed cistern, these frames allow you to replace a floor-standing toilet with a wall-hung one. So it's possible to renovate without removing the cistern. Like our other WC frames, our half frames are corrosion-resistant and load tested up to 400kg.



#### WC half frame - R010067

- Compatible with all wall-hung WC bowls
- 2 fixation points for WC
- Pre-assembled tubular frame for built-in or plasterboard wall installation
- Quick and easy installation
- Height-adjustable from 0 to 200mm
- Depth-adjustable outlet bend



Wall-hung bowl: Concept  
Flush plate: Oleas® M3/ P3 in matt chrome



#### WC half frame freestanding - R010167

- Compatible with all wall-hung WC bowls
- 2 fixation points for WC
- Pre-assembled tubular frame for plasterboard wall installation where there is no solid wall to secure the frame to (i.e. fixed to the floor only)
- Quick and easy installation
- Height-adjustable from 0 to 200mm
- Depth-adjustable outlet bend

# ProSys® accessories

We offer accessory kits to enable different kinds of installation in various environments. We also offer sound insulation kits that considerably reduce the amount of noise that passes through walls and floors into neighbouring rooms.

## 1 Noise insulation kits

Frame to floor – R010667

- Acoustic insulation
- Avoids direct contact between the frame and the floor

WC – R017467

- Acoustic insulation in expanded polyethylene
- Avoids direct contact between the WC bowl and the tiles

## 2 Fixing kit for extended wall hung pans

R020267

- Adds stability when using frames and extended bowls

## 3 Corner installation kit

R018567

- Enables the installation of WCs in bathroom corners
- Compatible with 1150mm height frames

## 4 Connection pipes

- S-bend outlet – R020367
- Horizontal outlet WC – R019967
- Telescopic connection pipe – R0200AC
- Flexible outlet WC bend – R019567

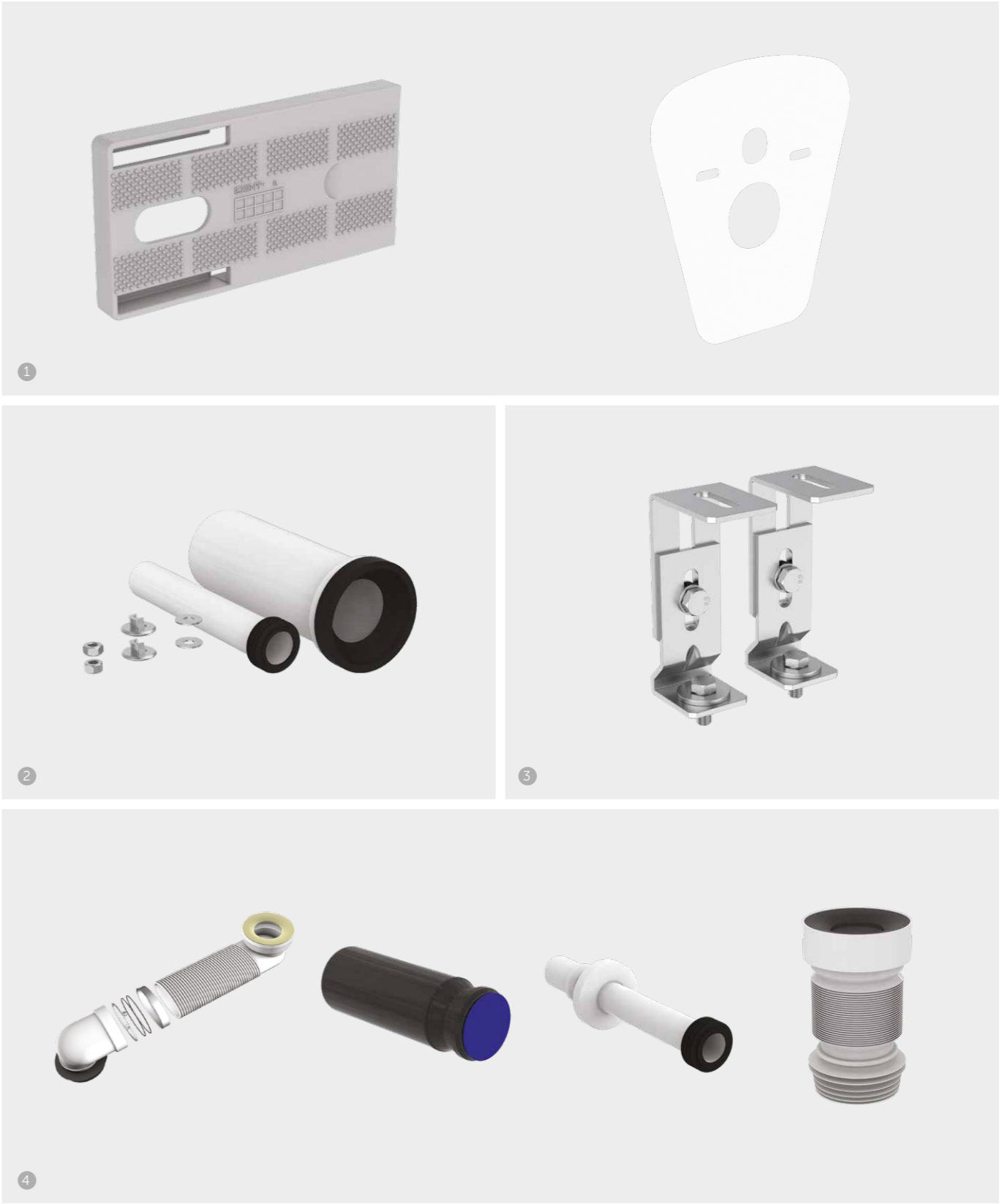

1. Noise insulation kits: Frame to floor; WC  
2. Extended bowl fixing kit  
3. Corner installation kit  
4. S-bend outlet; horizontal outlet WC; telescopic connection pipe; flexible outlet WC bend

Images are not to scale and some accessory pieces may be smaller than they appear in relation to other items. Other accessories and spares available, see Fast-Part spares for details.



Basin: Strada II 100cm  
Fitting: Edge  
Frame: ProSys® basin frame deck taps

## ProSys® non-WC solutions Basin frames

The ProSys® range includes four different installation solutions for wall-hung washbasins. We also offer a solution for wall-mounted fittings. The frames are not only easy to install, but are also thoroughly tested for loads up to 150kg.



### Basin frame deck taps – R010267

- For built-in or plasterboard wall installation
- Painted tubular frame with 1.5mm thickness, corrosion-resistant
- Height adjustable from 0 to 300mm
- Adjustable attachment plates



### Basin frame wall taps – R016167

- For built-in or plasterboard wall installation
- Painted tubular frame with 1.5mm thickness, corrosion-resistant
- Height adjustable from 0 to 300mm
- Adjustable attachment plates



Urinal: Sphero™ Maxi  
Frame: ProSys® urinal frame basic

## ProSys® non-WC solutions

### Urinal frames

Urinals are essential fixtures in public and commercial bathrooms. When installed with the ProSys urinal frames they offer a hygienic and cost-efficient solution that will last. Our urinal frames are corrosion-resistant and load tested for 100kg. They can be adjusted for height and width, and the easy way to ensure speed and consistency of fitting on project work.



#### Urinal frame – R010367

- For built-in or plasterboard wall installation
- Quick installation with EasyFix™ wall brackets
- Height adjustable from 0 to 300mm
- Adjustable wall brackets
- For back inlet installation urinals
- For use with specific urinals only, check the compatibility matrix



#### Urinal frame Sensorflow – R016367

- For built-in or plasterboard wall installation
- Quick installation with EasyFix™ wall brackets
- Height adjustable from 0 to 300mm
- Adjustable wall brackets
- For use with the Sensorflow electronic flushing system
- For use with specific urinals only, check the compatibility matrix

### Accessory frame

The same height as our standard WC frames, the ProSys accessory frame is the ideal solution to safely install urinal dividers or wall-hung support rails. Our EasyFix™ brackets provides an effortless and quick installation.



#### Accessory frame - R010567

- For built-in or plasterboard wall installation
- Painted tubular frame, corrosion-resistant
- Height adjustable from 0 to 200mm
- Strengthened wood panel
- Quick installation with EasyFix™ wall brackets

Please refer to the table on p51, to see ProSys urinal frame compatibility with Ideal Standard and Armitage Shanks urinals.

# Flush Plates

## Perfect finishing

Whatever your bathroom vision, it's the details that make the difference. That's why our range of flush plates offers a choice of shapes, colours, functions and materials to meet any design need.

You can choose from mechanical, pneumatic, and electronic "no touch" actuation (with either capacitive or infrared sensors) for a new level of hygiene and convenience at the wave of a hand. For public washroom environments, we also offer vandal-resistant models.



Oleas® M1/P1 White

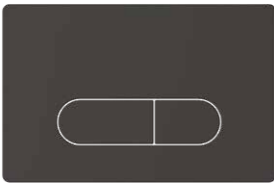

Oleas® M1/P1 Black

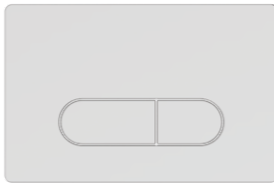

Oleas® M1/P1 Chrome

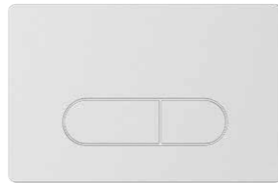

Oleas® M1/P1 Matt chrome

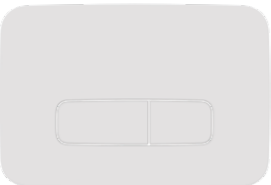

Oleas® M3/P3 White

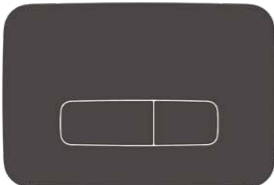

Oleas® M3 Black



Oleas® M3/P3 Chrome

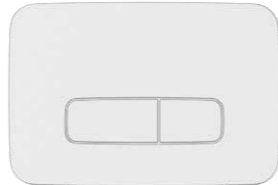

Oleas® M3/P3 Matt chrome

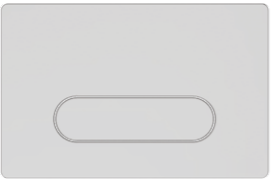

Oleas® M4 Chrome

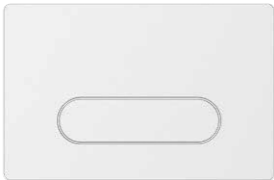

Oleas® M4 Matt chrome

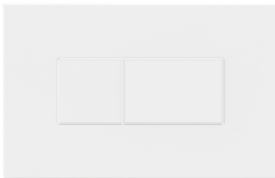

Solea® P2 White

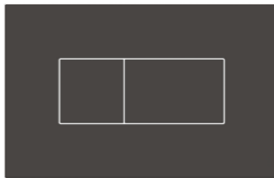

Solea® P2 Black soft-touch

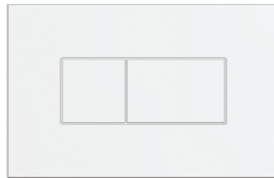

Solea® P2 Chrome

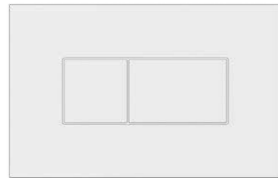

Solea® P2 Matt chrome

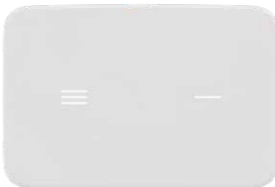

Altes® NT1 White



Altes® NT1 Black



Symfo® NT1 White



Symfo® NT1 Black



Septa Pro™ E1 Chrome

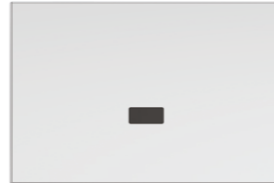

Septa Pro™ E2 Chrome

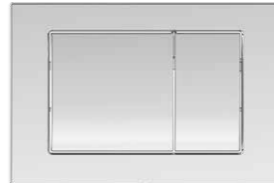

Septa Pro™ M1 Chrome

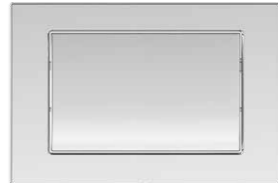

Septa Pro™ M2 Chrome



Septa Pro™ P1 Polished chrome



Septa Pro™ P2 Polished chrome



Septa Pro™ P3 Polished chrome



Septa Pro™ P4 Chrome



Septa Pro™ XS P1 Chrome

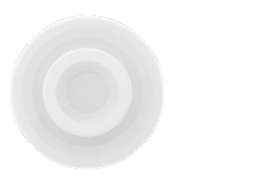

Septa™ XS P2 White

# Flush Plates

## Altes® and Symfo®

Ideal Standard's new Altes® and Symfo® ranges feature the latest no-touch technology, so the user just moves their hand near three lines designed into the glass for a full flush or over the single line graphic for a half flush – making the flush plates easy to use and ultra-hygienic.

The Altes® range is made from a beautiful ceramic, giving the plates a unique and elegant 'silky' finish. Available in either black or white, it blends seamlessly into any environment and works particularly well with the soft geometric design and gentle minimalism of our Strada II ceramic range.

Symfo® is a tempered glass plate, with a minimalist, borderless design. Its reflective appearance gives a contemporary look and feel and is the perfect complement to the lighter design and thin, curved rims of our Connect Air ceramic range.

The LED backlights on the Altes® and Symfo® flush plates are factory set to blue, but can be adjusted at installation to any of the following colours: red, yellow, white, green, violet, orange or purple.

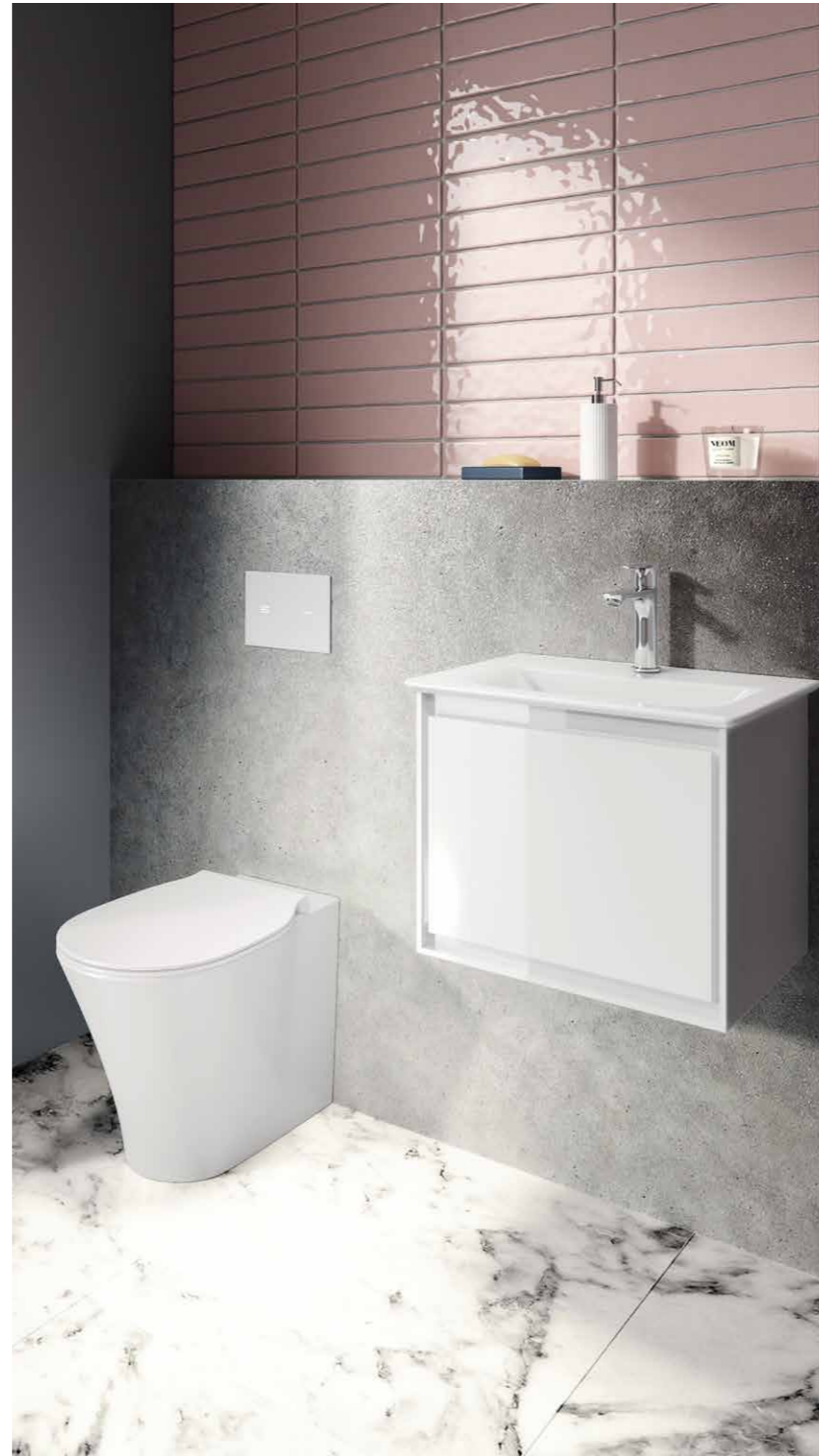

Flush plate: Symfo® NT1 in white glass  
Floor-standing bowl: Concept Air  
Fitting: Concept Air  
Vanity: Concept Air 54cm  
Furniture: Concept Air basin unit 50cm

### Overview

- Water-saving dual flush
- No-touch actuation – through capacitive sensors
- One piece ceramic (Altes®) or tempered glass (Symfo®)
- Hygienic and easy-to-clean
- Available in black or white

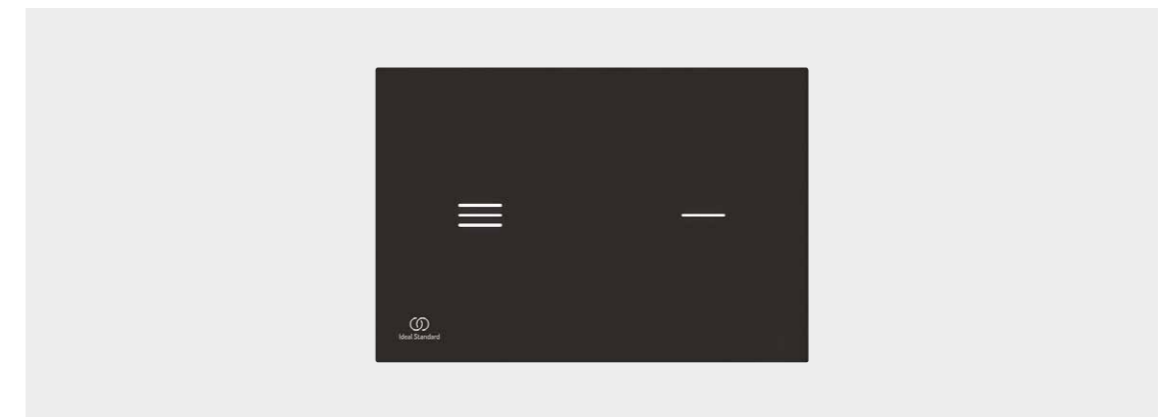

**'Our aim is to create...  
objects that provide  
lasting pleasure'**

Flush plate detail: Altes® NT1 in white ceramic  
Flush plate detail: Symfo® NT1 in black glass

# Flush Plates

Oleas®

‘The new flush plates are an example of design that fits in’

ROBIN LEVIEN



The new Oleas® collection has been developed as part of Ideal Standard’s long-standing and successful partnership with Studio Levien.

This collection features four minimalistic, highly functional models. Oleas® flush plates are available with mechanical and pneumatic actuation. Great care has gone into the movement – particularly the resistance and ‘spring-back’ of the buttons. The new Oleas® flush plates look good, feel good, work well, and ‘fit in’.

They work very well with the clean geometric lines and soft, rounded forms of our Tesi ceramics range.

### Overview

- Four different designs
- Water-saving dual flush and single flush available
- Mechanical or pneumatic actuation
- Available in different colours

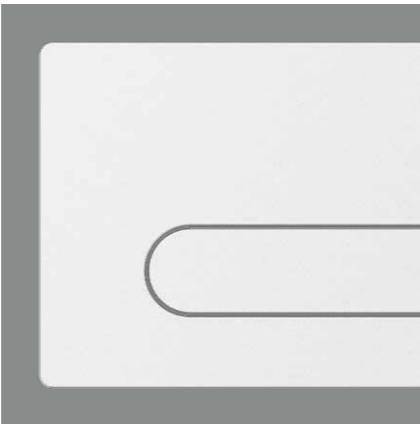

Studio**Levien**

L: Wall-hung bowl AquaBlade® Concept Air  
R: Flush plate detail: Oleas® M4 in matt chrome



Flush plate: Solea® P2 in brushed chrome  
Wall-hung bowl AquaBlade®: Concept Air

# Flush Plates

## Solea® P2

Solea® P2 pneumatic actuation flush plates are classic shapes that complement other bathroom fixtures and easily blend into any bathroom design.

Solea® P2 models feature dual flush so users choose how much water to use when flushing the toilet.

### Overview

- Water-saving dual flush
- Pneumatic actuation
- Available in four different finishes: white, chrome, brushed chrome and black

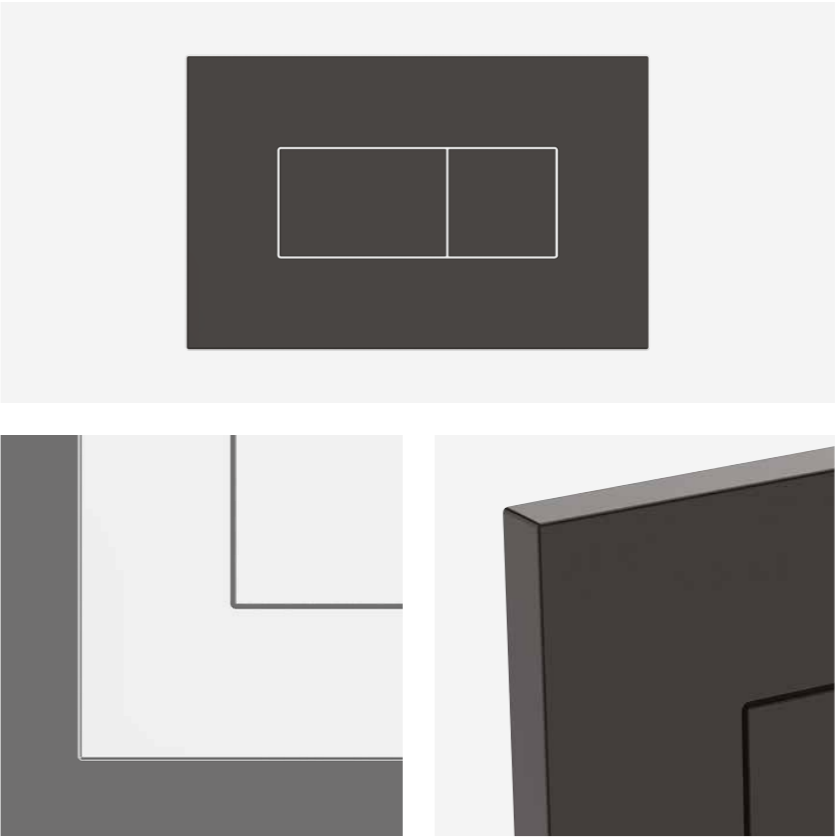

‘Solea® flush plates  
blend into any  
bathroom design’

Flush plate detail: Solea® P2 - in chrome and black

# Flush Plates

## Septa Pro™

Our range of Septa Pro™ flush plates are known for their versatility and durability. They come in a variety of shapes, sizes and finishes which makes them the perfect choice for any situation. Vandal-resistant and made with robust materials, they are particularly suitable for commercial, public and semi-public washrooms. High-tech features such as infrared actuation sensors also help make them more hygienic as there is no need to touch the flush plate. Additionally, the range includes models that can be installed away from the cistern for remote activation and easier access.



Flush plate detail: Septa Pro™ P1 Polished chrome



### Overview

- A range of different designs
- Water-saving dual flush and single flush available
- Mechanical, pneumatic and infrared sensor actuation available
- Vandal-resistant
- Available in different finishes and materials

L: Flush plate detail: Septa Pro™ M1 Chrome  
R: Flush plate detail: Septa Pro™ P4 Chrome  
B: Flush plate detail: Septa Pro™ P1 Polished chrome



Flush plate: Septa Pro™ P1 in chrome  
Wall-hung bowl: Aquablade® : Concept Air

‘Septa Pro™ ...  
the perfect choice  
for any situation’

# Flush Plates

## Minimum wall thickness (mm)

M: mechanical actuation  
P: pneumatic actuation  
M F: mechanical front actuation  
M T: mechanical top actuation  
N/C: not compatible  
N/A: not applicable



	Model	INSTALLATION ProSys® 1150		INSTALLATION ProSys® 820		INSTALLATION ProSys® 820	
		height mechanical	height pneumatic	height mechanical Front actuation	height pneumatic Front actuation	height mechanical Top actuation	height pneumatic Top actuation
Mechanical	Oleas® M1	15		0		0	
	Oleas® M2	15		0		0	
	Oleas® M3	15		0		0	
	Oleas® M4	15		0		0	
	Septa Pro™ M1	0		0		0	
	Septa Pro™ M2	0		0		0	
Pneumatic	Oleas® P1		30		0		30
	Oleas® P2		30		0		30
	Oleas® P3		30		0		30
	Solea® P2		25		0		20
	Septa Pro™ P1		10		0		0
	Septa Pro™ P2*		N/A		N/A		N/A
	Septa Pro™ P3*		N/A		N/A		N/A
	Septa Pro™ P4*		N/A		N/A		N/A
	Septa™ XS P1*		N/A		N/A		N/A
Electronic	Septa Pro™ E1	10	10	N/C	N/C	N/C	N/C
	Septa Pro™ E2	10	10	N/C	N/C	N/C	N/C
	Symfo® NT1	10	10	N/C	N/C	N/C	N/C
	Symfo® NT2	10	10	N/C	N/C	N/C	N/C

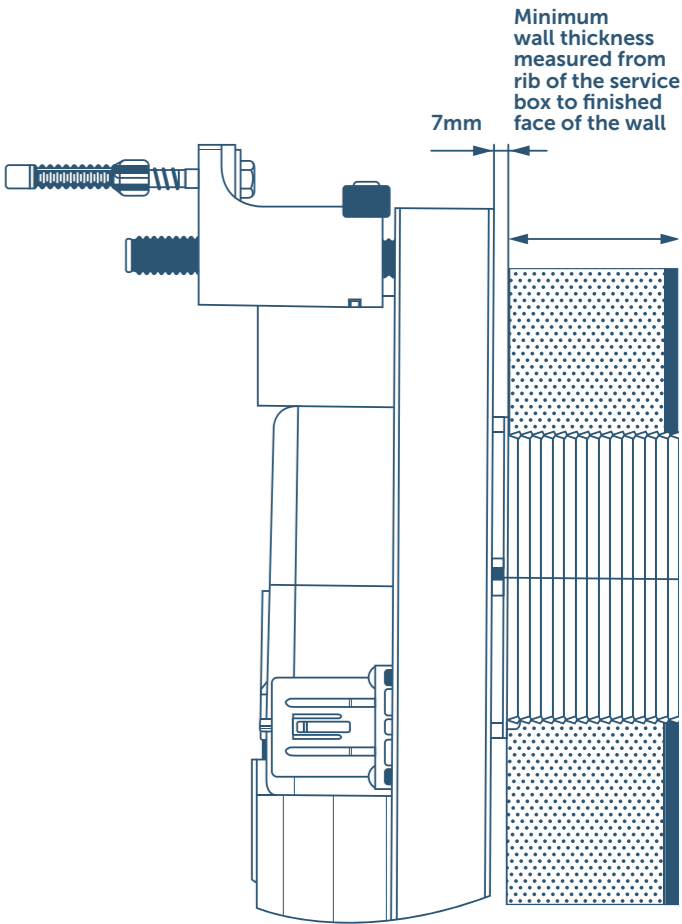

\*No minimum wall thickness required as flush plate is not installed in front of the cistern.  
An inspection plate is required to access the cistern.  
Electronic plates are only compatible with full height frames and 120 cisterns  
See diagram to the right and take account of the 7mm measurement for the rib of the service box

# Technical information

## ProSys® 120



### WC Cistern 120 M / P



Model	Ref
WC Cistern 120 M / P	R031767 - Mechanical R031867 - Pneumatic

- Compatible with back to wall floor standing WC bowls
- For installation into brick and cavity/stud constructed walls
- Minimum wall depth 126mm
- Supplied with anti-condensation lining and plaster mesh
- Mechanical or pneumatic flushplate actuation
- Electronic flushplate conversion kits available
- Fully maintainable through service tunnel positioned at the front of the tank

#### Characteristics

- Dual flush pre-set at 6/4L
- Polypropylene tank which has good chemical, fatigue and heat resistant properties
- NF-certified Class 2 inlet valve with patented water saving delayed fill feature
- 3mm thick tank; delivered with anti-condensation lining;
- CE marking EN 14055 Class 2 Type 6 & 4
- 2 water supply options (back centre top & left side top)
- Supplied with reversible cistern brackets for either back or front face fixings
- WC flush pipe and seal

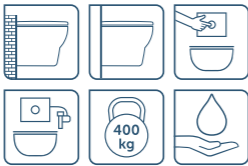

### WC Frame 120 M / P



Model	Ref
WC Frame 120 M / P	R015367 - Mechanical R031367 - Pneumatic

- For built-in installation into room height plasterboard constructed walls
- For wall hung WC bowls with connection dimensions in accordance with EN 33 2011
- For wall hung WC bowls up to 66cm projection
- Frame load tested to 400 kilos
- Quick adjustable height legs with brakes allowing one person installation
- Height adjustable from 0 to 200 mm
- Easy and quick installation with EasyFix™ wall brackets
- Depth adjustable from 150 to 210 mm
- Frame corrosion and scratch resistant
- Depth and directional adjustable outlet bend
- Mechanical and Pneumatic flushplate actuation
- Electronic flush plate conversion kits available
- Fully maintainable through service tunnel positioned at the front of the tank

#### Characteristics

- Dual flush pre-set at 6/4L
- Polypropylene tank which has good chemical, fatigue and heat resistant properties
- NF-certified Class 2 inlet valve with patented water saving delayed fill feature
- 3mm thick tank; delivered with anti-condensation lining
- CE marking EN 14055 Class 2 Type 6 & 4
- 2 water supply options (back centre top & left side top)
- Supplied with all frame and WC bowl fixings
- 90mm diameter connection pipe and 90/90 outlet bend with 90/100 and 90/110 adapters



### WC Frame 120 P 3 Heights



Model	Ref
WC Frame 120 P 3H	R031567

- For built-in installation into room height plasterboard constructed walls
- For wall hung WC bowls with connection dimensions in accordance with EN 33 2011
- Suitable for use with Contour 21+ WC 75cm projection pans S0441HY / S0442HY (available from July 2021)
- Allows height adjustment of the WC pan fixation in three different positions prior to wall closure
- Frame load tested to 400 kilos
- Quick adjustable height legs with brakes allowing one person installation
- Height adjustable from 0 to 200 mm
- Easy and quick installation with EasyFix™ wall brackets
- Depth adjustable from 150 to 210mm
- Frame corrosion and scratch resistant
- Depth and directional adjustable outlet bend
- Pneumatic flushplate actuation
- Electronic flush plate conversion kits available
- Fully maintainable through service tunnel positioned at the front of the tank

#### Characteristics

- Dual flush pre-set at 6/4L
- Polypropylene tank which has good chemical, fatigue and heat resistant properties
- NF-certified Class 2 inlet valve with patented water saving delayed fill feature
- 3mm thick tank; delivered with anti-condensation lining
- CE marking EN 14055 Class 2
- 2 water supply options (back centre top & left side top)
- Supplied with all frame and WC bowl fixings
- 90mm diameter connection pipe and 90/90 outlet bend with 90/100 and 90/110 adapters

# Technical information

## ProSys® 120



### WC Frame Freestanding 120 M



Model	Ref
WC Frame FS 120 M	R031467

- For built-in installation into room height plasterboard constructed walls
- For freestanding installation on concrete floors
- For wall hung WC bowls with connection dimensions in accordance with EN 33 2011
- For wall hung WC bowls up to 70cm projection
- Frame load tested to 400 kilos
- Quick adjustable height legs with brakes allowing one person installation
- Height adjustable from 0 to 200 mm
- Easy and quick installation with EasyFix™ wall brackets
- Frame corrosion and scratch resistant
- Depth and directional adjustable outlet bend
- Mechanical flush plate actuation
- Electronic flush plate conversion kits available
- Fully maintainable through service tunnel positioned at the front of the tank

#### Characteristics

- Dual flush pre-set at 6/4L
- Polypropylene tank which has good chemical, fatigue and heat resistant properties
- NF-certified Class 2 inlet valve with patented water saving delayed fill feature
- 3mm thick tank; delivered with anti-condensation lining
- CE marking EN 14055 Class 2
- 2 water supply options (back centre top & left side top)
- Supplied with all frame and WC bowl fixings
- 90mm diameter connection pipe and 90/100mm outlet bend

# Technical information

## ProSys® 150



WC Cistern 150 M / P



Model	Ref
WC Cistern 150 M / P	R014267 - Mechanical R031667 - Pneumatic

- Compatible with back to wall floor standing WC bowls
- For installation into masonry or cavity/stud constructed walls
- Minimum wall depth 150mm
- Supplied with anti-condensation lining
- Mechanical & Pneumatic flush plate actuation
- Requires separate central block R017667 for top actuation of Oleas M1, M2, M3 & M4 flush plates
- Fully maintainable through service tunnel positioned at the front or top of the tank

#### Characteristics

- Dual flush pre-set at 6/4L
- Polypropylene tank which has good chemical, fatigue and heat resistant properties
- NF-certified Class 2 inlet valve with patented water saving delayed fill feature
- 3mm thick tank; delivered with anti-condensation lining
- CE marking EN 14055 Class 2 Type 6 & 4
- 3 options for water supply top right hand and side inlet left and right
- Supplied with cistern wall brackets
- WC flush pipe and seal

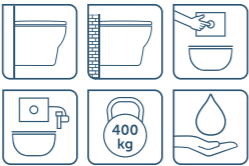

WC Frame 150 M / P



Model	Ref
WC Frame 150 M / P	R014067 - Mechanical R031267 - Pneumatic

- For built-in installation into part height plasterboard constructed walls
- For wall hung WC bowls with connection dimensions in accordance with EN 33 2011
- For wall hung WC bowls up to 66cm projection
- Frame load tested to 400 kilos
- Quick adjustable height legs with brakes allowing one person installation
- Height adjustable from 0 to 200 mm
- 820mm overall height suitable for lower/under window installation
- Adjustable depth 150 > 200mm
- Depth and directional adjustable outlet bend
- Mechanical or Pneumatic flushplate actuation
- Fully maintainable through service tunnel positioned at the front or top of the tank

#### Characteristics

- Dual flush pre-set at 6/4L
- Polypropylene tank which has good chemical, fatigue and heat resistant properties
- NF-certified Class 2 inlet valve with patented water saving delayed fill feature
- 3mm thick tank; supplied with anti-condensation lining
- CE marking EN 14055 Class 2 Type 6 & 4
- 3 options for water supply top right hand and side inlet left and right
- Supplied with all frame and WC bowl fixings
- 90mm diameter connection pipe, 90/90mm outlet bend, 90/100 and 90/110 adapters

# Technical information

## WC Half Frames



WC Half Frame



Model	Ref
WC Half frame	R010067

- Compatible with all wall-hung WC bowls
- For built-in installation into masonry and plasterboard constructed walls
- Ideal for use where cistern is already fitted for example where floor standing WC is being replaced with a wall hung WC
- Frame load tested to 400 kilos
- Height adjustable from 0 to 200 mm
- Adjustable depth 120 > 190mm
- Depth and directional adjustable outlet bend

#### Characteristics

- Supplied with all frame and WC bowl fixings
- 90mm diameter connection pipe, 90/90mm outlet bend, 90/100 and 90/110 adapters



WC Half Frame Freestanding



Model	Ref
WC Half frame Freestanding	R010167

- Compatible with all wall-hung WC bowls
- For built-in installation into plasterboard constructed walls
- Ideal for use where cistern is already fitted for example where floor standing WC is being replaced with a wall hung WC
- Frame load tested to 400 kilos
- Height adjustable from 0 to 200 mm
- Minimum depth 185mm
- Depth and directional adjustable outlet bend

#### Characteristics

- Supplied with all frame and WC bowl fixings
- 90mm diameter connection pipe, 90/90mm outlet bend, 90/100 and 90/110 adapters

# Technical information

## Urinal Frames



### Urinal Frame for Sensorflow installation



Model	Ref
Sensorflow urinal frame	R016367

- Compatible with specific wall-hung urinals. See matrix for model compatibility
- For built-in installation into masonry and plasterboard constructed walls
- Height adjustable legs from 0 to 300 mm
- Easy and quick installation with EasyFix™ wall brackets
- Adjustable depth 120 > 170
- Frame load tested to 100 kilos
- Adjustable height attachment bars
- Top recessed fixing panel for built in or infrared urinal flush control

- Characteristics
- Supplied with all frame fixings
  - Outlet bend 50/50mm
  - Outlet bend seal 50mm
  - 1 angled wall connector ½ F x ½ M



### Back Inlet Urinal Frame



Model	Ref
Back inlet urinal frame	R010367

- Compatible with specific wall-hung urinals. See matrix for model compatibility
- For built-in installation into masonry and plasterboard constructed walls
- Height adjustable legs from 0 to 300 mm
- Easy and quick installation with EasyFix™ wall brackets
- Adjustable depth 120 > 170
- Frame load tested to 100 kilos
- Adjustable height attachment bars
- For exposed manual urinal flush control

- Characteristics
- Supplied with all frame fixings
  - Outlet bend 50/50mm
  - Outlet bend seal 50mm
  - 1 angled wall connector ½ F x ½ M

# ProSys Urinal

## Frame compatibility

### Urinal Frame for Sensorflow installation

R016367



Sphero Mini
Sphero Midi
Sphero Midi Sensorflow
Contour: Not compatible
Contour Sensorflow: Not compatible
Profile Sensorflow
Sandringham: Not compatible
Sanura: Not compatible
Jasper Morrison
Profile 21 mains powered
Aridian: Not compatible

### Back Inlet Urinal Frame

R010367



Sphero Mini
Sphero Midi
Sphero Maxi
Sphero Maxi Hybrid
Contour: Not compatible
Contour Sensorflow: Not compatible
Profile
Sandringham: Not compatible
Sanura: Not compatible
Aridian: Not compatible

Note: Top inlet version of urinals will not be used on in wall frames. | When using the Sphero Maxi e-hybrid urinal the fixing strutt is required - R014067

# Technical information

## Basin Frames

### Basin Frame Deck Taps



Model	Ref
Basin Frame Deck Taps	R010267

- Compatible with wall-hung basins with deck mounted taps
- For built-in installation into masonry and plasterboard constructed walls
- Height adjustable legs from 0 to 300 mm
- Easy and quick installation with EasyFix™ wall brackets
- Adjustable depth 120 > 170
- Frame load tested to 150 kilos
- Adjustable height attachment bars
- Water connections pre drilled at 80 and 280mm centres

- Characteristics
- Supplied with all frame and basin fixings
  - Outlet bend multi fit 40-32/50-40mm
  - 2 angled wall connector ½ F x ½ M

### Basin Frame Wall Taps



Model	Ref
Basin Frame Wall Taps	R016167

- Compatible with wall-hung basins with wall mounted taps
- For built-in installation into masonry and plasterboard constructed walls
- Height adjustable legs from 0 to 300 mm
- Easy and quick installation with EasyFix™ wall brackets
- Adjustable depth 120 > 170
- Frame load tested to 150 kilos
- Adjustable height attachment bars

- Characteristics
- Supplied with all frame and basin fixings
  - Outlet bend multi fit 40-32/50-40mm
  - 2 angled wall connector ½ F x ½ M



### Accessory Frame



Model	Ref
Accessory Frame	R010567

- Compatible with hinged arm support rails, fixed grab rail or urinal divider
- For installation into masonry and plasterboard constructed walls
- Height adjustable from 0 to 200 mm
- Easy and quick installation with EasyFix™ wall brackets
- Depth adjustable from 120 to 170 mm

- Characteristics:
- Supplied with all frame fixings



Wall-hung WC: AquaBlade® Strada II  
Flush plate: Oleas® P2  
Vessel: Strada II  
Vessel mixer: Edge  
Furniture: Adapto

# Technical information

## Flush plates



Altes® NT1

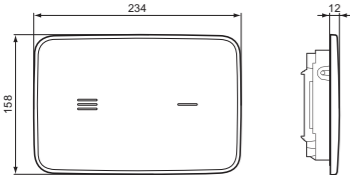

Model	Ref
NT1 White	R0130AC
NT1 Black	R0130A6

- One-piece ceramic material
- Dual flush
- No-touch activation through capacitive sensors
- Detection capacity – about 20mm
- Sensor sensitivity adjustment
- Duty flush and timing
- Waterproof connectors
- Anti-error electronic connections
- Operating temperature 0 – 70°C
- Degree of sensor protection: IP67
- Electronic connectors anti-error and waterproof: IP66
- Hygienic and easy to clean
- Requires R015867 conversion kit
- Ideal Standard branded



Symfo® NT1

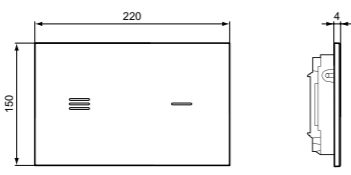

Model	Ref
NT1 White	R0129SA
NT1 Black	R0129RX

- One-piece tempered glass
- Dual flush
- No-touch activation through capacitive sensors with LED signs (sensor lighting adjustment; multiple LED back light colours: blue, red, yellow, white, green, violet, orange and purple)
- Detection capacity – about 20mm
- Sensor sensitivity adjustment
- Duty flush and timing
- Gull-Wing opening system which prevents damages to the control plate in actions of installation and maintenance
- Waterproof connectors
- Anti-error electronic connections
- Hygienic and easy to clean
- Requires R015867 conversion kit
- Ideal Standard branded



Oleas® M1

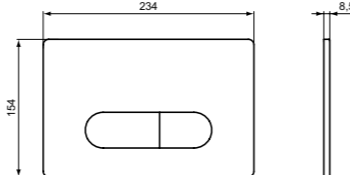

Model	Ref
M1 White	R0115AC
M1 Chrome	R0115AA
M1 Matt Chrome	R0115JG
M1 Black	R0115A6

- Dual flush
- Mechanical actuation
- Actuation force < 20N
- Ideal Standard branded



Oleas® M2

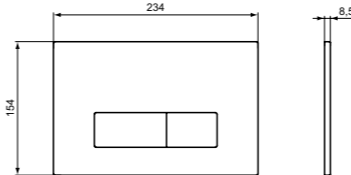

Model	Ref
M2 White IS branded	R0121AC
M2 White AS branded	S0767AC
M2 Chrome IS branded	R0121AA
M2 Chrome AS branded	S0767AA
M2 Matt Chrome IS branded	R0121JG
M2 Matt Chrome AS branded	S0767JG
M2 Black IS branded	R0121A6
M2 Black AS branded	S0767AG

- Available branded Ideal Standard or Armitage Shanks
- Square design
- Dual flush
- Mechanical actuation
- Actuation force < 20N



Oleas® M3

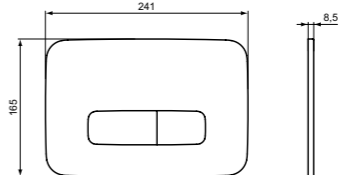
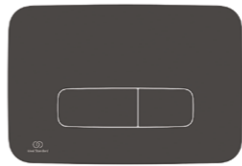

Model	Ref
M3 White	R0123AC
M3 Chrome	R0123AA
M3 Matt Chrome	R0123JG
M3 Black	R0123A6

- Soft-square design
- Dual flush
- Mechanical actuation
- Actuation force < 20N
- Ideal Standard branded



Oleas® M4

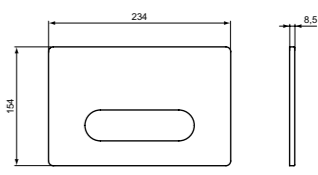
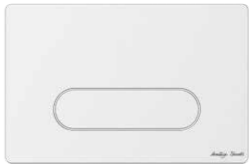

Model	Ref
M4 Chrome	S0766AA
M4 Matt Chrome	S0766JG

- Branded Armitage Shanks
- Single flush
- Mechanical actuation
- Actuation force < 20N

# Technical information

## Flush plates



Oleas® P1

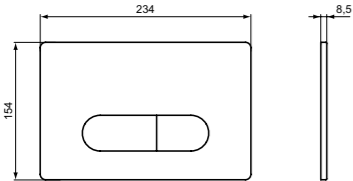
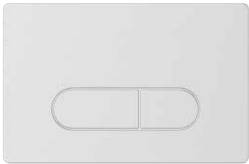

Model	Ref
P1 White	R0116AC
P1 Chrome	R0116AA
P1 Matt Chrome	R0116JG
P1 Black	R0116A6

- Dual flush
- Pneumatic actuation
- Actuation force < 20N
- Ideal Standard branded



Oleas® P2

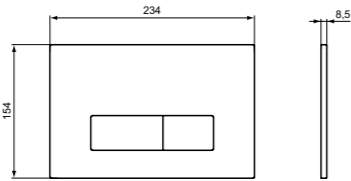

Model	Ref
P2 White IS branded	R0119AC
P2 Chrome IS branded	R0119AA
P2 Chrome AS branded	S0857AA
P2 Matt Chrome IS branded	R0119JG
P2 Matt Chrome AS branded	S0857JG
P2 Black IS branded	R0119A6
P2 Black AS branded	S0857A6

- Dual flush
- Pneumatic actuation
- Actuation force < 20N
- Ideal Standard or Armitage Shanks branded



Oleas® P3

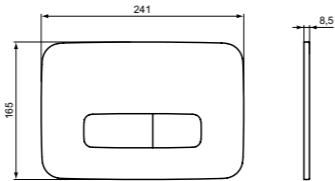

Model	Ref
P3 White	R0124AC
P3 Chrome	R0124AA
P3 Matt Chrome	R0124JG

- Soft-square design
- Dual flush
- Pneumatic actuation
- Actuation force < 20N
- Ideal Standard branded



Solea® P2

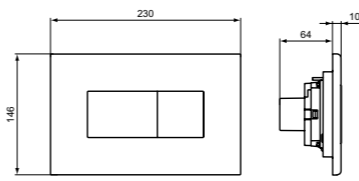
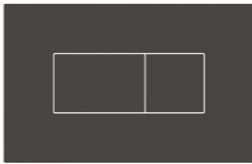

Model	Ref
P2 White	R0110AC
P2 Chrome	R0110AA
P2 Matt Chrome	R0110JG
P2 Black Soft-Touch	R0110A6

- ABS material
- Dual flush
- Pneumatic actuation
- Actuation force < 20N
- Ideal Standard branded



Septa Pro™ E1

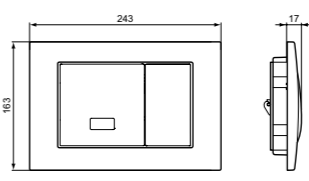
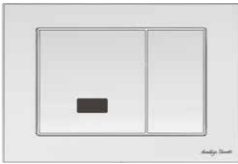

Model	Ref
E1 Chrome	S0772AA

- Branded Armitage Shanks
- Zamac material
- Dual flush (< 60s half flush; > 60s full flush)
- Infrared actuation or mechanical actuation (in case of electricity failure)
- Actuation force < 20N
- Flushes are activated when the user moves away
- Automatic
- Pre-installed power supply connection required for transformer
- Transformer 230v/120 included
- Auto flush every 24 hours
- Vandal-resistant
- Requires R009967 electronic conversion kit



Septa Pro™ E2

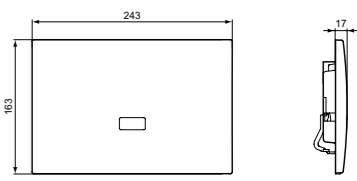

Model	Ref
E2 Chrome	S0773AA

- Branded Armitage Shanks
- Zamac material
- Dual flush (< 60s half flush; > 60s full flush)
- Infrared actuation
- Flushes are activated when the user moves away
- Pre-installed power supply connection required for transformer
- Transformer 230v/120 included
- Vandal-resistant
- Requires R009967 electronic conversion kit

# Technical information

## Flush plates



Septa Pro™ M1

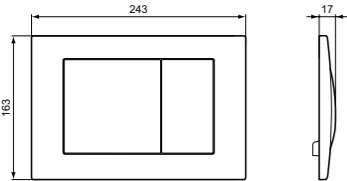
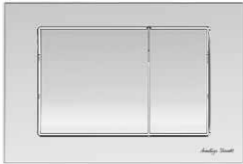

Model	Ref
M1 Chrome	S0858AA

- Branded Armitage Shanks
- Zamac material
- Dual flush
- Mechanical actuation
- Actuation force < 20N
- Vandal-resistant



Septa Pro™ M2

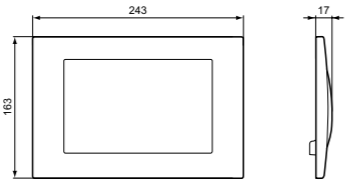
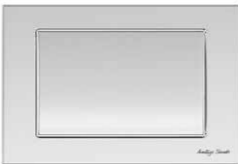

Model	Ref
M2 Chrome	S0859AA

- Branded Armitage Shanks
- Zamac material
- Single flush
- Mechanical actuation
- Actuation force < 20N
- Vandal-resistant



Septa Pro™ P1

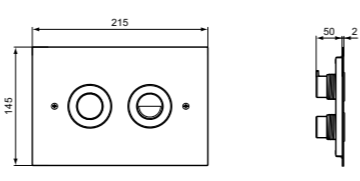
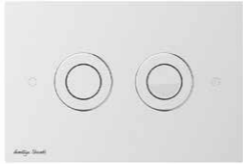

Model	Ref
P1 Chrome	S0775MY

- Branded Armitage Shanks
- Polished chrome finish
- Dual flush
- Pneumatic actuation
- Actuation force < 20N
- Fixing material and pneumatic pipe not included
- Vandal-resistant



Septa Pro™ P2

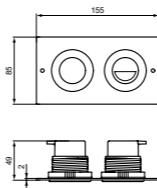

Model	Ref
P2 Chrome	S0860MY

- For remote installation:
- Branded Armitage Shanks
  - Polished chrome finish
  - Dual flush
  - Pneumatic actuation
  - Actuation force < 20N
  - Supplied with fixing material, pneumatic pipe (2,5m) and protective pipe cover (3m)
  - Vandal-resistant
  - Septa Pro inspection plate (separate order) is required to access the cistern



Septa Pro™ P3

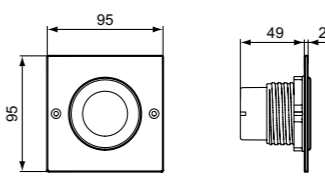

Model	Ref
P3 Chrome	S0776MY

- For remote installation:
- Branded Armitage Shanks
  - Polished chrome finish
  - Single flush
  - Pneumatic actuation
  - Actuation force < 20N
  - Supplied with fixing material, pneumatic pipe (2,5m) and protective pipe cover (3m)
  - Vandal-resistant
  - Septa Pro inspection plate (separate order) is required to access the cistern



Septa Pro™ P4

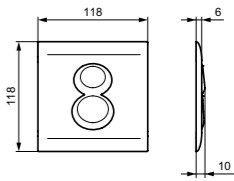

Model	Ref
P4 Chrome	R0136AA

- For remote installation:
- ABS material
  - Dual flush
  - Pneumatic actuation
  - Actuation force < 20N
  - Vandal-resistant
  - Compliant with Safety Regulations against Fire and Panic Hazards in Public Buildings (ERP) – Article Co 31.
  - Raised button settings for less abled use
  - Septa Pro™ inspection plate (separate order) is required to access the cistern
  - No Logo

- For remote installation order separately:
- R019667 ProSys® pneumatic pipe 3m x 2
  - R019767 ProSys® corrugated pneumatic barrier pipe 1.8m

# Technical information

## Flush plates



Septa™ XS P1

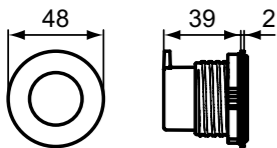

Model	Ref
XS P1 Chrome	P0109AA

- For remote installation:
- ABS material
  - Single flush
  - Pneumatic actuation
  - For tight wall installation only
  - Septa Pro™ inspection plate (separate order) is required to access the cistern
  - No logo

- For remote installation order separately:
- R019667 ProSys® pneumatic pipe 3m x 2
  - R019767 ProSys® corrugated pneumatic barrier pipe 1.8m



Septa™ XS P2

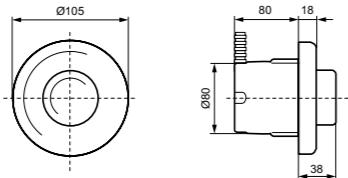

Model	Ref
XS P1 White	R0184AC

- For remote installation:
- ABS material
  - Single flush
  - Pneumatic actuation
  - Supplied with fixing material, pneumatic pipe (2,5m) and protective pipe cover (2,5m)
  - Septa Pro™ inspection plate (separate order) is required to access the cistern
  - Raised button
  - No logo



Septa Pro™ Inspection

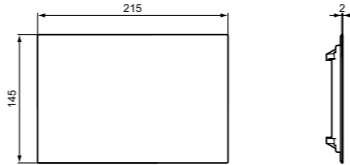

Model	Ref
White	R0137AC
Chrome	R0137AA
Matt Chrome	R0137JG

- Required when flush plate is fitted in remote position (not directly to cistern)
- Provides maintenance access to cistern ABS material for white model
- Stainless steel material for chrome and matt chrome models
- Compatible with all ProSys® cisterns
- Vandal-resistant
- No logo

# Flush plate





## branding matrix



IS: Ideal Standard



AS: Armitage Shanks

	Chrome 	White 	Black 	Chrome Matt 
OLEAS®				
M1	IS	IS	IS	IS
M2	IS/AS	IS/AS	IS/AS	IS/AS
M3	IS	IS	IS	IS
M4	AS	X	X	AS
P1	IS	IS	IS	IS
P2	IS/AS	IS	IS/AS	IS/AS
P3	IS	IS	X	IS
SOLEA®				
P2	IS	IS	IS	IS
SEPTA				
Pro M1	AS	X	X	X
Pro M2	AS	X	X	X
Pro P1	AS	X	X	X
Pro P2	AS	X	X	X
Pro P3	AS	X	X	X
Pro P4	AS - No Logo	X	X	X
Inspection Plate	AS - No Logo	AS - No Logo	X	AS - No Logo
Pro XS P1	AS - No Logo	X	X	X
Pro XS P2	X	AS - No Logo	X	X
Pro E1	AS	X	X	X
Pro E1	AS	X	X	X
ALTES®/SYMFO®				
NT1	X	IS	IS	X

# Flush plates compatibility with frames and cisterns

	OLEAS®		SOLEA®
FRAME & CISTERN TYPE	Pneumatic	Mechanical	Pneumatic
150 Frames (820H)	Compatible	Compatible	Compatible
120 Frames (1150H)	Compatible	Compatible	Compatible
120 3 Height Frame (1150mm H)	Compatible	X	Compatible
120 Freestanding Frame (1150mm H)	X	Compatible	X
150 Concealed Cisterns	Compatible	Compatible	Compatible
120 Concealed Cisterns	Compatible	Compatible	Compatible

SEPTA			ALTES® / SYMFO®	TOP FLUSH KIT
Pneumatic	Mechanical	Electronic	Electronic	Mechanical
Compatible	Compatible	X	X	Compatible
Compatible	Compatible	Compatible	Compatible	X
Compatible	X	Compatible	Compatible	X
X	Compatible	Compatible	Compatible	X
Compatible	Compatible	X	X	Compatible
Compatible	Compatible	Compatible	Compatible	X

# Technical information

## Accessories



### Electronic Conversion Kit 120 – Sensor



Model	Ref
Conversion Kit 120 NT S	R015867

- Conversion from mechanical to electronic actuation sensor operated flush plates Symfo® and Altes®
- Pre-installation of electric connection is needed for connection to mains
- Supplied with transformer to convert mains voltage to extra low voltage for optimum safety
- Compatible with ProSys® 120 cisterns



### Electronic Conversion Kit 120 – Infrared



Model	Ref
Conversion Kit 120 NT IR	R009967

- Conversion from mechanical to electronic actuation infrared operated flush plates Septa Pro™ E1 and E2
- Pre-installation of electric connection is needed for connection to mains
- Transformer is supplied with Septa Pro™ E1 and E2 flush plates
- Compatible with ProSys® 120 cisterns



### Top Actuation Conversion Kit 150

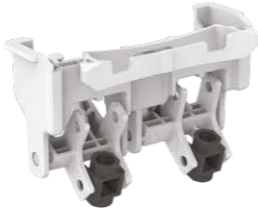

Model	Ref
Conversion Kit 150 M T	R017667

- Conversion from mechanical front actuation to top actuation
- Compatible with R014267 ProSys® 150 mechanical cistern
- Compatible with mechanical Oleas® flush plates



Wall-hung bowl: Blend  
 Flush plate: Symfo® NT1 in white glass  
 Vessel: Ipalyss® 55cm  
 Vessel mixer: Joy

# Solutions for any project

### Stadiums and transport hubs

We offer a range of durable, easy-to-clean and cost-efficient products and technologies for use in high-traffic washrooms in transport hubs and sports stadiums.

### Hotels and restaurants

Reliable, well-designed products that are suited to everything from busy public washrooms to exclusive guest bathrooms.

### Apartment blocks

Sound insulation and optimum space utilisation can all be enhanced by our pre-wall systems, flush plates, ceramics and fittings.

### Workplaces

High-quality design for visitor areas and hard-wearing, easy-to-maintain systems for heavily used employee washrooms, along with high-technology flush systems and taps to reduce operating costs.

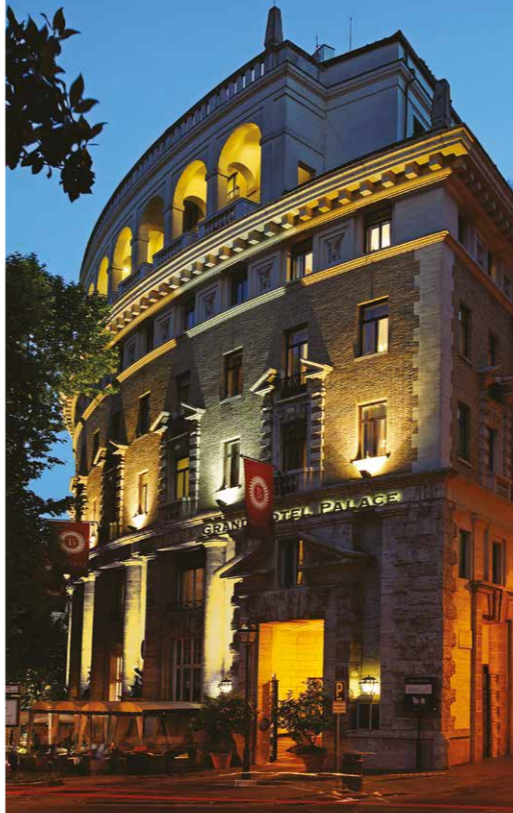

### Hospitals

Hygiene is the primary concern in hospitals and care facilities. Ideal Standard offer a number of specialised products that improve hygiene.

### Private homes

All the design choices you need to create the perfect bathroom or modernise an existing one.

### Education

We offer a full range of child-friendly products in age-appropriate sizes and designs.

Ideal Standard pursue a policy of continuing improvement in design and performance of our products. The right is therefore reserved to vary specifications without notice. While great care has been taken to ensure accuracy of all product codes, descriptions and dimensions, Ideal Standard reserves the right to correct errors or misprints. Colour reproduction is as accurate as possible within the limitations of the printing process.

©Ideal Standard UK Ltd

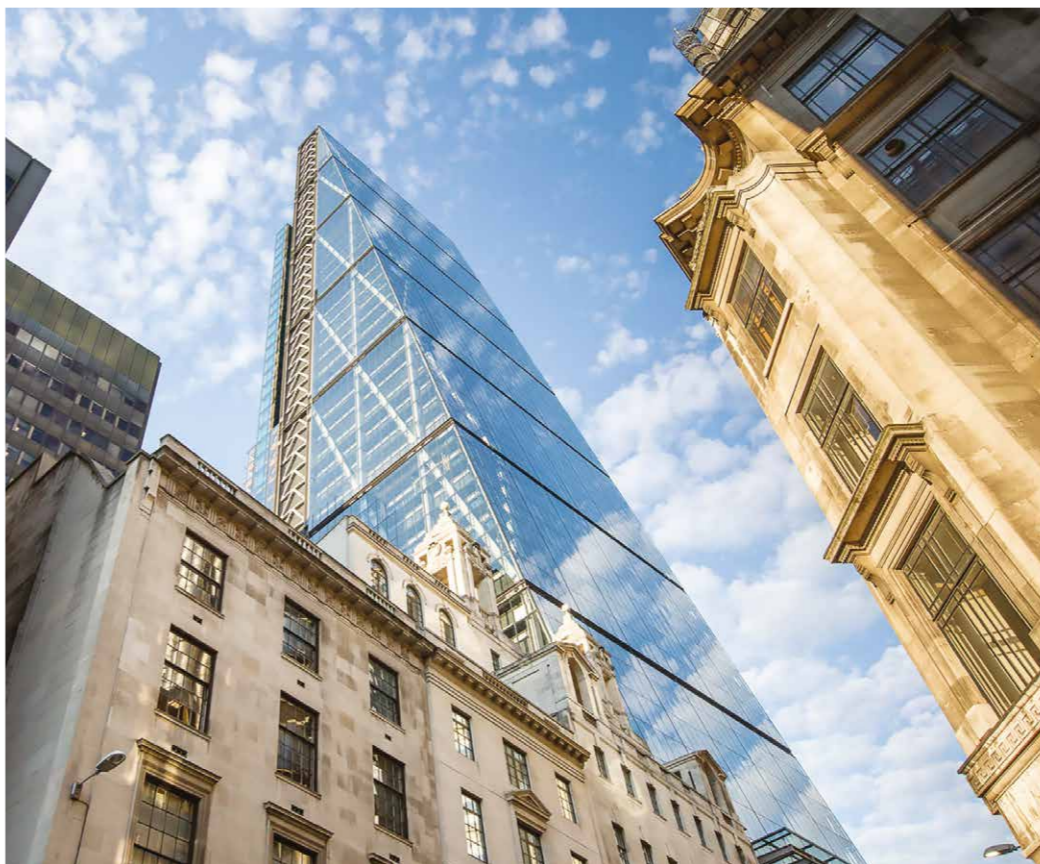



Ideal Standard

Ideal Standard (UK) Ltd  
The Bathroom Works  
National Avenue  
Kingston Upon Hull  
HU5 4HS  
England

01482 346461  
[www.IdealStandard.co.uk](http://www.IdealStandard.co.uk)