

Alto CT 150cm x 70cm Water Saving Idealform Plus+ Bath Handgrips No Tapholes

ILLUSTRATED

- E7622** Alto Contract 150 x 70cm Idealform Plus+ water saving bath with chrome handgrips, no tapholes
- E4796** Unilux Plus+ 150cm front panel
- E4831** Unilux Plus+ 70cm end panel
- E5795** Waste 1½" bath pop-up waste and overflow components only
- E5800** Bath pop-up waste operating handle and cover only

OPTIONS

- A5634** Alto Ecotherm dual control wall mounted bath shower mixer with fast-fix wall bracket & new body - no kit
- S8830** Waste 1½" bath chain and overflow, plastic plug
- B9556** Idealrain S3 shower kit with 3 function 80mm handspray, 600mm metal slide rail, 1.8m hose & integrated soap dish.

ILLUSTRATED PRODUCT DETAILS





Weights

- E7622** 32.81 KG
- E4796** 3.30 KG
- E4831** 2.58 KG
- E5795** 1.34 KG
- E5800** 0.82 KG

Materials

- E7622** Idealform Plus+
- E4796** Acrylic
- E4831** Acrylic
- E5795** Chrome Plated Metal
- E5800** Chrome Plated Metal

Finishes

- E7622**  White (01)
- E4796**  White (01)
- E4831**  White (01)
- E5795**  Neutral / No Finish (67)
- E5800**  Chrome (AA)

Capacity

- E7622** 149 litres (to overflow)

Designer

Robin Levien, RDI

Standards

Constructed to EN 198:2008. EN 14516

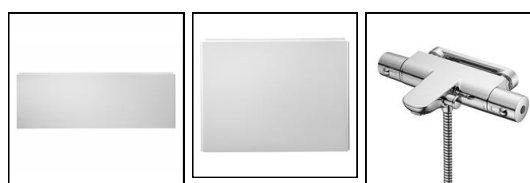
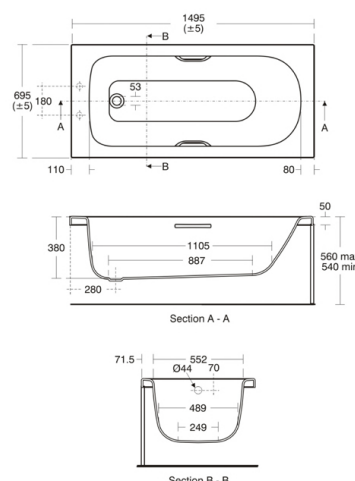

ACCREDITATIONS



Alto CT 150cm x 70cm Water Saving Idealform Plus+ Bath Handgrips No Tapholes

FEATURES

