

IMPORTANT

Read the instructions carefully and follow them exactly. Failure to do so may result in personal injury or property damage. The manufacturer is not responsible for any damage or injury caused by improper use of the product.

1. Never touch the glass with bare hands. Always use the handles and latches to open and close the door.

2. Do not lean against the glass. The glass is not designed to support weight.

3. Do not use the glass as a shelf or for any other purpose. The glass is not designed to support weight.

4. Do not use the glass as a screen or for any other purpose. The glass is not designed to support weight.

5. Do not use the glass as a door or for any other purpose. The glass is not designed to support weight.

6. Do not use the glass as a partition or for any other purpose. The glass is not designed to support weight.

7. Do not use the glass as a screen or for any other purpose. The glass is not designed to support weight.

8. Do not use the glass as a door or for any other purpose. The glass is not designed to support weight.

9. Do not use the glass as a partition or for any other purpose. The glass is not designed to support weight.

10. Do not use the glass as a screen or for any other purpose. The glass is not designed to support weight.

WICHTIG

Lesen Sie die Anweisungen sorgfältig und befolgen Sie sie genau. Bei Nichtbeachtung kann es zu Personenschäden oder Sachschäden kommen. Der Hersteller ist nicht haftbar für Schäden oder Verletzungen, die aus einer falschen Verwendung des Produkts resultieren.

1. Berühren Sie das Glas niemals mit bloßen Händen. Verwenden Sie immer die Griffe und Schließmechanismen, um die Tür zu öffnen und zu schließen.

2. Lehn Sie sich nicht gegen das Glas. Das Glas ist nicht dafür ausgelegt, Gewicht zu tragen.

3. Verwenden Sie das Glas nicht als Ablagefläche oder für andere Zwecke. Das Glas ist nicht dafür ausgelegt, Gewicht zu tragen.

4. Verwenden Sie das Glas nicht als Schirm oder für andere Zwecke. Das Glas ist nicht dafür ausgelegt, Gewicht zu tragen.

5. Verwenden Sie das Glas nicht als Tür oder für andere Zwecke. Das Glas ist nicht dafür ausgelegt, Gewicht zu tragen.

6. Verwenden Sie das Glas nicht als Trennwand oder für andere Zwecke. Das Glas ist nicht dafür ausgelegt, Gewicht zu tragen.

7. Verwenden Sie das Glas nicht als Schirm oder für andere Zwecke. Das Glas ist nicht dafür ausgelegt, Gewicht zu tragen.

8. Verwenden Sie das Glas nicht als Tür oder für andere Zwecke. Das Glas ist nicht dafür ausgelegt, Gewicht zu tragen.

9. Verwenden Sie das Glas nicht als Trennwand oder für andere Zwecke. Das Glas ist nicht dafür ausgelegt, Gewicht zu tragen.

10. Verwenden Sie das Glas nicht als Schirm oder für andere Zwecke. Das Glas ist nicht dafür ausgelegt, Gewicht zu tragen.

028S9HJE4

IMPORTANT:
**Please read the complete instructions
before commencing fitting.**

Make sure the tray is 100% level in all directions.
Do Not attempt to install the product unless you
can tick all 4 boxes satisfactorily.

- Check that you have the tools required ☐
- Check the installation site is compatible with
the sizes of door supplied ☐
- Check all the enclosure components are present ☐
- Check the installation kit is complete ☐

The wall plugs supplied with the installation kit are
for use in solid walls. Hollow or 'stud partition'
walls will require alternative fixings. Please consult
a hardware supplier for the correct type.
It may also be necessary to consult your tiling
supplier about the correct method for drilling your
tiles.

**ATTENTION: TAKE EXTREME CARE WHEN
HANDLING GLASS, WEAR PROTECTIVE EYEWEAR
AND CLOTHING. DO NOT LEAVE THE GLASS ON
HARD SURFACES AND AVOID CONTACT BETWEEN
THE GLASS EDGES AND HARD SURFACES OR
IMPACTS DURING THE INSTALLATION.**



No.	Qty	Part No.	No.	Qty	Part No.	No.	Qty	Part No.
①	2	A06S0058	⑮	2	A06S0032	⑳	1	A06S0038
②	2	A01S0115	⑯	1	D	㉑	1	A06S0043
③	2	A06S0060	⑰	1	A06S0031	㉒	1	A06S0069
④	1	A	⑱	8	A06S0049	㉓	2	A01S0154
⑤	2	A06S0048	⑲	10	8SSJ066	㉔	1	A06S0044N
⑥	1	A06S0030	㉀	1	A06S0082	㉕	1	A06S0037
⑦	1	A06S0081	㉁	2	A06S0010	㉖	1	A06S0003
⑧	1	A06S0021	㉂	1	A06S0028			
⑨	1	A06S0020	㉃	1	A06S0016			
⑩	1	B	㉄	1	A06S0015			
⑪	1	C	㉅	8	A06S0012			
⑫	1	A06S0023	㉆	8	A06S0013			
⑬	1	A06S0024	㉇	8	A06S0011			
⑭	1	A06S0025	㉈	1	A06S0041N			

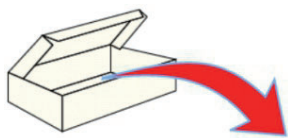

A06S0060 L/R
×2

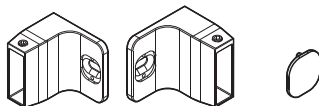

A06S0030 ×1 A06S0031 ×1 A06S0032 ×2

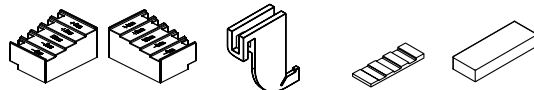

A06S0067 ×2 A06S0039 ×3 A06S0062 ×2 A06S0063 ×2

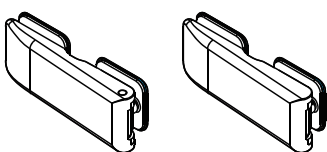

A06S0010
×2



A06S0081
×1



A06S0021
×1



A06S0020
×1

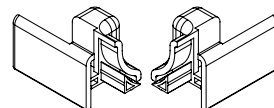

A06S0037 L/R
×1

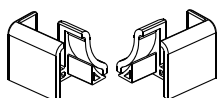

A06S0038 L/R
×1

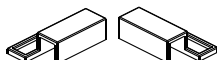

A06S0066 L/R
×2

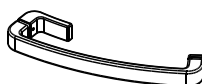

A06S0015
×1

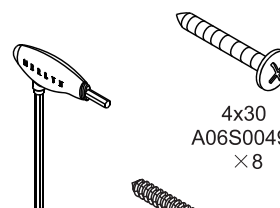

4mm
A06S0046
×1

4x30
A06S0049
×8

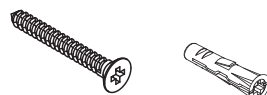

4x30
A06S0048
×2



8SSJ066
×10



A06S0023
×1



A06S0028
×1

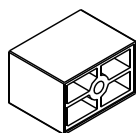

A06S0024
×1



A06S0025
×1

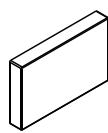

A06S0082
×1



3.0mm
8S1300611
×1

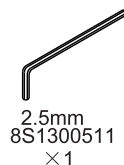

2.5mm
8S1300511
×1



A09S0052
×1

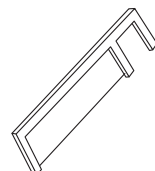
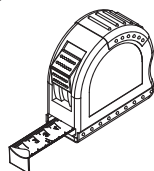
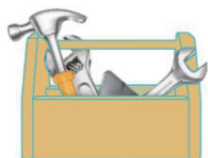

PH2

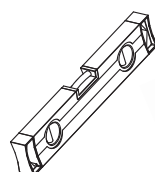

Φ6

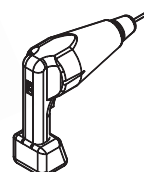

1

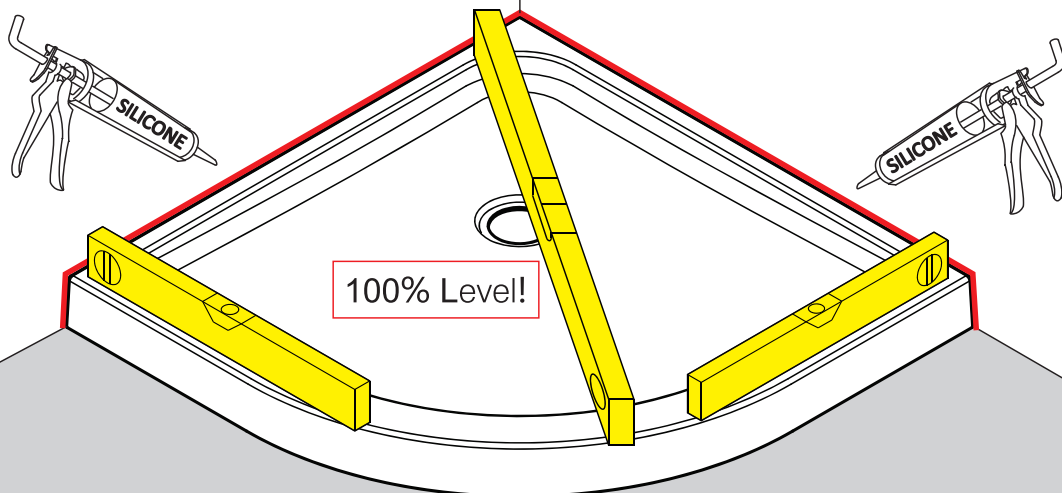
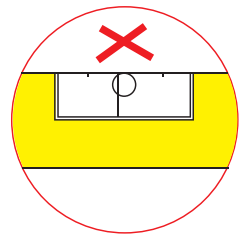
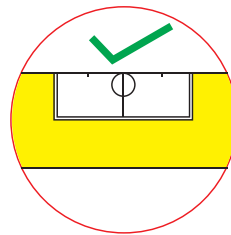

NOTE: Tray must be 100% level in all directions

Seal between tiles and the tray before fitting enclosure

2



Do not silicone the wall profiles to the wall at this stage

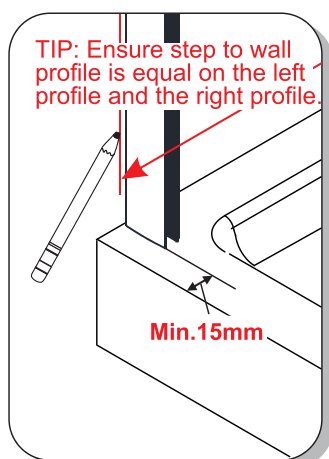

NOTE: To guarantee optimum product performance wall profiles must be positioned at a minimum of 15mm from the tray edge.

Size Taille Größe Maat	X	Y
800	765-790	765-790
900	865-890	865-890
900x760	725-750	865-890
1000x800	765-790	965-990
1000x1000	965-990	965-990
1200x800	765-790	1165-1190
1200x900	865-890	1165-1190

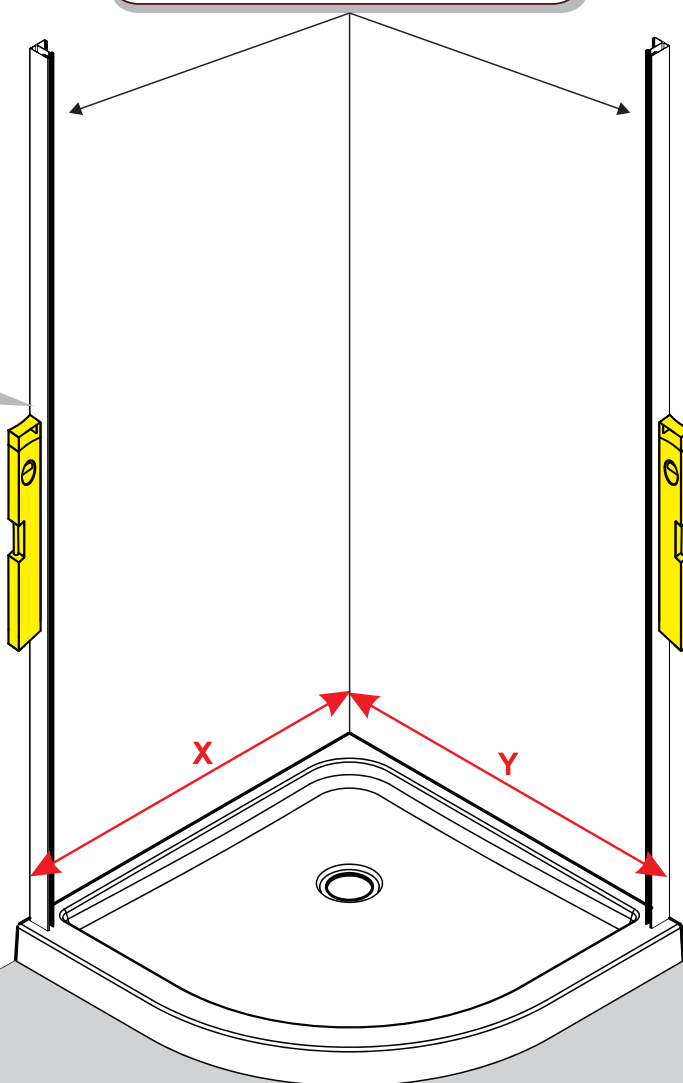

3

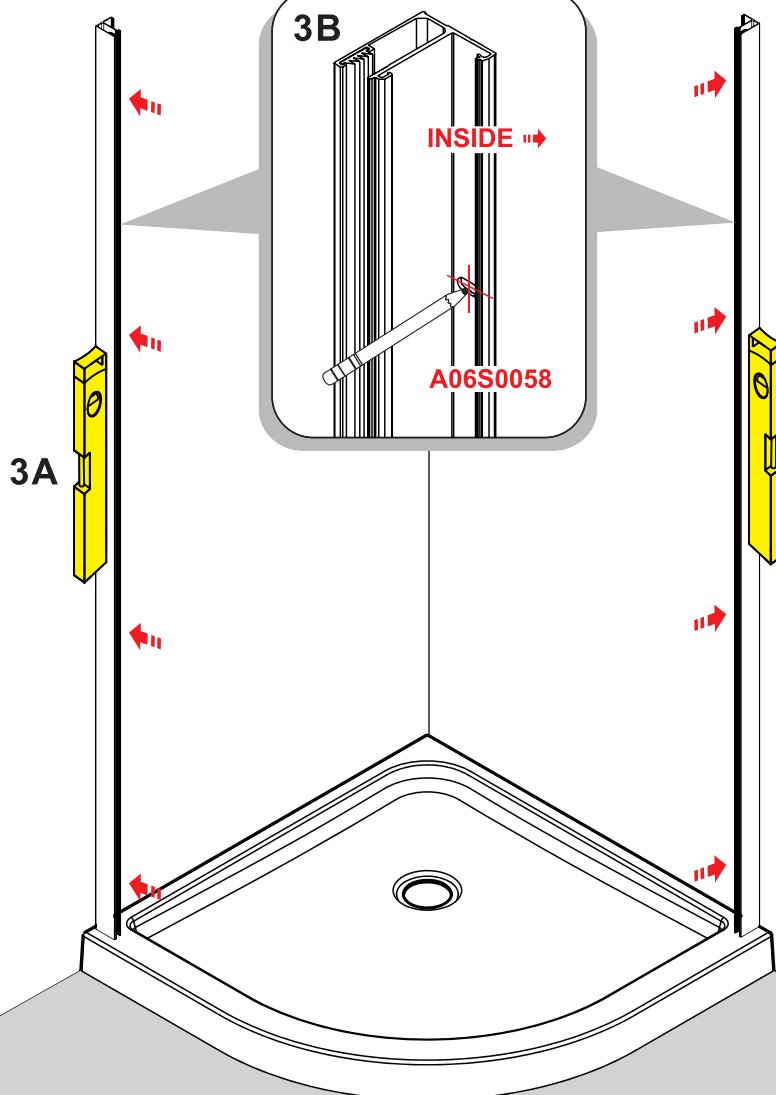
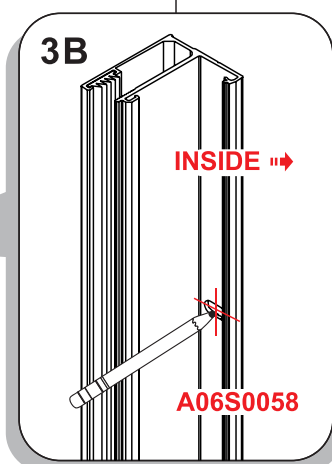
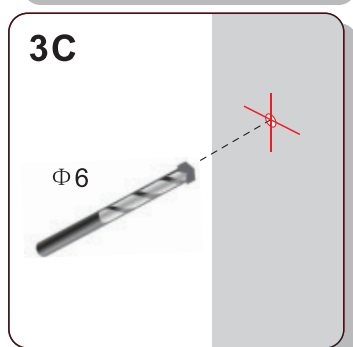
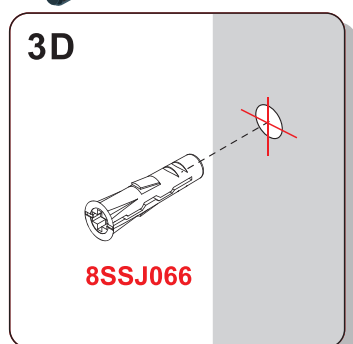
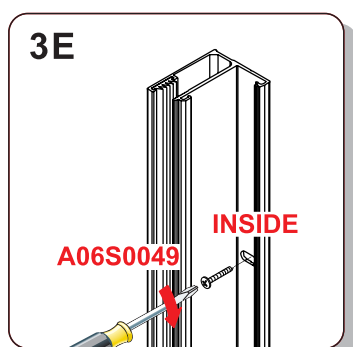

4

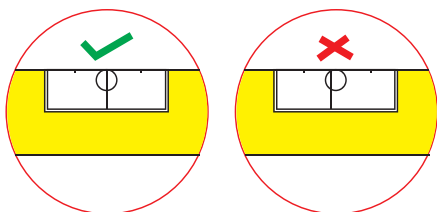

4B

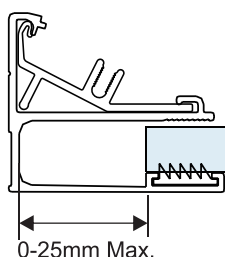

Make sure both fixed panels are adjusted evenly on each side

4C

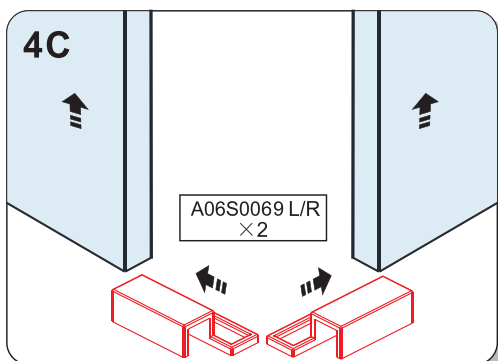

4D

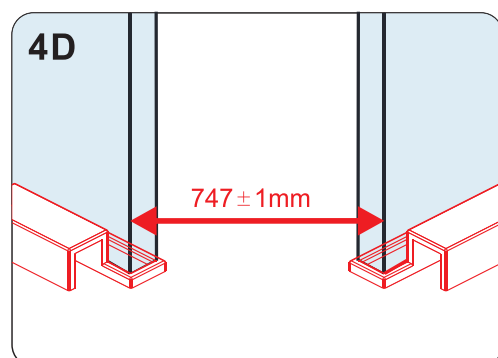

4A

INSIDE "→"

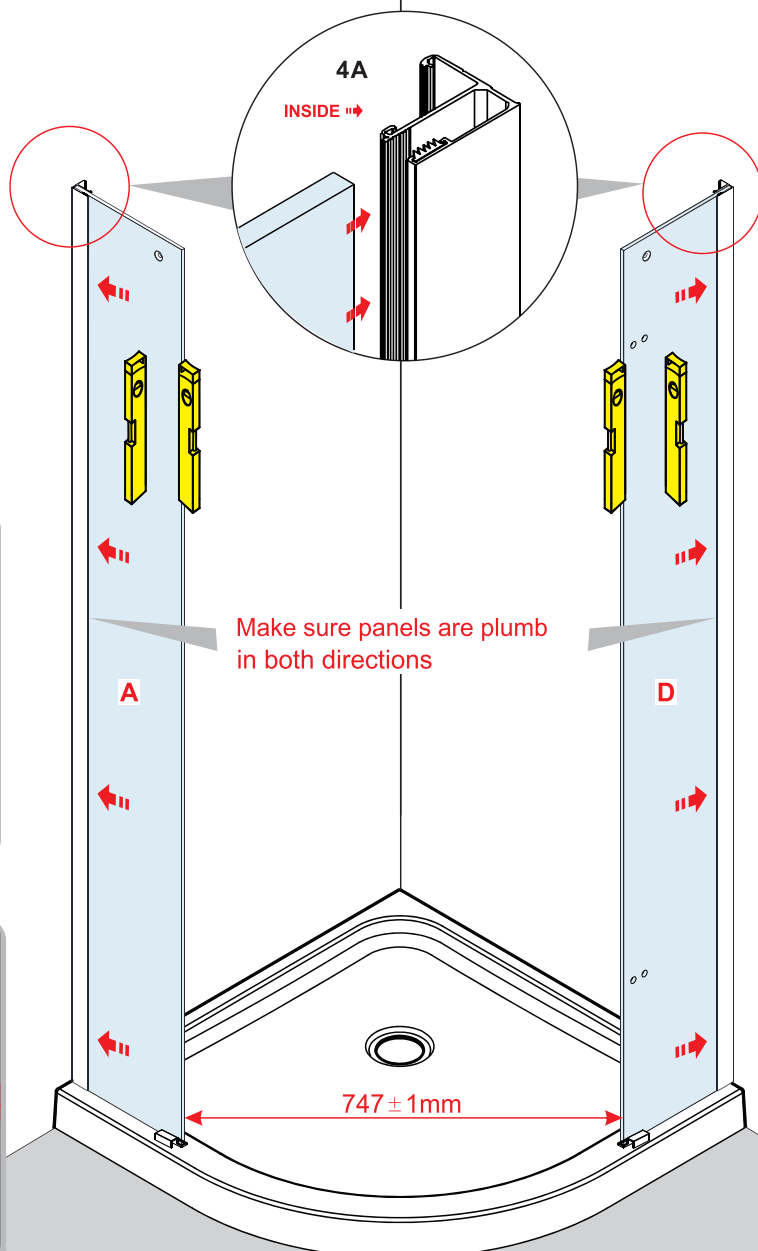

5

5A

Set gap between fixed panels to $747 \pm 1\text{mm}$,
(measured from outside edges of fixed panels),
then insert wedge gaskets 100mm on each
side to hold the fixed panels in position

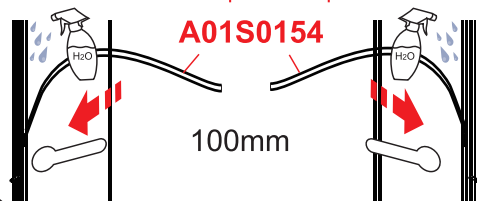

5A

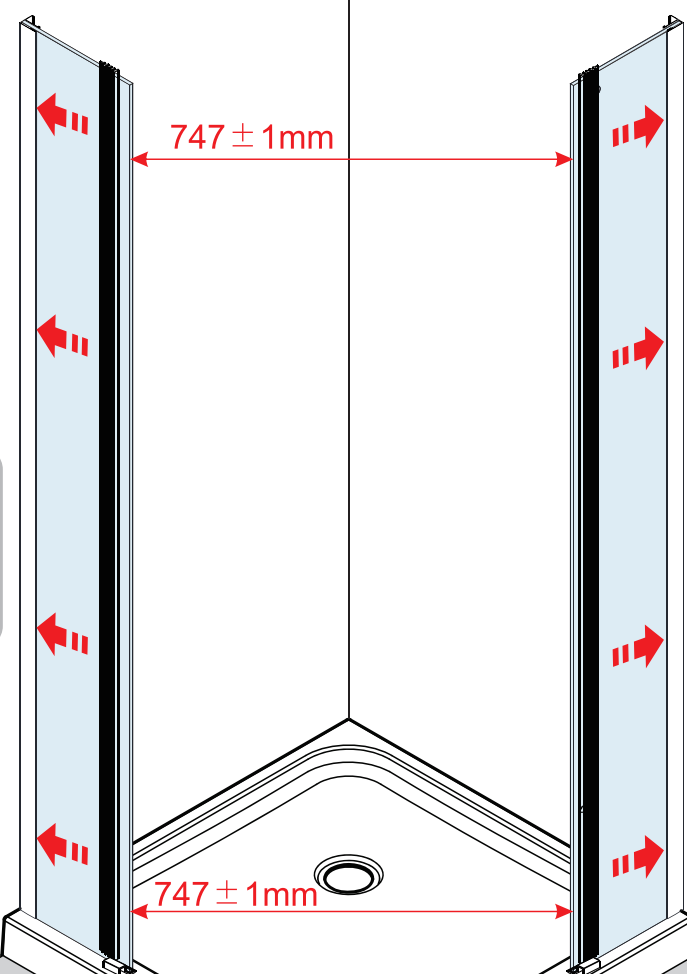
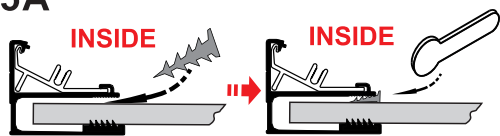

6

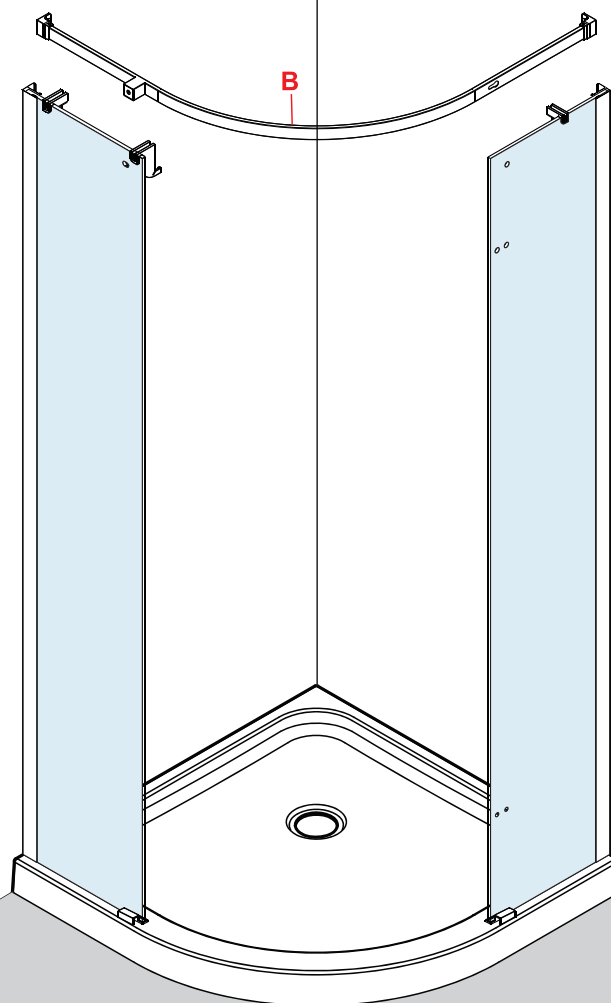
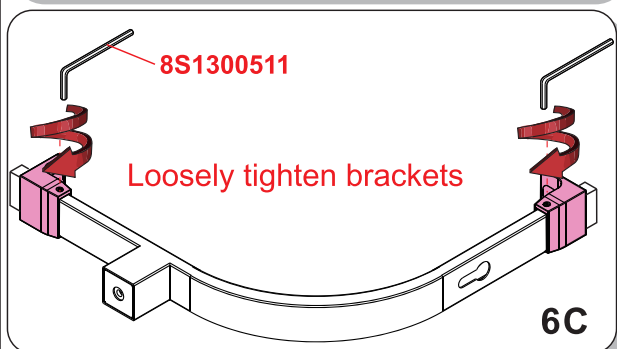
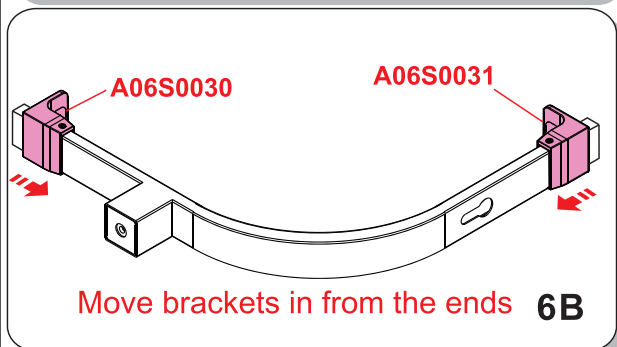
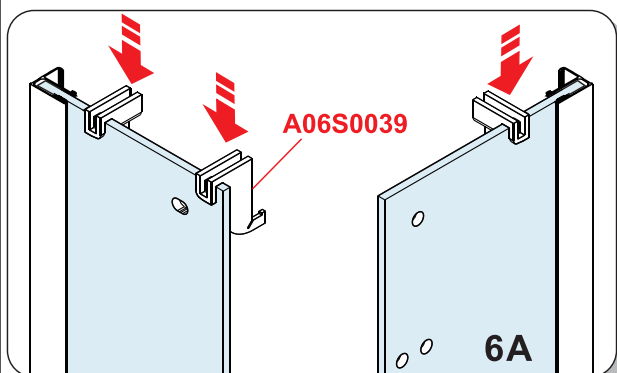

7

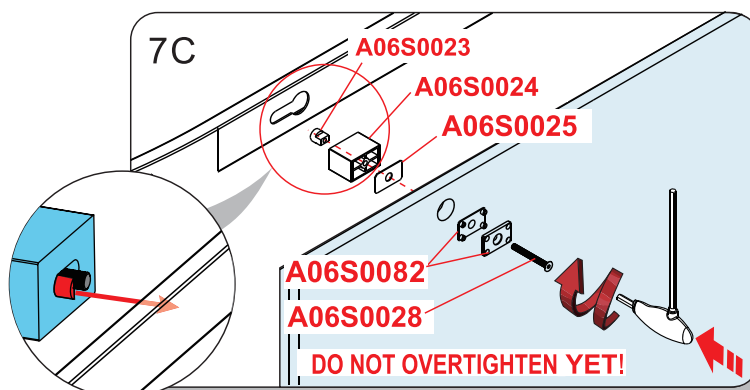
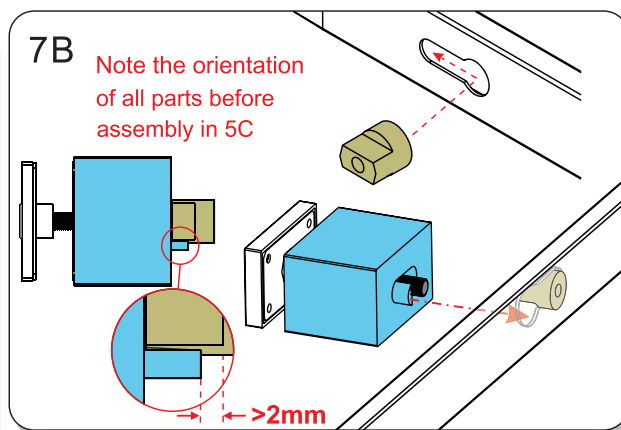
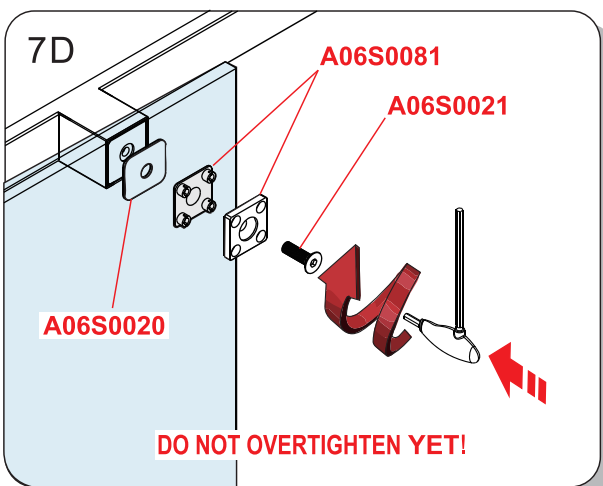
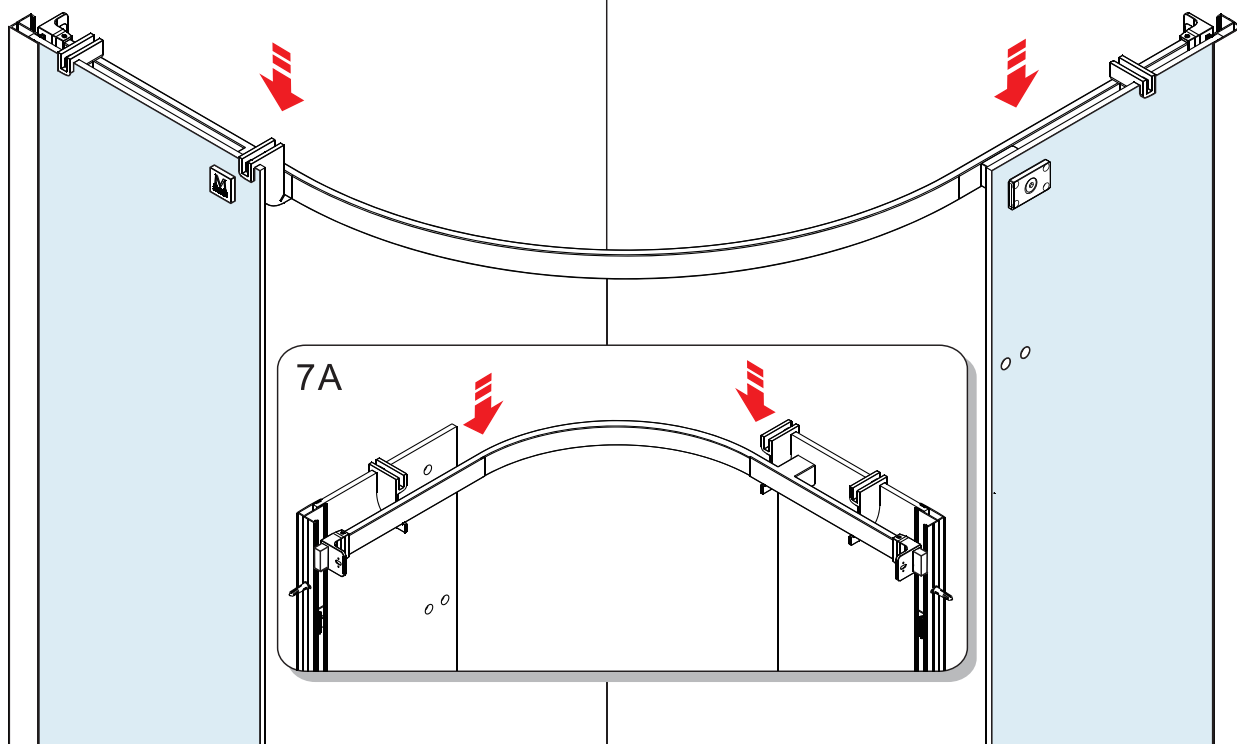

8

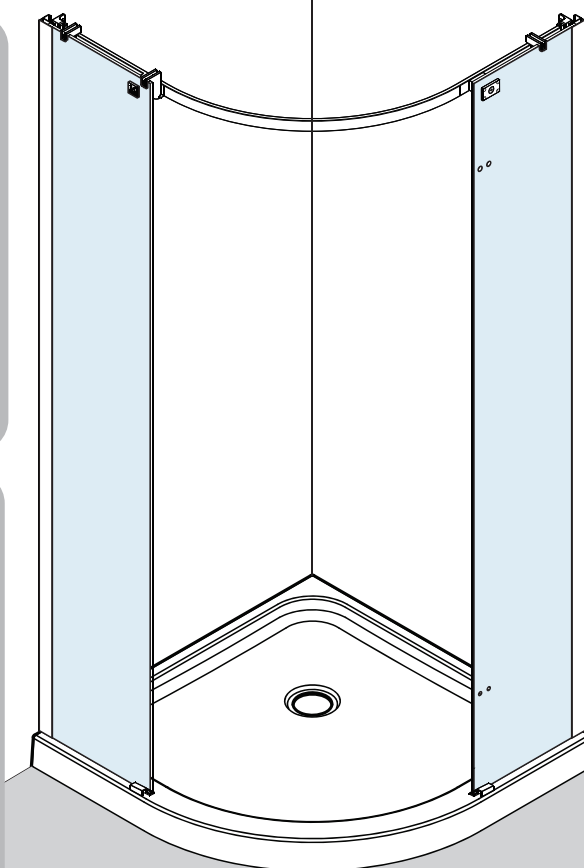
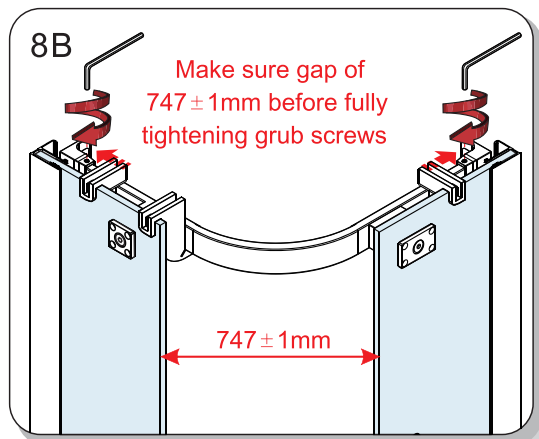
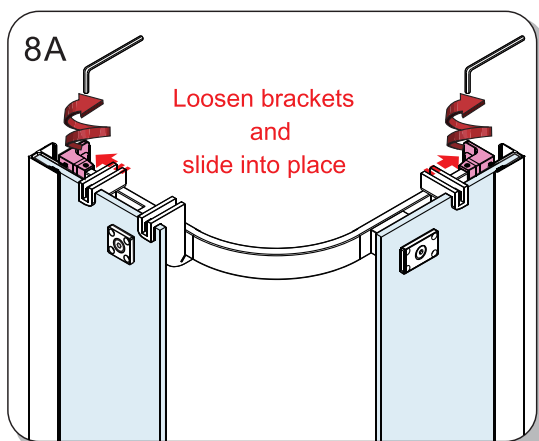

9

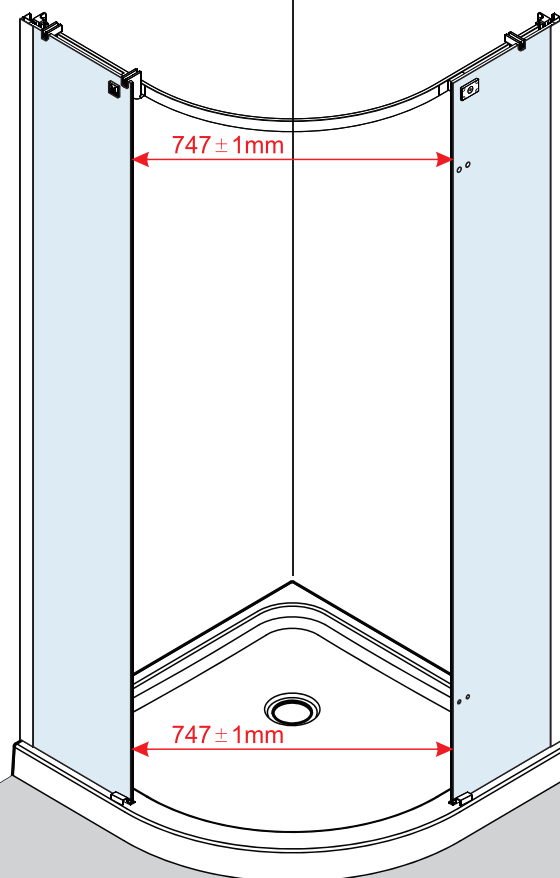
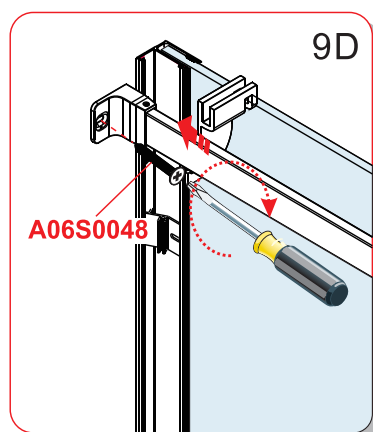
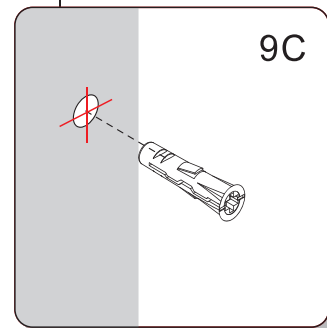
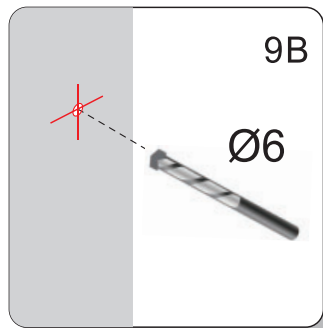
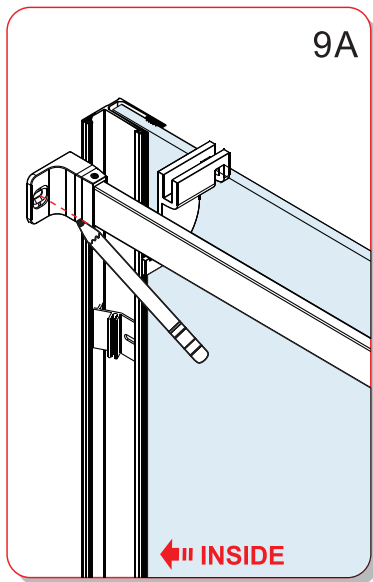

10

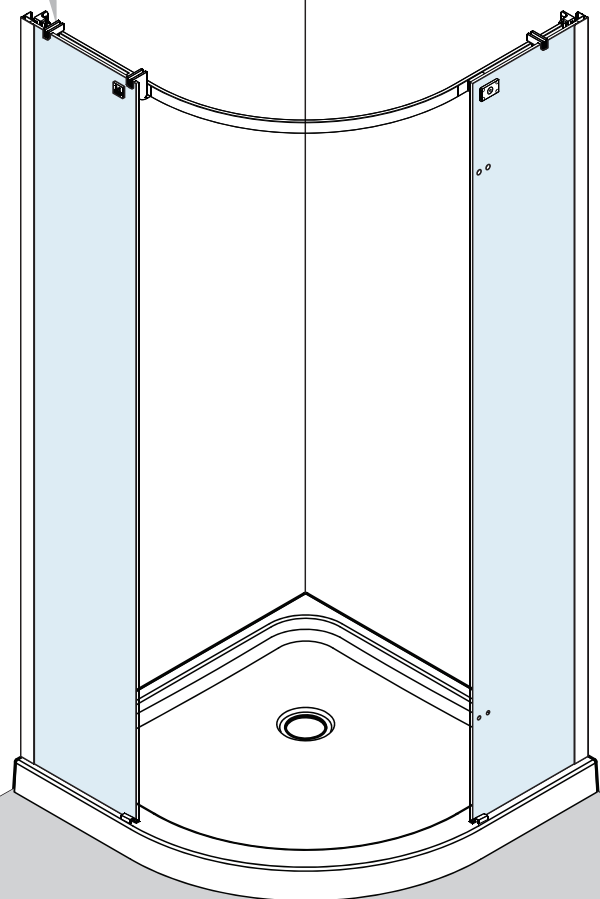
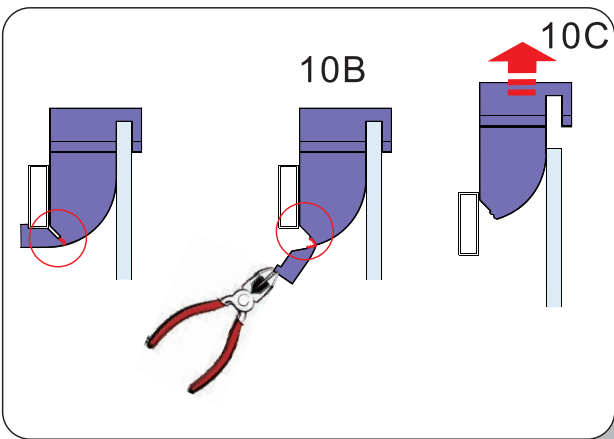
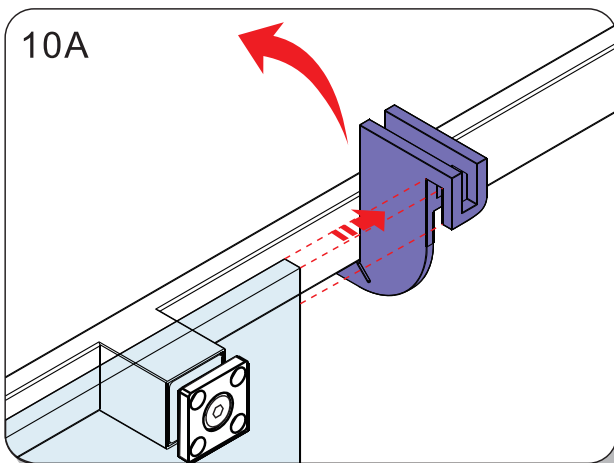

11

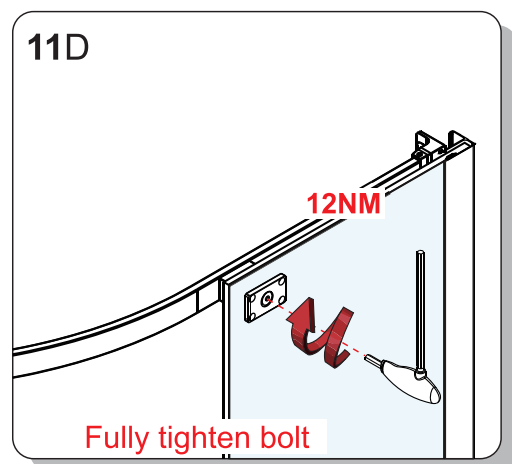
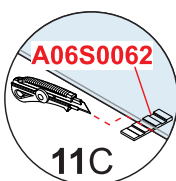
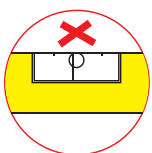
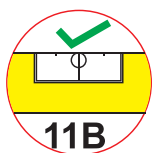
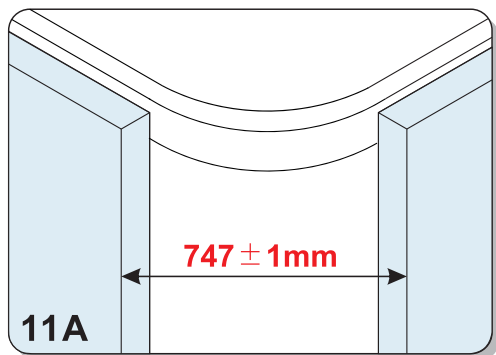

If required use spacers to ensure edges of both fixed panels are plumb.

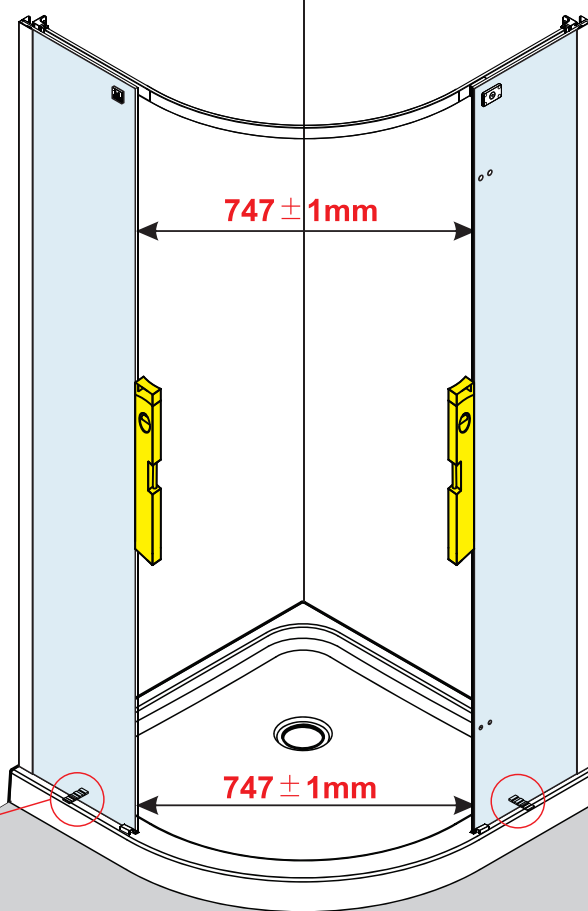

12A

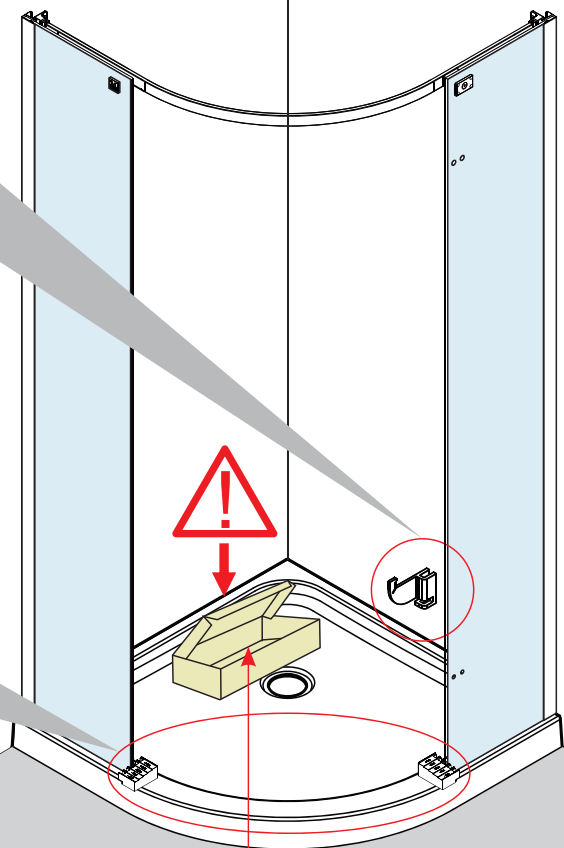
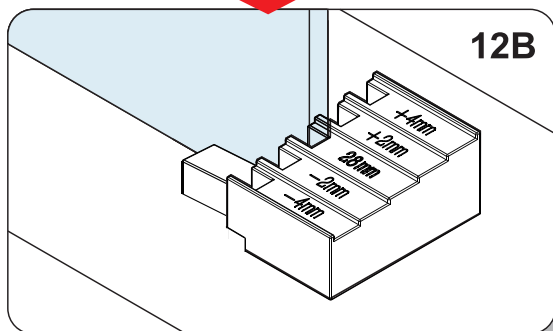

14.

13

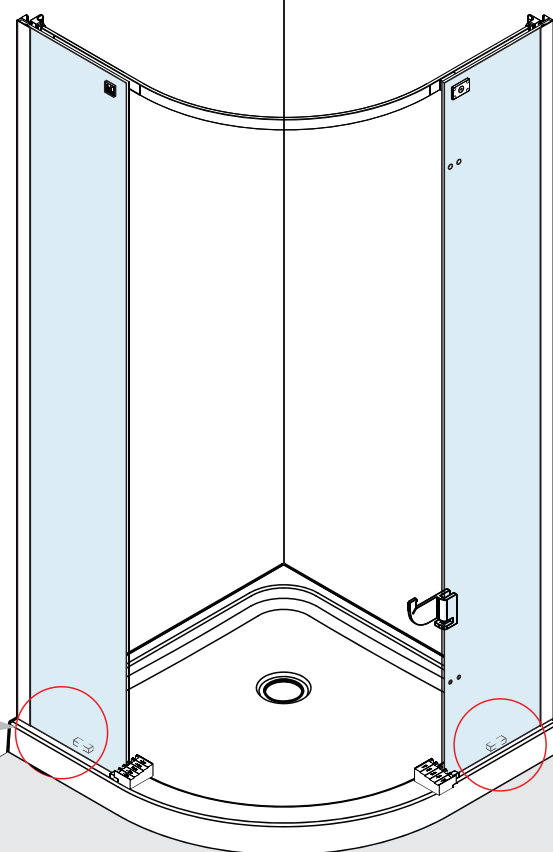
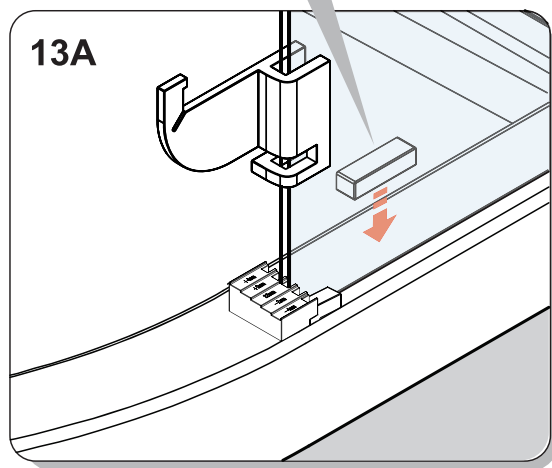
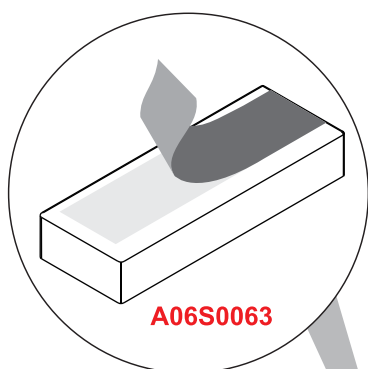

14

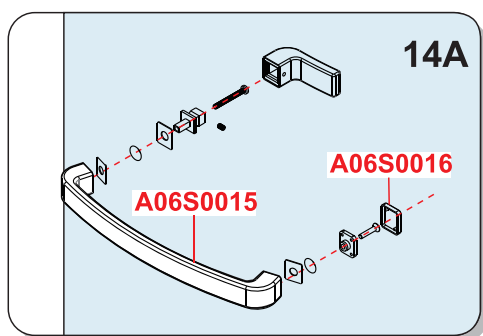
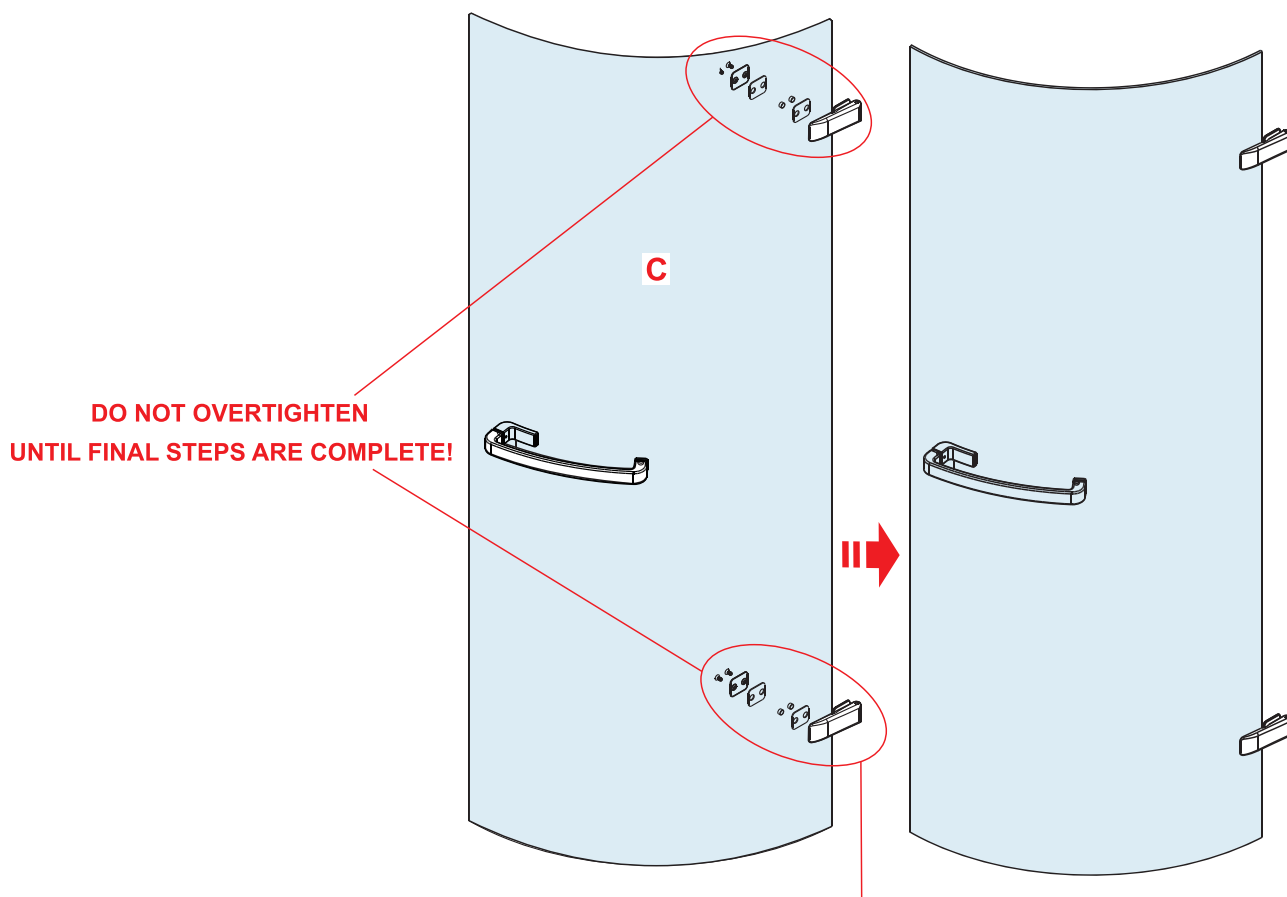

The pin is only visible on one side
and should be facing up on the top
hinge and down on the bottom hinge.

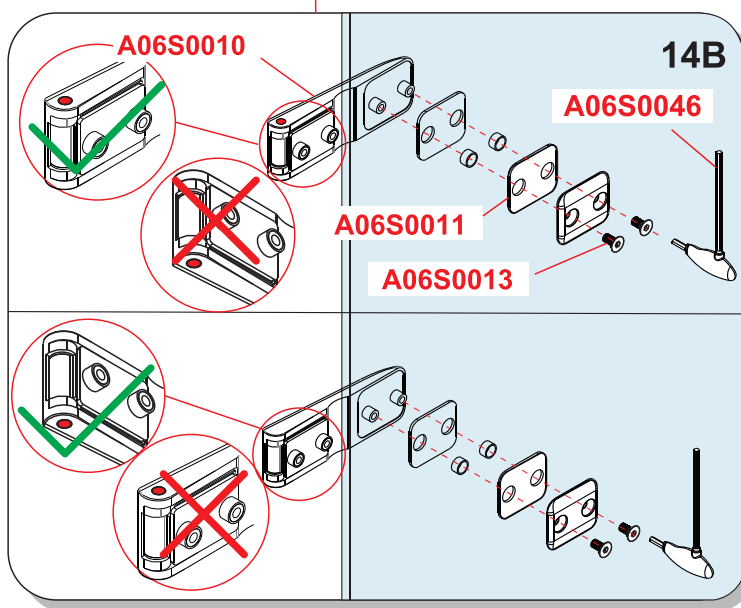

15

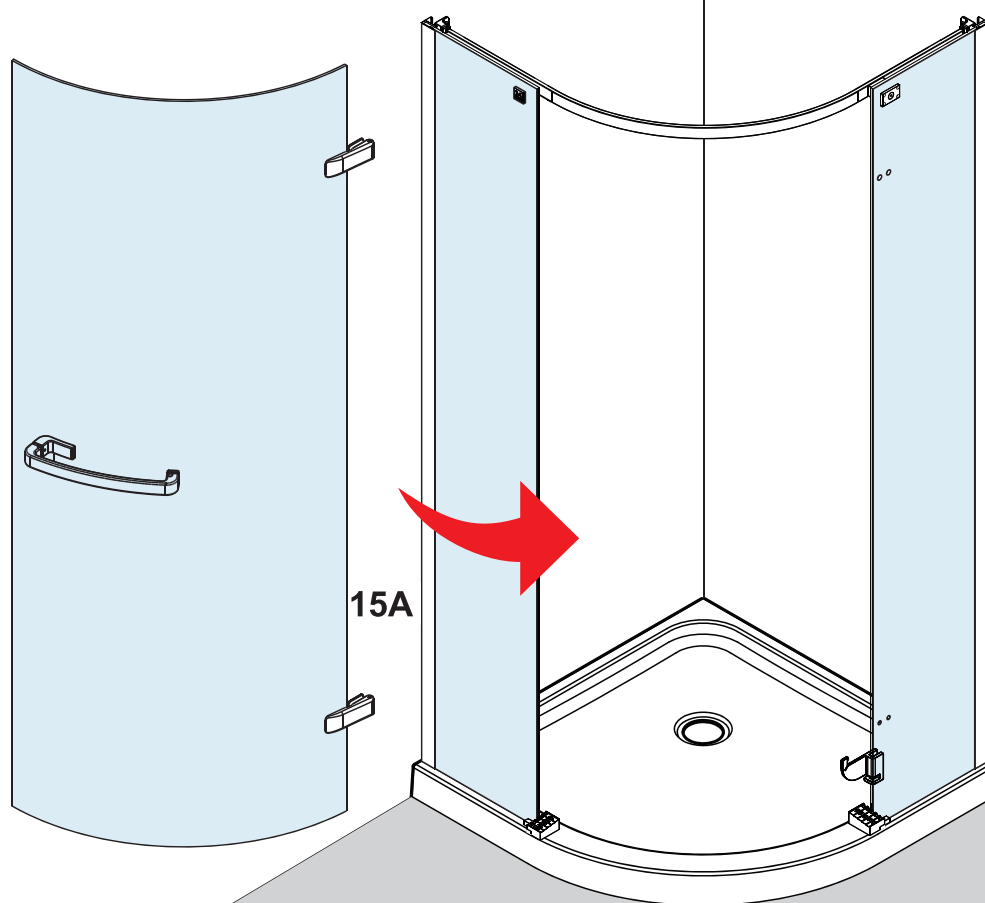

Stand inside the enclosure and lift the door onto the spacer blocks and secure with fitting aids provided.

16

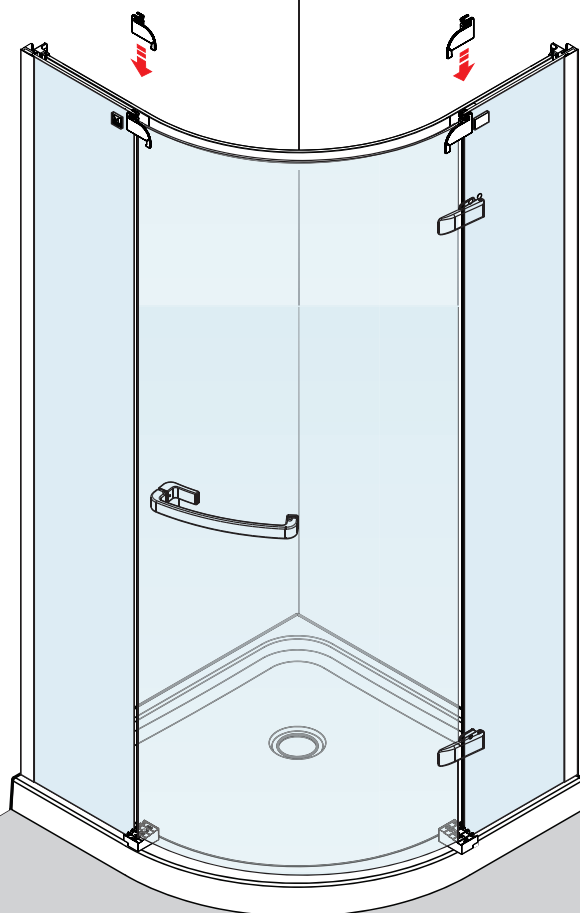
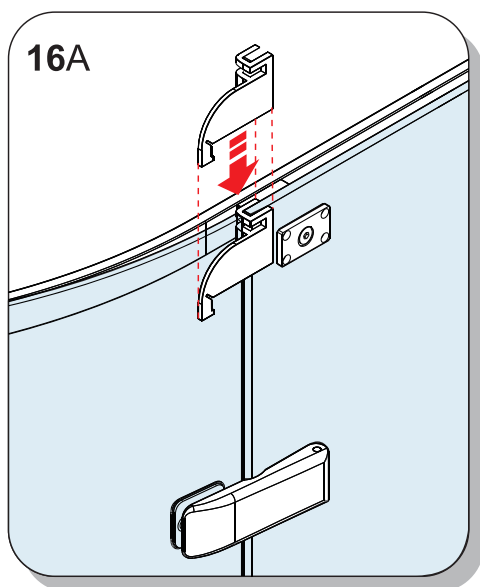

17

17A

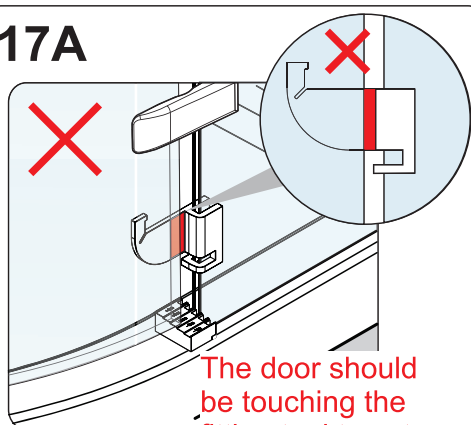

The door should be touching the fitting tool to set the correct gap.

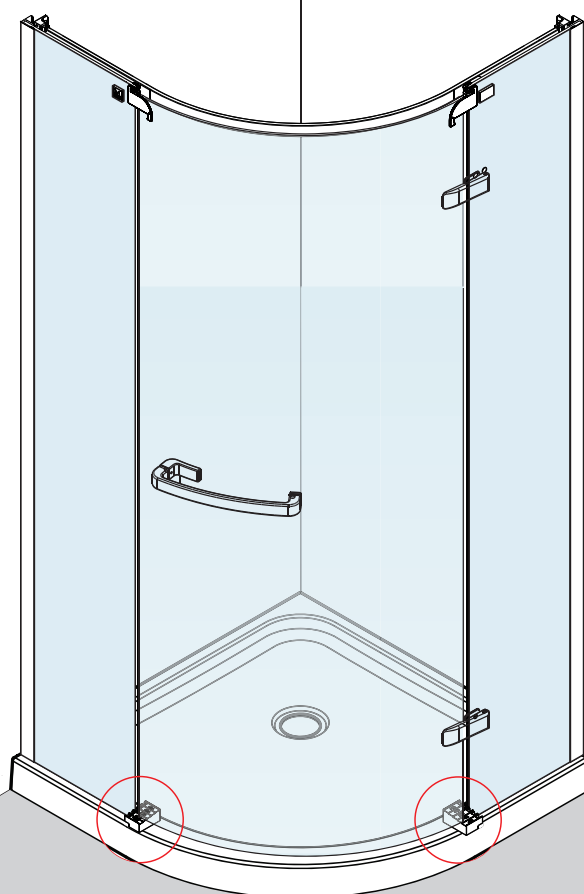
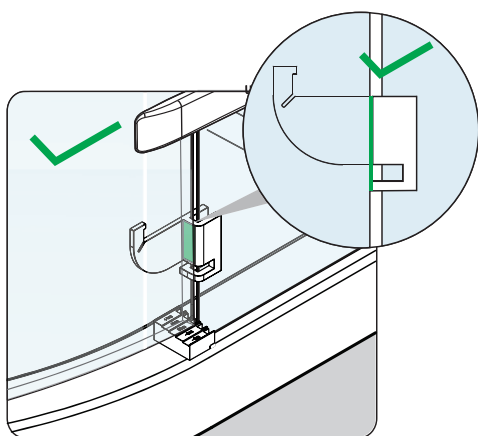

18

18A

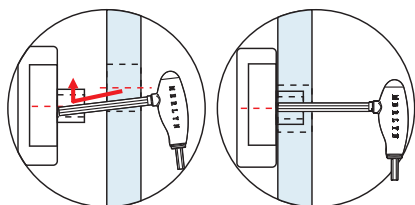
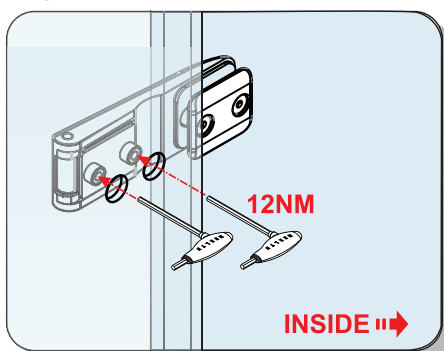

DO NOT OVERTIGHTEN!

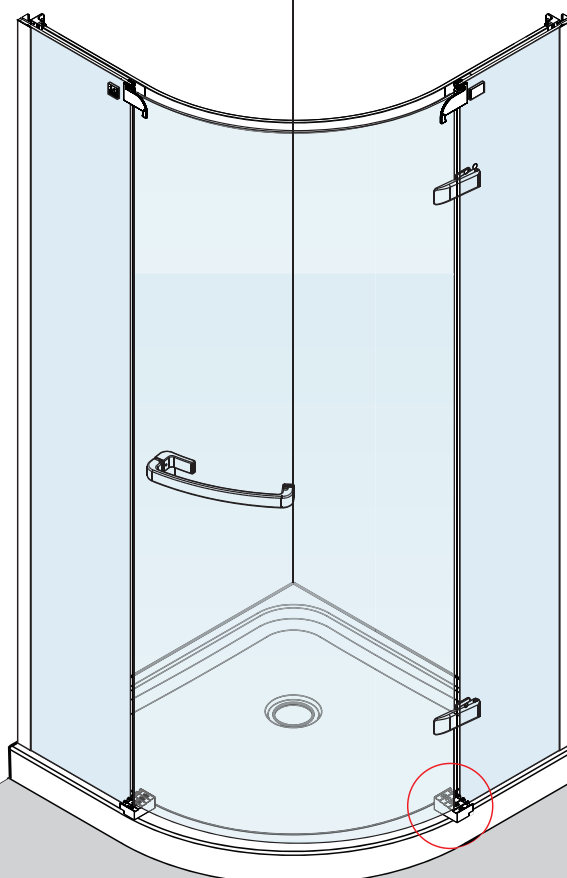
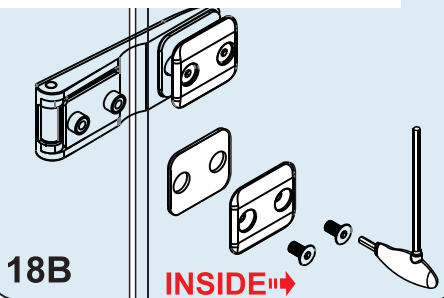

19

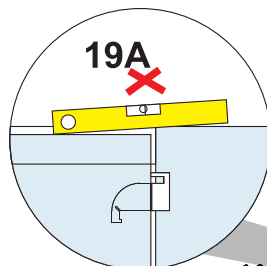
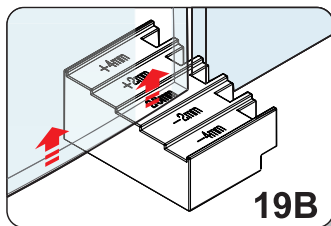

Adjust the height of the door using spacer blocks to ensure door is level with the hinged fixed panel.

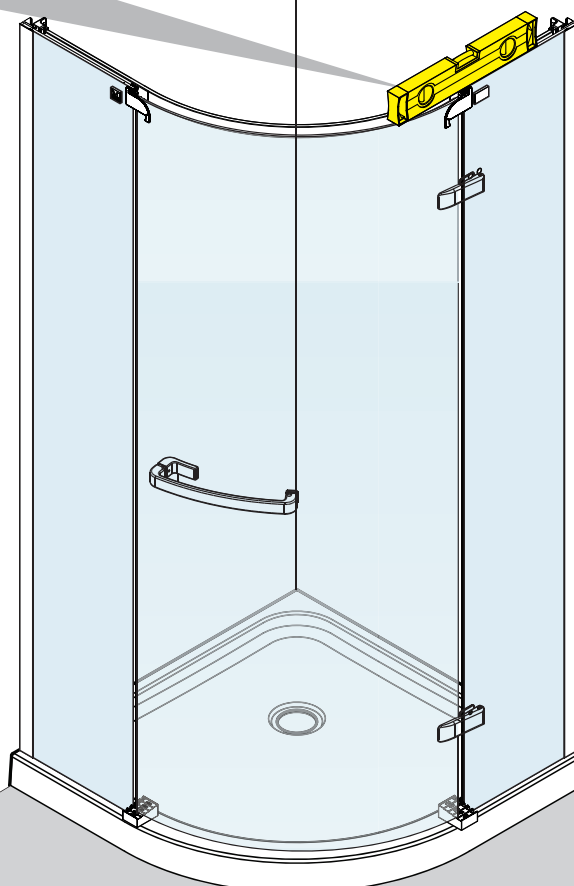
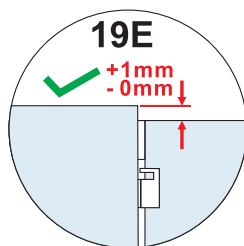
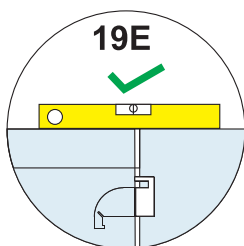
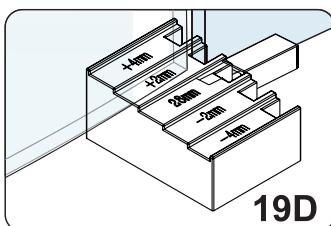
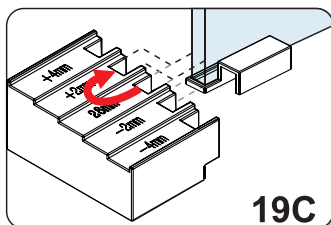

20

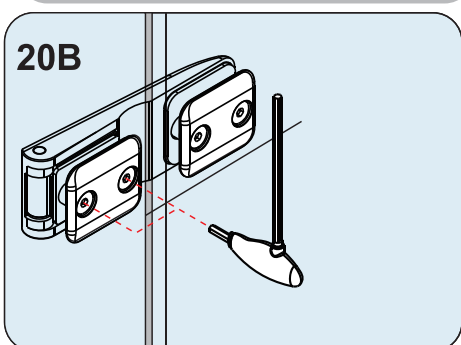
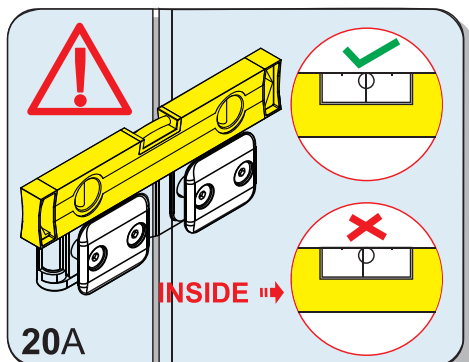

20B: Using only the Hex key provided fully tighten all hinge bolts to their absolute limit. Anything less than this could cause the door to drop over time.

Note: Screws need to be tightened to the Max and its normal to hear a 'clicking' noise.

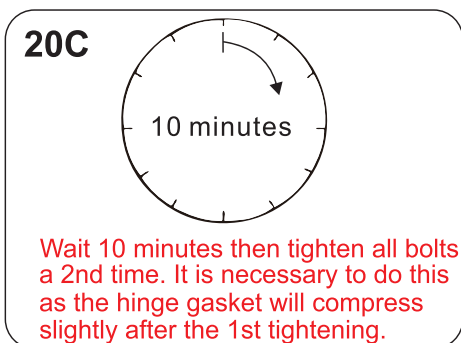

Wait 10 minutes then tighten all bolts a 2nd time. It is necessary to do this as the hinge gasket will compress slightly after the 1st tightening.

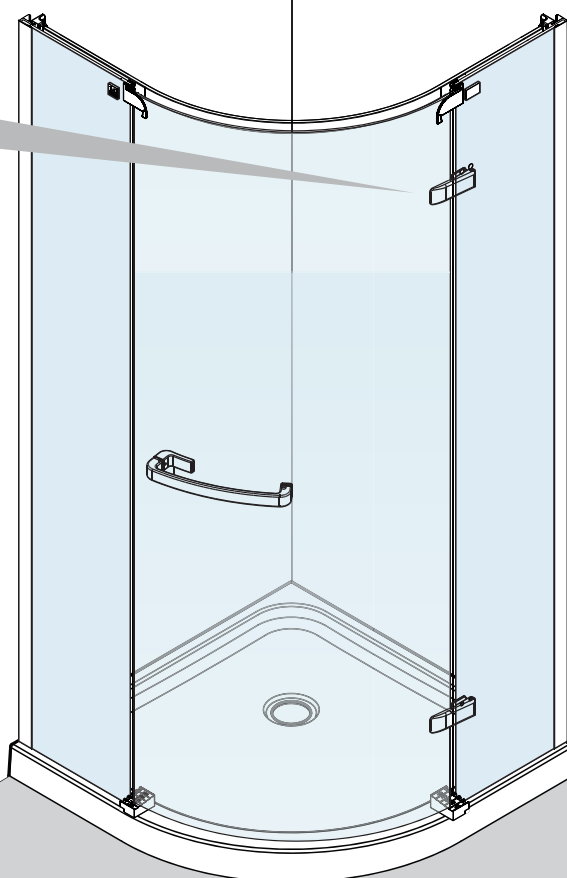
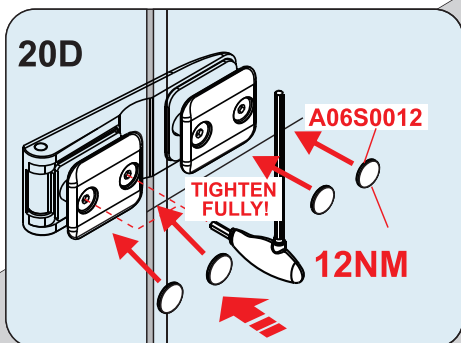

21

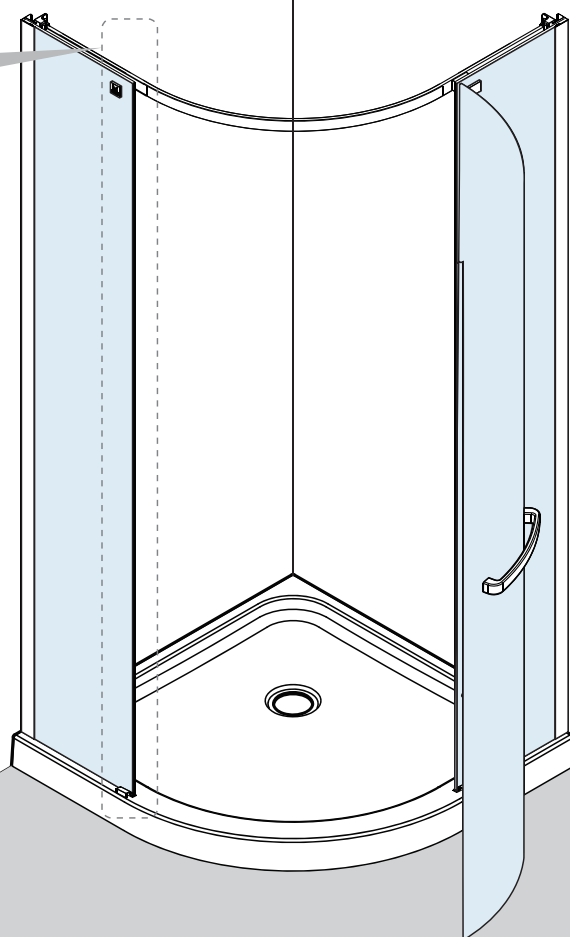
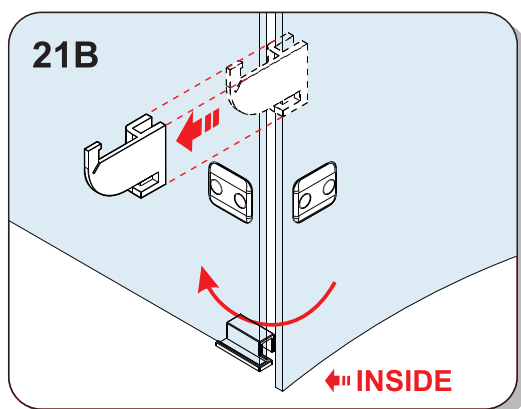
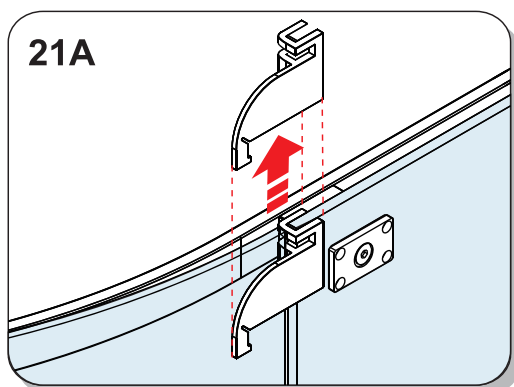

22

$X \neq 19 \pm 2\text{mm}$

22A1

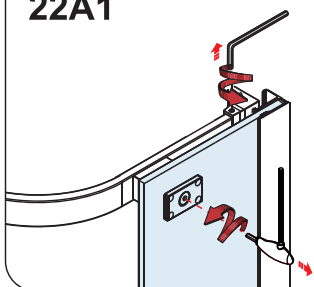

If: $x \neq 19 \pm 2\text{mm}$
adjust with
the bar on
hinge side.

22A2

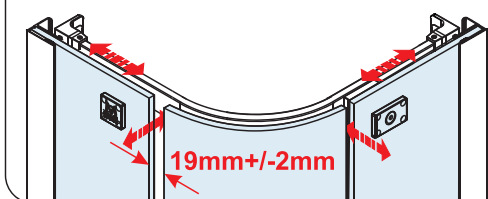

22A3

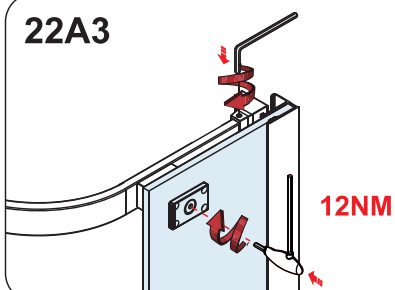

22A

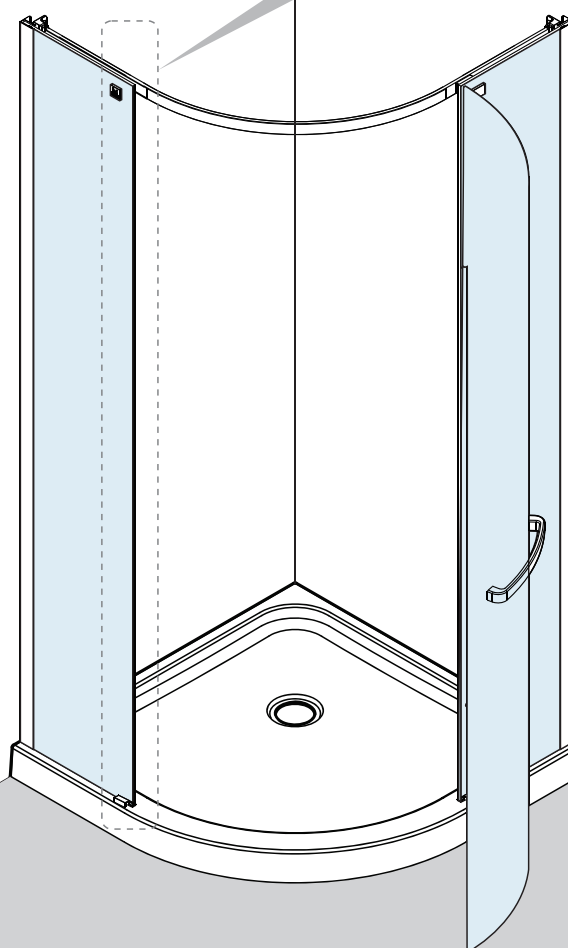
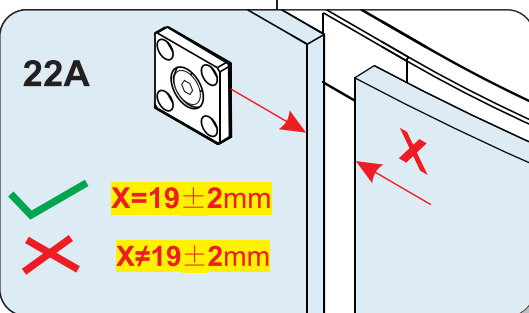

23

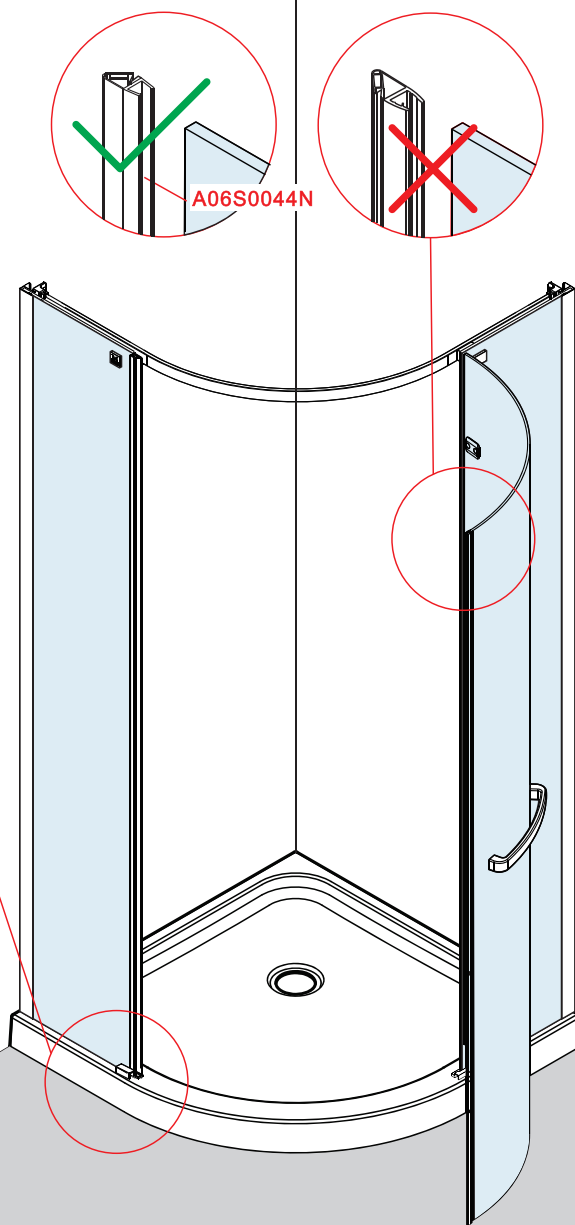
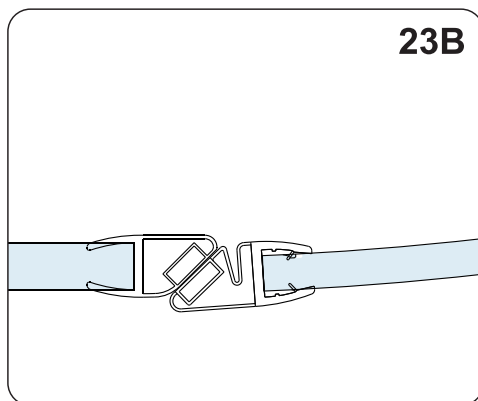
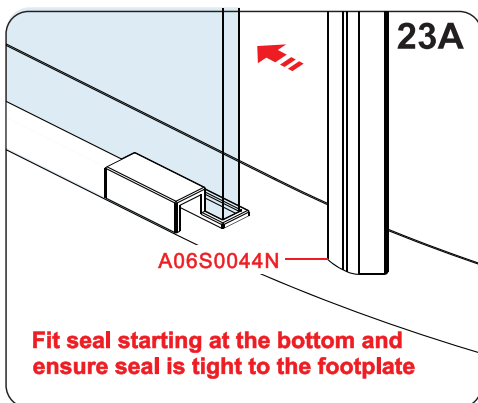

24

24B

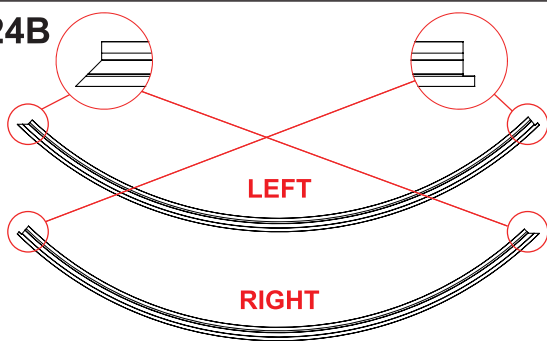

24A

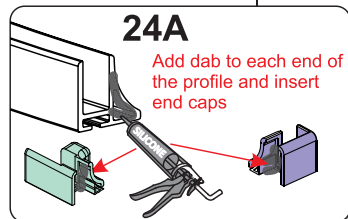

24C

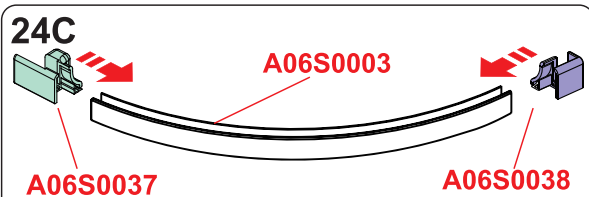

24D

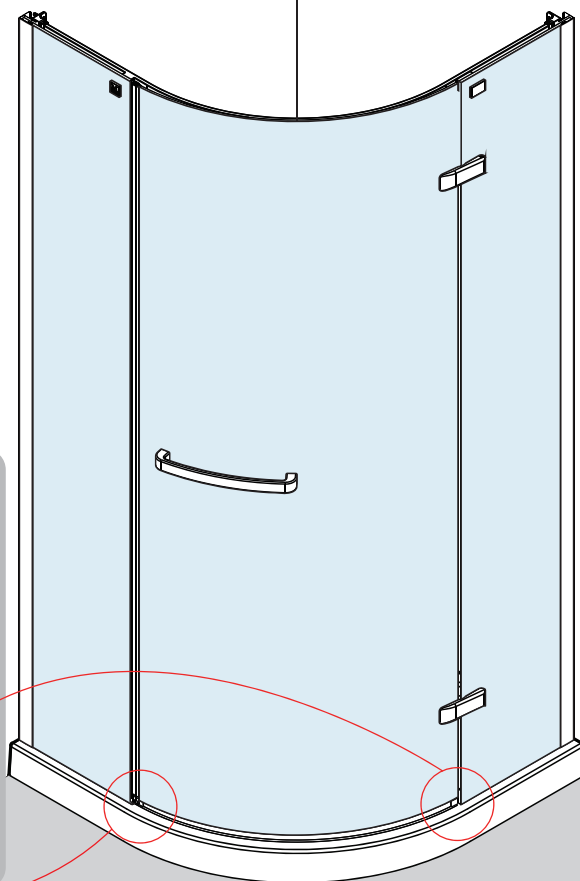
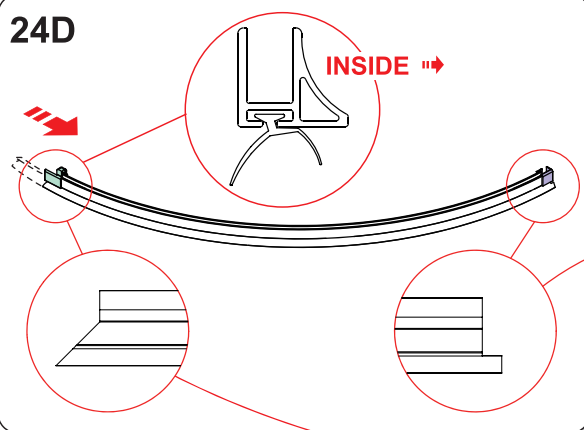

24D: Slide in the bottom seal fully. Make sure the seal slides all the way to the end of the footplate.

25

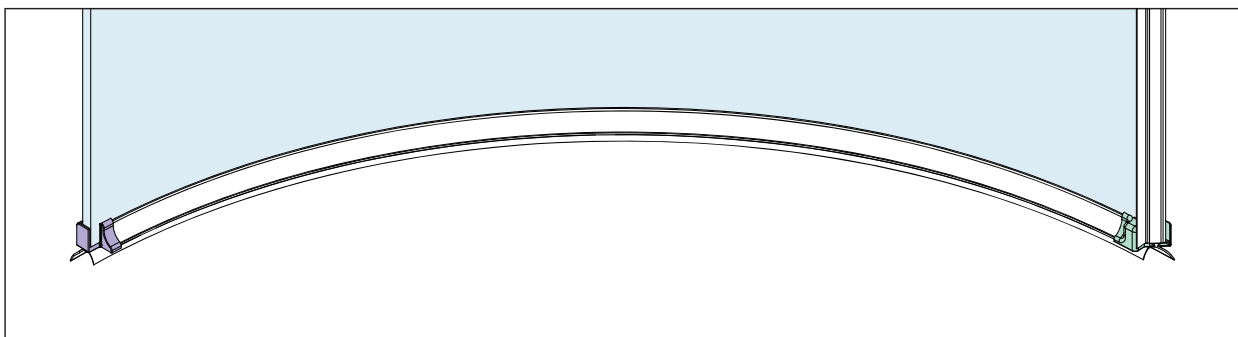
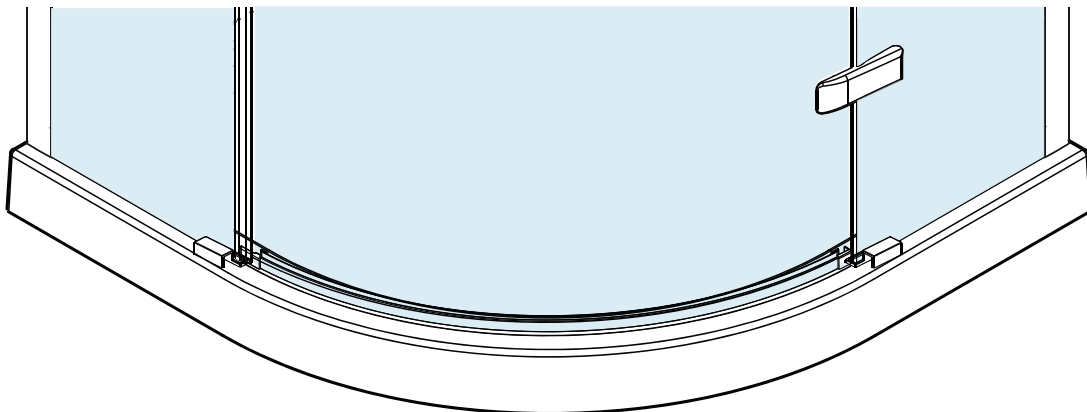

25A

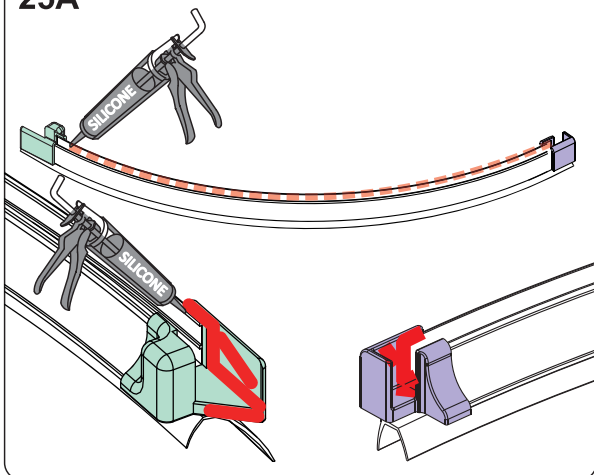

25B

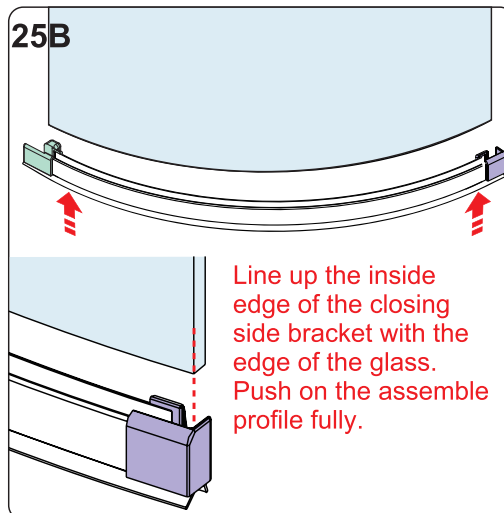

25C

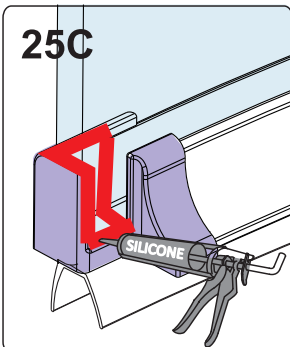

25D

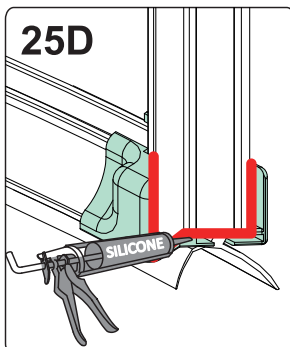

25E

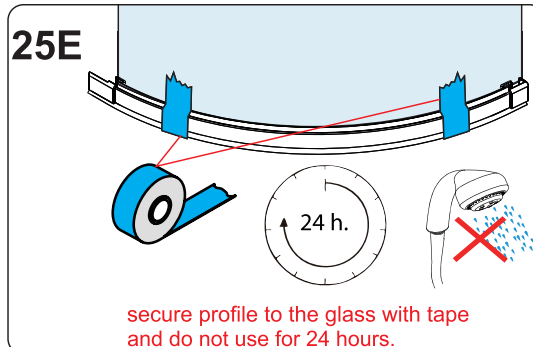

26

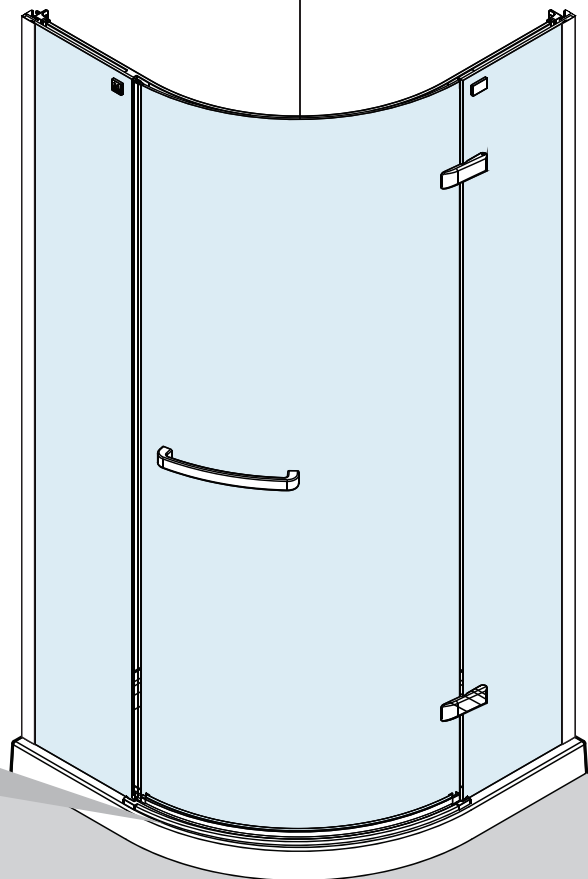
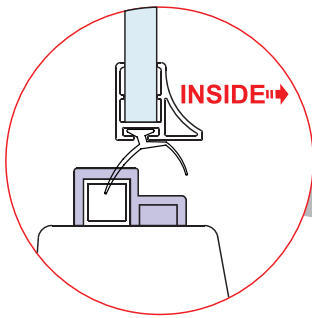
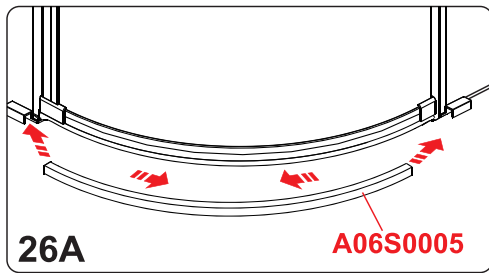

27

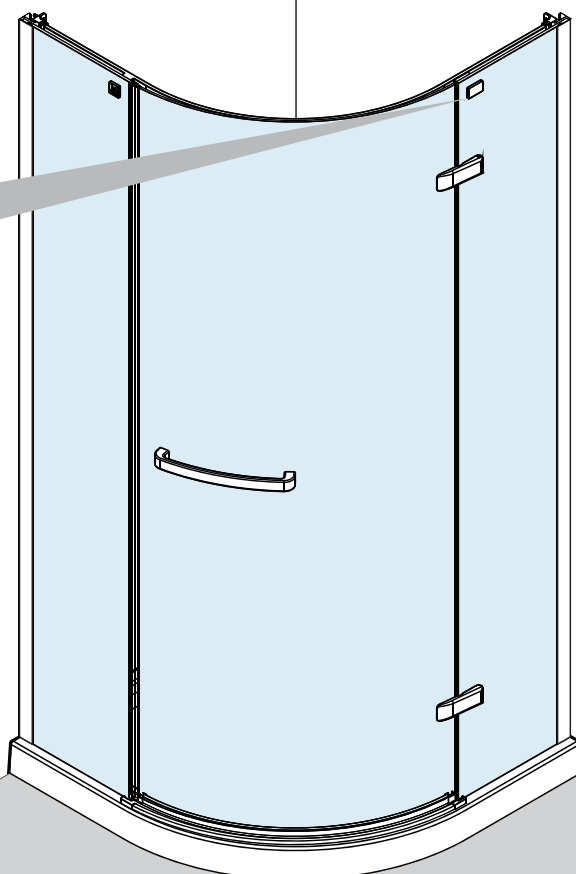
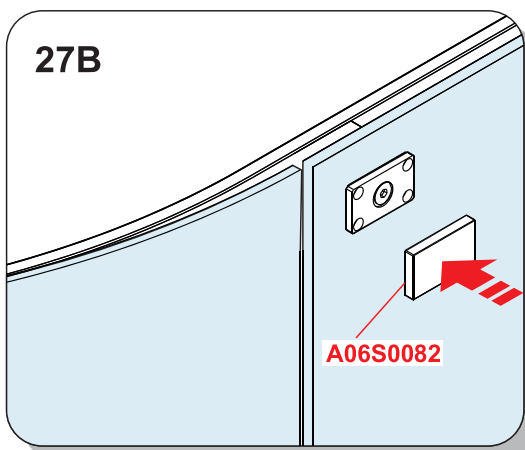
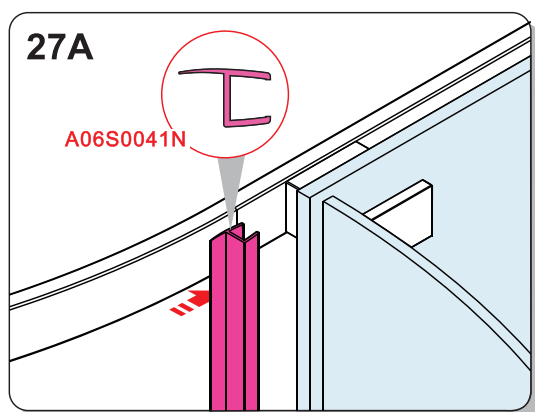

28

28A

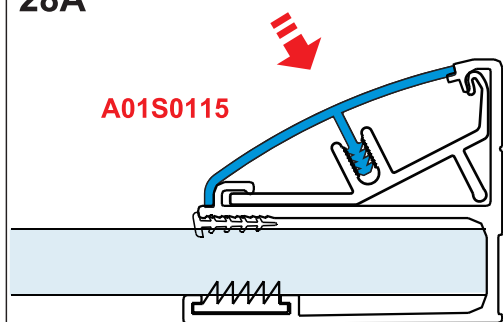

28B

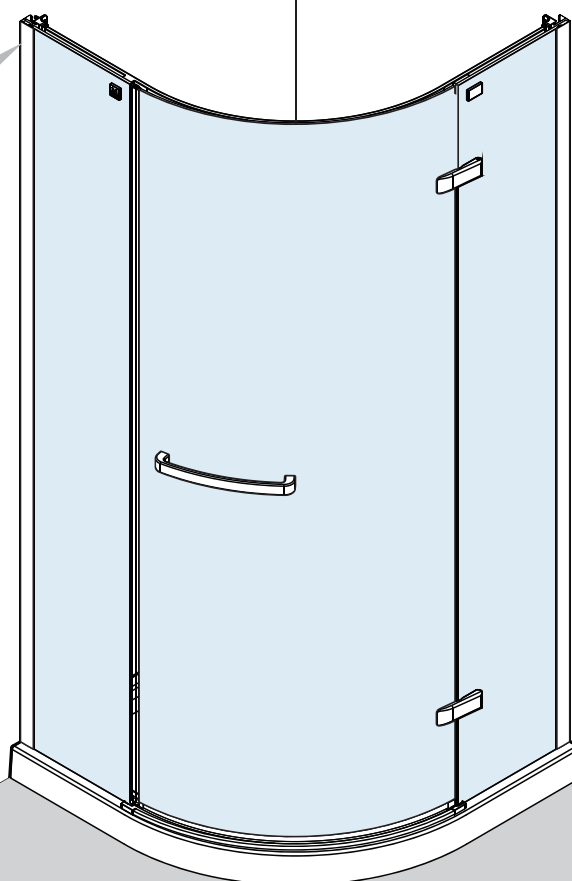
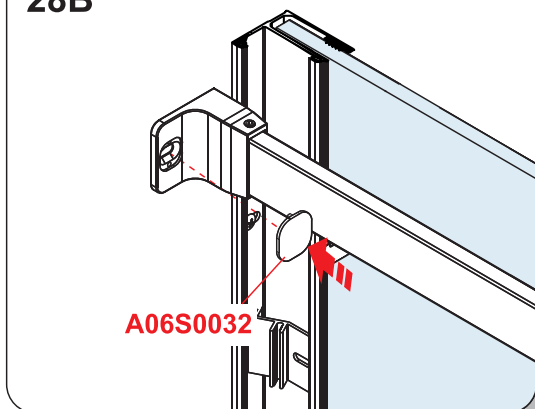

29

29A

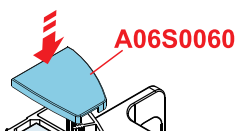

29B

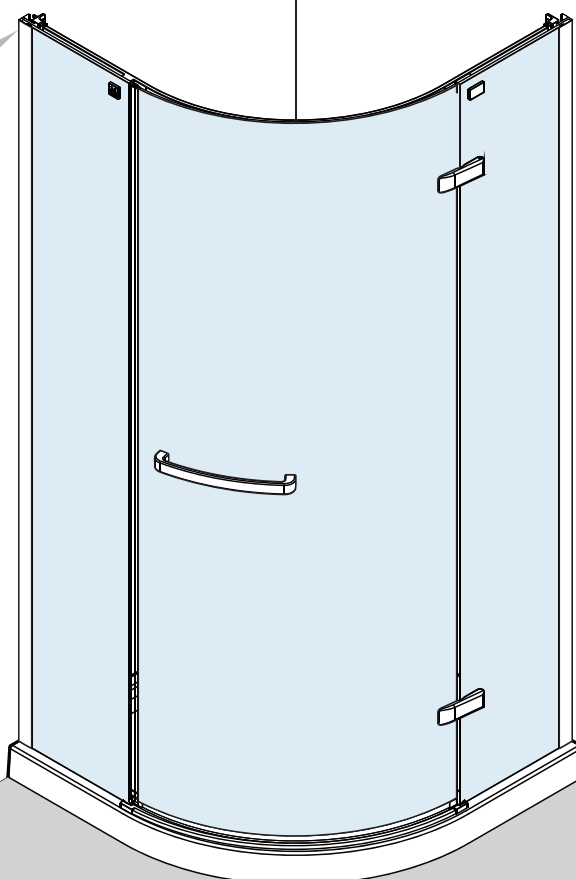
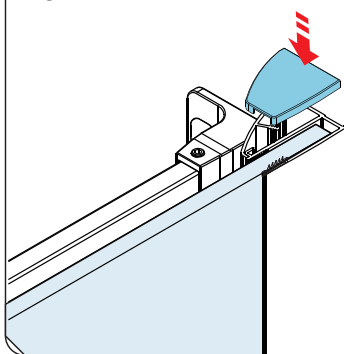

30

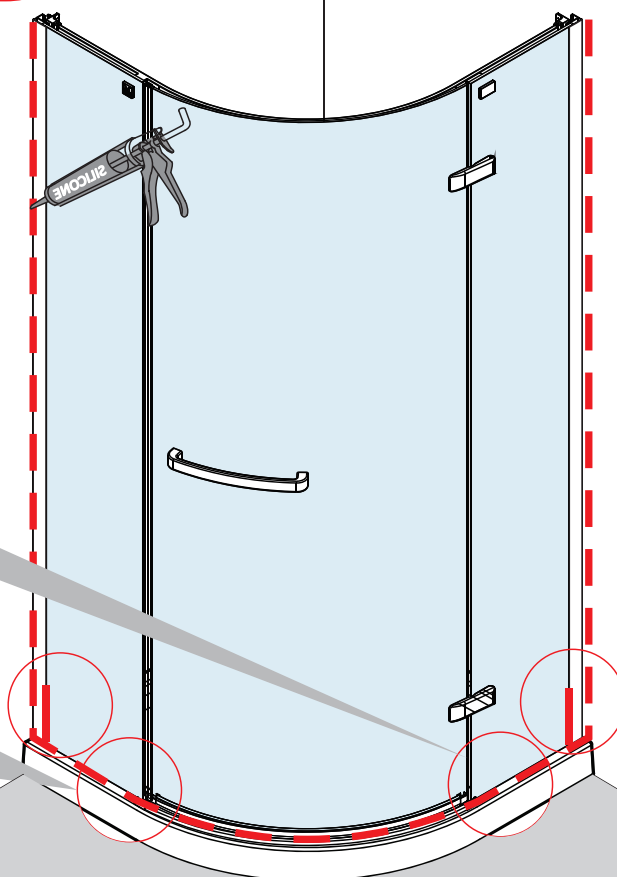
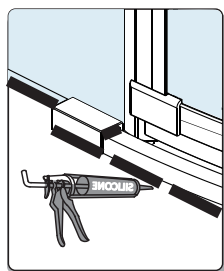
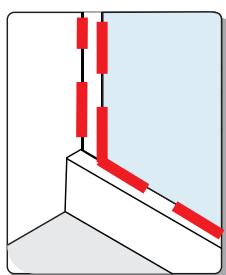
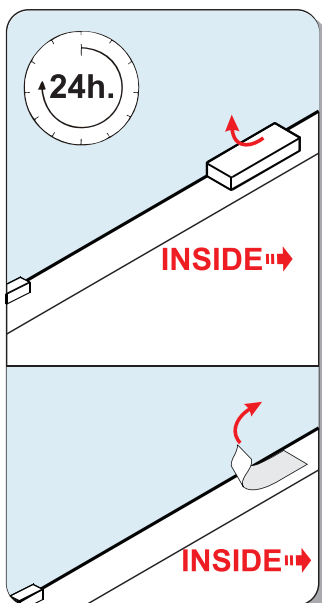
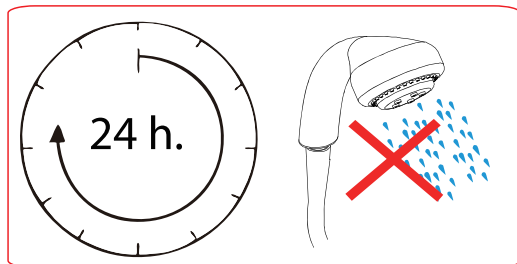

To download the Declaration of Performance (DOP) for this product please use the link below.

<https://merlynshowering.com/aftersales-support/dop-certs/>

For further information please contact IRL: 056 7791 555, UK: 08081011429