

Sales Code: NCS286

Description: Ivo Btw Pan

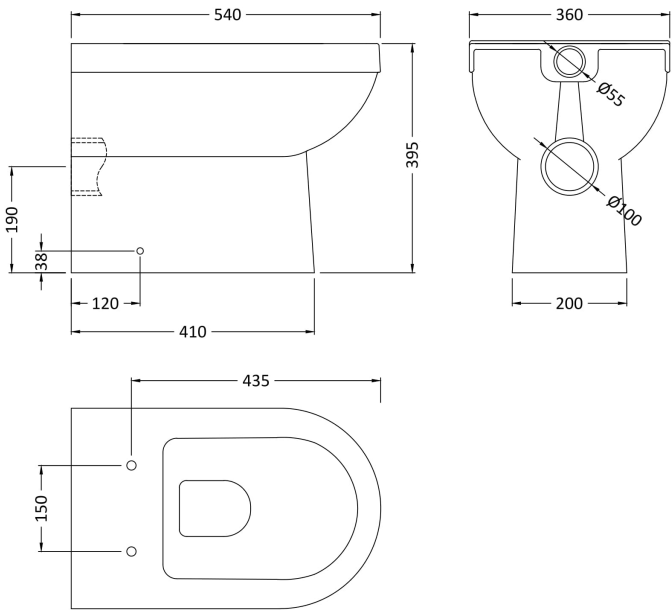

Product Dimensions

|                   |     |
|-------------------|-----|
| Height (mm):      | 395 |
| Width (mm):       | 360 |
| Depth (mm):       | 540 |
| Nett Weight (kg): | 24  |

Packaging Dimensions

|                    |      |
|--------------------|------|
| Height (mm):       | 450  |
| Width (mm):        | 375  |
| Depth (mm):        | 560  |
| Gross Weight (kg): | 24.5 |

Packaging Data

|               |                     |
|---------------|---------------------|
| Box Colour:   | Brown Cardboard Box |
| Box Qty:      | 1                   |
| Label Size:   | 100 x 50            |
| Label Colour: | White Label         |
| Label Qty:    | 2                   |

Outer Box Dimensions (If Applicable)

|                    |               |
|--------------------|---------------|
| Height (mm):       |               |
| Width (mm):        |               |
| Depth (mm):        |               |
| Gross Weight (kg): |               |
| Barcode:           | 5055275872833 |

Product Details

|                           |                |
|---------------------------|----------------|
| Country of Origin:        | China          |
| Fitting Instruction:      | No             |
| Certification: CE & UKCA: | No             |
| WRAS:                     | N/A            |
| WRAS No:                  | N/A            |
| Product Material:         | Vitreous China |
| Fixing Supplied:          | No             |

|              |                                |                            |
|--------------|--------------------------------|----------------------------|
| Pans/Bidets: | Trap Style: P Trap             | Includes Seat: No          |
| Seats:       | Seat Type: Not Applicable      | Material: Not Applicable   |
|              | Function: Not Applicable       | Hinge Type: Not Applicable |
|              | Hinge Material: Not Applicable |                            |

|           |                                |                          |
|-----------|--------------------------------|--------------------------|
| Cisterns: | Operating Type: Not Applicable | Fittings: Not Applicable |
|           | Lever Type: Not Applicable     |                          |

|         |                              |                                 |
|---------|------------------------------|---------------------------------|
| Basins: | Tap Hole: Not Applicable     | Chain Stay Hole: Not Applicable |
|         | Template: Not Applicable     | Waste Type Req: Not Applicable  |
|         | Overflow Inc: Not Applicable | Overflow Cover: Not Applicable  |
|         | Inner Bowl Depth (mm):       | N/A                             |