

Sales Code: WIN15TR03

Barcode: 5056678478899

Brand: nuie

Description: nuie Windon Brushed Brass Triple Thermostatic Shower Valve With Diverter

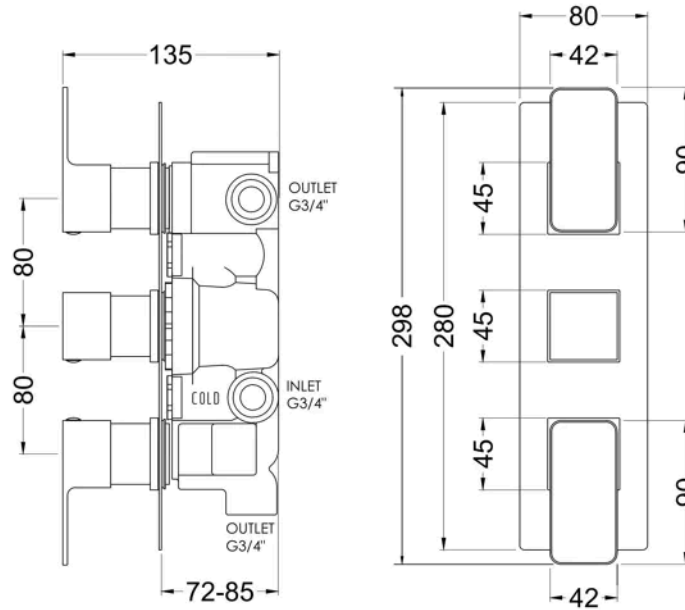
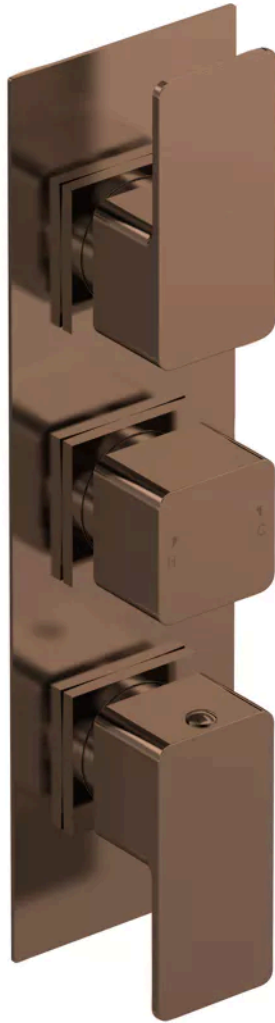

Product Dimensions

| | |
|-----------------|-------------------------------|
| Product | 300 x 80 x 135mm (H x W x D) |
| Packaged | 110 x 250 x 320mm (H x W x D) |
| Outer Box | 500 x 510 x 355mm (H x W x D) |
| Nett Weight | 3.5 kg |
| Packaged Weight | 3.5 kg |

Packaging Details

| | |
|-----------------|----------|
| Label Size (mm) | 50 x 100 |
| Label Colour | White |
| Label Qty | 1.0000 |

Product Details

| | |
|----------------------------|------------------|
| Country of Origin | China |
| Product Material | Abs, Brass |
| Control Type | Manual |
| WRAS Approved | Yes |
| Valve/Cartridge Type | 1/4 Turn |
| Colour/Finish | Brushed Bronze |
| Mount Type | Surface/Wall |
| Style | Contemporary |
| Handle Type | Lever/Square |
| Easy Clean | No |
| TMV2 Approved | Yes |
| TMV3 Approved | No |
| Pipe Size | 22 mm (3/4" BSP) |
| Handset Included | No |
| Head Included | No |
| Hose Included | No |
| Min Operating Pressure | 0.5 Bar |
| Minimum Operation Pressure | 1 Bar |
| No. Of Body Jets | 0.0000 |
| No. Outlets | 3.0000 |
| Outlet Elbow Supplied | No |
| Tmv2 Approval Number | 2603035 |
| Valve / Cartridge Type | 1/4 Turn |
| Wras Approval No | 250602040 |