

Sales Code: MER004

Description: 500X360 Wh 1-Door Vanity & Basin

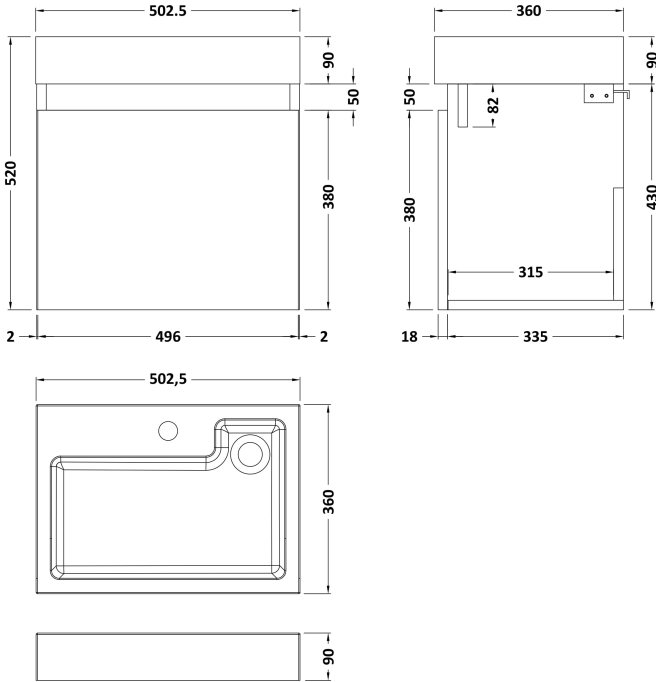

| Packaging Details | |
|-------------------|---------------|
| Barcode: | 5056211801177 |

Sales Code: MOZ582

Description: 500X360 Wh 1-Door Unit

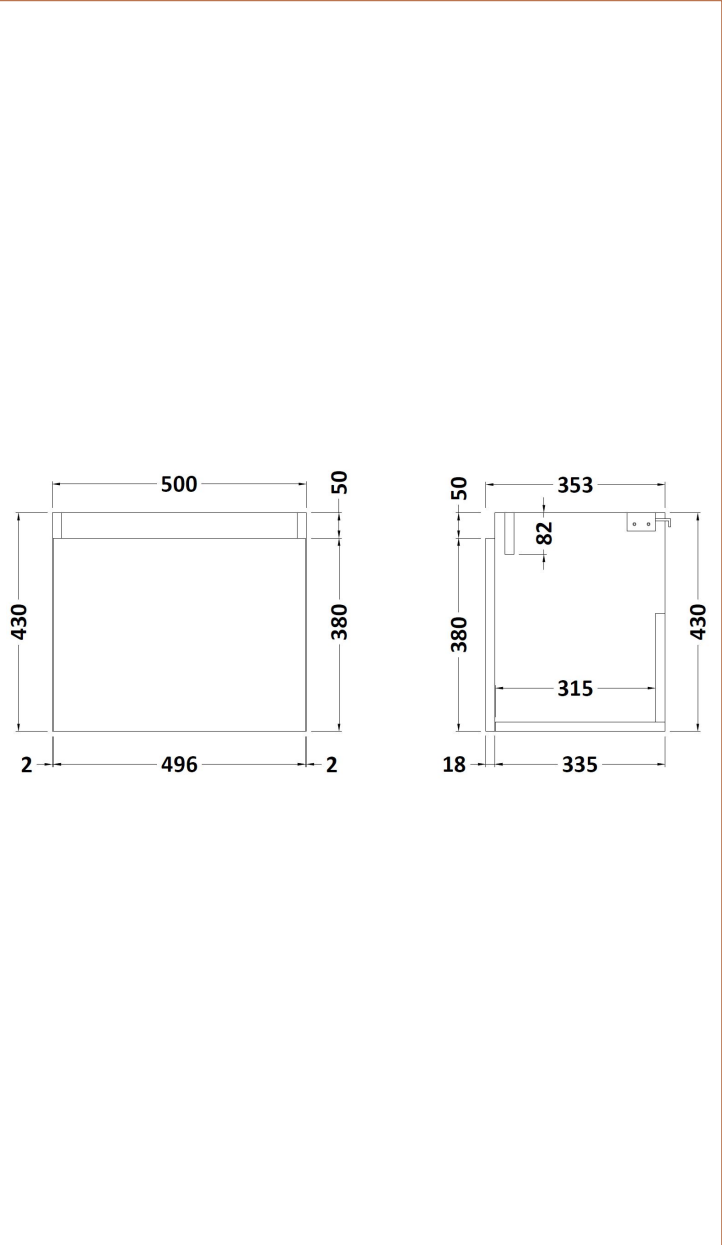

| Product Dimensions | |
|--------------------------------------|----------------------|
| Height (mm): | 430 |
| Width (mm): | 500 |
| Depth (mm): | 353 |
| Nett Weight (kg): | 10 |
| Packaging Dimensions | |
| Height (mm): | 375 |
| Width (mm): | 520 |
| Depth (mm): | 450 |
| Gross Weight (kg): | 11 |
| Packaging Data | |
| Box Colour: | Brown Cardboard Box |
| Box Qty: | 1 |
| Label Size: | 50 x 100 |
| Label Colour: | White Label |
| Label Qty: | 2 |
| Outer Box Dimensions (If Applicable) | |
| Height (mm): | |
| Width (mm): | |
| Depth (mm): | |
| Gross Weight (kg): | |
| Barcode: | 5055275883655 |
| Product Details | |
| Country of Origin: | United Kingdom |
| Fitting Instruction: | No |
| CE & UKCA: | N/A |
| FSC Certified Materials: | Yes |
| Colour: | Anthracite Woodgrain |
| Construction Method: | Cam & Wood Dowel |
| Construction Type: | Rigid |
| Cabinet Finish: | MFC Textured Matt |
| Fascia Finish: | MFC Textured Matt |
| Cabinet Thickness (mm): | 18 |
| Fascia Thickness (mm): | 18 |
| Drawer Included: | No |
| Drawer Type: | Not Applicable |
| No of Shelves: | 0 |
| Hinge Type: | 95 Degree Soft Close |
| Hinge Included: | Yes |
| Adjustable Legs: | No, Not Required |
| Fixings Included: | Yes |
| Handle Style: | Not Applicable |
| Waste Shroud: | Not Applicable |
| Handle Included: | No, Not Required |
| Handle Type: | Not Applicable |

Sales Code: PMB022

Description: 2 In 1 Polymarble Basin 503 X 360 Rw

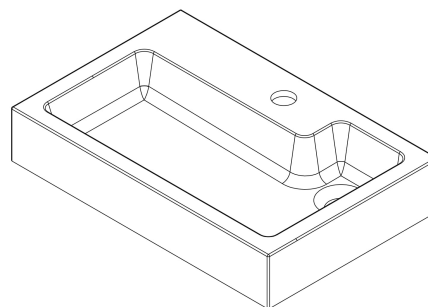
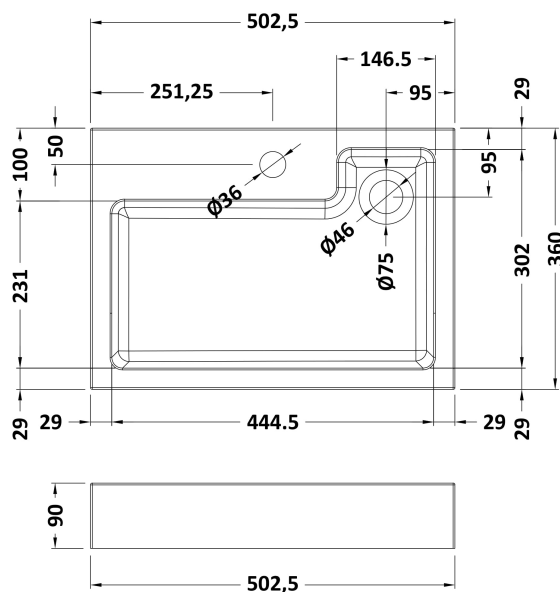

Product Dimensions

| | |
|-------------------|------|
| Height (mm): | 90 |
| Width (mm): | 503 |
| Depth (mm): | 360 |
| Nett Weight (kg): | 11.5 |

Packaging Dimensions

| | |
|--------------------|-----|
| Height (mm): | 110 |
| Width (mm): | 52 |
| Depth (mm): | 38 |
| Gross Weight (kg): | 12 |

Packaging Data

| | |
|---------------|-------------------------------|
| Box Colour: | Brown Cardboard Box - Printed |
| Box Qty: | 1 |
| Label Size: | 100 x 50 |
| Label Colour: | White Label |
| Label Qty: | 2 |

Outer Box Dimensions (If Applicable)

| | |
|--------------------|---------------|
| Height (mm): | |
| Width (mm): | |
| Depth (mm): | |
| Gross Weight (kg): | |
| Barcode: | 5055275819524 |

Product Details

| | | |
|------------------------------|------------|--------------|
| Country of Origin: | China | |
| Fitting Instruction: | No | |
| Certification: CE & UKCA: No | WRAS: N/A | WRAS No: N/A |
| Product Material: | Polymarble | |
| Fixing Supplied: | No | |

Pans/Bidets: Trap Style: Not Applicable Includes Seat: Not Applicable

| | | |
|---------------|--------------------------------|----------------------------|
| Seats: | Seat Type: Not Applicable | Material: Not Applicable |
| | Function: Not Applicable | Hinge Type: Not Applicable |
| | Hinge Material: Not Applicable | |

| | | |
|------------------|--------------------------------|--------------------------|
| Cisterns: | Operating Type: Not Applicable | Fittings: Not Applicable |
| | Lever Type: Not Applicable | |

| | | |
|----------------|-----------------------------|--------------------------------|
| Basins: | Tap Hole: One Taphole | Chain Stay Hole: No |
| | Template: Not Required | Waste Type Req: Unslotted |
| | Overflow Inc: No | Overflow Cover: Not Applicable |
| | Inner Bowl Depth (mm): 70mm | |