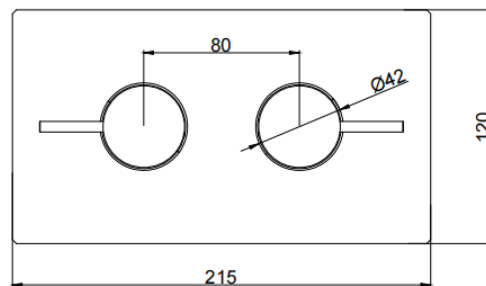
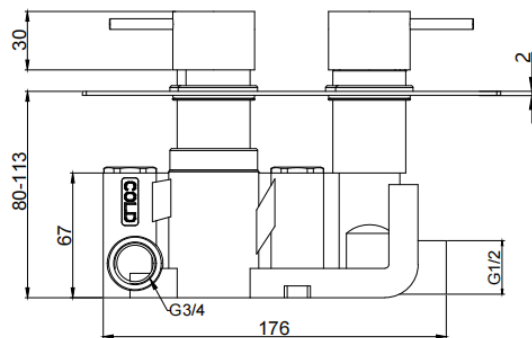

**SHO1410T - Ottone Concealed Therm. Shower Valve Brushed Brass**

**BAR CODE: 5055681439231**
**COLOUR: BRUSHED BRASS**
**WEIGHT:**
**NET 2.37 kg**
**GROSS 2.73 kg**
**STANDARDS: BS EN 1111**
**NOTES:**
**SUITABLE FOR PRESSURES BETWEEN 0.2 - 5 BAR**
**HOT & COLD PRESSURES MUST BE BALANCED**
**SUITABLE FOR COMBI- BOILERS, UNVENTED MAINS**
**PRESSURE SYSTEMS AND GRAVITY FED SYSTEMS**
**SUITABLE FOR SHOWER PUMPS**
**Flow Rate:**

0.2 bar	0.5 bar	1 bar	2 bar	3 bar	5 bar
5.7 L	9.6 L	13.6 L	19.8 L	24.5 L	28.5 L

**BOX SIZE 263x165x160**