

MIRROR ABOUT CENTRELINE

595 W

457 D

18

830 H

60

591 (TYP)

25 (TYP)

120

604

75 (TYP)

2X Ø4 THRU

50 (ALL ROUND)  
BOTH DOORS

294.5

294.5

☒

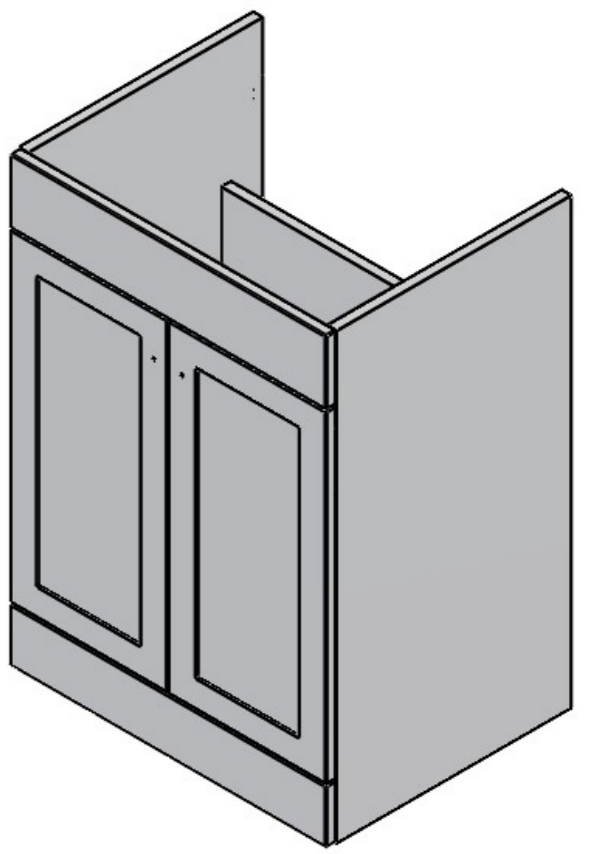

**Summerbridge**

This drawing belongs to HUMBER DOORS LTD and is not allowed to be copied, partly copied, reproduced or assigned without written approval from HUMBER DOORS LTD.

REV:	CHANGE DESCRIPTION:	REF:	DATE:	BY:
1	First Issue	N/A	17/02/2026	JA
DRAWN BY: D.Burge		DATE: 16/02/2026		REVISION: 1
APPROVED BY: J.Allen		DATE: 17/02/2026		

TITLE:  
**Sanctuary - 600mm 2 Door Floor Standing Unit**

DWG NO.  
**KAR-SAN03**

DIMENSIONS:  
595W x 457D x 830H

UNLESS OTHERWISE SPECIFIED:  
DIMENSIONS ARE IN MILLIMETERS  
TOLERANCES:  
LINEAR: +/- 0.5mm  
ANGULAR: +/- 0.5°  
SCALE: 1:8

DO NOT SCALE IF IN DOUBT ASK

A3

SHEET 1 OF 1