

USER MANUAL

K-VIT MIRRORS

HARDWIRED CONFIGURATION

WWW.KARTELLUK.COM

FINALLY YOU WILL GET THE MOST OUT OF YOUR MIRROR!

Thank you for making Reflections by K-VIT your everyday partner

We know how special you are, so this product has been carefully crafted, meticulously inspected and packaged before shipment just for you.

Before start enjoying an amazing new experience on your room please read this guide and follow the instructions for a safe use.

Lights on!

Use the sensor switch in your mirror to light your room and get ready to makeup.

Forget about foggy mirrors!

Once mirror is light up, the Demister will automatically prepare to warm up the surface of your mirror clearing up the fog before you take shower.

Don't look for extensions and plugs!

Use the charge station in the mirror to plug-in your electric shaver or toothbrush and get ready for an amazing day, simple and convenient.

Clear reflection and rust proof!

This wonderful mirror is made Copper-free coating, giving you a more vibrant reflection and colors when used together with lighting.

Plus its coated technology keeps it safe from rust for longer time than usual mirrors.



IMPORTANT PRECAUTIONS

DO NOT lay the mirror on tiled or concrete surface prior to installation. Preferable unpack the mirror at the moment of installation.

Do not take out the protective plastic until finished installation to prevent chipping of the corners.

Care must be taken before drilling pilot holes to avoid any existing wiring or pipe work that may be concealed. Confirm that the wall can support the weight of the mirror.

A certified electrician must perform all work.

This product shall be installed only in the zone 2 of your bathroom according to regulations. this mirror is suitable for all other rooms use.

The Charge Station voltage is 220v recommended for electric shaver use mainly.



SPLASHPROOF



**LEAD FREE
MIRROR**

MIR002 Technical Data

Life Span:	50,000 hours
Certifications:	CE & RoHS
Size:	700x500x55mm
IP protection:	IP44
Light Source:	SMD 2835
Use:	Indoor
Colour Temp:	Cool White 6000K
Material:	Aluminium / Crystal
Total Power:	31.8 Watts
Lighting Power:	16.8 Watts
Frequency:	50/60 Hz
Voltage:	AC 220-240V
Lumens:	1464 Lumens
Led Performance	87.14 Lm/W
Warranty	3 Years
Total Weight:	6.2Kg
Installation:	Horizontal
Lighting:	Frontal
Additional Functions	Demister Pad
	Sensor Switch
	Charge Station

K-VIT MIRROR

LONG-LASTING BRIGHTNESS

Your new Mirror uses 50,000 hours effective lifespan led chips, which means lumens won't decay or get yellowish over time.

Effective usage of Led Chips goes up to 27 years!.

But not just that, your mirrors is also IP44 certified and ready for use in Bathroom Zone 2!.



PRECAUTIONS WHEN CLEANING



When cleaning your Smart Mirror use non-abrasive soaps with neutral PH or recommended products for Glass cleaning, using a soft piece of cloth and drying it well.

First remove all dust with the soft piece of cloth cleaning all the surface of the mirror.



Spray a little of non-abrasive soap or Alcohol in the surface of the mirror and clean it with another soft piece of cloth, before the alcohol vaporize.

Note: try not to use non-cleaning mirror chemicals and excess of soap or alcohol, hence the chemicals in excess can accelerate the corrosion of the back cover.



CLEAN IT LIKE A PRO

GLASS AND MIRROR

WARRANTY

Once received carefully inspect your mirror and packaging.

Mirrors come with a 3 year warranty subject to company policy.

Contact your nearest distributor in case of any issue.

Technical Support

For technical support with any of our products, email technical@kartelluk.com or call 0330 808 5049

Installation Steps

1

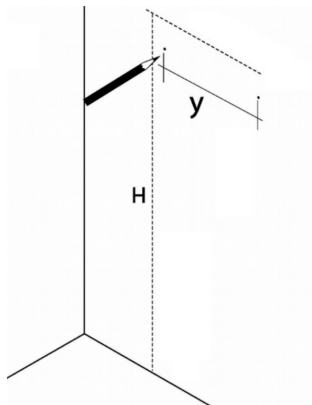
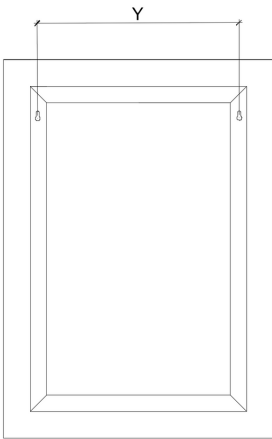

2

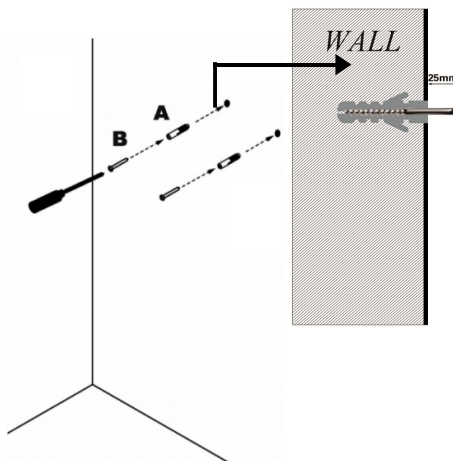
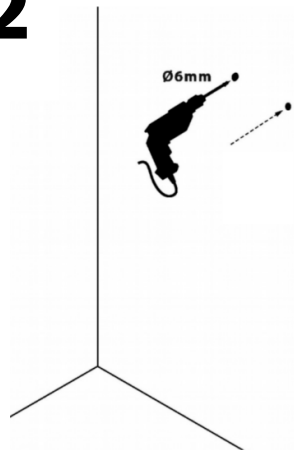

3

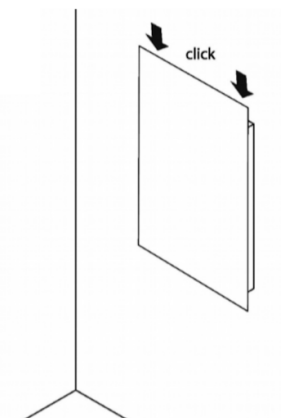
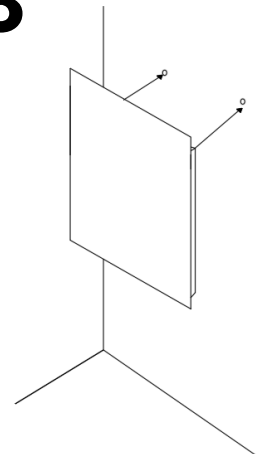

FOR YOUR SAFETY:

- During Ooperation, never put hard and sharp materials directly against the mirror surface, or otherwise, it may result in current leakage and even personal injury.
- Never forget to turn off the power switch in storm days, or otherwise, lightning may damage electric elements of the product.
- During normal operation, never forcibly pull out the power plug to stop the product, or otherwise, electric elements of the product may be damaged.
- Please pull out the power plug if the product is not used for a long time.

