

Sales Code: NFB105R

Description: Curved Freestanding Bath Rh 1700X800x575

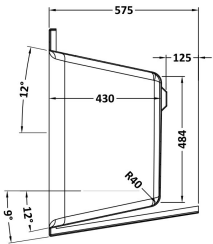

SECTION A-A

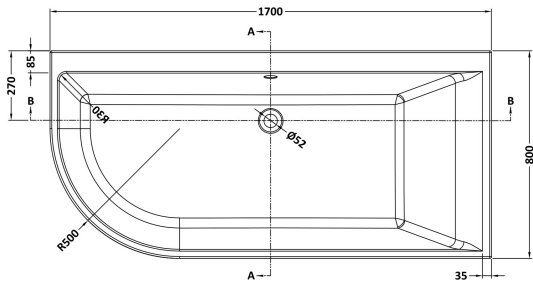
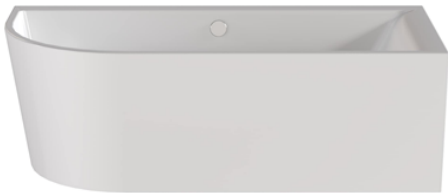
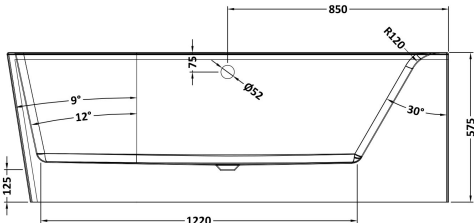

SECTION B-B

Product Dimensions

Length (mm):	1700
Width (mm):	800
Depth (mm):	575
Nett Weight (kg):	46

Packaging Dimensions

Length (mm):	1700
Width (mm):	800
Depth (mm):	575
Gross Weight (kg):	46

Packaging Data

Box Colour:	Brown Cardboard Box
Box Qty:	1
Label Size:	100 x 50
Label Colour:	White Label
Label Qty:	1

Outer Box Dimensions (If Applicable)

Length (mm):	
Width (mm):	
Height (mm):	
Gross Weight (kg):	
Barcode:	5056678446706

Product Details

Country of Origin:	Egypt
Fitting Instruction:	No
Certification:	FSC: No CE & UKCA: No
Material Colour Reference:	European White
Product Material:	Acrylic
Material Thickness:	
Volume (Ltr):	240
Displaced Capacity:	170
Leg Set Included:	Legset Included
Waste Included:	Waste Not Included
Drilled/Undrilled:	Undrilled For Taps
Includes Grips:	No Grips Supplied
Embossed:	No
No of Tapholes:	None
Anti-Slip:	No