

RAK-MOON

Back to Wall | Water Closet

RAK
CERAMICS

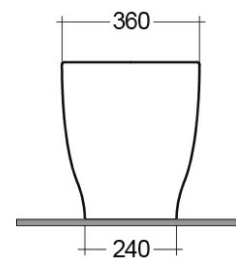
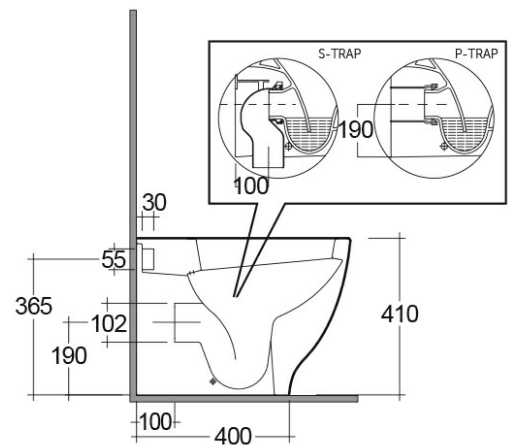
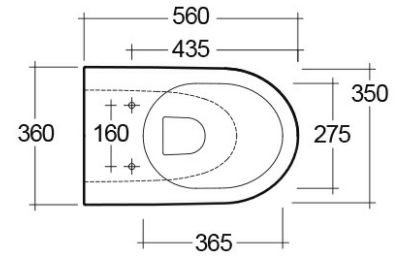

Technical specifications

Dimensions:	560 x 360 mm
Weight:	29 Kg
Color:	Alpine White
Trap type:	P Trap & S Trap
Trapway type:	Concealed
Seat cover options:	Urea
Bowl shape:	Oval
Soft close:	yes
Dual flush:	yes
Suites:	RAK-MOON

Code	Name
HAR18AWHA	MOON WATER CLOSET BACK TO WALL P S TRAP 56CM

Dimensions: All dimensions in mm tolerance $\pm 5\%$ for below 200mm and $\pm 3\%$ for above 200mm.

Note: Due to a continuing development programme to improve design and performance, the manufacturer reserves all rights to vary specifications without prior information.

Please note accessories are for photographic use only.