

RAK-SENSATION

Back to Wall | Water Closet

RAK
CERAMICS



Technical specifications

Dimensions:	620 x 380 mm
Weight:	31 Kg
Color:	Alpine White
Trap type:	P Trap & S Trap
Trapway type:	Concealed
Seat cover options:	Urea
Bowl shape:	Oval
Suites:	RAK-SENSATION

Code	Name
SENWC1146AWHA	SENSATION WATER CLOSET BACK TO WALL P/S-TRAP 62CM
SENWT1800AWHA	SENSATION WATER CLOSET TANK

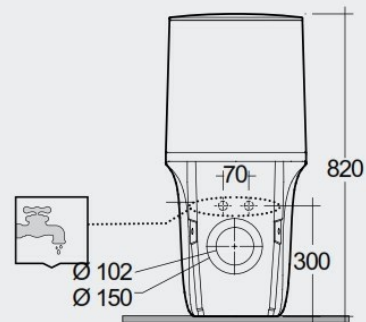
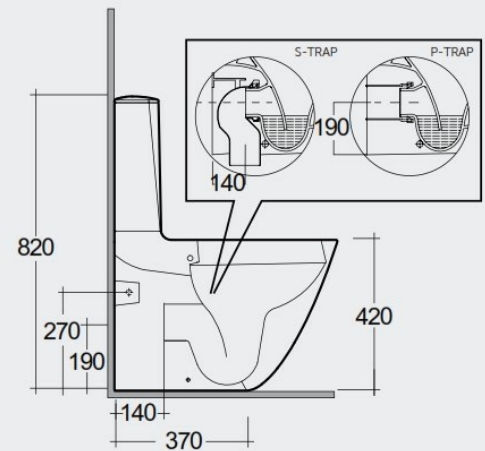
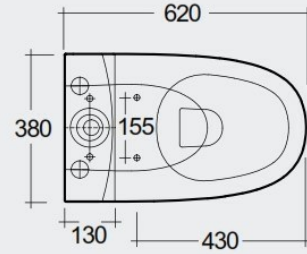

31.3 Kg.

Dimensions: All dimensions in mm tolerance $\pm 5\%$ for below 200mm and $\pm 3\%$ for above 200mm.

Note: Due to a continuing development programme to improve design and performance, the manufacturer reserves all rights to vary specifications without prior information.

Please note accessories are for photographic use only.