

RAK-ILLUSION
Wash basin | Wall Hung

RAK
CERAMICS

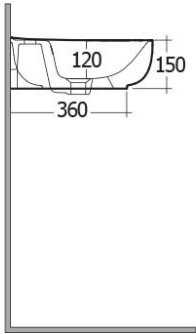
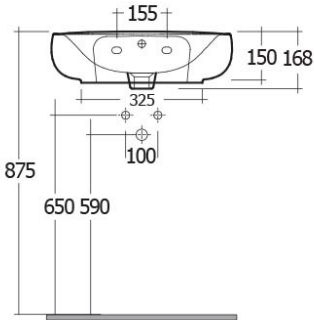
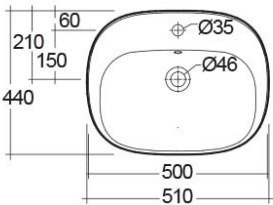

| Technical specifications | |
|--------------------------|------------------------------|
| Dimensions: | 500 x 440 mm |
| Weight: | 13 Kg |
| Color: | Alpine White |
| Shape of basin: | Oval |
| Overflow hole: | yes |
| Suites: | RAK-ILLUSION |
| Code | Name |
| ILLWB5001AWHA | RAK-ILLUSION |

Dimensions: All dimensions in mm. Tolerance of vitreous china & fireclay items: ± 5% for below 200mm and ± 3% for above 200mm; for all other items tolerance ± 1%. Note: Due to a continuing development program to improve design and performance, the manufacturer reserves all rights to vary specifications without prior information. Please note accessories are for photographic use only.