

RAK-RESORT – RAKRSTFSU55602 Cloakroom Vanity Unit, None

RAK
CERAMICS

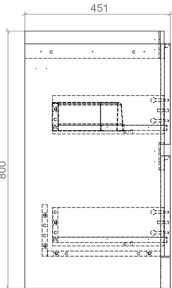
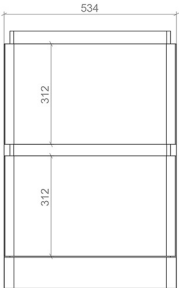
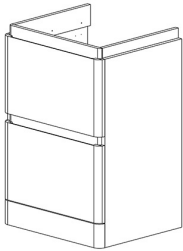

TECHNICAL SPECIFICATIONS

Suite:	RAK-RESORT
Type:	Cloakroom Vanity Unit
Dimensions:	534 x 800 mm
Weight:	27 Kg
Color:	Matt Mushroom
Door drawer:	2

Code	Name
RAKRSTFSU55602	RAK-RESORT – 55cm Floorstanding basin unit in Matt Mushroom to fit Resort 55cm Basin

Dimensions: All dimensions in mm. Tolerance of vitreous china & fireclay items: ± 5% for below 200mm and ± 3% for above 200mm; for all other items tolerance ± 1%. Note: Due to a continuing development program to improve design and performance, the manufacturer reserves all rights to vary specifications without prior information. Please note accessories are for photographic use only.