

RAK-SUMMIT
Close Coupled | Water Closet

RAK
CERAMICS

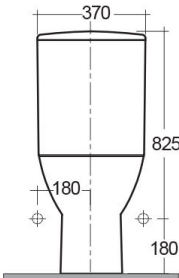
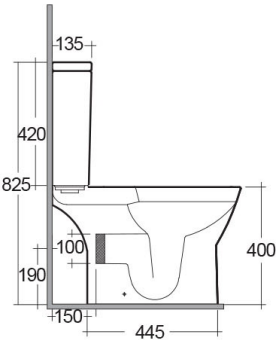
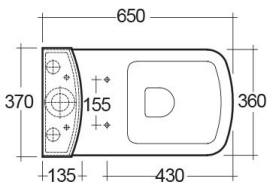

TECHNICAL SPECIFICATIONS

Suite:	RAK-SUMMIT
Type:	Close Coupled
Dimensions:	650 x 360 mm
Weight:	39 Kg
Color:	Alpine White
Trap type:	P Trap
Trapway type:	Concealed
Seat cover options:	Urea
Bowl shape:	Rectangle
Soft close:	yes
Flush Type:	Dual Flush

Code	Name
SM11AWHA	SUMMIT WATER CLOSET CLOSE COUPLED P-TRAP 65CM
SM10AWHA	SUMMIT WATER CLOSET TANK
YFG088C	RAK-Summit Urea Soft Close and Quick Release Seat Cover

Dimensions: All dimensions in mm. Tolerance of vitreous china & fireclay items:  $\pm 5\%$  for below 200mm and  $\pm 3\%$  for above 200mm; for all other items tolerance  $\pm 1\%$ . Note: Due to a continuing development program to improve design and performance, the manufacturer reserves all rights to vary specifications without prior information. Please note accessories are for photographic use only.