

# COMPACT COMMERCIAL NON CONCUSSIVE BASIN TAP

## Faucets

**RAK**  
CERAMICS

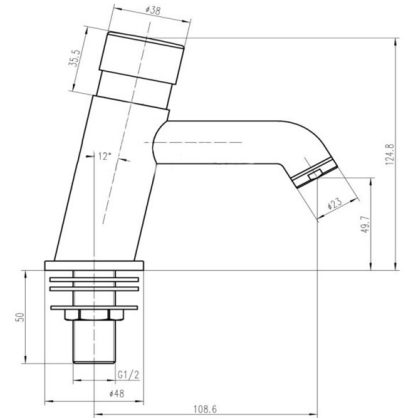

## TECHNICAL SPECIFICATIONS

Type:	Compact Commercial Non concussive basin tap
Pressure:	3 l
Weight:	0.61 Kg
Chrome thickness:	0.30
Cartridge:	Yes
Tail:	NA
Handset wall brackets:	No
Color:	Chrome

Code	Name
RAKCOM901C	Compact Commercial Non concussive basin tap

Dimensions: All dimensions in mm. Tolerance of vitreous china & fireclay items:  $\pm 5\%$  for below 200mm and  $\pm 3\%$  for above 200mm; for all other items tolerance  $\pm 1\%$ . Note: Due to a continuing development program to improve design and performance, the manufacturer reserves all rights to vary specifications without prior information. Please note accessories are for photographic use only.