

RAK-COMPACT-COMFORT HEIGHT 45CM

Close Coupled | Water Closet

RAK
CERAMICS

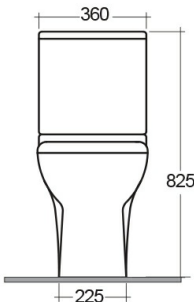
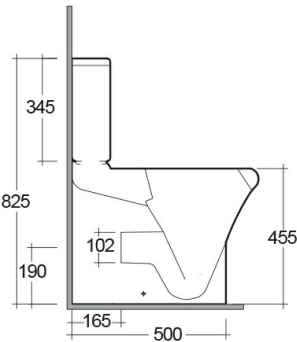
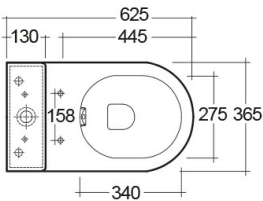

Technical specifications

Dimensions:	625 x 365 mm
Weight:	39 Kg
Color:	Alpine White
Trap type:	P Trap
Trapway type:	Concealed
Seat cover options:	Urea
Bowl shape:	Round
Flush Type:	Dual Flush
Suites:	RAK-COMPACT

Code	Name
CO26AWHA	COMPACT WATER CLOSET RIMLESS COMFORT HEIGHT 45CM CLOSE COUPLED P S-TRAP 62CM
CO10AWHA	COMPACT WATER CLOSET TANK

Dimensions: All dimensions in mm. Tolerance of vitreous china & fireclay items: $\pm 5\%$ for below 200mm and $\pm 3\%$ for above 200mm; for all other items tolerance $\pm 1\%$. Note: Due to a continuing development program to improve design and performance, the manufacturer reserves all rights to vary specifications without prior information. Please note accessories are for photographic use only.